

SwitchBot Safety Alarm

User Manual

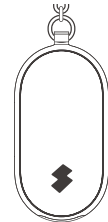

Please read this user manual carefully before using your device.

Scannen Sie den QR-Code, um die deutsche Version unseres Benutzerhandbuchs zu erhalten.
Scannez le code QR pour obtenir notre manuel d'utilisation en version française.
Escanee el código QR para obtener la versión en español de nuestro manual de usuario.
Scan de QR code voor de Nederlandse versie van onze gebruikershandleiding.
Scansionate il codice QR per ottenere la versione italiana del nostro manuale d'uso.
<https://www.switch-bot.com/pages/switchbot-user-manual>



User Manual

Package Contents



Safety Alarm



2 × CR2032 batteries



Screwdriver

List of Components

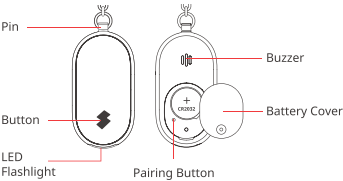

Preparation

You will need:

- A smartphone or tablet using Bluetooth 4.2 or later.
- The latest version of our app, downloadable via the Apple App Store or Google Play Store.
- A SwitchBot account, you can register via our app or sign in to your account directly if you already have one.

iOS and Android system requirements:
<https://support.switch-bot.com/hc/en-us/articles/12567397397271>

Add your Safety Alarm to our app

- 1 Open our app and sign in. Tap the + icon in the top right-hand corner of the home page, choose Add Device, select the Safety Alarm icon, and follow the prompts to add your device.



2 Unscrew and remove the battery cover.

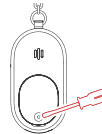

3 Install the two batteries as shown. Make sure the side with + faces upwards.

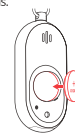

4 Tap Add device via the app when the indicator light starts flashing.

Note:

If the connection times out, use the screwdriver to press the pairing button besides the battery slot for 2 seconds to re-enter the pairing mode.

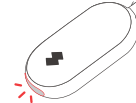

Use with Apple's Find My app

- 1 Open the Find My app, then click + icon and select Add Other Item.
- 2 Press the pairing button for 2 seconds until you hear a beep and the indicator light flashes.
- 3 Name your Safety Alarm and then tap Continue.
- 4 Register your SwitchBot Safety Alarm with your Apple ID, and click Continue.
- 5 Use the Find My app to check the location and status of your Safety Alarm.



Functions

SOS Emergency Alert

Visual and sound alarm

- 1 Pull the pin to activate flashing lights and loud alarm.
- 2 Meanwhile, your specified family member will receive SOS notifications with your location, and emergency contacts will get email alerts.

Note: This feature requires that a Hub or your phone is within range. The SOS notification will be sent for 3 times.

- 3 Install the pin to stop the alarm.

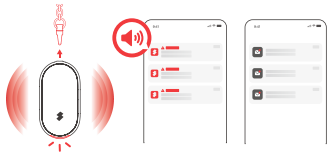

Silent alarm

- 1 Press the button for 5s to activate silent alarm.
- 2 Your family member will receive location notifications and emergency contacts get email alerts, without sound.

Note: This feature requires that a Hub or your phone is within range. Only one notification will be sent.

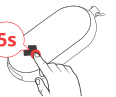

Locate your SwitchBot Safety Alarm

- 1 You can use the Find My app to locate your Safety Alarm. When your device is within Bluetooth range, our app can activate sounds on the Safety Alarm, making it easier to locate.
- 2 Alternatively, you can track the location of your Safety Alarm through our app. When the device is within Bluetooth range, our app can activate sounds on the Safety Alarm, making it easier to locate.

Locate your phone, even in Silent Mode

- 1 Enable Find My Phone via our app.
- 2 Quickly press the button twice. Two confirmation beeps will sound. If your phone is nearby, it will emit sound to help you locate it.

Return of lost items via QR code

- 1 Activate Lost Mode for your Safety Alarm using our app.
- 2 Follow the prompts to input your contact information. This allows others to contact you by scanning the QR code on the device and return your belongings.

Disable Find My network

Quickly press the button five times. On the fifth press, hold the button for ten seconds. One confirmation beep will sound, followed by two beeps.

Reset device data

- 1 Unscrew to remove the battery cover.
- 2 Press the pairing button for 15 seconds until you hear five beeps.

Perform serial number lookup

You can use the Find My app to learn about a Safety Alarm that's been misplaced or lost by its owner.

- Open the Find My app, scroll to the bottom of the Items tab, then tap Identify Found Item.
- Keep the device near your iPhone. Once your iPhone detects the Safety Alarm, it will appear in the list of found items. Select the Safety Alarm from the list.

- On the displayed page, you can connect to the device by following these steps:

- 1 Locate the button on the front of the SwitchBot Safety Alarm. Quickly press the button twice. Two confirmation beeps will sound.
- 2 After successfully connecting to the Safety Alarm, tap Continue on Website. On the website, you can view Lost Mode message left by the owner and check the device's serial number.

Anti-Tracking Mode

- 1 If someone uses a Safety Alarm to unlawfully track you or your belongings, you will receive alerts on your Apple device (iPhone or iPad running iOS version 14.5 or above) via the Find My app.
- 2 A device that isn't with its owner for a period of time will emit a sound when it's moved.

NFC

This product supports Near Field Communication (NFC). If someone finds your lost item, they can tap the Safety Alarm with an NFC-enabled device to get your contact information.

You can use this device as an NFC card and quickly unlocks your doors with associated SwitchBot Keypad products.

Flashlight

- 1 Short press the device button once to turn on the flashlight.
- 2 Press again to increase the brightness.
- 3 Press one more time to turn off the flashlight.

Precautions

- For your safety, we recommend familiarizing yourself with the SOS alert function.
- Regularly check the battery level, and replace the battery promptly if the alarm volume weakens or after 12 months of use.
- If water gets into the buzzer, dry the device immediately.
- Avoid submerging the device in water or exposing it to high humidity for extended periods, especially when the pin is removed.
- This device is a precision-based electronic product, please avoid physical damage.
- Do not punch holes in or attach foreign objects to this device.
- Do not attempt to disassemble, repair, or modify this device.
- Do not use this device where wireless devices are not allowed.
- Avoid using or storing the device in areas with strong static electricity and magnetic fields.

Firmware Upgrades

In order to improve user experience, we will regularly release firmware updates to introduce new functions and solve any software defects that may occur during usage. When a new firmware version is available, we will send an upgrade notification to your account via our app. When upgrading, please make sure your product has sufficient battery or stay powered on and make sure your smartphone is within range to prevent interference.

Troubleshooting

Safety Alarm connected to another Apple ID

1. If you want to use a different Apple ID with your Safety Alarm, ensure that the device has been removed from the Find My app associated with the previous Apple ID.
2. If you encounter this problem when you add the device for the first time, please contact us at support@switch-bot.com.

Specifications

Material: ABS+PC
Size: 67 × 33 × 15 mm (2.6 × 1.3 × 0.6 in.)
Weight: 35 g (1.2 oz.)
Power: 2 × CR2032 batteries
Battery Life: 1 year
Operating Temperature: -10°C to 45°C (14°F to 113°F)
Operating Humidity: 10% to 90% RH
Connectivity: Bluetooth Low Energy
Operating Frequency: 13.56 MHz
Communication Protocol: ISO14443A
IP Rating: IP65

FCC Caution:

Any changes or modifications not expressly approved by the party responsible for compliance could void the user's authority to operate this equipment.

This device complies with part 15 of the FCC Rules. Operation is subject to the following two conditions:

- (1) this device may not cause harmful interference, and
- (2) this device must accept any interference received, including interference that may cause undesired operation.

This device and its antenna(s) must not be co-located or operating in conjunction with any other antenna or transmitter.

NOTE: This equipment has been tested and found to comply with the limits for a Class B digital device, pursuant to Part 15 of the FCC Rules. These limits are designed to provide reasonable protection against harmful interference in a residential installation. This equipment generates, uses and can radiate radio frequency energy and, if not installed and used in accordance with the instructions, may cause harmful interference to radio communications. However, there is no guarantee that interference will not occur in a particular installation.

If this equipment does cause harmful interference to radio or television reception, which can be determined by turning the equipment off and on, the user is encouraged to try to correct the interference by one or more of the following measures:

- Reorient or relocate the receiving antenna.
- Increase the separation between the equipment and receiver.
- Connect the equipment into an outlet on a circuit different from that to which the receiver is connected.
- Consult the dealer or an experienced radio/TV technician for help.

The device has been evaluated to meet general RF exposure requirement. The device can be used in portable exposure condition without restriction.