

- 5 Install the Roller Mop back to the robot.

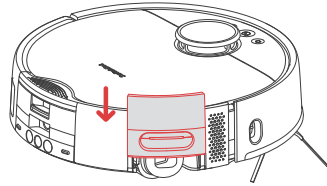

Anti-Tangle Rubber Brush

- 1 Flip the robot over, press the latch, and remove the brush cover.

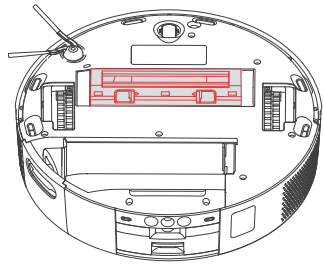

- 2 Remove the Anti-Tangle Rubber Brush, pull out the bearings at both ends, and clean any hair or dirt wrapped around the brush. You can use the provided small cleaning tool for this.

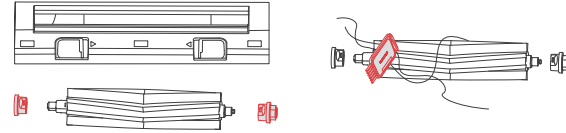

- 3 Install the Anti-Tangle Rubber Brush back to the robot. You will hear a clicking sound once it is correctly installed. Make sure both ends of the brush are inserted into the robot's pegs, and then cover it with the brush cover.

Important

- Wipe off the dirt on the Anti-Tangle Rubber Brush with a damp cloth. If the brush is soaked, dry it thoroughly and avoid direct sunlight.
- Do not use corrosive cleaning liquids or disinfectants to clean the Anti-Tangle Rubber Brush.

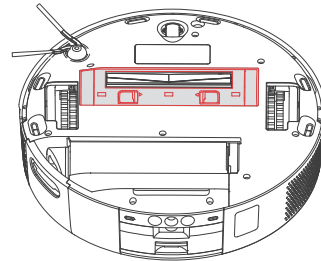

Side Brush

- 1 Remove the Side Brush.

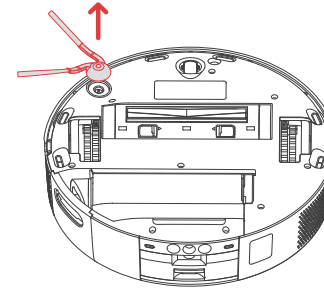

- 2 Clean the Side Brush and its mounting shaft, then reinstall it.

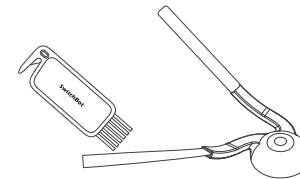

Front Caster Wheel

- 1 Use a small screwdriver or similar tool to pry out the wheel and clean it.

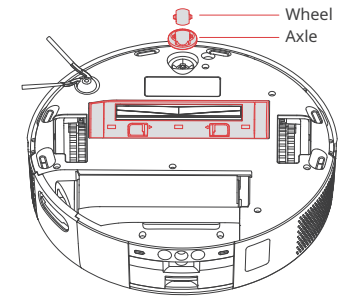

- 2 Rinse the wheel and axle to remove hair or dirt. Dry it and reattach the wheel, pressing it firmly into place.

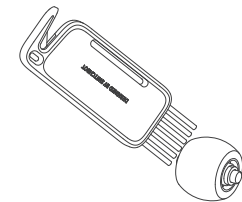

Dustbin

- 1 Open the robot's faceplate and remove the dustbin.

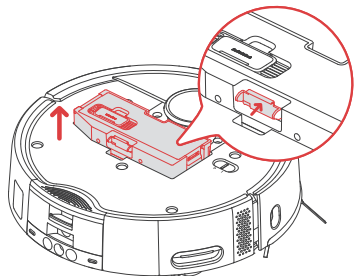

- 2 Open the dustbin lid and empty the trash. Use the provided cleaning tool to deep clean the box.

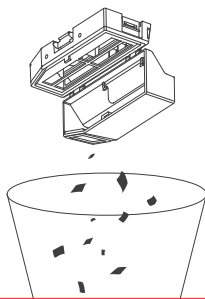

- 3 Reinstall the dustbin.

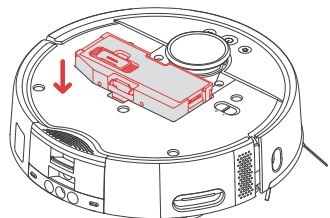

Important
If washing, do not add any detergent, as it may cause filter clogging. Make sure to dry the dustbin and the filter thoroughly before installing them back.

Dustbin Filter

- 1 Open the dustbin cover and remove the filter.

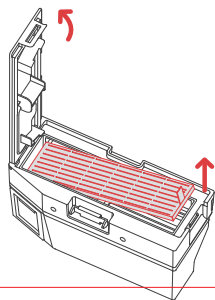

Roller Mop

- 2 Rinse the filter repeatedly and gently tap the dirt out until it is clean.

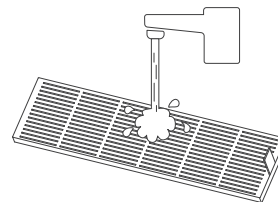

Important
Do not touch the filter surface with hands, brushes, or sharp objects to avoid damaging the filter.

- 3 Air dry the filter for at least 24 hours before reuse. For optimal performance, alternate between two filters.

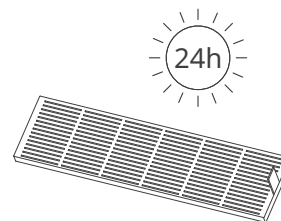

- 1 As shown in the picture, lift the Roller Mop Cover and pull out the Roller Mop.

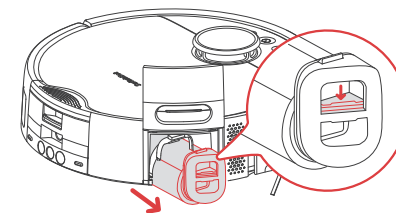
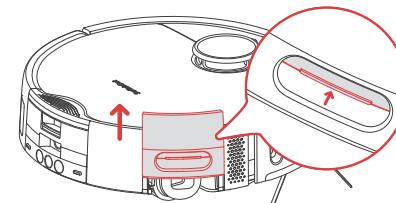

② Use the small cleaning tool provided to remove hair or debris wrapped around the Roller Mop.



③ Rinse the Roller Mop surface with clean water and drain excess water.

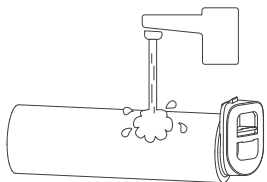

④ Reinstall the Roller Mop and press the Roller Mop Cover back into place. Make sure there is no water or stains inside the Roller Mop to avoid damaging the motor.

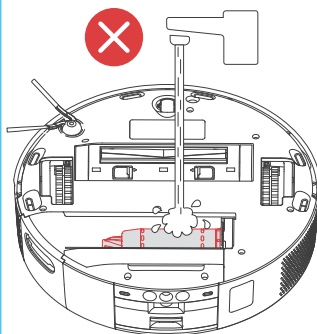
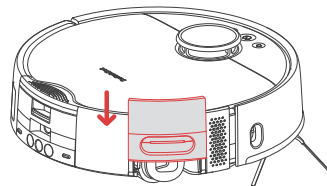

Important

Do not rinse the roller motor when it is installed on the robot. This may cause motor and robot damage.

Robot Sensors

Clean the various sensors on the robot with a soft, dry cloth, including: LDS Laser Radar, Docking Sensors, Obstacle Avoidance Sensor, Wall Follow Sensor, Carpet Sensor, Cliff Sensor, and Charging Contacts.

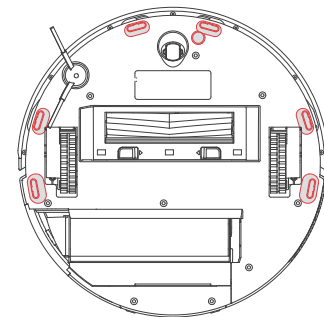
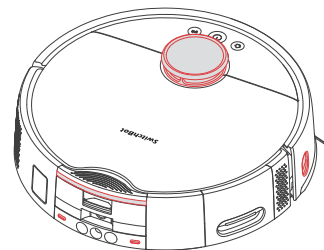

Daily Maintenance (Base Station)

Dust Bag

You will receive app prompts when the Dust Bag is full. In this case, replace the Dust bag in time.

① Open the canister lid, remove and discard the used dust bag.

Tips

When removing the Dust Bag, its handle will seal the bag to effectively prevent dust leakage.

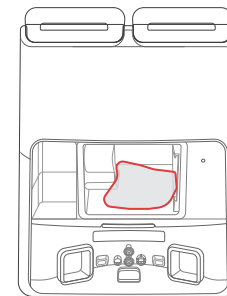

② Install a new dust bag and close the canister lid.

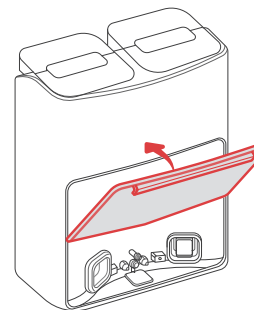

Diatom Mud Mat

Diatom Mud Mat absorbs water drops and air dries by itself. Clean or replace as prompted by the app.

- 1 Remove the Diatom Mud Mat from the Base Station.
- 2 Install a new Diatom Mud Mat.

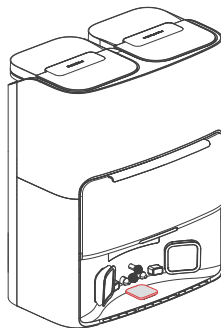

Debris Evacuation Port

Please regularly clean the Debris Evacuation Port to avoid blockage. Use the small cleaning tool provided to clear any debris accumulated in the Debris Evacuation Port. Use a dry cloth to wipe the Debris Evacuation Port to make sure it is dry and clean.

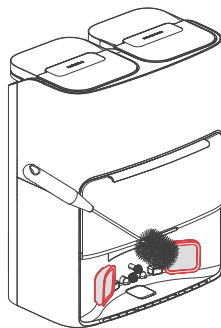

Clean Water Tank

Regularly check your Clean Water Tank's water level and refill in time to ensure normal use.

Take out Clean Water Tank and inject water to the highest water level.

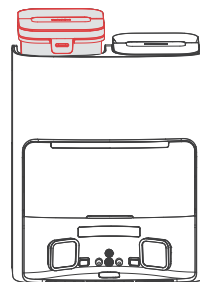

Please note

Hot water is not recommended because it may cause device damage.

Waste Water Tank

Empty the Waste Water Tank in time to prevent spilling.

Remove and empty the Waste Water Tank. Rinse to clean it based on your needs.

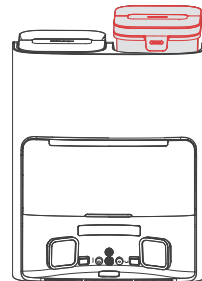

Charging Area

Use a soft, dry cloth to clean the Base Station's charging contacts and the Recharging Signal Emitter area.

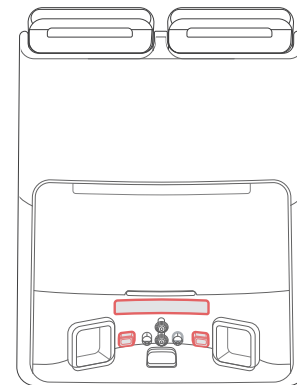

Waste Filter

- 1 Follow the mark beside the Waste Filter Cover to turn it open.

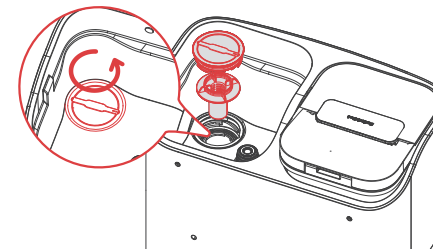

- 2 Remove the Waste Filter inside, and rinse it under a tap.



3 Put the filter back into the station and tighten the Waste Filter Cover.

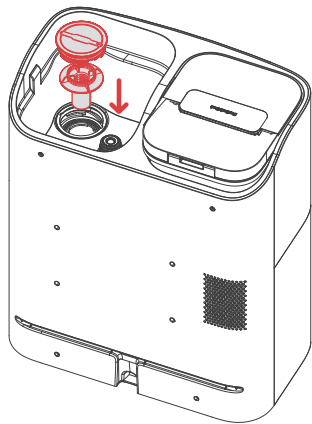

Troubleshooting

Common Issues

If you encounter any issues, start by updating the firmware or restarting the device, as these steps often resolve common problems. If the issue persists, consult the troubleshooting guide or contact customer support for further assistance.

Unable to power on

- The battery level is low. Put the robot on the Base Station and charge it before use.
- The ambient temperature is too low or too high. Only use the robot within the range of 4°C to 40°C (39°F to 104°F).

Unable to charge

- Check the power cord for any damage and make sure it's securely plugged in. Ensure the station is powered on and its indicator light turns on in white.
- Poor contact, please clean the charging contacts on the Base Station and the robot.
- Make sure the firmwares of your robot and Base Station are up to date.

Network connection failure

- Incorrect Wi-Fi password, please enter the correct Wi-Fi password.
- Switch to a 2.4GHz network for pairing, as 5GHz networks and enterprise routers are not supported.
- Keep the robot within a range with good Wi-Fi signal strength.
- The robot may not be in the ready-to-configure state, exit the app and re-enter, then follow the pairing steps to try again.

Abnormal task termination

- Your robot's battery is exhausted.
- Your robot has been stuck or tangled and cannot dock to charge. Set No-Go Zone or virtual wall in such areas.

Unable to identify Base Station

- Ensure that your station is powered on, with the white light turns on. Keep the power cord organized to avoid wear and entanglement.
- Check the Bluetooth connection between your robot and the station. If your product has undergone a warranty or replacement process, manually pair them after powering on.

Package contents inconsistency

- We're continuously upgrading our package contents based on customer feedback, but documentation updates may lag behind. We apologize for any inconvenience.
- If this inconsistency affects the normal use of your product, please contact us.

Abnormal behavior

- Make sure to declutter your room before initiating a cleaning task.
- Check and remove any hair or debris tangled on the Main Wheels or Caster Wheel.
- Check if the floor is slippery or uneven.
- Please turn off and restart the robot.

The Side Brush fell off

- Please reinstall the Side Brush, making sure to hear a "click" to indicate it is in place.
- The Side Brush may have fallen off due to tangled wires. Please clear wires on the floor before use.

Ground not cleaned up

- The dustbin is full. Please empty it.
- The filter may be clogged with dust. Please check and clean as necessary.
- If the filter is not dry after cleaning. Please let it air dry before using.

Water leaked while mopping

- Remove the Roller Mop and Collection Gutter, and clear any debris.
- Ensure the firmware versions of all parts are up to date.

Dust leaked while working

- Remove the Anti-Tangle Rubber Brush and dustbin, and clear any debris near the Anti-Tangle Rubber Brush.
- Your Dustbin is full. Please dock your robot and empty dust.

Loud operating noise

- The dustbin is full. Please empty it.
- Hard objects may be tangled in the Anti-Tangle Rubber Brush and dustbin. Please check and clean as necessary.
- The Side Brush and Anti-Tangle Rubber Brush may be tangled with debris. Please check and clean as necessary.
- You can lower the suction power of the robot to Quiet or Low if necessary.

Failed to upgrade firmware

- Exit the firmware upgrade page and try again later.
- Make sure the network connection is stable.

Roller Mop dry/Mopping effect not satisfied

- Set your robot to an appropriate Mopping Water Level via our app.
- Wash your mop prior a mopping task to get the optimal mopping effect.

Stopped due to being stuck

- The robot may be stuck under furniture of a similar height. Consider raising the furniture, manually blocking or using our app to set a virtual wall to avoid the area.
- Check the corresponding area for any wires, curtains, or carpet edges that may be tangled with or obstructing the robot. Manually remove any obstructions for smooth operation.

Water refilling/draining errors

- Check if the Clean Water Tank is properly positioned and has sufficient water.
- Check if the Waste Water Tank is full.
- Check if the silicone joints on the Auto-Fill Port and Auto-Drain Port are damaged.

Missed cleaning some rooms <ul style="list-style-type: none">• Please ensure all room doors are fully opened.• Check if there is a doorstep higher than 1.8 cm at the entrance of the room, as this product cannot overcome higher doorsteps.• If the entrance is slippery, causing the robot to skid and malfunction, it is recommended to manually clean up the water on the floor.• Check if there is a small mat or carpet at the entrance of the room. When in Mop mode, the robot will avoid carpets. You can disable the carpet detection feature in the app settings page.	Scheduled cleaning not effective <ul style="list-style-type: none">• The cleaning will only start when the remaining battery is more than 15%.
Robot indicator light on or flashes in orange <ul style="list-style-type: none">• Your robot is trying to free it from being stuck. Please check if your robot is getting stuck.• Your robot's battery is low. The indicator light will turn off after it is docked and charged.• Your robot is abnormal. Please troubleshoot based on the app prompts. If the fault persists, please contact the customer support.	Tubes cannot be installed <ul style="list-style-type: none">• Refer to the installation video for guidance and select the appropriate installation methods and accessories.• Ensure all components (gaskets, screws, clamps, etc.) are correctly installed and securely fitted.• If the provided accessories are not suitable, measure the size of the tubes in your home and contact our support team. We will provide customized accessories tailored to your specific requirements.
Water droplets found after refilling/draining <ul style="list-style-type: none">• During refilling or draining, water droplets may occur. Check if the Diatom Mud Mat is dry.• Check if the silicone joints on your station are intact.	The LED Status Indicator on the Base Station stays orange <ul style="list-style-type: none">• The dust bag is not in position. Please check and install it correctly.• The dust bag is full. Please check and replace with a new dust bag.• The canister lid of the Base Station is not closed. Please check and close it tightly.
Didn't resume cleaning after being fully charged <ul style="list-style-type: none">• Make sure the robot is not in Do Not Disturb mode, as it will not resume cleaning in this mode.• If the robot is docked manually or by pressing the Home button, it will not resume cleaning after being fully charged.	Robot indicator light on or flashes in orange <ul style="list-style-type: none">• Your robot is trying to free it from being stuck. Please check if your robot is getting stuck.• Your robot's battery is low. The indicator light will turn off after it is docked and charged.• Your robot is abnormal. Please troubleshoot based on the app prompts. If the fault persists, please contact the customer support.
Purchasing Cleaning Solution <p>Visit our website or contact SwitchBot customer support to purchase the official SwitchBot Floor Cleaning Solution.</p>	Purchasing Cleaning Solution <p>Visit our website or contact SwitchBot customer support to purchase the official SwitchBot Floor Cleaning Solution.</p>
	Unable to create maps in the app <ul style="list-style-type: none">• The robot needs to start mapping from the Base Station, it is recommended to use the Fast Mapping feature.• Do not move the robot during the first mapping process to avoid locating failure.

<ul style="list-style-type: none">• If the robot does not return to the Base Station after completing the first mapping task, check and remove any obstacles on the ground.	Warranty & Support
<div>Note</div> <p>If returning the product for repair, please empty any water and use its original packaging to prevent damage during transportation.</p> <p>Please visit our website or scan the QR code below for more information. https://support.switch-bot.com/hc/en-us/categories/29440818503831</p> 	Warranty <p>We warrant to the original owner of the product that the product will be free from defects in materials and workmanship. Please note that this limited warranty does not cover:</p> <ol style="list-style-type: none">1. Products submitted beyond the original limited warranty period.2. Products on which repairs or modifying have been attempted.3. Products subjected to falls, extreme temperatures, water, or other operating conditions outside the product specifications.4. Damage due to natural disaster (including but not limited to lightning, flood, tornado, earthquake, or hurricane, etc.).5. Damage due to misuse, abuse, negligence or casualty (e.g. fire).6. Other damage that is not attributable to defects in the manufacture of product materials.7. Products purchased from unauthorized resellers.8. Consumable parts (including but not limited to batteries).9. Natural wear of the product.
Specifications <p>Robot</p> <p>Material: ABS Size: 365 × 365 × 115 mm (14.3 × 14.3 × 4.5 in.) Weight: 5.5 kg (12 lb) Power Supply: 21.6 V/4000 mAh lithium-ion battery Rated Power: 85 W Operating Temperature: 0 °C to 40 °C (32 °F to 104 °F) Operating Humidity: < 90% RH Charging Time: 3 to 4 h Connectivity: 2.4 GHz Wi-Fi, Bluetooth 4.2 or later 4.2</p> <p>Base Station</p> <p>Size: 380 × 223 × 460 mm (14.9 × 8.7 × 18.1 in.) Weight: 6.79 kg (15 lb) Rated Input: 120 V~ 60 Hz Rated Power (Charging): 36 W Rated Power (Emptying Dust): 900 W Rated Power (Drying Mop and Charging): 150 W Rated Output: Max 24 V – 1.5 A</p>	

Disclaimers

- We are not responsible for any damages caused by natural disasters such as earthquakes, lightning, wind and water damage, fires that are not caused by the product, third party actions, intentional or negligent misuse by the customer, or other abnormal usage conditions.
- We are not responsible for any incidental damages arising from the use or inability to use this product (such as changes or loss of recorded content, loss of business profits, business interruption).
- We are not liable for damages arising from non-compliance with the contents in this manual.
- We assume no responsibility for damages caused by improper actions or use with devices not controlled by us.

Contact & Support

Feedback: If you have any concerns or problems when using our products, please send feedback via our app through the Profile > Support page.
Setup and Troubleshooting: support.switch-bot.com
Support Email: support@switch-bot.com

REGULATORY INFORMATION

Floor Cleaning Robot S20

CE Warning

To comply with RF exposure requirements, a minimum separation distance of 20 cm must be maintained between the user's body and the device, including the antenna. Use only the supplied or an approved antenna. This device in compliance with the essential requirements and other relevant provisions of directive 2014/53/EU. All essential radio test suites have been carried out.

CE DOC

Hereby, Woan Technology (Shenzhen) Co., Ltd. declares that the radio equipment type W3211800 is in compliance with Directive 2014/53/EU. The full text of the EU declaration of conformity is available at the following internet address: support.switch-bot.com

This product can be used in EU member states and UK.

Manufacturer: Woan Technology (Shenzhen) Co., Ltd.
Address: Room 1101, Qiancheng Commercial Center, No. 5 Haicheng Road, Mabu Community, Xixiang Subdistrict, Bao'an District, Shenzhen, Guangdong, P.R.China, 518100
CE representative: XDH Tech
Address: 2 Rue Coysevox Bureau 3, Lyon, France

Operation frequency (Max power)
Wi-Fi: 2412 MHz to 2472 MHz (3.5 dBm)
BLE: 2402 MHz to 2480 MHz (3.5 dBm)
Operation temperature: 4 °C to 35 °C

FCC Warning

This device complies with Part 15 of the FCC Rules. Operation is subject to the following two conditions:

- (1) This device may not cause harmful interference.
- (2) This device must accept any interference received, including interference that may cause undesired operation.

NOTE: This equipment has been tested and found to comply with the limits for a Class B digital device, pursuant to part 15 of the FCC Rules. These limits are designed to provide reasonable protection against harmful interference in a residential installation.

This equipment generates uses and can radiate radio frequency energy and, if not installed and used in accordance with the instructions, may cause harmful interference to radio communications. However, there is no guarantee that interference will not occur in a particular installation. If this equipment does cause harmful interference to radio or television reception, which can be determined by turning the equipment off and on, the user is encouraged to try to

correct the interference by one or more of the following measures:

- Reorient or relocate the receiving antenna.
- Increase the separation between the equipment and receiver.
- Connect the equipment into an outlet on a circuit different from that to which the receiver is connected.
- Consult the dealer or an experienced radio/TV technician for help.

NOTE: The manufacturer is not responsible for any radio or TV interference caused by unauthorized modifications to this equipment. Such modifications could void the user's authority to operate the equipment.

FCC Radiation Exposure Statement

This equipment complies with FCC radiation exposure limits set forth for an uncontrolled environment. This equipment should be installed and operated with minimum distance 20 cm between the radiator & your body.

CE-Warnung

Um die Anforderungen an die HF-Exposition zu erfüllen, muss ein Mindestabstand von 20 cm zwischen dem Körper des Benutzers und dem Gerät, einschließlich der Antenne, eingehalten werden. Verwenden Sie nur die mitgelieferte oder eine zugelassene Antenne. Dieses Gerät entspricht den grundlegenden Anforderungen und anderen relevanten Bestimmungen der Richtlinie 2014/53/EU. Alle wesentlichen Funktestreihen wurden durchgeführt.

CE-DOC

Hiermit erklärt Woan Technology (Shenzhen) Co., Ltd. dass die Funkanlage (des Typs W3211800) mit der Richtlinie 2014/53/EU übereinstimmt. Der vollständige Text der EU-Konformitätserklärung ist unter der folgenden Internetadresse verfügbar: **support.switch-bot.com**

Dieses Produkt kann in den EU-Mitgliedsstaaten und in Großbritannien verwendet werden.

Hersteller: Woan Technology (Shenzhen) Co., Ltd.
Adresse: Raum 1101, Qiancheng Commercial Center, Nr. 5 Haicheng Road, Mabu Community, Xixiang Subdistrict, Bao'an District, Shenzhen, Guangdong, P.R.China, 518100
CE-Vertreter: XDH Tech
Anschrift: 2 Rue Coysevox Bureau 3, Lyon, Frankreich

Betriebsfrequenz (maximale Leistung)
Wi-Fi: 2412 MHz bis 2472 MHz (3,5 dBm)
BLE: 2402 MHz bis 2480 MHz (3,5 dBm)
Betriebstemperatur: 4 °C bis 35 °C

Avertissement CE

Pour respecter les exigences en matière d'exposition aux radiofréquences, une distance de séparation minimale de 20 cm doit être maintenue entre le corps de l'utilisateur et l'appareil, y compris l'antenne. N'utilisez que l'antenne fournie ou une antenne approuvée. Cet appareil est conforme aux exigences essentielles et aux autres dispositions pertinentes de la directive 2014/53/UE. Toutes les suites de tests radio essentiels ont été effectuées.

CE DOC

Par la présente, Woan Technology (Shenzhen) Co, Ltd déclare que le type d'équipement radio (W3211800) est conforme à la directive 2014/53/UE. Le texte intégral de la déclaration de conformité UE est disponible à l'adresse internet suivante : **support.switch-bot.com**.

Ce produit peut être utilisé dans les États membres de l'UE et au Royaume-Uni.

Fabricant : Woan Technology (Shenzhen) Co, Ltd.
Adresse : Appartement 1101, Centre Commercial de Qiancheng, No. 5 de la route de Haicheng, Communauté de Mabu, Sub-district de Xixiang, District de Bao'an, Shenzhen, Guangdong, République populaire de Chine, 518100
Représentant CE : XDH Tech
Adresse : 2 Rue Coysevox Bureau 3, Lyon, France

Fréquence de fonctionnement (Puissance maximale)
Wi-Fi : 2412 MHz à 2472 MHz (3,5 dBm)
BLE : 2402 MHz à 2480 MHz (3,5 dBm)
Température de fonctionnement : 4 à 35 °C

Avvertenza di CE

Per rispettare i requisiti di esposizione alle radiofrequenze, è necessario mantenere una distanza minima di 20 cm tra il corpo dell'utente e il dispositivo, compresa l'antenna. Utilizza esclusivamente l'antenna in dotazione o un'antenna approvata. Questo dispositivo è conforme ai requisiti essenziali e alle altre disposizioni pertinenti della direttiva 2014/53/UE. Sono state eseguite tutte le suite di test radio essenziali.

DOC CE

Con la presente, Woan Technology (Shenzhen) Co., Ltd. dichiara che il tipo di apparecchiatura radio (W3211800) è conforme alla Direttiva 2014/53/UE. Il testo completo della dichiarazione di conformità UE è disponibile al seguente indirizzo internet: **support.switch-bot.com**

Questo prodotto può essere utilizzato negli Stati membri dell'UE e nel Regno Unito.

Produttore: Woan Technology (Shenzhen) Co., Ltd.
Indirizzo: Room 1101, Qiancheng Commercial Center, No. 5 Haicheng Road, Mabu Community, Xixiang Subdricit, Bao'an District, Shenzhen, Guangdong, P.R.China, 518100
Rappresentante CE: XDH Tech
Indirizzo: 2 Rue Coysevox Bureau 3, Lione, Francia

Frequenza di funzionamento (potenza massima)
Wi-Fi: da 2412 MHz a 2472 MHz (3,5 dBm)
BLE: da 2402 MHz a 2480 MHz (3,5 dBm)
Temperatura di funzionamento: da 4 a 35 °C

Advertencia CE

Para cumplir con los requisitos de exposición a RF, se debe mantener una distancia mínima de separación de 20 cm entre el cuerpo del usuario y el dispositivo, incluyendo la antena. Utilice solo la antena suministrada o una aprobada. Este dispositivo cumple con los requisitos esenciales y otras disposiciones relevantes de la directiva 2014/53/UE. Se han llevado a cabo todas las pruebas de radio esenciales.

DOC CE

Por la presente, Woan Technology (Shenzhen) Co., Ltd. declara que el equipo de radio (tipo W3211800) cumple con la Directiva 2014/53/UE. El texto completo de la declaración de conformidad de la UE está disponible en la siguiente dirección de internet: **support.switch-bot.com**

Este producto puede ser utilizado en los estados miembros de la UE y el Reino Unido.

Fabricante: Woan Technology (Shenzhen) Co., Ltd.
Dirección: Sala 1101, Centro Comercial Qiancheng, No. 5 Haicheng Road, Comunidad Mabu, Subdistrito Xixiang, Distrito Bao'an, Shenzhen, Guangdong, P.R.China, 518100
Representante CE: XDH Tech
Dirección: 2 Rue Coysevox Bureau 3, Lyon, Francia

Frecuencia de Operación (Potencia máxima)
Wi-Fi: 2412 MHz a 2472 MHz (3.5 dBm)
BLE: 2402 MHz a 2480 MHz (3.5 dBm)
Temperatura de operación: 4 a 35 °C

CE Waarschuwing

Om te voldoen aan de RF-blootstellingsvereisten, moet een minimale afstand van 20 cm worden aangehouden tussen het lichaam van de gebruiker en het apparaat, inclusief de antenne. Gebruik alleen de meegeleverde of een goedgekeurde antenne. Dit apparaat voldoet aan de essentiële eisen en andere relevante bepalingen van richtlijn 2014/53/EU. Alle essentiële radiotestreeksen zijn uitgevoerd.

CE DOC

Hierbij verklaart Woan Technology (Shenzhen) Co., Ltd. dat de radiouitrusting van het type (W3211800) voldoet aan Richtlijn 2014/53/EU. De volledige tekst van de EU-verklaring van conformiteit is beschikbaar op het volgende internetadres: **support.switch-bot.com**

Dit product kan worden gebruikt in EU-lidstaten en het Verenigd Koninkrijk.

Fabrikant: Woan Technology (Shenzhen) Co., Ltd.
Adres: Kamer 1101, Qiancheng Commercial Center, Nr. 5 Haicheng Road, Mabu Community, Xixiang Subdistrict, Bao'an District, Shenzhen, Guangdong, V.R. China, 518100
CE-vertegenwoordiger: XDH Tech
Adres: 2 Rue Coysevox Bureau 3, Lyon, Frankrijk

Bedrijfsfrequentie (Maximaal vermogen)
Wi-Fi: 2412 MHz tot 2472 MHz (3,5 dBm)
BLE: 2402 MHz tot 2480 MHz (3,5 dBm)
Bedrijfstemperatuur: 4 tot 35 °C

Battery Recycling

 This symbol on the battery indicates that the battery must not be disposed of with unsorted common municipal waste. As the end-user, it is your responsibility to dispose of the end-of-life battery in your appliance in an environmentally sensitive manner as follows:

- (1) Returning it to the distributor/dealer from whom you purchased the product or
- (2) Depositing it at a designated collection point

The separate collection and recycling of end-of-life batteries at the time of disposal will help to conserve natural resources and to ensure that it is recycled in a manner that protects human health and the environment. For more information, please contact your local recycling office or the dealer from whom you originally purchased the product. Failure to properly dispose of end-of-life batteries may result in negative potential effects on the environment and human health due to the substances in the batteries and accumulators.

Removing the battery

The information below is only applicable when disposing of or transporting the robot, not for daily operation instructions.

1. Let the robot run to a low battery level where it cannot clean, without attaching to the Auto-empty Station.
2. Turn off the robot.
3. Remove the screws from the bottom cover of the robot.
4. Remove the battery.
5. Press the buckle to pull out the battery connector plug and remove the battery.

Note:

- Make sure the battery is exhausted and the robot is disconnected from the Auto-empty Station when removing the battery.
- Please remove the entire battery pack together, do not damage the battery pack casing to avoid short circuits or leakage of hazardous substances.
- If the battery leaks and accidentally comes into contact, rinse with plenty of water and seek medical attention immediately.

SAVE THESE INSTRUCTIONS









SwitchBot

SwitchBot

SAFETY INFORMATION

Floor Cleaning Robot S20

READ ALL INSTRUCTIONS BEFORE USING

 WARNING: You must read all safety warnings and instructions. Failure to follow the warnings and instructions set out below may result in electric shock, fire and/or serious injury.			
 This is the safety alert symbol. It is used to alert you to potential physical injury hazards. Obey all safety messages that follow this symbol to avoid possible injury or death.			
 Risk of electric shock	 Risk of fire	 Class II appliance	 Keep out of reach of children
 For indoor use only	 Read operator's manual	 Separate collection symbol	
~ ~ ALTERNATING CURRENT symbol [symbol IEC 60417-5032 (2009-02)]			
≡ -- DIRECT CURRENT symbol [symbol IEC 60417-5031 (2009-02)]			
- PROTECTIVE EARTH (Protective Ground) symbol [symbol IEC 60417-5019 (2009-02)]			

 WARNING

General



- This appliance can be used by children aged from 8 years and above and persons with reduced physical, sensory or mental capabilities or lack of experience and knowledge if they have been given supervision or instructions concerning use of the appliance in a safe way and understand the hazards involved. Children shall not play with the appliance. Cleaning and user maintenance shall not be undertaken by children without supervision.
 - Your robot is designed to be plugged into a standard household AC power outlet only.
 - Do not use the Auto-empty Station with a damaged cord or plug.
 - Do not submerge your robot in water.
 - Do not use outdoors or on wet surfaces.
 - Use your robot indoors in a dry location only. Do not handle your robot or Base Station with wet hands due to risk of electric shock.
 - Do not operate the robot in areas with exposed electrical outlets on the floor. Place cords of other appliances away from areas that need cleaning.
 - Do not put any object into openings. Do not use with any opening blocked. Keep free of dust, lint, hair, and anything that may reduce air flow.
 - Keep hair, loose clothing, fingers, and all parts of the body away from openings and moving parts.
 - Use extra care when cleaning on stairs.
 - Do not use to pick up flammable or combustible liquids, such as gasoline, or use in areas where they may be present.
 - Do not use the robot to pick up anything that is burning or smoking, such as cigarettes, matches, or hot ashes.
 - To avoid your robot falling downstairs, ensure that the Base Station is placed at least 4 feet (1.2 meters) away from stairs or suspended areas.
 - If the room to be cleaned contains lit candles on furniture, or equipment, such as stoves, fans, or humidifiers, remove the equipment before operation. There is a risk of injury, accident or malfunction if the robot pushes or knocks over equipment.
- Before using this device, pick up objects like clothing and loose paper. Lift up cords for blinds or curtains, and move power cords and fragile objects out of the way. If this device passes over a power cord and drags it, an object could be pulled off a table or shelf.

- Clean the (edge detection or cliff) sensor lens and cover on the bottom of your robot for dust and dirt buildup as needed to ensure normal operation.
- Do not use without a dust bag and/or filters in place.
- This appliance is intended for household use only.
- Your robot is not a toy. Children and pets should be supervised when your robot is operating. Do not sit or stand on your robot or the Auto-empty Station.
- Keep the charging contacts dry and clean. Failure to maintain the cleanliness of the charging contacts could result in the loss of ability of your robot to charge its battery.
- Please test your robot on a small section of hard floor at home before you start cleaning to ensure that it is compatible and does not harm flooring. Using your robot on a hard floor that is not compatible may result in damage to your device or floor itself. Contact your hard floor manufacturer should you have questions with compatibility.
- Before running your robot on carpets or rugs, ensure that they are compatible with vacuums using bars or brushes. Using your robot on a carpet or rug that is not compatible may result in damage. Contact your carpet or rug manufacturer to find out more.
- Should the robot malfunction, endure damage, or be dropped into water, please discontinue use, and locate a SwitchBot authorized service center.
- This robotic vacuum cleaner contains batteries that are only replaceable by skilled persons. The appliance is only to be used with the power supply unit provided with the appliance. The plug must be removed from the socket-outlet before cleaning or maintaining the appliance. WARNING: For the purposes of recharging the battery, only use the SwitchBot Floor Cleaning Robot S20 Base Station (model: W6602310/W6602320) provided with this appliance.

Base Station



- Do not use the Base Station with a damaged cord or plug. If the supply cord is damaged, it must be replaced by the manufacturer, its service agent or a similarly qualified person in order to avoid hazards.
 - Always disconnect your robot from the Base Station before cleaning or maintaining it. Please unplug the Auto-empty Station from the outlet when not in use and before servicing.
 - The plug must be removed from the socket outlet before cleaning or maintaining the appliance.
 - Only use the provided power supply for charging the robot. The provided power supply delivers a safer extra-low voltage current corresponding to the input marking on the robot which is required to maintain safe operation.
 - Only use the Base Station to charge your robot. Other types of charging may affect your robot's battery or cause injury. Please contact SwitchBot Customer Support should you wish to replace batteries or for other maintenance.
 - Do not use the Base Station to charge non-rechargeable batteries.
 - Turn off all controls before unplugging.
 - Do not pull or carry by cord, use cord as a handle, close a door on cord, or pull cord around sharp edges or corners. Do not run appliances over cord. Keep cord away from heated surfaces.
 - If you live in an area prone to electrical storms, it is recommended that you use additional surge protection. Your Auto-empty Station may be protected with a surge protector in the event of severe electrical storms.
 - If the supply cord is damaged, it must be replaced by the manufacturer, its service agent or similarly qualified persons in order to avoid a hazard.
 - CAUTION: In order to avoid a hazard due to inadvertent resetting of the thermal cut-out, this appliance must not be supplied through an external switching device, such as a timer, or connected to a circuit that is regularly switched on and off by the utility.
 - Maximum inlet water pressure: 0.6Mpa; Minimum inlet water pressure: 0.1Mpa
- The new hose sets supplied with the appliance are to be used and that old hose sets should not be reused.

Battery and Charging



- This appliance contains 1 rechargeable lithium-ion battery with a rated capacity of 4000 mAh.
 - Do not expose a battery pack or appliance to fire or excessive temperature. Exposure to fire or temperature above 130 °C (265 °F) may cause explosion. Before using this product, make sure there are no cords present that may obstruct it.
 - Do not open, crush, heat the battery above 80 °C (176 °F), or incinerate. Follow our user manual for proper use, maintenance, handling, and disposal.
 - Do not use the robot when the surrounding temperature is higher than 40 °C (104 °F), or lower than 4 °C (39 °F), or there is any liquid or sticky substance on the floor.
 - Follow all charging instructions and do not charge the battery pack or appliance outside of the temperature range specified in the instructions. Charging improperly or at temperatures outside of the specified range may damage the battery and increase the risk of fire.
 - Do not allow metal objects to contact battery terminals or immerse the battery in liquid, or the battery may short-circuit. Shorting the battery terminals together may cause burns or a fire. Do not subject batteries to mechanical shock.
 - Check the battery pack for any sign of damage or leakage regularly. Do not charge damaged or leaking battery packs. Damaged or modified batteries may exhibit unpredictable behavior resulting in fire, explosion or risk of injury.
 - Do not allow the battery liquid to come in contact with skin or eyes. If contact has been made, wash the affected area with plenty of water and seek medical attention. Seal the damaged battery in a plastic bag and recycle or dispose of safely according to local environmental regulations, or return it to your local authorized SwitchBot Service Center for disposal.
 - Use the appliance only with specifically designated battery packs. Use of any other battery packs may create a risk of injury and fire.
 - To prevent unintentional starting, ensure the switch is in the off-position before connecting the battery pack before picking up or carrying the appliance. Carrying the appliance with your finger on the switch may cause accidents.
 - Do not modify or attempt to repair the appliance or the battery pack (as applicable) except as indicated in the instructions for use and care.
 - Have servicing performed by a qualified repair person using only identical replacement parts. This will ensure that the safety of the product is maintained.
 - Battery usage by children should be supervised. Seek medical advice immediately if a cell or a battery has been swallowed.
 - Lithium-ion batteries and products that contain lithium-ion batteries are subject to stringent transportation regulations. If you need to ship this product (with the battery included) for service, travel or any other reason, you must follow the Battery Recycling part of this user manual or contact the transportation agent for relevant instructions.
 - If placing the robot into storage, charge it fully and turn it off, then place it in a cool dry place. Recharge it at least every three months to prevent the battery from over-discharging.
- Warning against recharging non-rechargeable batteries

Cleaning Solution



- Be sure to read and follow the directions labeled on the product package carefully to safely use and store the cleaning solution.
- Only use SwitchBot authorized cleaning solution.
- For cleaning solution warnings, please refer to the solution bottle or packaging.