

文件名称: Strip3-SMS-EN-2501	设计师:LSY	完成时间:2025/01/14
版本号: V1.0-2501	成品尺寸:60mm × 90mm	
材质和工艺: 80g书写纸+风琴折+四色+一专 <div>PT 2034C</div>		
更改内容: 备注:此页表格不印刷、红色线框也不做印刷		

SwitchBot LED Strip Light 3

User Manual

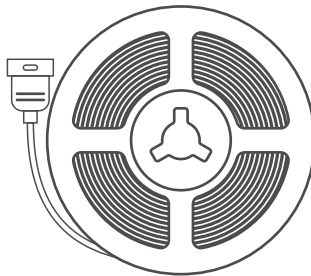

Please read this user manual carefully
before using your device.

Package Contents

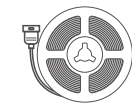

LED Strip Light 3
(5 m/16.4 ft.) × 1



Mounting Buckle × 6
(with screws)



Remote Control × 1

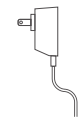

Power Adaptor × 1



Controller × 1

List of Components

Controller Buttons

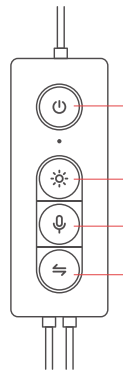

On/Off Button

Brightness Control

Music Mode

Mode Switch Button
· Click once:
Switching scenes
· Hold: Color loop

Preparation

You will need:

- A smartphone or tablet using Bluetooth 4.2 or later.
- The latest version of our app, downloadable via the Apple App Store or Google Play Store.
- A SwitchBot account, you can register via our app or sign in to your account directly if you already have one.

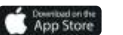

iOS and Android system requirements:
<https://support.switch-bot.com/hc/en-us/articles/12567397397271>



Installation

Before you start:

- Connect your Strip Light 3 to a power supply and check if it can light up normally.
- Open our app and tap the "+" icon located in the right-hand corner of the home page and select Add Device. Find the relevant device icon and select. Then follow the instructions to add your Strip Light 3.
- Make sure your device works normally before installing it.

Steps:

1. Clean the installation surface and ensure that it is dry and clean.



2. Peel off the tape liner on the back and stick your Strip Light 3 onto the installation surface.

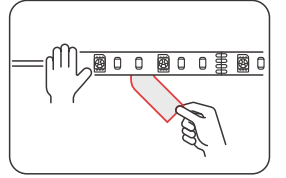

3. You may secure your Strip Light 3 by using the mounting buckles and screws provided, especially at turns.

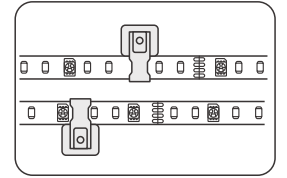

Note: Do not excessively bend this product.

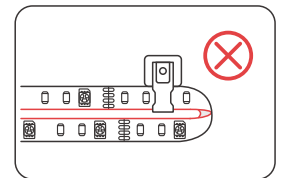

4. Connect the controller to the light as shown.

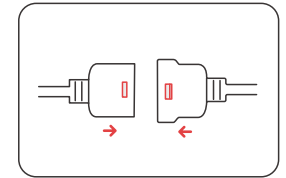

5. Plug your Strip Light 3 in using the power adaptor.

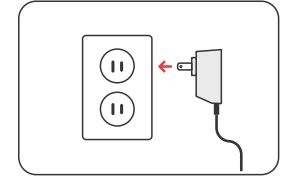

6. Control your Strip Light 3 using the remote control, controller or the app.

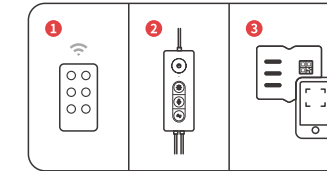

Precautions

- Before using this product, check the electricity voltage. Inappropriate voltage will damage the product and cause safety issues.
- Only cut the Strip Light at the designated point. The cut-off part will not work. Cut the Strip Light only when the power is off. Otherwise, this can lead to a short circuit.
- Please keep the installation surface clean and even for easy adhesion.
- Use the mounting buckles on surfaces such as wallpaper for a more secure installation.
- The LED light's surface is splashproof, but the circuit board beneath is not waterproof. Avoid submerging the product in water.
- Only use the product indoors. When in use, maintain a good airflow for cooling.

- When bending the product during installation, avoid bending the LED parts to maintain a longer product life.
- Never allow children to install this product alone.

Restoring to Factory Settings

Press and hold the On/Off button and Music Mode button simultaneously for 8 seconds until red, green and blue lights flow through your Strip Light 3.

Note: After resetting the device, all settings will resume to default values.

Firmware Upgrades

In order to improve user experience, we will regularly release firmware updates to introduce new functions and solve any software defects that may occur during usage. When a new firmware version is available, we will send an upgrade notification to your account via our app. When upgrading, please make sure your product has sufficient battery or stay powered on and make sure your smartphone is within range to prevent interference.

Troubleshooting

For more information regarding troubleshooting your device, please scan the QR code below.



Specifications

Power: 18 W
Input: 100–240 V~, 50-60 Hz
Color Type:
RGB CW+WW (Cool White + Warm White)
Lumens: 1200 lm
Color Temperature: 2700–6500 K
Strip Width: 12 mm (0.5 in.)
Dimming Range: 1% to 100%
Lifespan: 25000 h
Applicable Environment:
For indoor use only
Operating Temperature:
0 °C to 40 °C (5 °F to 113 °F)
Operating Humidity: 0 to 99% RH
Connectivity: 2.4 GHz Wi-Fi+Bluetooth 4.2

Warranty

We warrant to the original owner of the product that the product will be free from defects in materials and workmanship for a period of one year from the date of purchase. Please note that this limited warranty does not cover:

1. Products submitted beyond the original one-year limited warranty period.
2. Products on which repairs or modifying have been attempted.
3. Products subjected to falls, extreme temperatures, water, or other operating conditions outside the product specifications.
4. Damage due to natural disaster (including but not limited to lightning, flood, tornado, earthquake, or hurricane, etc.).
5. Damage due to misuse, abuse, negligence or casualty (e.g. fire).

6. Other damage that is not attributable to defects in the manufacture of product materials.
7. Products purchased from unauthorized resellers.
8. Consumable parts (including but not limited to batteries).
9. Natural wear of the product.

Contact & Support

Feedback: If you have any concerns or problems when using our products, please send feedback via our app through the Profile > Support page.

Setup and Troubleshooting:
[support.switch-bot.com](mailto:support@switch-bot.com)
Support Email: support@switch-bot.com

文件名称: Lighting Products-合规声明-7in1-2502	设计师: LBY	完成时间: 2025/02/07
版本号: V1.0-Lighting Products-HGSM-2502	成品尺寸: 58*58mm	
材质工艺: 80g书写纸+印黑色+风琴折 <div></div> K=90		
更改内容: 备 注:蓝色线框为折页线，不印刷；本表格不印刷。		

SwitchBot Regulatory Compliance Information

EN CE Warning

To comply with RF exposure requirements, a minimum separation distance of 20 cm must be maintained between the user's body and the device, including the antenna. Use only the supplied or an approved antenna. This device is in compliance with the essential requirements and other relevant provisions of directive 2014/53/EU. All essential radio test suites have been carried out.

CE DOC

Hereby, Woan Technology (Shenzhen) Co., Ltd. declares that the radio equipment type is in compliance with Directive 2014/53/EU. The full text of the EU declaration of conformity is available at the following internet address: support.switch-bot.com

This product can be used in EU member states and UK.

Manufacturer: Woan Technology (Shenzhen) Co., Ltd.

Address: Room 1101, Qiancheng Commercial Center, No. 5 Haicheng Road, Mabu Community, Xixiang Subdistrict, Bao'an District, Shenzhen, Guangdong, P.R.China, 518100

E-mail: support@switch-bot.com

CE representative: XDH Tech

Address: 2 Rue Coysevox Bureau 3, Lyon, France

E-mail: xdh.tech@outlook.com

Operation frequency (Max power)

2.4GHz Wi-Fi:

Frequency band(s): 2412-2472 MHz

Maximum RF power transmitted: <20dBm (e.i.r.p.)

2.4GHz Bluetooth:

Frequency band(s): 2402-2480 MHz

Maximum RF power transmitted: <10dBm (e.i.r.p.)

Operation temperature: 0 °C to 40 °C

FCC Warning

This device complies with Part 15 of the FCC Rules. Operation is subject to the following two conditions:

(1) This device may not cause harmful interference.

(2) This device must accept any interference received, including interference that may cause undesired operation.

NOTE: This equipment has been tested and found to comply with the limits for a Class B digital device, pursuant to part 15 of the FCC Rules. These limits are designed to provide reasonable protection against harmful interference in a residential installation.

This equipment generates, uses, and can radiate radio frequency energy and, if not installed and used in accordance with the instructions, may cause harmful interference to radio communications. However, there is no guarantee that interference will not occur in a particular installation. If this equipment does cause harmful interference to radio or television reception, which can be determined by turning the equipment off and on, the user is encouraged to try to correct the interference by one or more of the following measures:

- Reorient or relocate the receiving antenna.

- Increase the separation between the equipment and receiver.

- Connect the equipment into an outlet on a circuit different from that to which the receiver is connected.

- Consult the dealer or an experienced radio/TV technician for help.

NOTE: The manufacturer is not responsible for any radio or TV interference caused by unauthorized modifications to this equipment. Such modifications could void the user's authority to operate the equipment.

Radiation Exposure Statement

This equipment complies with FCC radiation exposure limits set forth for an uncontrolled environment. This equipment should be installed and operated with minimum distance 20 cm between the radiator and your body.

DE CE-Warnung

Um die Anforderungen an die HF-Exposition zu erfüllen, muss ein Mindestabstand von 20 cm zwischen dem Körper des Benutzers und dem Gerät, einschließlich der Antenne, eingehalten werden. Verwenden Sie nur die mitgelieferte oder eine zugelassene Antenne. Dieses Gerät entspricht den grundlegenden Anforderungen und anderen relevanten Bestimmungen der Richtlinie 2014/53/EU. Alle wesentlichen Funktestreihen wurden durchgeführt.

CE-DOC

Hiermit erklärt Woan Technology (Shenzhen) Co., Ltd. dass die Funkanlage mit der Richtlinie 2014/53/EU übereinstimmt. Der vollständige Text der EU-Konformitätserklärung ist unter der folgenden Internetadresse verfügbar: support.switch-bot.com

Dieses Produkt kann in den EU-Mitgliedsstaaten und in Großbritannien verwendet werden.

Hersteller: Woan Technology (Shenzhen) Co., Ltd.

Adresse: Raum 1101, Qiancheng Commercial Center, Nr. 5 Haicheng Road, Mabu Community, Xixiang Subdistrict, Bao'an District, Shenzhen, Guangdong, P.R.China, 518100

E-mail: support@switch-bot.com

CE-Vertreter: XDH Tech

Anschrift: 2 Rue Coysevox Bureau 3, Lyon, Frankreich

E-mail: xdh.tech@outlook.com

Betriebsfrequenz (Maximale Leistung)

2,4 GHz Wi-Fi:

Frequenzband: 2412-2472 MHz

Maximale übertragene HF-Leistung: <20 dBm (e.i.r.p.)

2,4 GHz Bluetooth:

Frequenzband: 2402-2480 MHz

Maximale übertragene HF-Leistung: <10 dBm (e.i.r.p.)

Betriebstemperatur: 0 °C bis 40 °C

FR Avertissement CE

Pour respecter les exigences en matière d'exposition aux radiofréquences, une distance de séparation minimale de 20 cm doit être maintenue entre le corps de l'utilisateur et l'appareil, y compris l'antenne. N'utilisez que l'antenne fournie ou une antenne approuvée. Cet appareil est conforme aux exigences essentielles et aux autres dispositions pertinentes de la directive 2014/53/UE. Toutes les suites de tests radio essentiels ont été effectuées.

CE DOC

Par la présente, Woan Technology (Shenzhen) Co, Ltd déclare que le type d'équipement radio est conforme à la directive 2014/53/UE. Le texte intégral de la déclaration de conformité UE est disponible à l'adresse internet suivante : support.switch-bot.com.

Ce produit peut être utilisé dans les États membres de l'UE et au Royaume-Uni.

Fabricant : Woan Technology (Shenzhen) Co, Ltd.

Adresse : Appartement 1101, Centre Commercial de Qiancheng, No. 5 de la route de Haicheng, Communauté de Mabu, Sub-district de Xixiang, District de Bao'an, Shenzhen, Guangdong, République populaire de Chine, 518100

E-mail: support@switch-bot.com

Représentant CE : XDH Tech

Adresse : 2 Rue Coysevox Bureau 3, Lyon, France

E-mail: xdh.tech@outlook.com

Fréquence de fonctionnement (Puissance maximale)

Wi-Fi 2,4 GHz:

Plage de fréquences: 2412-2472 MHz

Puissance RF maximale transmise: <20 dBm (PIRE)

Bluetooth 2,4 GHz:

Plage de fréquences: 2402-2480 MHz

Puissance RF maximale transmise: <10 dBm (PIRE)

Température de fonctionnement : 0 à 40 °C

ES Advertencia CE

Para cumplir con los requisitos de exposición a RF, se debe mantener una distancia mínima de separación de 20 cm entre el cuerpo del usuario y el dispositivo, incluyendo la antena. Utilice solo la antena suministrada o una aprobada. Este dispositivo cumple con los requisitos esenciales y otras disposiciones relevantes de la directiva 2014/53/UE. Se han llevado a cabo todas las pruebas de radio esenciales.

DOC CE

Por la presente, Woan Technology (Shenzhen) Co., Ltd. declara que el equipo de radio cumple con la Directiva 2014/53/UE. El texto completo de la declaración de conformidad de la UE está disponible en la siguiente dirección de internet: support.switch-bot.com

Este producto puede ser utilizado en los estados miembros de la UE y el Reino Unido.

Fabricante: Woan Technology (Shenzhen) Co., Ltd.

Dirección: Sala 1101, Centro Comercial Qiancheng, No. 5 Haicheng Road, Comunidad Mabu, Subdistrito Xixiang, Distrito Bao'an, Shenzhen, Guangdong, P.R.China, 518100

E-mail: support@switch-bot.com

Representante CE: XDH Tech

Dirección: 2 Rue Coysevox Bureau 3, Lyon, Francia

E-mail: xdh.tech@outlook.com

Frecuencia de Operación (Potencia máxima)

Wi-Fi de 2,4 GHz:

Banda de frecuencias: 2412-2472 MHz

Potencia máxima de RF transmitida: <20 dBm (PIRE)

Bluetooth de 2,4 GHz:
Banda de frecuencias: 2402–2480 MHz
Potencia máxima de RF transmitida: <10 dBm (PIRE)
Temperatura de operación: 0 a 40 °C

NL CE Waarschuwing

Om te voldoen aan de RF-blootstellingsvereisten, moet een minimale afstand van 20 cm worden aangehouden tussen het lichaam van de gebruiker en het apparaat, inclusief de antenne. Gebruik alleen de meegeleverde of een goedgekeurde antenne. Dit apparaat voldoet aan de essentiële eisen en andere relevante bepalingen van richtlijn 2014/53/EU. Alle essentiële radiotestreeksen zijn uitgevoerd.

CE DOC

Hierbij verklaart Woan Technology (Shenzhen) Co., Ltd. dat de radiouitrusting van het type voldoet aan Richtlijn 2014/53/EU. De volledige tekst van de EU-verklaring van conformiteit is beschikbaar op het volgende internetadres: support.switch-bot.com

Dit product kan worden gebruikt in EU-lidstaten en het Verenigd Koninkrijk.

Fabrikant: Woan Technology (Shenzhen) Co., Ltd.

Adres: Kamer 1101, Qiancheng Commercial Center, Nr. 5 Haicheng Road, Mabu Community, Xixiang Subdistrict, Bao'an District, Shenzhen, Guangdong, V.R. China, 518100

E-mail: support@switch-bot.com

CE-vertegenwoordiger: XDH Tech

Adres: 2 Rue Coysevox Bureau 3, Lyon, Frankrijk

E-mail: xdh.tech@outlook.com

Werkfrequentie (Maximale vermogen)

2,4 GHz Wi-Fi:

Frequentieband(en): 2412–2472 MHz

Maximaal verzonden RF-vermogen: <20 dBm (e.i.r.p.)

2,4 GHz Bluetooth:
Frequentieband(en): 2402–2480 MHz
Maximaal verzonden RF-vermogen: <10 dBm (e.i.r.p.)
Bedrijfstemperatuur: 0 tot 40 °C

IT Avvertenza di CE

Per rispettare i requisiti di esposizione alle radiofrequenze, è necessario mantenere una distanza minima di 20 cm tra il corpo dell'utente e il dispositivo, compresa l'antenna. Utilizza esclusivamente l'antenna in dotazione o un'antenna approvata. Questo dispositivo è conforme ai requisiti essenziali e alle altre disposizioni pertinenti della direttiva 2014/53/UE. Sono state eseguite tutte le suite di test radio essenziali.

DOC CE

Con la presente, Woan Technology (Shenzhen) Co., Ltd. dichiara che il tipo di apparecchiatura radio è conforme alla Direttiva 2014/53/UE. Il testo completo della dichiarazione di conformità UE è disponibile al seguente indirizzo internet: support.switch-bot.com

Questo prodotto può essere utilizzato negli Stati membri dell'UE e nel Regno Unito.

Produttore: Woan Technology (Shenzhen) Co., Ltd.

Indirizzo: Room 1101, Qiancheng Commercial Center, No. 5 Haicheng Road, Mabu Community, Xixiang Subdistrict, Bao'an District, Shenzhen, Guangdong, P.R.China, 518100

E-mail: support@switch-bot.com

Rappresentante CE: XDH Tech

Indirizzo: 2 Rue Coysevox Bureau 3, Lione, Francia

E-mail: xdh.tech@outlook.com

Frequenza di funzionamento (Potenza massima)

Wi-Fi 2,4 GHz:

Bande di frequenza: 2412–2472 MHz

Potenza RF massima trasmessa: <20 dBm (PIRE)
Bluetooth 2,4 GHz:
Bande di frequenza: 2402–2480 MHz
Potenza RF massima trasmessa: <10 dBm (PIRE)
Temperatura di funzionamento: da 0 a 40 °C

PL Ostrzeżenie CE

Aby zachować zgodność z wymogami dotyczącymi ekspozycji na fale radiowe, należy zachować minimalną odległość 20 cm między ciałem użytkownika a urządzeniem, w tym anteną. Należy używać wyłącznie dostarczonej lub zatwierdzonej anteny. To urządzenie jest zgodne z zasadniczymi wymaganiami i innymi stosownymi postanowieniami dyrektywy 2014/53/UE. Przeprowadzono wszystkie niezbędne testy radiowe.

DOC CE

Niniejszym firma Woan Technology (Shenzhen) Co., Ltd. oświadcza, że urządzenie radiowe typu SwitchBot jest zgodne z dyrektywą 2014/53/UE. Pełny tekst deklaracji zgodności UE jest dostępny pod następującym adresem internetowym: support.switch-bot.com

Ten produkt może być używany w państwach członkowskich UE i Wielkiej Brytanii.

Producent: Woan Technology (Shenzhen) Co, Ltd.

Adres: Room 1101, Qiancheng Commercial Center, No. 5 Haicheng Road, Mabu Community, Xixiang Subdistrict, Bao'an District, Shenzhen, Guangdong, P.R.China, 518100

E-mail: support@switch-bot.com

Przedstawiciel CE: XDH Tech

Adres: 2 Rue Coysevox Bureau 3, Lyon, Francja

E-mail: xdh.tech@outlook.com

Częstotliwość pracy (maks. moc)
Wi-Fi 2,4 GHz:
Pasma(a) częstotliwości: 2412-2472 MHz
Maksymalna przesyłana moc RF: <20dBm (e.i.r.p.)
Bluetooth 2,4 GHz:
Pasma(a) częstotliwości: 2402-2480 MHz
Maksymalna przesyłana moc RF: <10dBm (e.i.r.p.)
Temperatura pracy: 0 °C do 40 °C