

User manual

Model:Y-ES0201

Brand:Yiimix

CONTENTS

03	OVERVIEW- ELECTRICAL BOARD
04	OVERVIEW- REMOTE CONTROL
05	CHARGE PROCEDURE
06	QUICKSTART
08	WARNING AND NOTE



IP54 Water Resistant



18 Mile Range



330Lbs Max Carry



15 Incline



LED Head Lights / Tail Lights



Offroad Capable



Wireless Remote



Sharp Cornering

OVERVIEW- ELECTRICAL BOARD

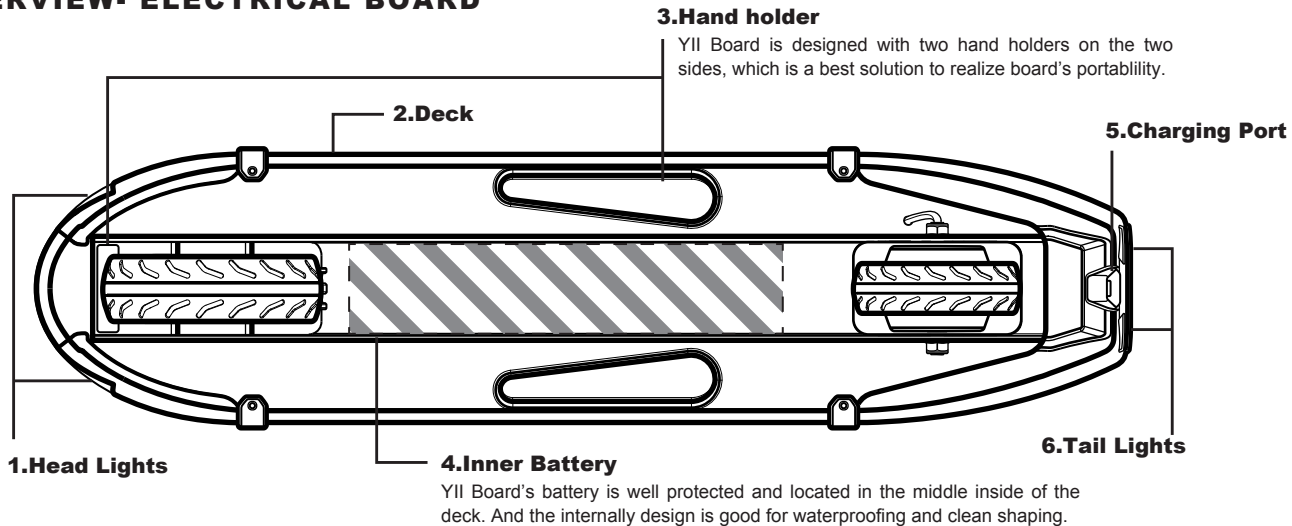

OVERVIEW- REMOTE CONTROL

1.ANTENNA

NOTE: Antenna is placed in the top inside. Please don't cover the top while operating.

2.INDICATORS

Indicate the power status of board and remote control.

3.POWER ON/OFF

4.SPEED MODE SWITCH

Fast Speed Mode: About 20KM/h

Low Speed Mode: About 12KM/h

Changing speed mode should be operated before powering the remote.

5.USB CHARGING PORT

6.THROTTLE/BRAKE

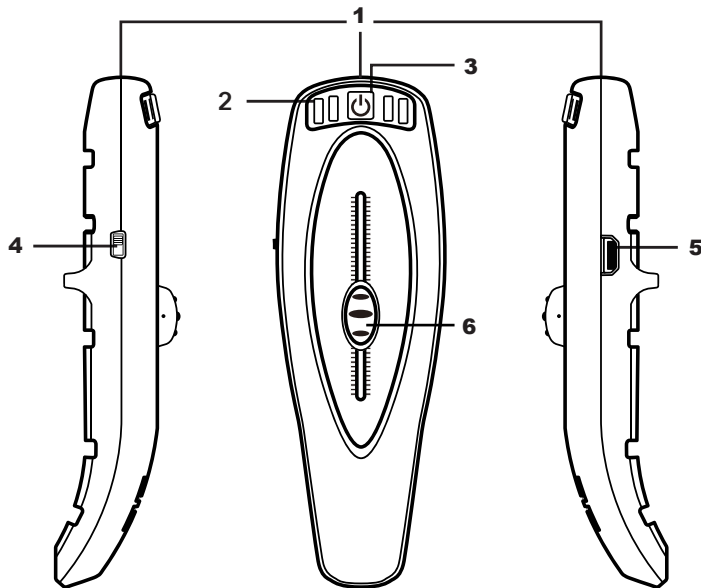

CHARGE PROCEDURE

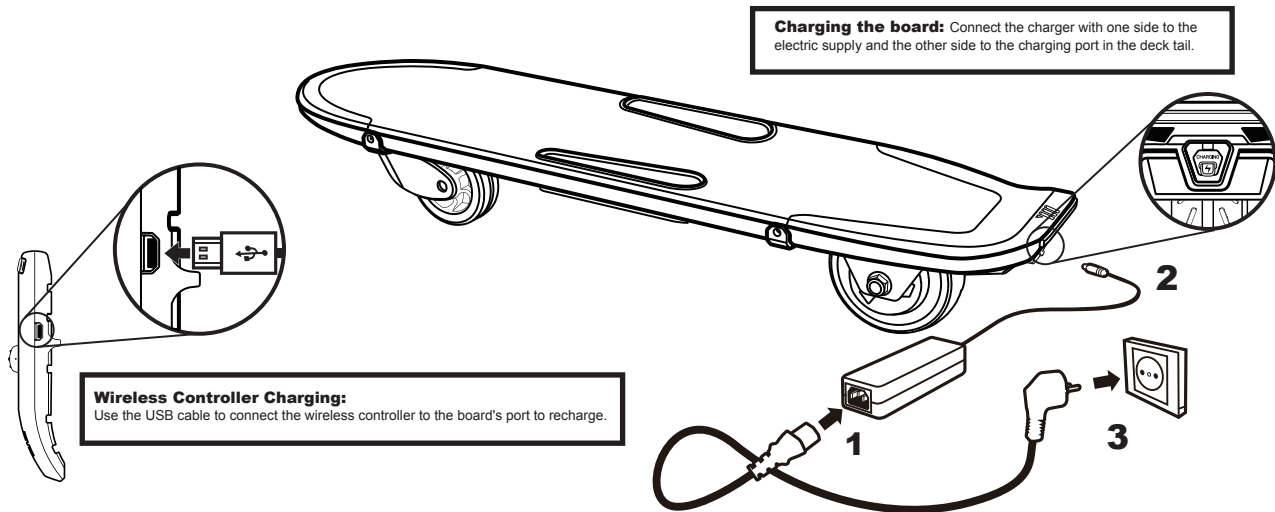

QUICKSTART

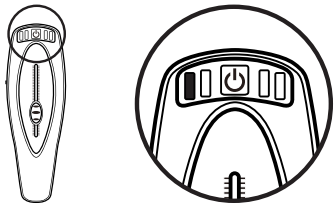

1 Start the board with pressing on the Power button on the top. After starting, the boards head and tail indicators will turn on.

NOTE:

Power on the wireless control with the throttle located in the middle. The left first indicator will fast flash in green while throttle not in the middle.

All indicators slowly flash in green: Indicates the connection between wireless controller and the board is failed, please move the wireless controller close to the board.

All indicators in green: Fully charged. The indicators go out as the power is deducing.

Only left first indicator in green: Low power. The speed will slowly reduce to the low-speed mode, but the brake still as strong as under the high-speed mode.

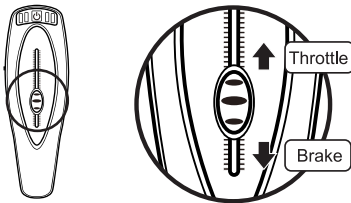

2 Push the throttle to the front, the more you pushed the faster you will go. Pull the throttle to the back, the more you pull the stronger brake you will get.

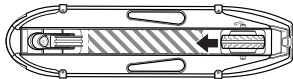

4 Lithium-ion battery should be kept with 70% power capacity while long time no using. Please avoid to keep it with lower battery in long time (more than two weeks). And recharge/discharge the battery every 3 months.

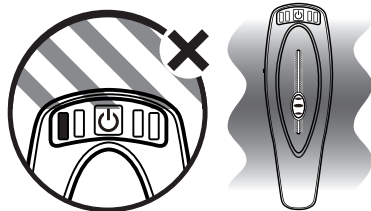

3 Antenna is placed in the top inside. Please don't cover the top while operating.

Wireless controller vibrates: Indicating that the connection between controller and board is not good or failed. The board will go on without power supply after 0.5s disconnection until successfully reconnected.

QUICKSTART

NOTE:

The lithium-ion battery will normally lose power in low temperature. The battery capacity in winter is less than in summer which will automatically recovered as temperature going high.

Low-Temp Protection: The battery will go with Low Temperature Protection at -10 C which will automatically recovered as temperature going high.

High-Temp Protection: The battery will go with High Temperature Protection at 40 C which will automatically recovered as temperature going low.

5 The board may go into over-heat protection after long time riding. This is normal after up-climbing in summer or riding on rocky road. The board will recovered automatically after a rest.

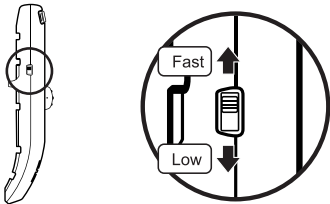

6 Speed Mode Switch

Fast Speed Mode: About 20KM/h

Low Speed Mode: About 12KM/h

NOTE: Changing speed mode should be operated before powering the remote. The speed, accelerated speed and brake in low speed mode are weaker than in fast speed mode.

7 For beginners, it is better to step on the proper area of the deck. Similar to the ski-board, keeping the feet in the middle of the front and back wheels to stand stably on the board and avoid turning up on one side.

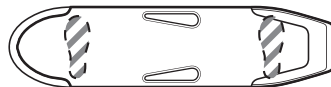

8 The head and tail indicators are on and can not be turned off while powered on. The tail indicator will be brighter while breaking which is not a waste of power.

9 It is not safe to ride on the slippery road in rain. And also reduce the life of the board. Please not to ride in rain and keep the board dry.

10 Please always wear protective equipments and ride in familiar circumstance without traffic.

11 Please always check your board before riding to ensure safety. Any problem, please feel free to contact us, and thanks for your support!

WARNING AND NOTE

NOTE: Instructions, which if not properly followed, would cause possible damages to property and/or little to no possible injuries.

WARNING: Skateboarding, like all sports, carries inherent risk or injury. The rider may lose balance and fall off while riding this electric skateboard, which would cause serious injury or even death. Always skate within your abilities. Learn to stop (slide) and don't skate in traffic or other hazardous situations that may increase your risk.。

- The YllBoard is designed for one-person riding.
- Please always wear protective equipment such as helmet, pads etc. to limit your risk.
- Please ride on flat pavement in open space.
- Please don't try longboard tricks such as jump, slides to avoid injuries to yourself or damage to the board.
- Please check your shoelace before riding and pay special attention not to let it get involved in wheels or power system which may cause fatal consequences.
- Please ride with care and concentration.
- Please check the board condition before riding.
- Please obey local laws, regulations and ride this electric skateboard where you are allowed to.
- Please ride outdoor in suitable environment. Riders can speed up with remote after standing steadily on the board.

- Never ride on rough roads with potholes, gallets, grits or silt or slippery grounds such as snowfield, ice ground to avoid falling off.
- Never touch power wheel with bare hands while or once after riding. This could lead to burns and injuries.
- Never use the board at night or under the condition of poor visibility.
- Never ride in rain and snow.
- Never use your mobile phone or earphone while riding.
- Never place the board within the reach of children under 8 years old. Not recommended for children under 16 years old.
- Never speed up in a rush.

Frequency Range:2402~2479 MHz

Modulation Technique:GFSK

Antenna Type:Dipole antenna

Antenna Gain (dBi):0 dBi

FCC Caution.

This device complies with part 15 of the FCC Rules. Operation is subject to the following two conditions: (1) This device may not cause harmful interference, and (2) this device must accept any interference received, including interference that may cause undesired operation.

Any Changes or modifications not expressly approved by the party responsible for compliance could void the user's authority to operate the equipment.

Note: This equipment has been tested and found to comply with the limits for a Class B digital device, pursuant to part 15 of the FCC Rules. These limits are designed to provide reasonable protection against harmful interference in a residential installation. This equipment generates uses and can radiate radio frequency energy and, if not installed and used in accordance with the instructions, may cause harmful interference to radio communications. However, there is no guarantee that interference will not occur in a particular installation. If this equipment does cause harmful interference to radio or television reception, which can be determined by turning the equipment off and on, the user is encouraged to try to correct the interference by one or more of the following measures:

- Reorient or relocate the receiving antenna.
- Increase the separation between the equipment and receiver.
- Connect the equipment into an outlet on a circuit different from that to which the receiver is connected.
- Consult the dealer or an experienced radio/TV technician for help.