



Bluetooth Keyboard for smart phone

## P1-S6-User Guide

The Samsung Galaxy S6 is used as the basis for this guide.

Contact us at: [www.ezicaretech.com/contact-us/](http://www.ezicaretech.com/contact-us/)

Or write to us at: [support@ezicaretech.com](mailto:support@ezicaretech.com)

Visit us at: [www.ezicaretech.com](http://www.ezicaretech.com)

**Edition 2: 08/October/2016**



## **Contents – Bluetooth Keyboard for smart phone User Guide**

<b>1</b>	<b>Bluetooth Keyboard for smart phone Introduction .....</b>	<b>5</b>
1.1	Bluetooth Keyboard for smart phone Exceptions .....	6
<b>2</b>	<b>Bluetooth Keyboard for smart phone – Package.....</b>	<b>7</b>
<b>3</b>	<b>Before using the Bluetooth Keyboard for smart phone do the following:.....</b>	<b>7</b>
3.1	Bluetooth Keyboard for smart phone –Overview .....	8
3.2	Inserting the phone in Bluetooth Keyboard for smart phone .....	8
3.3	Ezi-Pad – Battery status .....	8
3.4	Bluetooth Keyboard for smart phone – Layout: Front Cover .....	9
3.5	Bluetooth Keyboard for smart phone – Layout: Keyboard .....	10
3.6	Bluetooth Keyboard for smart phone – Other keys and descriptions.....	10
3.7	Turning the EZI-PAD ON and OFF.....	12
3.7.1	Turning ON the Bluetooth Keyboard for smart phone .....	12
3.7.2	Turning OFF the Bluetooth Keyboard for smart phone.....	12
3.7.3	When the phone or Bluetooth is turned OFF and ON .....	12
3.7.4	Accessing settings on the phone .....	12
<b>4</b>	<b>Bluetooth Keyboard for smart phone – Pairing and connecting to the smartphone.....</b>	<b>12</b>
<b>5</b>	<b>Telephone Settings .....</b>	<b>15</b>
5.1	Phone Language Settings: Phone and External keyboard (Bluetooth Keyboard for smart phone).....	15
5.2	Phone settings – Home key to answer call, Power key to End call .....	19
<b>6</b>	<b>Using Bluetooth Keyboard for smart phone with EziSmart App .....</b>	<b>22</b>
6.1	Introduction to EziSmart App .....	22
6.2	Features in EziSmart App .....	22
6.3	Navigating around EziLaunch screen using Bluetooth Keyboard for smart phone .....	24
6.4	Calling, SMS and Email –without using touch.....	24
6.4.1	Calling using Navigation and Enter keys .....	24
6.4.2	Write SMS –using Navigation and Enter keys.....	25
6.4.3	Write Email –using Navigation and Enter keys.....	25
6.5	Short cut to activate the direct access apps.....	25
<b>7</b>	<b>Hints &amp; Problems .....</b>	<b>26</b>
7.1	Taking a picture – made easy .....	26
7.2	Recommendations for on-screen keyboard .....	26

7.3	Telephone does not work .....	26
7.4	Difficult to pair up .....	27
7.5	Keyboard does not work.....	27
7.6	Charging stand .....	27
7.7	Call answer and call end keys do not work.....	28
7.8	Bluetooth Keyboard for smart phone – manual language set up .....	28
7.9	Combination of Bluetooth Keyboard for smart phone and on-screen keyboard .....	28
7.9.1	On-screen keyboard not visible .....	28
7.9.2	Not valid keyboard symbols.....	28
8	Contact us .....	29
9	Other guides and informartion .....	29
10	Handling instructions .....	30
10.1	Battery .....	30
10.1.1	Bluetooth Keyboard for smart phone – battery charging.....	30
10.2	Material .....	30
10.3	Connectors, ports, and buttons. ....	30
10.4	Safety information.....	30
10.5	Usage environment .....	31
10.6	Operating and storage environment.....	31
10.6.1	Operating temperature .....	31
10.6.2	Local rules and laws.....	31
10.6.3	Magnetic media.....	31
10.6.4	Electronics equipment.....	31
10.6.5	Pacemaker .....	31
10.6.6	Other medical equipment .....	32
10.6.7	Dangerous environment.....	32
10.6.8	Precautions.....	32
10.6.9	Disposal .....	32

## Table of Figures

Figure 1 - Contents of Bluetooth Keyboard for smart phone package.....	7
Figure 2- Inserting phone into Bluetooth Keyboard for smart phone casing.....	8
Figure 3 - Charging Bluetooth Keyboard for smart phone .....	8

Figure 4 - Front Cover .....	9
Figure 5 - Keyboard .....	10
Figure 6 - Keyboard other features.....	12
Figure 7 - Opening settings .....	12
Figure 8 - Pairing and Connecting.....	15
Figure 9 - Phone's Language and external keyboard settings .....	19
Figure 10 - Home key to answer call, power key to end call .....	21
Figure 11 - EziSmart App .....	22
Figure 12 - Move around the screen using navigation buttons.....	24
Figure 13 - Call using Navigation and Enter keys.....	24
Figure 14 - Write SMS using Navigation and Enter keys.....	25
Figure 15 - Write Email using Navigation and Enter keys.....	25
Figure 16 - Keyboard short cots for apps.....	26
Figure 17- Google keyboard with predictive text .....	26
Figure 18 - Installing Google keyboard .....	26
Figure 19 - Restarting keyboard.....	27

## **1 Bluetooth Keyboard for smart phone Introduction**

The Bluetooth Keyboard for smart phone is made for people who cannot use the smartphone's screen or the touch keyboard.

It has large keys and is ergonomically designed to meet several needs:

- a) For large fingers
- b) For shaky hands, provide easy localisation and stabilisation of the finger
- c) Retain some easy to use function keys from feature phones
- d) Make accessible some control buttons in the smartphone which are otherwise difficult to use
- e) A learning tool for smartphone usage

## **1.1 Bluetooth Keyboard for smart phone Exceptions**

The Bluetooth Keyboard for smart phone has 3 casing variants for:

A3 (6), Galaxy S4, Galaxy S6

Bluetooth Keyboard for smart phone gives accessibility for texting for users who cannot use the on screen keyboard for whatever reason. However, Ezi-Pad is best used in combination with touch, for example when the area to be touched is large and accessible.

The Bluetooth Keyboard for smart phone when operated together with the EziSmart App provides further ease of use enhancements.

The Bluetooth Keyboard for smart phone working without the Ezi-Smart App has limitations which are:

- 1) The SOS button will not work without the EziSmart App
- 2) The Flashlight button will not work without the EziSmart App
- 3) The Recording short cut button will not work without the EziSmart App

*Note:*

*When using the Bluetooth Keyboard for smart phone access to the headset connector is inaccessible. You will need to use a Bluetooth headset.*

## Bluetooth Keyboard for smart phone – Package

**The Bluetooth Keyboard for smart phone package includes:**

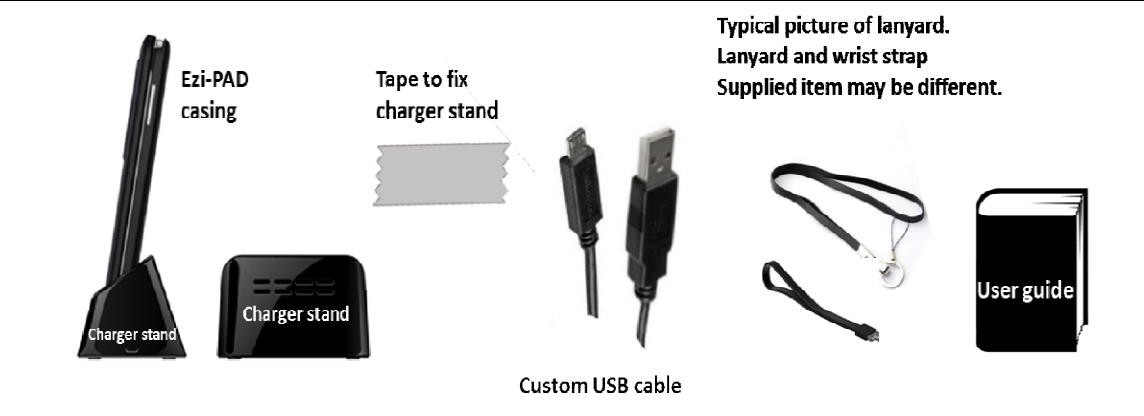
1 x Bluetooth Keyboard for smart phone casing	1 x charging stand
1 x lanyard	1 x wrist strap
1 x custom usb cable (Charge the phone only, when in the casing: use this custom usb cable)	
1 x double sided tape for fixing the charger on a flat surface	
1 x User guide	
	

**Figure 1 - Contents of Bluetooth Keyboard for smart phone package**

## **2 Before using the Bluetooth Keyboard for smart phone do the following:**

a.	Insert your SIM card into the phone (if you have not already done so).
b.	Insert your phone into the Bluetooth Keyboard for smart phone casing. Ref: Section 2.2
c.	Charge the Bluetooth Keyboard for smart phone and the phone. Connect the phone's mains adapter to the charging stand and plug the Bluetooth Keyboard for smart phone with the phone into the charging stand. Ref: Section 2.3
d.	Turn ON the Bluetooth Keyboard for smart phone. Ref. Section 3.2.1
e.	Pair (Bluetooth) and connect the Bluetooth Keyboard for smart phone to the phone. Ref: Section4
f.	Set the language of the Bluetooth Keyboard for smart phone to be the same as the phone. Ref: Section5.1
g.	Set the call answer and call end features in the phone. Ref: Section5.2
h.	To get the most out of Bluetooth Keyboard for smart phone, spend some time going through this guide .

**You can start using the Bluetooth Keyboard for smart phone after you have been through 3a to 3g.**

## 2.1 Bluetooth Keyboard for smart phone –Overview

## 2.2 Inserting the phone in Bluetooth Keyboard for smart phone

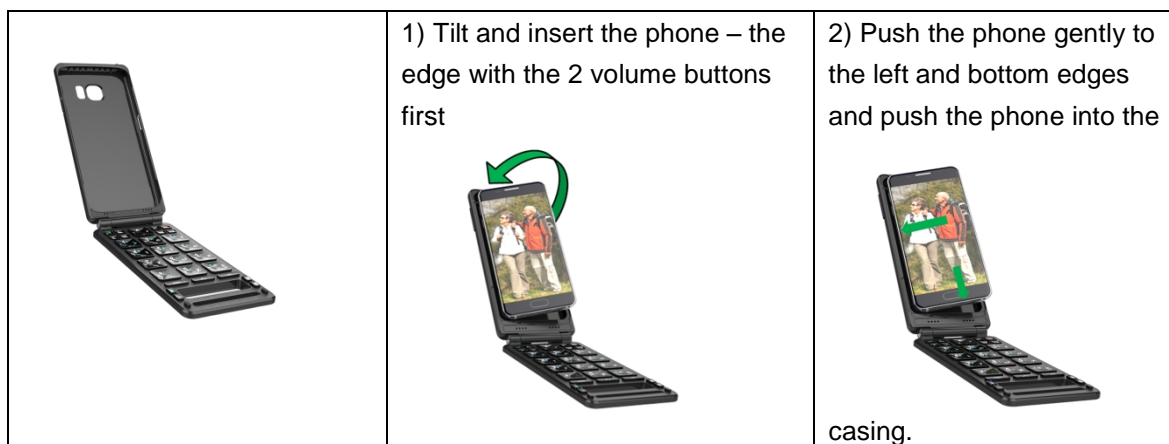

Figure 2- Inserting phone into Bluetooth Keyboard for smart phone casing

## 2.3 Ezi-Pad – Battery status

Refer to Figure 4

Refer to Bluetooth Keyboard for smart phone – Charging

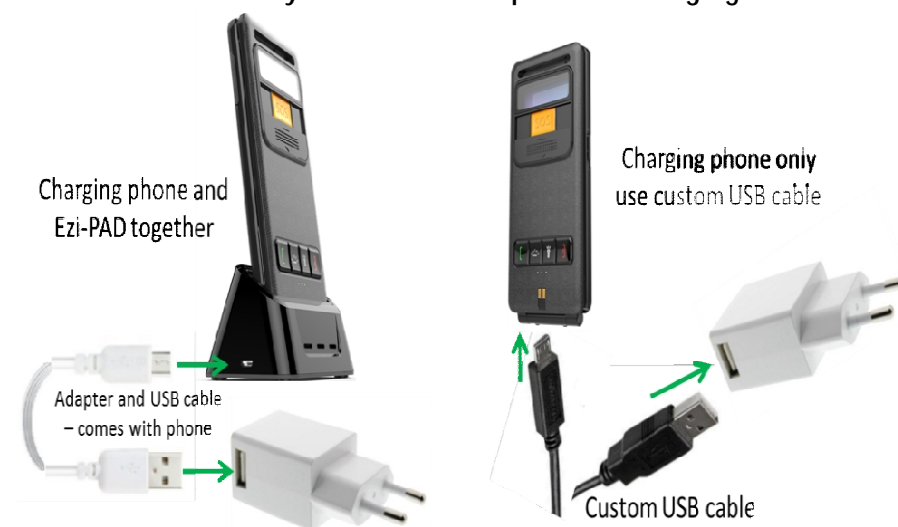

Figure 3 - Charging Bluetooth Keyboard for smart phone

Note:

*The Bluetooth Keyboard for smart phone casing has an inbuilt battery. The battery lasts typically more than 5 days in normal usage. The Smartphone battery typically lasts about 2 days in normal use.*

**Charging both the smartphone and battery in the Bluetooth Keyboard for smart phone:**

Use the charger stand.

**Warning:** if it is the very first time you use the charger after installing the phone be very careful when you are plugging the Bluetooth Keyboard for smart phone assembly into the charging stand.



Plug the Bluetooth Keyboard for smart phone into the charger. Give it a gentle push downwards. The green light on the front cover comes ON indicating charging of the Bluetooth Keyboard for smart phone. You should also hear a sound from the phone indicating charging of the phone. Make sure the phone's volume is audible.

#### Charging the smartphone only (while it is in the Bluetooth Keyboard for smart phone casing):

Use the custom USB cable.

Take good care of this custom cable. The connector is extended for making contact with the phone through the Bluetooth Keyboard for smart phone casing.

#### 2.4 Bluetooth Keyboard for smart phone – Layout: Front Cover

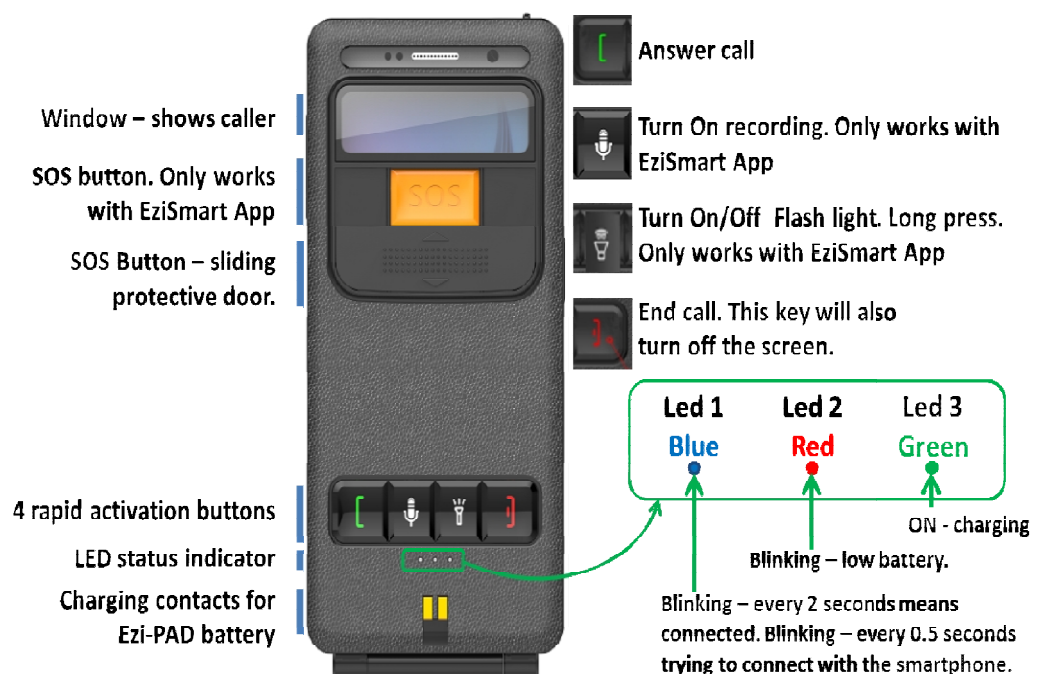

Note: When all lights are off can mean:

- Ezi-PAD switched off. Switch ON by Long press on Answer button
- Needs charging

Figure 4 - Front Cover

Notes:

- The headset connector is not accessible when the phone is in the Bluetooth Keyboard for smart phone casing.
- The SOS, Recording and the Flash light buttons will only work when the EziSmart app is installed as the default launcher.
- The Recording button is a short cut to call up the recording function. Press and hold for about 4 seconds until there is a vibration and a soft audio indication – this call up the

recording app. Open the casing, tap and activate recording on the screen.

- d) The call answer and end call buttons uses the Samsung's call handling features which are set in the Accessibility app.



Settings>Accessibility>Answering and ending calls

### 3 Bluetooth Keyboard for smart phone – Layout: Keyboard

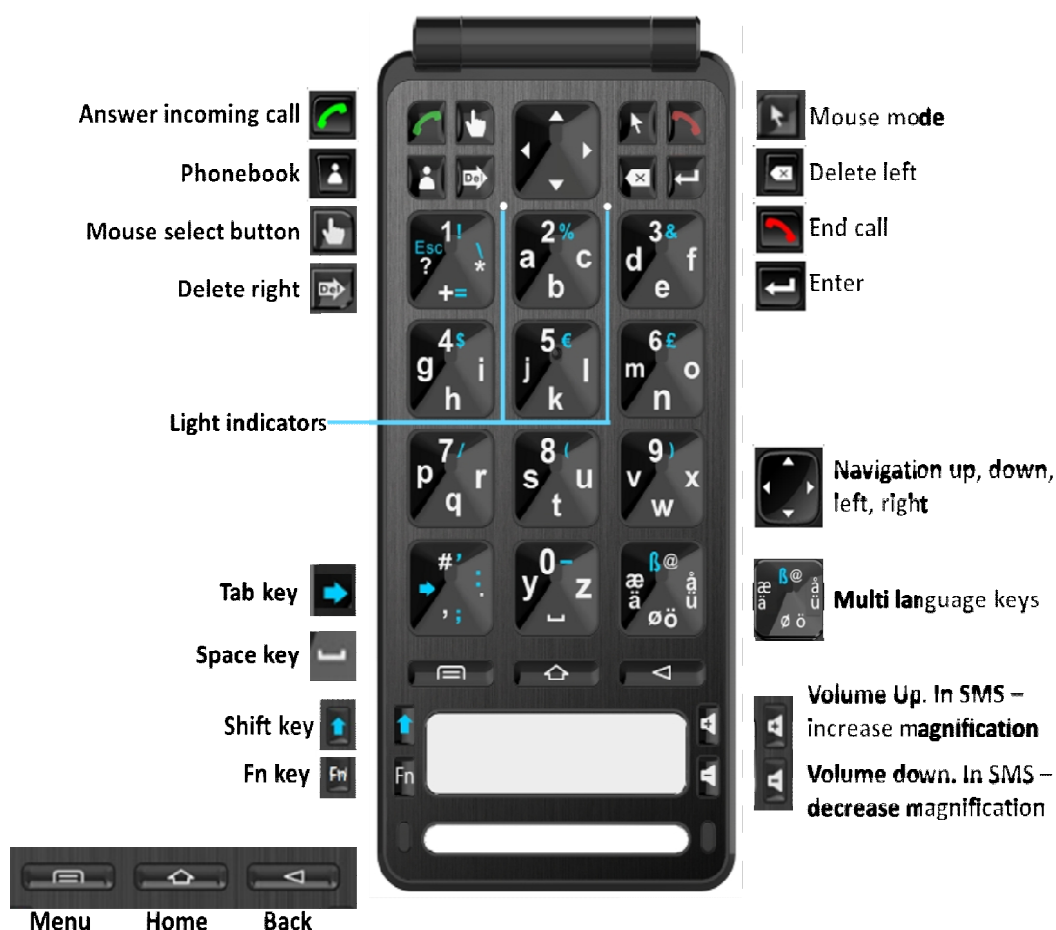

















Figure5 - Keyboard

#### 3.1 Bluetooth Keyboard for smart phone – Other keys and descriptions

	<b>Call Answer button</b>	<ul style="list-style-type: none"> <li>When Bluetooth Keyboard for smart phone is OFF, long press to turn ON.</li> <li>When there is an incoming call, press to answer call</li> <li>When the phone's screen is OFF, press to turn ON</li> </ul>
	<b>End Call button</b>	<p>When typing on the Bluetooth Keyboard for smart phone keyboard avoid pressing the End Call Button unless you wish to end an incoming call. In case of accidental press, the screen will go off. To make the screen reappear, press the back key  on the Bluetooth Keyboard for smart phone or the key  on the smartphone.</p>

	<b>Mouse - Emulator</b>	<p>The Mouse simulates the “touch” action on the screen. It gives you fine control when navigating around a screen with small text. This button turns the mouse ON and OFF. When the mouse is not in use make sure it is turned off.</p> <p>Pressing the  button toggles the mouse mode ON/OFF.</p> <p>Use the navigation buttons  to move the mouse pointer around the screen.</p> <p>The select button  is used to select at the position where the mouse pointer is <b>positioned. This button is equivalent to the Left button on a standard mouse.</b></p> <p>The mouse pointer will be visible for 15 seconds at a time. When the mouse pointer becomes invisible, pressing any of the navigation buttons will make it visible for another 15 seconds.</p>
	<b>Enter key</b>	Apart from using this key to create new text lines and activate functions, it can be used to take pictures when in the camera app.
	<b>Phone book</b>	Short cut to the Contacts app.
	<b>Shift Key (sticky key)</b>	<ul style="list-style-type: none"><li>Pressing the shift key followed by an alphabet denotes a capital key.</li><li>Pressing shift followed by the keys marked in blue denotes the relevant symbol.</li><li>Pressing twice in quick succession will put the keyboard in a shift lock mode. In the shift lock mode – the 2 indicator lights on the keyboard will be lit. Press it again goes out of shift lock.</li></ul>
	<b>Function Key</b>	<p>Special functions key</p> <ul style="list-style-type: none"><li>Setting language on Bluetooth Keyboard for smart phone keyboard (ref: Section 5.1)</li><li>Resetting the Bluetooth connection (ref: Section4.)</li></ul>
	<b>Volume control buttons</b>	The volume control buttons when in the SMS application allows you to increase and decrease the size of the text.
	<b>Tab key</b>	The Tab key can be used for navigation in certain apps. This will depend upon what the app supports with regards to physical keyboards.
 Menu      Home      Back		<p> similar to the home key  on the phone</p> <p> similar to the back key  on the phone</p>

Esc	Escape key	Has the same function as the back key
-----	------------	---------------------------------------

**Figure 6 - Keyboard other features**

### **3.2 Turning the EZI-PAD ON and OFF**

#### **3.2.1 Turning ON the Bluetooth Keyboard for smart phone**

To turn ON the power in the Bluetooth Keyboard for smart phone, open the cover. Press and hold the GREEN Handset symbol  on the keyboard ~~for about 5 seconds or when~~

~~the~~ light indicators come ON(momentarily). Press GREEN Handset symbol  a second time.

You should see a message “Bluetooth keyboard connected” if you have paired up the Bluetooth Keyboard for smart phone with the phone.

In any event that the Bluetooth connection cannot be established go to Section4.

#### **3.2.2 Turning OFF the Bluetooth Keyboard for smart phone**

To turn OFF the power in the Bluetooth Keyboard for smart phone, open the cover. Press and hold the top right most button on the keyboard (RED Handset symbol ).

#### **3.2.3 When the phone or Bluetooth is turned OFF and ON**

When the smartphone or when the Bluetooth function in the smartphone is switched off the Bluetooth Keyboard for smart phone will try to re-connect with the smartphone for about 3 minutes.

After trying for 3 minutes without re-connection the Bluetooth Keyboard for smart phone will turn OFF.

To switch ON again, go to Section 3.2.1 to restart and re-connect the Bluetooth.

#### **3.2.4 Accessing settings on the phone**



**Figure 7 - Opening settings**

## **4 Bluetooth Keyboard for smart phone – Pairing and connecting to the smartphone**

- Pair the Bluetooth Keyboard for smart phone to the smartphone using Bluetooth

- b) After pairing, connect the Bluetooth Keyboard for smart phone to the Smartphone (step 6)

### Bluetooth Keyboard for smart phone - Pairing and connecting to the smartphone

#### Step 1a



Turn ON the Bluetooth Keyboard for smart phone. Press and hold the Green handset button.

#### Step 1b



The indicator lights come ON momentarily.



Led 1 Blue Led 2 Red Led 3 Green  
connect to smartphone.

Check:  
Blue light  
Blinking every  
0.5 seconds  
trying to

#### Step 2

On the Bluetooth Keyboard for smart phone keyboard Press and Hold at the same time.

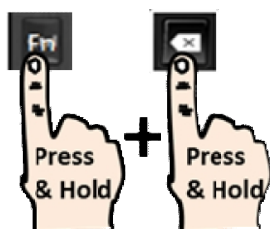

Hold for about 5 seconds. Release the keys when you see the indicator lights come ON (the lights are shown in the picture in step 1b).

Then go to step 3.

#### Status

Check: front cover

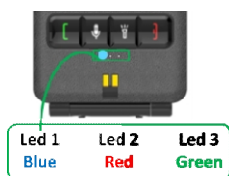

Blue light Blinking every 0.5 seconds trying to connect with the smartphone.

#### Step 3 go to settings

Via this screen

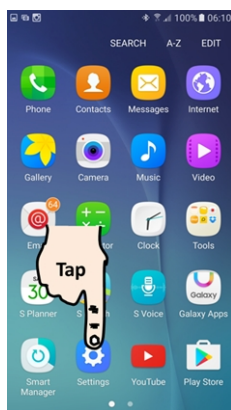

Or via Ezilaunch if it is installed

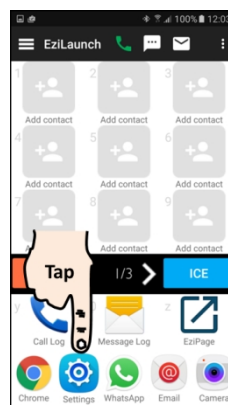

#### Step 4

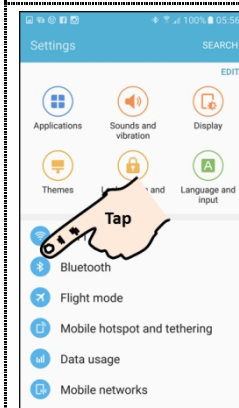

### Step 5

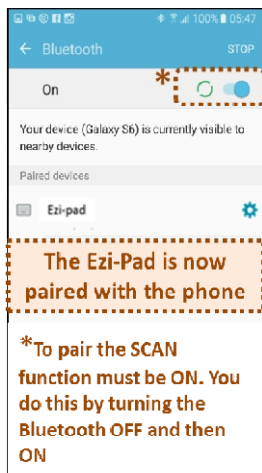

### Step 6

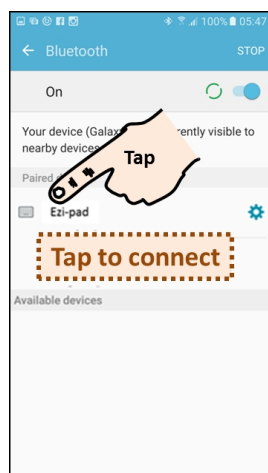

### Step 7

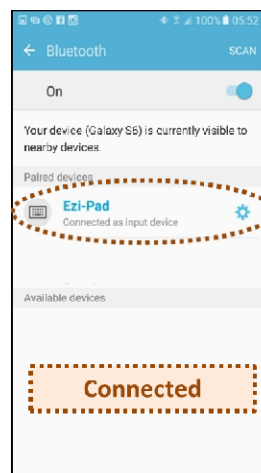

*N.B:*

*If it does not connect up you may have to:*

- *turn your phone On and Off*
- *repeat the steps 1 to 7*

#### For Samsung S4

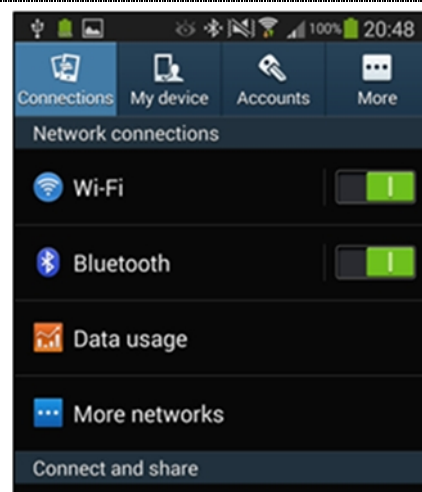

*Notes:*

*For Samsung S4*

*Bluetooth settings:*

*tap on*

**Figure 8 - Pairing and Connecting**

## **5 Telephone Settings**

**Mandatory - set the following:**

- a) Select the phone language and Bluetooth Keyboard for smart phone's language
- b) Set the language for Bluetooth Keyboard for smart phone's keyboard.

### **5.1 Phone Language Settings: Phone and External keyboard (Bluetooth Keyboard for smart phone)**

**Important – set up the following;**

## Step 1

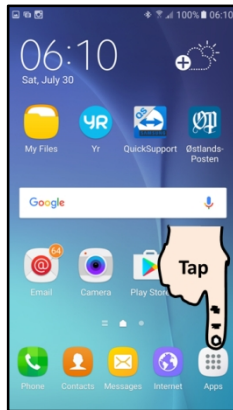

## Step 2

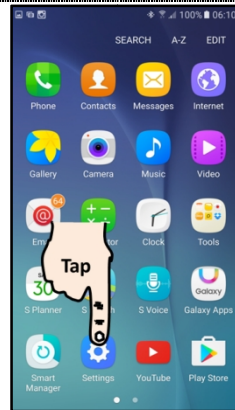

## Step 3

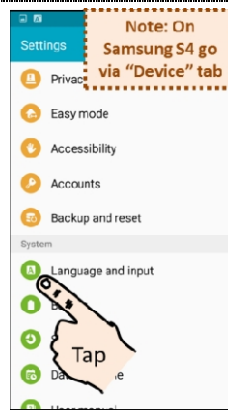

## Step 4 Phone language

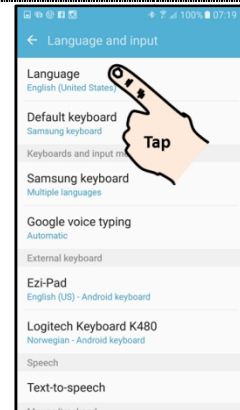



## Step 5

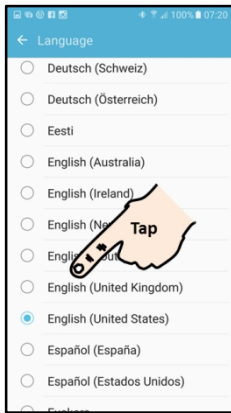

## Step 6 Bluetooth Keyboard for smart phone language

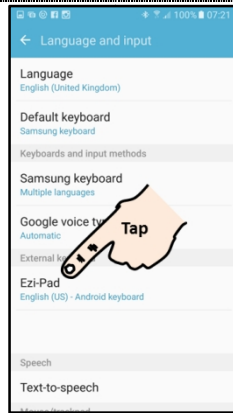

## Step 7

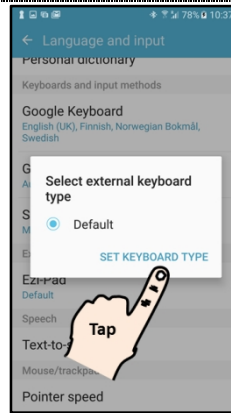

## Step 8

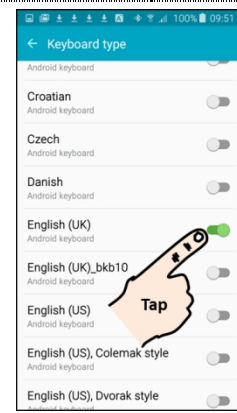

### Step 9

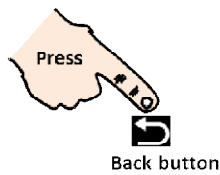

### Step 10

Setting the Bluetooth Keyboard for smart phone language in the phone.

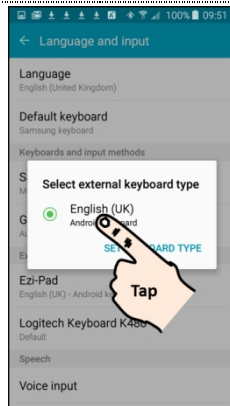

### Step 11

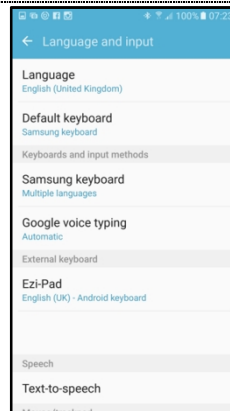

### Step 12



After this step the Bluetooth Keyboard for smart phone language and the phone language shall be automatically synchronized. If typing on the keyboard shows wrong characters go to step 13

### Step 13

If wrong characters shown when typing

In Step 10, the phone must know what language the external keyboard uses (i.e. Bluetooth Keyboard for smart phone is an external keyboard) This language setting must be the same as the language setting in the Bluetooth Keyboard for smart phone

In step 10 above, English UK is selected for the phone's external (Bluetooth Keyboard for smart phone) keyboard.

The Bluetooth Keyboard for smart phone keyboard has to be the same.

To set the language in the Bluetooth Keyboard for smart phone keyboard;

Press on + keys at the same time and hold until the keyboard indicator lights come ON.

Note: e = English UK

### Notes:

**The Bluetooth Keyboard for smart phone keyboard can be set to be for 1 to 6 types, see below.**

*The Bluetooth Keyboard for smart phone keyboard language setting shall be the same as the phone's external (Bluetooth Keyboard for smart phone) language setting. (see step 10 above).*

*The settings combinations in Bluetooth Keyboard for smart phone keyboard for the 6 types of keyboards are shown below.*

Danish		+	
English UK		+	
German		+	
Norwegian		+	

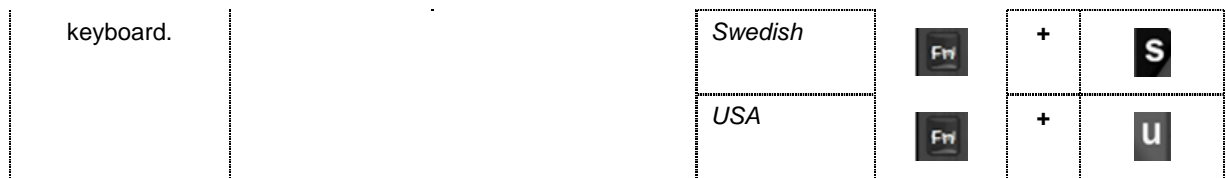

**Figure 9 - Phone's Language and external keyboard settings**

*N.B: You can force the the Bluetooth Keyboard for smart phone to use a different language other than that set for the phone. For example, in step 10, if Finnish is selected for the phone, you can force the Bluetooth Keyboard for smart phone language setting in step 10 to Swedish. After that in step 13, you can force the Bluetooth Keyboard for smart phone keyboard setting to*

*Swedish by Press  + s at the same time.*

*This is especially useful as the Finnish keyboard is the same as the Swedish keyboard. See also the recommendation in Section 7.2 which screen keyboard is best used with the Bluetooth Keyboard for smart phone.*

## **5.2 Phone settings – Home key to answer call, Power key to End call**

**Mandatory – set up the following;**

a) Phone setting - Answer and End calls

Home button to answer calls

Power button to end calls

### Step 1

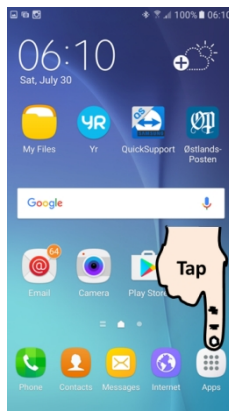

### Step 2

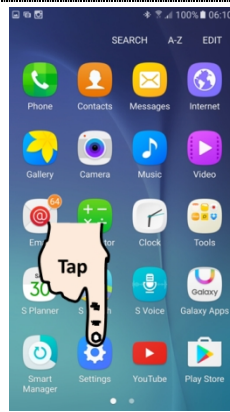

### Step 3

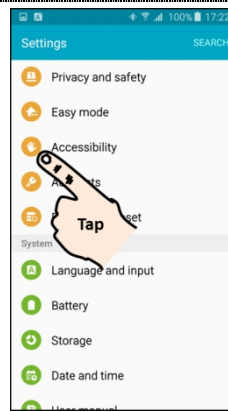

### Step 4

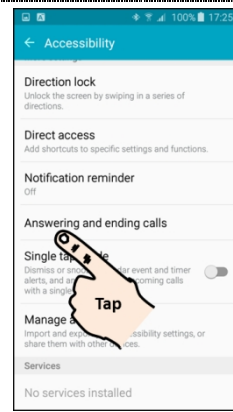

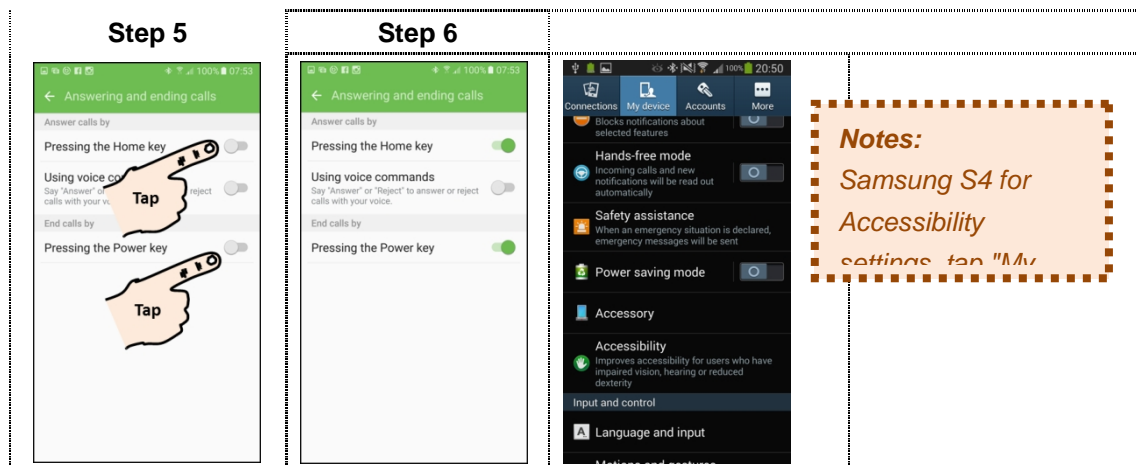

Figure 10 - Home key to answer call, power key to end call

## 6 Using Bluetooth Keyboard for smart phone with EziSmart App

Bluetooth Keyboard for smart phone when used with the EziSmart app enhances ease of use. The EziSmart has a launcher which is an “all-in-one” easy to use interface. In addition it has safety and security features.





### 6.1 Introduction to EziSmart App





EziSmart app has 8 features. When installed the EziSmart can be used as an app or be set with EziLaunch as the default launcher (i.e. be the Home screen). Get EziSmart App at Google Play Store.



Figure 11 - EziSmart App

### 6.2 Features in EziSmart App

Feature	Description	Feature	Description
 <b>EziLaunch</b> The start screen	<b><i>Provides ease of use:</i></b> <ul style="list-style-type: none"><li>-Pictorial calling, messaging and email</li><li>-Fast access to your apps</li><li>-Emergency alert</li><li>-See your medical log quickly</li></ul>	 <b>EziGPS</b>	<b><i>Be safe. You can allow:</i></b> <ul style="list-style-type: none"><li>-Pre-selected persons to remotely interrogate your phone's GPS position via SMS</li><li>-Send periodically your GPS location</li></ul>
 <b>EziAutoAns</b> Automatic answer	<b><i>No hands, no stress:</i></b> Automatically answer calls from preselected contacts	 <b>EziSendGPS</b>	<b><i>You can share your location:</i></b> for meet ups or assistance or simply tell your loved ones where you are

 <p><b>Ezi-ICE</b> In Case of Emergency</p>	<p><b><i>Out Travelling:</i></b> Take your personal medical log with you, just in case. Use it for storing your personal information and for your own look up.</p>	 <p><b>EziPage</b></p>	<p><b><i>Frequently used apps:</i></b> Keep them in one place, reach them quickly</p>
 <p><b>Ezi-SOS</b> SOS Alert</p>	<p><b><i>Need help:</i></b> Rapidly generate SOS or priority SMS and/or calls</p>	 <p><b>EziSwitch</b></p>	<p><b><i>Want more:</i></b> Easily switch to the phone's Android system</p>

**Table 1- EziSmart features**

### 6.3 Navigating around EziLaunch screen using Bluetooth Keyboard for smart phone

The Bluetooth Keyboard for smart phone is best used in combination with touch (tap) where the touch area is large use tap. However, if tap is not possible for whatever reasons, use the Bluetooth Keyboard for smart phone keyboard.

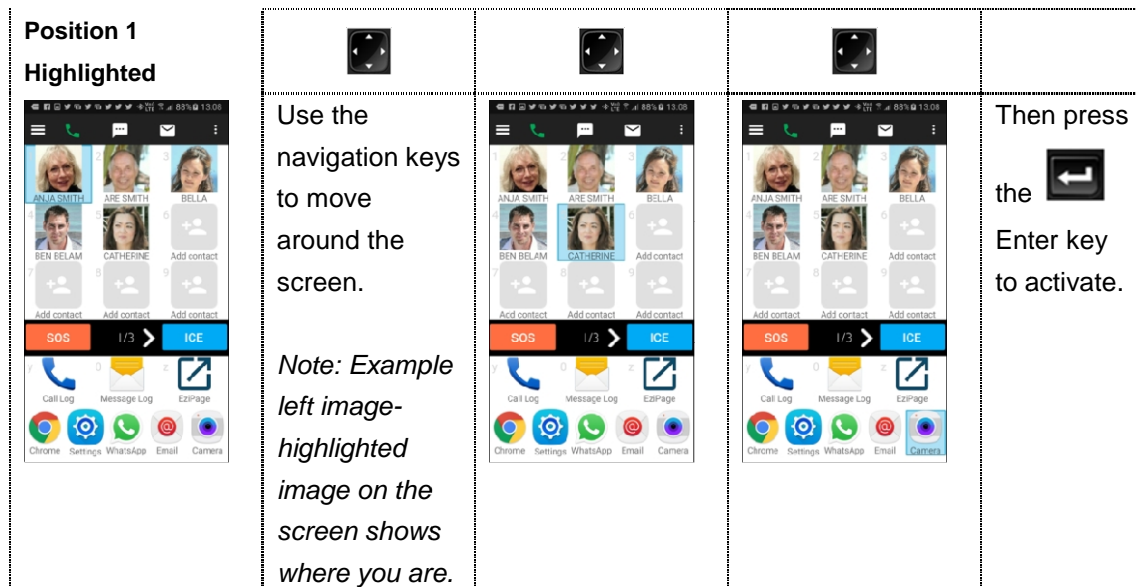

Figure 12 - Move around the screen using navigation buttons

### 6.4 Calling, SMS and Email –without using touch

#### 6.4.1 Calling using Navigation and Enter keys

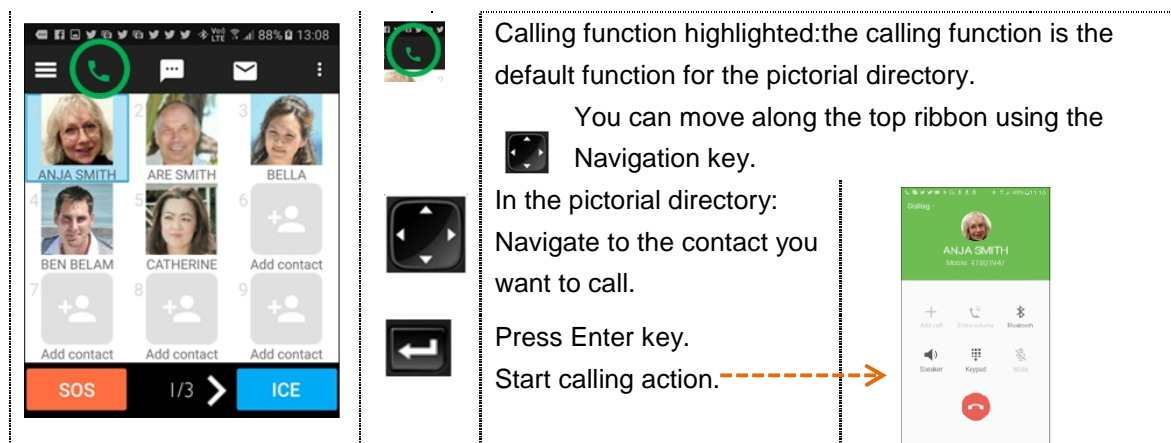

Figure 13 - Call using Navigation and Enter keys



#### 6.4.2 Write SMS –using Navigation and Enter keys

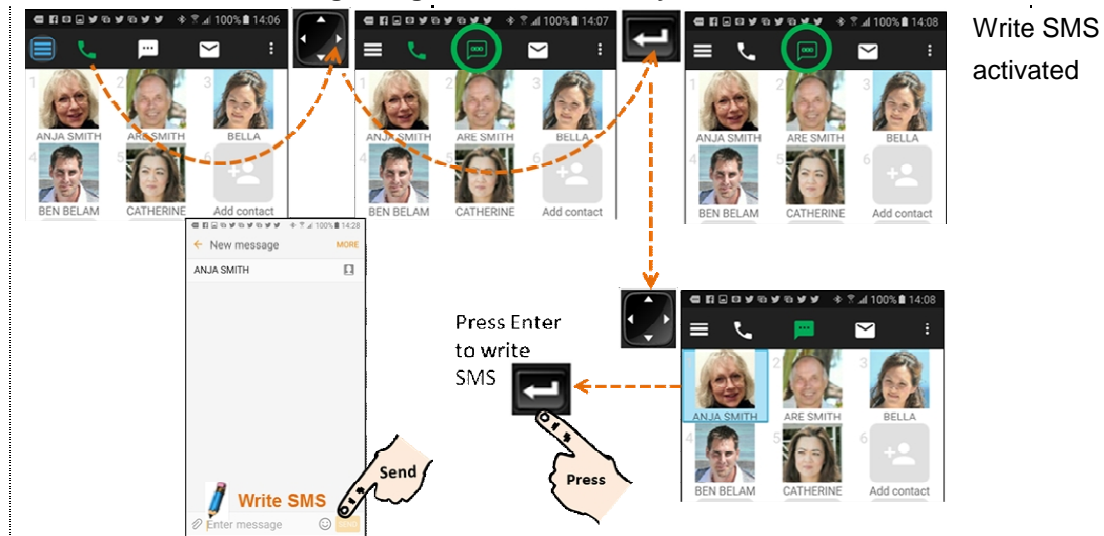

Figure 14 - Write SMS using Navigation and Enter keys

#### 6.4.3 Write Email –using Navigation and Enter keys

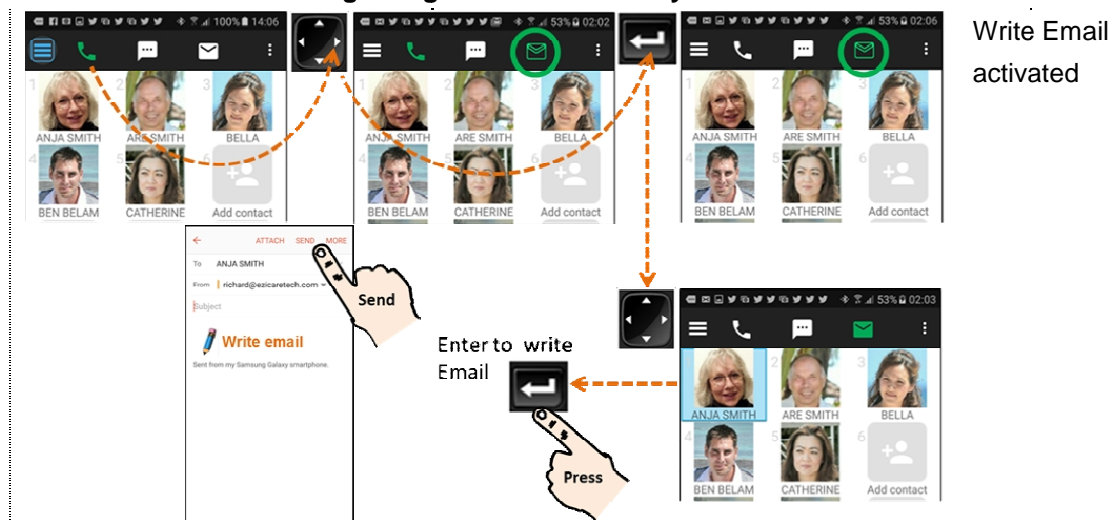
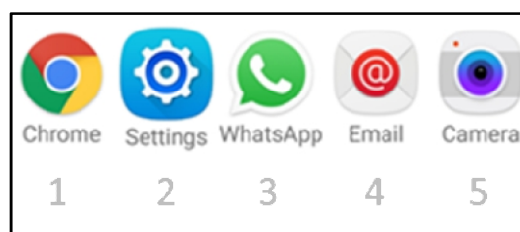

Figure 15 - Write Email using Navigation and Enter keys

### 6.5 Short cut to activate the direct access apps

The direct access apps positions are numbered 1 to 5.

Activation of apps in these positions is done by pressing First Fn followed by a numeral 1-5.



Fn key.

Fn followed by 1

Fn followed by 2

This key when pressed and release will be valid only once.

Will activate the app in position 1 (i.e. Chrome app in this case)

Will activate the app in position 2 (i.e. Settings app in this case)

And so on up to 5

**Figure 16 - Keyboard short cuts for apps**

## 7 Hints & Problems

### 7.1 Taking a picture – made easy

Ease of use extends to taking a picture. For convenience Bluetooth Keyboard for smart phone gives you a handle to hold the smartphone when taking a picture. It also mitigates shaking which comes from pressing the trigger button on the phone's screen whilst taking a picture.

Start the camera app - point, focus and snap a picture with the Enter key



### 7.2 Recommendations for on-screen keyboard

There are many on-screen keyboards. Different on-screen keyboards behave differently. Some on-screen keyboards do not support predictive text when used with the Bluetooth Keyboard for smart phone.

It is recommended that the Google keyboard be used with Bluetooth Keyboard for smart phone. Download and install from Google play.

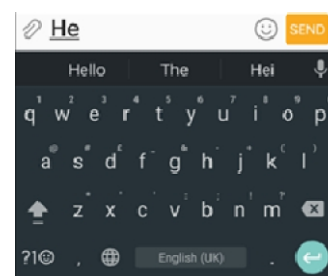

**Figure 17- Google keyboard with predictive text**

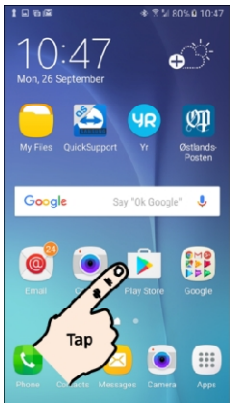
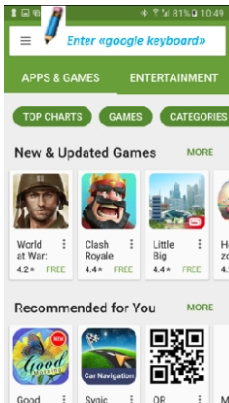
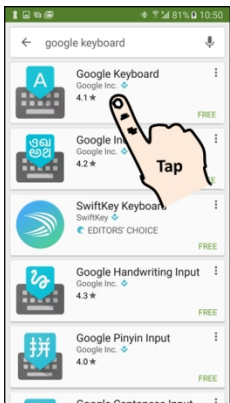
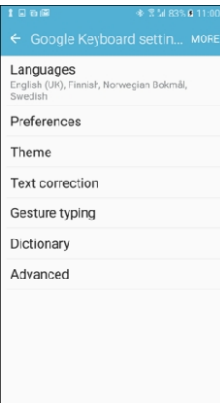
Step 1	Step 2	Step 3	Step 4
Go to the Google Play app.	Search for Google keyboard.	Select and install. Follow instructions.	Choose your preferences.
			

**Figure 18 - Installing Google keyboard**

### 7.3 Telephone does not work

- When the telephone does not work. The screen will not light up. Maybe battery low.
- Put the phone and Bluetooth Keyboard for smart phone assembly on charge in the charging stand.

After charging, go to Section 3.2.1.

## 7.4 Difficult to pair up

Sometimes, depending upon the phone used, condition and operating system you may experience difficulty in pairing and connecting Bluetooth Keyboard for smart phone to the smartphone.



You may need to repeat steps 3 to 6 in Section 4.

If that still does not work, repeat the steps from Step 1 to 6 in Section 4.

## 7.5 Keyboard does not work

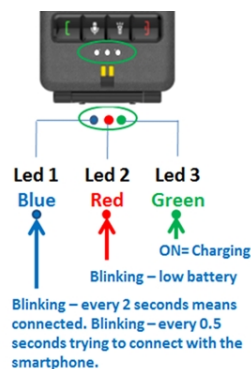
- 1) Bluetooth Keyboard for smart phone turned off. Go to a) below.
- 2) Battery in the phone or the Bluetooth Keyboard for smart phone had run out. Charge Bluetooth Keyboard for smart phone. Then go to a) below.
- 3) The Bluetooth in the phone had been switched off. Go to a) below.



- a) Press and hold  the key until the Light indicators in the keyboard lights up momentarily.
- b) Observe the Blue light (Led 1) on the cover. If it is blinking slowly about every 2 seconds then the Bluetooth Keyboard for smart phone has been re-connected with the phone.
- c) If it is blinking quickly every 0.5 seconds then the Bluetooth Keyboard for smart phone is trying to connect with the phone.
  - i. Press the home button  on the phone
  - ii. Tap on settings
  - iii. Tap Bluetooth
  - iv. Is Bluetooth Keyboard for smart phone connected?

**Yes**

Press home button  
on the phone to Exit.

**No**

Connection not established.  
Go to Section4.

**Figure 19 - Restarting keyboard**





## 7.6 Charging stand

The charging stand is made to enable convenience for charging the phone and the Bluetooth Keyboard for smart phone together and to avoid frequent handling of the fiddly charging connector.

Please use gently and handle with care. Do not use force when inserting the phone into the charging stand. Unnecessary force will damage the stand and the connectors.

## 7.7 Call answer and call end keys do not work

There are 2 sets of call answer and call end keys on Bluetooth Keyboard for smart phone:  
1 set on the front cover and 1 set on the keyboard.

Function	Front cover	On Bluetooth Keyboard for smart phone keyboard
Answer call		
End call		
	These front cover keys are disabled when the cover is opened.	

**Table 2 - Call answer and call end keys**

When call answer and call end keys in the keyboard and the front cover does not work. Go to Section 5.2. Do the necessary settings in the phone.

These keys use features available in the phone. For an incoming call during the ringing phase, the end call key stops the audio ringing. However, before the caller or the network terminates this call it is still active in the background and can be answered by the user (if so wished).

## 7.8 Bluetooth Keyboard for smart phone – manual language set up

The Bluetooth Keyboard for smart phone can emulate 6 different keyboards. This Bluetooth Keyboard for smart phone language setting has to be the same as the settings in the phone.

You can manually set the Bluetooth Keyboard for smart phone to 1 of 6 keyboard settings; Danish, German, Norwegian, UK and US, ref. Section 5.1, Step 13.

## 7.9 Combination of Bluetooth Keyboard for smart phone and on-screen keyboard

### 7.9.1 On-screen keyboard not visible

On occasions, the on-screen keyboard is not visible example in texting mode. Tap anywhere on the screen where you are entering your text. The on screen keyboard will pop up.

### 7.9.2 Not valid keyboard symbols

For the various languages and associated keyboards, some symbols and alphabets may not be available even though these are shown on the keyboard. This is due to limitations in the keyboard standards.

For example: US keyboard will not have the £ and € symbols and the multi-language characters.

**Symbols not used for the various languages:**

Language	Symbols not used					
Danish	ß					
English (UK)	ß			æ,ä	ø,ö	å,ü

English (US)	ß	€	£	æ,ä	ø,ö	å,ü
German			£			
Norwegian	ß					
Swedish	ß					

**Table 3 - Languages and symbols**

If you are operating the Bluetooth Keyboard for smart phone with the US settings, you may occasionally need to use the € or £ signs. You can always call up the € and £ symbols by using the on-screen keyboard in combination with the Bluetooth Keyboard for smart phone or you can set the Bluetooth Keyboard for smart phone to English UK keyboard.

## **8 Contact us**

Contact us at: [www.ezicaretech.com/contact-us/](http://www.ezicaretech.com/contact-us/)

Or write to us at: [support@ezicaretech.com](mailto:support@ezicaretech.com)

## **9 Other guides and information**

Download other guides at: [www.ezicaretech.com/download/](http://www.ezicaretech.com/download/)

## **10 Handling instructions**

Treat your Bluetooth Keyboard for smart phone with care. It is made of plastic. It has sensitive electronic components and a lithium ion battery inside. The Bluetooth Keyboard for smart phone can be damaged if dropped, heated, crushed, and punctured or if it comes in contact with liquid.

### **10.1 Battery**

The Bluetooth Keyboard for smart phone has an internal, lithium-ion rechargeable battery which will gradually degenerate. For battery replacements please contact EziCare Tech at [www.ezicaretech.com/contact-us/](http://www.ezicaretech.com/contact-us/)

#### **10.1.1 Bluetooth Keyboard for smart phone – battery charging**

The Bluetooth Keyboard for smart phone comes with a docking station for charging. The charging adapter that comes with your phone is used. When the Bluetooth Keyboard for smart phone with the smartphone inserted is placed in the docking station both the Bluetooth Keyboard for smart phone and the smartphone are charged at the same time.

#### **Note!**

***Charging dock: Please insert the Bluetooth Keyboard for smart phone into the docking station gently and with great care to avoid damage. Do not use force as this can damage the docking station and worst case also damage the charging connector in the smartphone.***

### **10.2 Material**

The Bluetooth Keyboard for smart phone body and key tops are made of ABS plastic and polycarbonates. For cleaning use a very mild detergent and please be very careful with the printed keys. Avoid rubbing the key tops and avoid abrasive materials when cleaning the casing and the key tops. Gently dust the key tops with a soft cloth.

### **10.3 Connectors, ports, and buttons.**

Never force a connector into a port or apply excessive pressure to a button, because this may cause damage that is not covered under the warranty. If the connector and port does not match with reasonable ease, there is most probably damaged. Check for obstructions and make sure that the connector matches the port and that you have positioned the connector correctly in relation to the port.

### **10.4 Safety information**

The unit and the accessories contain small parts. Keep all of the equipment out of the reach of small children.

The mains socket outlet must be close to the equipment and easily accessible when used.

## **10.5 Usage environment**

You must follow the local law and regulations. Don't use the Bluetooth Keyboard for smart phone with the mobile phone in prohibited places. Use the Bluetooth Keyboard for smart phone properly for the purpose it is intended.

Do not place magnetic storage medium close to the Bluetooth Keyboard for smart phone as this may delete the stored information.

Do not place the Bluetooth Keyboard for smart phone close to flammables and combustibles.

## **10.6 Operating and storage environment**

### **10.6.1 Operating temperature**

Operating temperature: 0° and 35° C (32° and 95° F)

Storage temperature: -20° and 45° C. (-4° and 113° F)

If operated and stored outside these temperatures damage, malfunctions and poor battery life may occur.

Avoid dramatic changes in temperature or humidity.

### **10.6.2 Local rules and laws**

Follow the rules and local laws that apply wherever you are. Turn off the unit whenever its use is prohibited or can cause interference or hazards. Only use the unit in its normal intended user position.

### **10.6.3 Magnetic media**

Parts of the unit are magnetic. The unit can attract metal objects. Do not keep credit cards or other magnetic media near the unit. The information stored on them can be erased.

### **10.6.4 Electronics equipment**

Some electronics equipment may interfere with the radio-frequency signal used by the Bluetooth Keyboard for smart phone.

### **10.6.5 Pacemaker**

The distance between the Bluetooth Keyboard for smart phone with the phone inserted and the pacemaker is suggested to be at least 20 cm(6 inches) in case of any interference from the phone. This suggestion is given by pacemaker and wireless technology institute.

It must be observed that the Bluetooth Keyboard for smart phone with an inserted phone must not be placed in a lapel pocket when pacemaker is used.

#### **10.6.6 Other medical equipment**

Any wireless transmitting equipment (including mobile phones) may cause interference to the function of improperly protected medical equipment. Please turn off the phone in places where phones are prohibited to be switched on.

#### **10.6.7 Dangerous environment**

Turn off the phone in places where the environment is highly combustible. Observe the warning signs which are usually displayed in such places. Spark in these places will cause explosions and fires.

#### **10.6.8 Precautions**

The Bluetooth Keyboard for smart phone casing is made to house a smartphone and it provides protection for the phone's display when in normal use. However, it is not made to withstand being dropped on to a hard surface. Handle with care and do not drop the unit (with or without the phone in it). This will cause damage to the Bluetooth Keyboard for smart phone although the phone may be protected from damage.

Please observe the following:

- Keep the Bluetooth Keyboard for smart phone away from children.
- Keep the Bluetooth Keyboard for smart phone dry.
- Do not use or put the Bluetooth Keyboard for smart phone in dusty and dirty places.
- Do not try to take the Bluetooth Keyboard for smart phone part.
- Do not drop, heat, vibrate or shake violently. Rough treatment may damage the inner circuit board of the Bluetooth Keyboard for smart phone.
- Do not wash the Bluetooth Keyboard for smart phone with harsh chemicals, cleaner or strong detergent.
- Do not smear the Bluetooth Keyboard for smart phone with pigment.
- Please deliver the Bluetooth Keyboard for smart phone to an authorized repair centre if there are any operational problems with the Bluetooth Keyboard for smart phone, battery, charger or accessories. Please contact us at EziCare Tech at [www.ezicaretech.com/contact-us/](http://www.ezicaretech.com/contact-us/)

#### **10.6.9 Disposal**

##### **Warning:**

Do not dispose of the Bluetooth Keyboard for smart phone or its battery as domestic waste. Please dispose according to local laws and regulations.



**FCC Caution:**

This device complies with part 15 of the FCC Rules. Operation is subject to the following two conditions: (1) This device may not cause harmful interference, and (2) this device must accept any interference received, including interference that may cause undesired operation.

Any Changes or modifications not expressly approved by the party responsible for compliance could void the user's authority to operate the equipment.

**Note:** This equipment has been tested and found to comply with the limits for a Class B digital device, pursuant to part 15 of the FCC Rules. These limits are designed to provide reasonable protection against harmful interference in a residential installation. This equipment generates uses and can radiate radio frequency energy and, if not installed and used in accordance with the instructions, may cause harmful interference to radio communications. However, there is no guarantee that interference will not occur in a particular installation. If this equipment does cause harmful interference to radio or television reception, which can be determined by turning the equipment off and on, the user is encouraged to try to correct the interference by one or more of the following measures:

- Reorient or relocate the receiving antenna.
- Increase the separation between the equipment and receiver.
- Connect the equipment into an outlet on a circuit different from that to which the receiver is connected.
- Consult the dealer or an experienced radio/TV technician for help.