

The home base unit

Model: S921

user manual

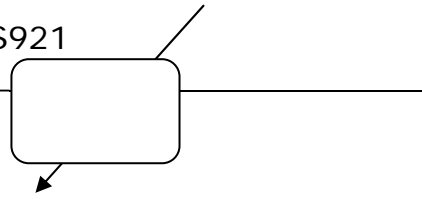

1、Product overview

The home base unit S921 is an auxiliary device of the MT200 tracker, If the MT 200 tracker is within 20 meters of the home base unit S921, you can detect the normal work of MT200. beyond this range, the home base unit s921 can not detect MT200 tracker. The home base unit S921 has no waterproof function.

2、Product appearance and parameters

Items	Specification
input voltage	AC 100-240V 50/60HZ
Internal Battery	Rechargeable lithium battery 100 mAh (3.7V)
Working current	450mA
size	83mm X 59mm X 35mm
weight	142g
Operating Temperature	-20 ~ +55 °C
GSM module	Quad Band GSM 850/900/1800/1900 MHz
internal memory	32M-BIT Flash memory
LED	Power LED light、GSM LED light 、wifi&BT LED light
button	SOS button
Antenna interface	External antenna interface, for connect with 2.4GH external antenna

accessories



GMT921Terminal (Internal Battery)



Special USB cable (optional)

button

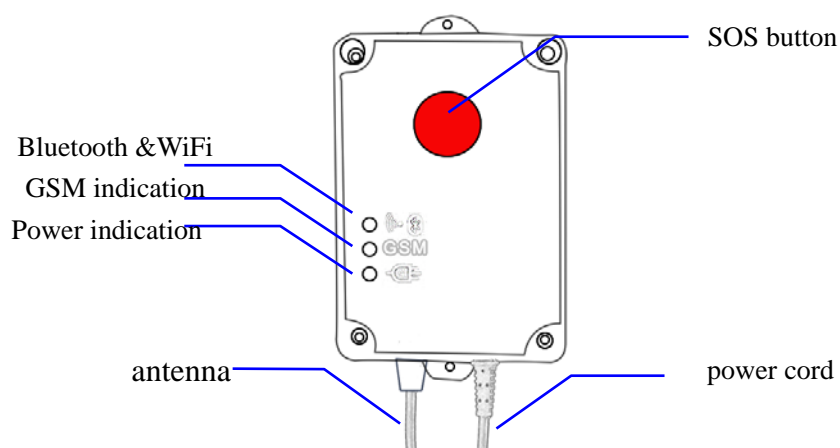

red – Power indication

always on	Connect external power source
always off	disconnect external power source

Blue – GSM indication

0.3s on and 0.3s off	GSM module is initializing
Always on	GSM network is not registered
1s on and 3s off	GSM network is registered
0.1s on and 3s off	GSM network is registered and connected to the server by GPRS

yellow – GPS indication

1s on and 3s off	module is initializing
0.1s on and 3s off	module is working normally
SOS button	Press sos button for 3S to sent" sos "alert to platform

3 function

◆power off alarm

1、 When the home base unit is connected with power , the base unit will send alarm information to the platform.

2、 When the home base unit is disconnected with power , the base unit will send alarm information to the platform.

*****If the device has an power off alarm function, the device must be connected to an internal battery*****

◆SOS emergency alarm

When Parole pressed the SOS key, the base unit sends an alarm message to the platform.

◆disassembly alarm

When the Home Base unit is disassembled, the base unit sends an alarm message to the platform

◆ Heartbeat package

For keeping the base unit and the platform normal connection, the base unit transmits the data to the platform according to the fixed time interval.

If the base unit does not send information to the platform according to the fixed time interval, the base station and the platform are disconnected.

4the home base unit installation and use

Install the SIM card and spare battery for the home base unit

Install the card requirements

- Ensure that your tracker has a working SIM card.
- Please make sure SIM card has enough credit.
- Please make sure that the SIM is not locked and do not require a password to operate.
- If you need to make a phone call back to your location, Please make sure the SIM card is supporting caller ID display

①

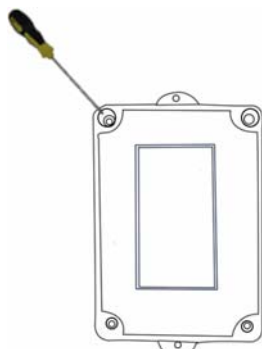

1、 Unscrew the back cover of the device.

②

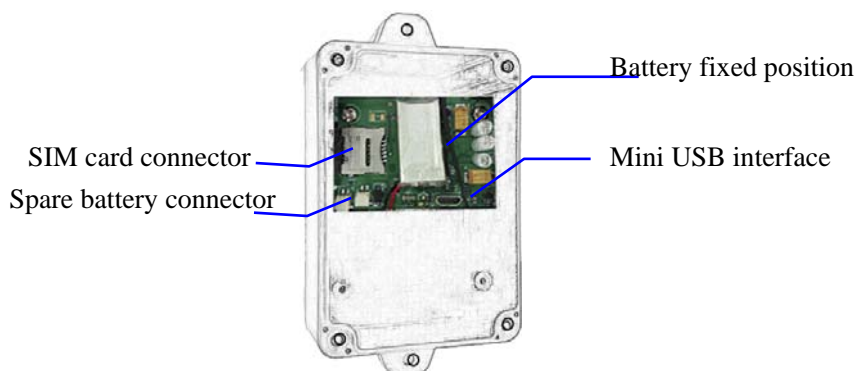

2、 Install the SIM card, insert the battery cable, fixed the battery.

③

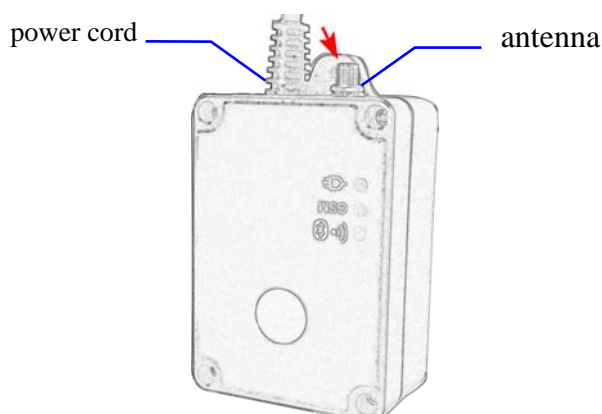

3、 screwdriver screw on the back cover, and then install the antenna

Fix the home Base unit

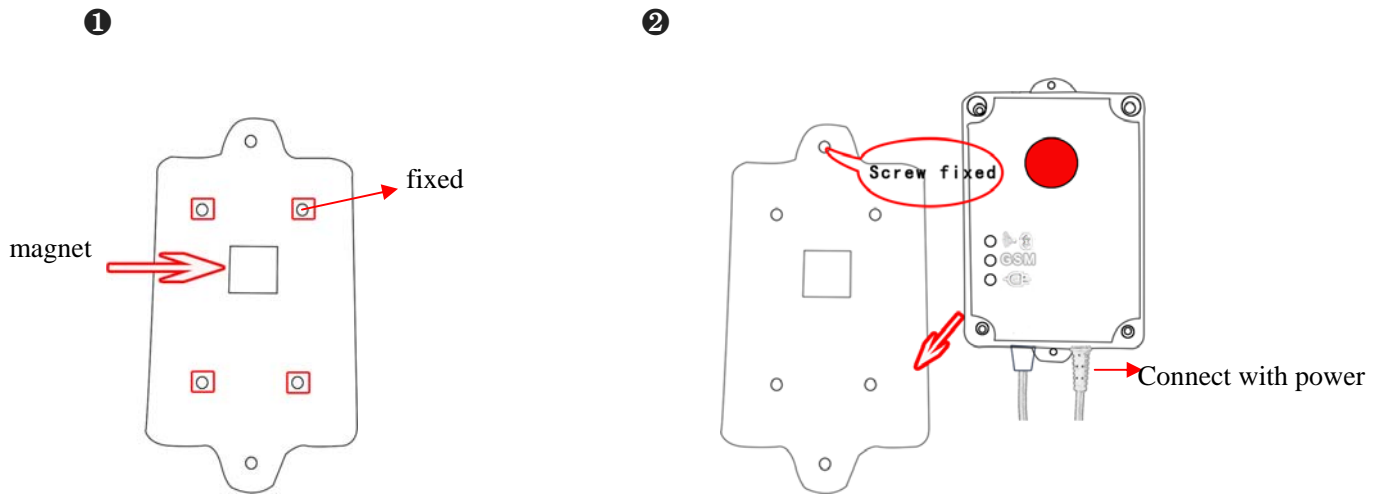

1、 the foundation of the home base unit with screws fixed to the wall and put the magnet into the specified location

2. The home base unit is screwed to the foundation and Connect with power.

Schematic diagram of the home base unit operation

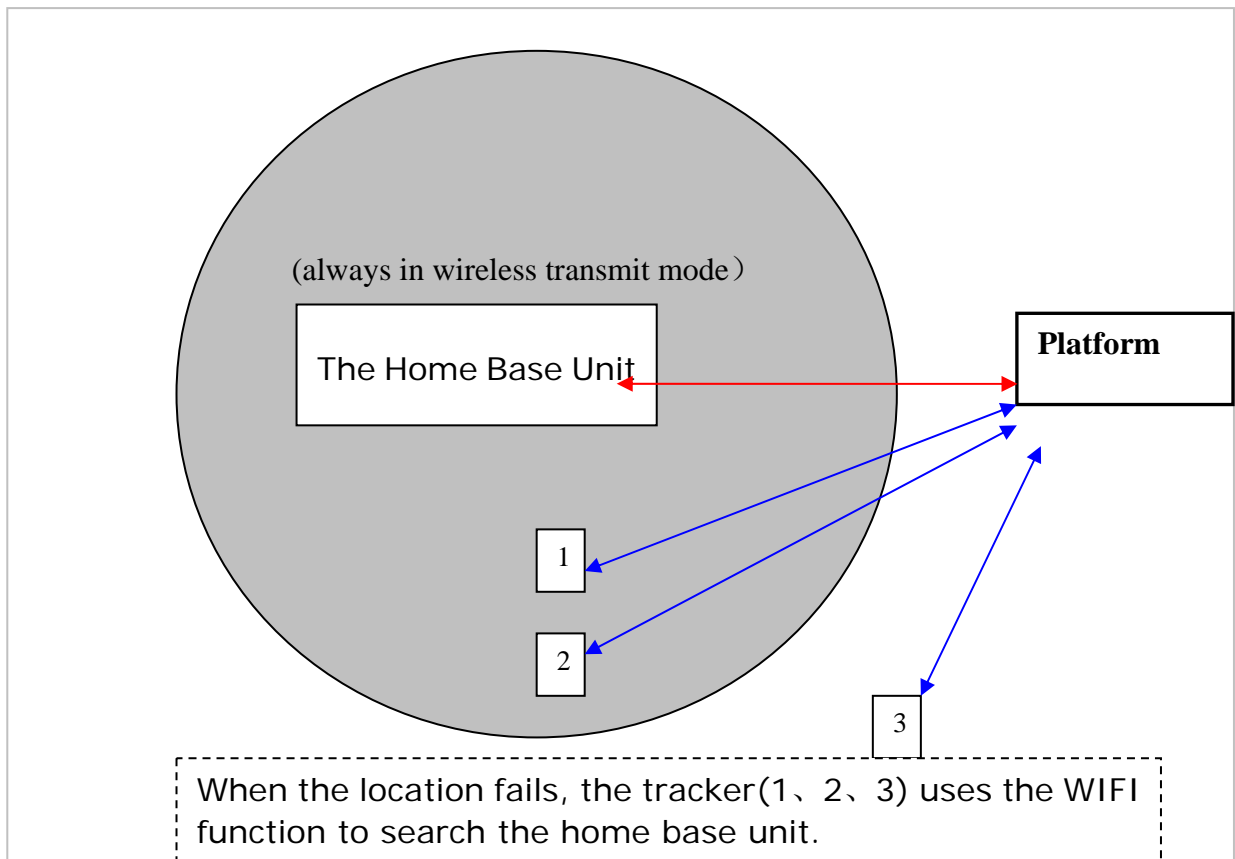

5 Parameters set up

Tracker supports APP setup software by smart phone or by sending command via SMS or by pc.

5.1 Change password

Description: change user's password

SMS Command: `$SMS,*****;W001,#####;!`

SMS Command explain: `$SMS, default password; W001,new password;!`

Explain:

*****: user password, the range of 6 digits, default password is 000000

#####: new password, the range of 6 digits.

Note: please switch to the English input method when you input a command by smart phone; tracker will only accept commands from a user with the correct password. Command will be ignored if with wrong password.

Example:

`$SMS, 000000;W001, 123456;!`

Read password: `$SMS, 000000;R001;!`

Clear password: `$SMS, 000000;C001;!`

5.2、Set the GPRS server

Description: Enable this function

SMS Command: `$SMS, 000000;W002, APN, Username, Password;W003, IP, Port;W005, X;W009, Y;!`

Explain:

APN:	Access point name of network	range of: 0~29 characters
Username:	accesses port' user name	range of: 0~29 characters
Password:	Accesses port's password	range of: 0~29 characters
IP:	server' IP address	range of: 0~29 characters
Port:	server's port	range of: 0~65535
		range of: 0~2
		0: means disable GPRS function,
Y:	GPRS upload mode	1: means upload by TCP,
		2: means upload by UDP
		default is 0

Example: \$SMS,000000;W002, cmnet, ;W003,192.168.1.1,8088;W005,1;W009,1;!

Read tracking regularly by GPRS:

\$SMS,000000;R002;R003;R005;R009;!

Clear tracking regularly by GPRS:

\$SMS,000000;C002;C003;C005;C009;!

FCC Statement

This equipment has been tested and found to comply with the limits for a Class B digital device, pursuant to part 15 of the FCC rules. These limits are designed to provide reasonable protection against harmful interference in a residential installation. This equipment generates, uses and can radiate radio frequency energy and, if not installed and used in accordance with the instructions, may cause harmful interference to radio communications. However, there is no guarantee that interference will not occur in a particular installation. If this equipment does cause harmful interference to radio or television reception, which can be determined by turning the equipment off and on, the user is encouraged to try to correct the interference by one or more of the following measures:

- Reorient or relocate the receiving antenna.
- Increase the separation between the equipment and receiver.
- Connect the equipment into an outlet on a circuit different from that to which the receiver is connected.
- Consult the dealer or an experienced radio/TV technician for help.

To assure continued compliance, any changes or modifications not expressly approved by the party.

Responsible for compliance could void the user's authority to operate this equipment. (Example- use only shielded interface cables when connecting to computer or peripheral devices).

This device complies with part 15 of the FCC Rules. Operation is subject to the condition that this device does not cause harmful interference.

FCC Radiation Exposure Statement:

The equipment complies with FCC Radiation exposure limits set forth for uncontrolled environment. This equipment should be installed and operated with minimum distance 20cm between the radiator and your body.