

eCordum ECG Patch

By



User Guide

For detailed information and the safety instructions, please visit:
www.eCordum.com/CB11



Get Started: Download App

Download the PAF Burden App from the App Store.

An eCordum account is needed to transfer ECG data through your iOS or Android device to the cloud. An account can be set up either via eCordum PAF App, or at www.eCordum.com.

Install Battery

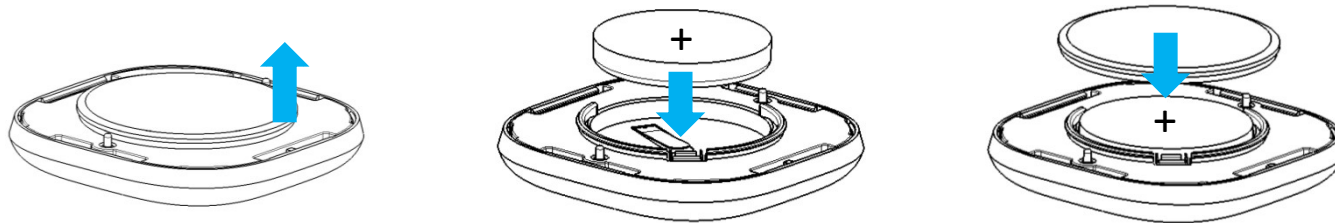

Battery type: CR2032.

Recommend brand: Energizer, Fujitsu. Or any other who claimed their product can meet or exceed the requirement of IEC 62133 standard.

Prepare your skin

- Shave the chest hair where you will wear the device.
- Clean the skin using ethyl alcohol-based sanitizer, or soap and water. Dry the area completely.
- Do not apply any kinds of lotion or oil.

Attach ECG Patch to Electrode Pad

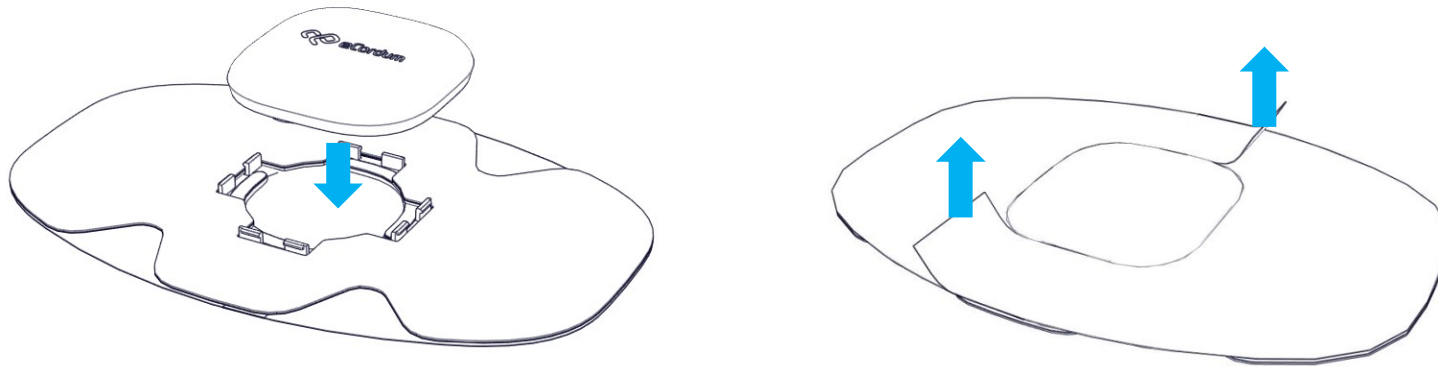

Wearing

- Place the Electrode Pad and ECG Patch on your chest as shown below.
- Press around the adhesive pad to make sure it sticks with your skin firmly.
- Recommend to replace the Electrode Pad every 24 hours or when it no longer adheres to the skin.
- Device will be automatically powered up when the Electrode Pad and ECG Patch sticks onto your skin. Likewise, automatically powered down when they detached.

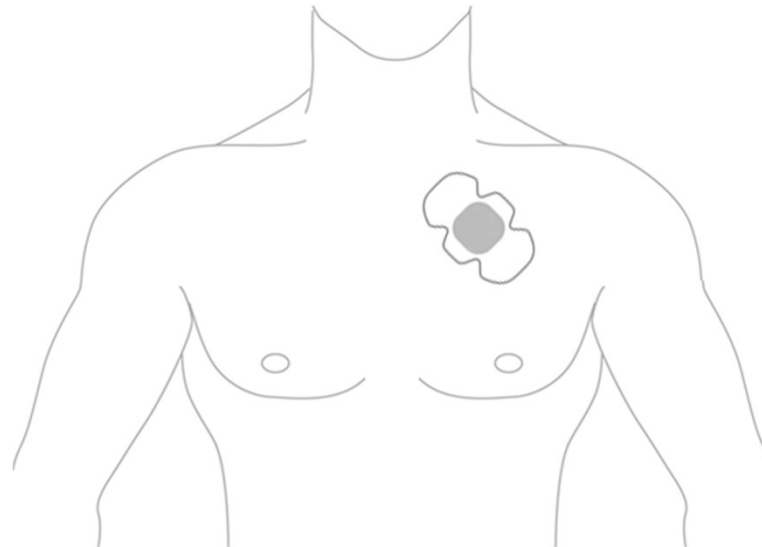

Beeping Alarm

- One long beep indicates that the device is powered on.
- 10 sequential beeps indicate that the adhesive electrode pad was disconnected for more than 2 seconds.
- 10 sequential dual beeps indicate that the battery is running low.

Transmit Data

- Make sure that your mobile phone's Bluetooth is turned on.
- Open PAF Burden App. The App will try to auto connect with last connected device.
- Choose your ECG Patch in Device List if auto connecting failed.
- Click UPLOAD button to transmit data to the cloud through your phone.

Live ECG mode

- Choose your ECG Patch in Device List and click Start button.
- Your live heart waveform can be tracked and analyzed.

Handheld Electrode Pad

- Keep arms to be stable (for example, put them on a desk).
- Put thumbs onto the metallic Electrode Pad gently.
- Data will be saved in the device automatically, and can be uploaded after tested multiple times.
- And Live ECG mode in the App can also be chosen to show your real time waveform status.

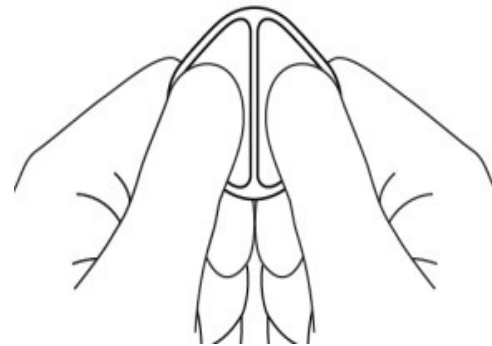
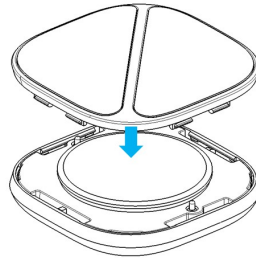

INFORMATION TO USER This equipment has been tested and found to comply with the limits for a Class B digital device, pursuant to Part 15 of the FCC Rules. These limits are designed to provide reasonable protection against harmful interference in a residential installation. This equipment generates, uses and can radiate radio frequency energy and, if not installed and used in accordance with the instructions, may cause harmful interference to radio communications. However, there is no guarantee that interference will not occur in a particular installation. If this equipment does cause harmful interference to radio or television reception, which can be determined by turning the equipment off and on, the user is encouraged to try to correct the interference by one or more of the following measures:

- Reorient or relocate the receiving antenna.

- Increase the separation between the equipment and receiver.

- Connect the equipment into an outlet on a circuit different from that to which the receiver is connected.

- Consult the dealer or an experienced radio/TV technician for help.

FCC COMPLIANCE STATEMENT This device complies with Part 15 of the FCC Rules. Operation is subject to the following two conditions: (1) this device may not cause harmful interference, and (2) this device must accept any interference received, including interference that may cause undesired operation.

WARNING The Changes or modifications not expressly approved by the party responsible for compliance could void the user's authority to operate the equipment.

Cautions:

- Device is not waterproof design. Do not wear the device in shower, sauna, swim or other similar activities.
- Keep distance from strong interference sources such as TV, computer, micro-wave, router, refrigerator, strong power supply, strong magnetic field etc. while wearing for better signal quality.
- Do not wear the device when undergoing an MRI.
- Use the correct type of battery specified by eCordum Inc.
- Dispose of the used batteries according to the instructions.
- WARNING: Choking hazard – device contains small parts.



419 1st Street
East Northport, NY 11731
USA
Made in China.

©2015 eCordum, Inc., all rights reserved.
eCordum is a trademark of eCordum, Inc.

