

bluesky 
Super 

**QUICK
START
GUIDE**

Package content

- Device
- Data cable
- Earphones
- USB power adaptor
- Quick start guide
- Screen protector



Their items supplied with the device and their images
May vary by region

Accessing more information

To view the full user manual on your device, launch the Settings app and tap User Manual.

- The user manual may not be available depending on the web browser or service provider.
- You may incur additional charges for accessing the internet.

Device layout

To turn on the device, press and hold the Power key for few seconds.

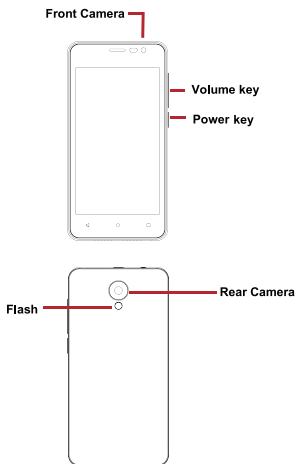

Installing a nano-SIM and a microSD card

Gently remove the battery door from the phone, slide and lift the SIM tray door and place the SIM card as shown in the picture below:

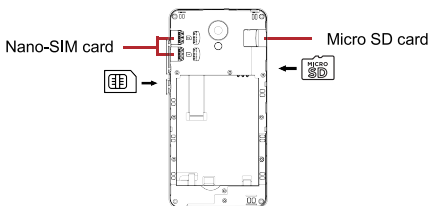

- If the card is not firmly to the tray, the card may leave or fall out of the tray.



Nano-SIM card, MicroSD card are sold separately.

Charging the battery

Before using the device for the first time, you must charge the battery.



The charger should remain close to the electric socket and easily accessible while charging.

Using the Home button

- When you turn on the device, the Home button will appear at the bottom of the screen as a soft button.
- When the screen is off, hard press the Home button until the device vibrates to turn on the screen.

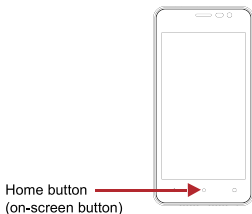

- To transfer data of the previous to a new device:
Please login to your Gmail account and sync all your content.

The actual available capacity of the internal memory is less than the specified capacity because the operating system and default apps occupy part of the memory. The available capacity may change when you upgrade the device.

Some content may differ from your device depending on the region, service provider, or software version, and is subject to change without prior notice.

Android and other marks are trademarks of Google LLC.
Oreo is a trademark of Mondelez International, Inc. group.

Safety Information

Read all safety information before using the device to ensure safe and proper use.



Warning

Follow the warning information provided below to prevent incidents such as fire or explosion.

- Do not expose the device to physical impact or damage.
- Use manufacturer-approved batteries, chargers, accessories, and Supplies.
- Prevent the multipurpose jack and battery terminals from Contracting conductive elements, such as metal or liquids.
- If any part of the device is cracked or broken, stop using the device immediately and take it to a Samsung Service Centre.
- Do not turn on or use the device when the battery compartment is exposed.

Follow the warnings below to prevent injury to people or damage for the device.

- Do not allow children or animals to chew or suck the device.
- If the device has a camera flash or light, do not use it close to the eyes of people or animals.
- The device can be used in locations with an ambient temperature of -10°C to 55°C. You can store the device or reduce the battery's lifespan.
- Do not use your device in a hot environment or near fire.
- Comply with all safety warnings and regulations regarding mobile device usage while operating a vehicle.
- To protect your eyes, do not stare at the iris recognition LED light when your eyes are less than 20 cm away from the device.



To prevent possible hearing damage when using a headset, do not listen to sound high volume for long periods.

To view the full safety information including device and battery disposal instructions, launch the **Settings** app and tap **About phone**→ **Legal information**→**Safety information**.

You can download and install the firmware update to upgrade your device's software with the firmware over the-air (FOTA) service. To check for the firmware update, launch the **OTA Update Service** app and tap **Available Update..**

Specific Absorption Rate (SAR) certification information

Your device conforms to U.S. Federal Communications Commission (FCC) standards that limit human exposure to radio frequency (RF) energy emitted by radio and telecommunications equipment.

SAR information on this and other model devices can be accessed online on the FCC's website through transition.fcc.gov/oet/rfsafety/sar.html.

In normal use, actual SAR is likely to be much lower, as the device has been designed to emit only the RF energy necessary to transmit a signal to the nearest base station. By automatically emitting lower levels when possible, your device reduces your overall exposure to RF energy.

The FCC has granted an Equipment Authorization for this model device based on the compliance of all reported SAR levels with the FCC RF exposure guidelines. This device has a FCC ID number: 2AKGQBSS45(Model:Super BSS45) and the specific SAR levels for this device can be found at the following FCC website: www.fcc.gov/ote/ea/.

Any Changes or modifications not expressly approved by the party responsible for compliance could void the user's authority to operate the equipment.

This device complies with part 15 of the FCC Rules. Operation is subject to the following two conditions:

- (1) This device may not cause harmful interference, and
- (2) this device must accept any interference received, including interference that may cause undesired operation.

Note: This equipment has been tested and found to comply with the limits for a Class B digital device, pursuant to part 15 of the FCC Rules. These limits are designed to provide reasonable protection against harmful interference in a residential installation. This equipment generates uses and can radiate radio frequency energy and, if not installed and used in accordance with the instructions, may cause harmful interference to radio communications. However, there is no guarantee that interference will not occur in a particular installation. If this equipment does cause harmful interference to radio or television reception, which can be determined by turning the equipment off and on, the user is encouraged to try to correct the interference by one or more of the following measures:

- Reorient or relocate the receiving antenna.
- Increase the separation between the equipment and receiver.
- Connect the equipment into an outlet on a circuit different from that to which the receiver is connected.
- Consult the dealer or an experienced radio/TV technician for help.

Specific Absorption Rate (SAR) information SAR tests are conducted using standard operating positions accepted by the FCC with the phone transmitting at its highest certified power level in all tested frequency bands, although the SAR is determined at the highest certified power level, the actual

SAR level of the phone while operating can be well below the maximum value, in general, the closer you are to a wireless base station antenna, the lower the power output

Before a new mobile phone is available for sale to the public, it must be tested and certified to the FCC that it does not exceed the exposure limit established by the FCC, Tests for each phone are performed in positions and locations (e.g. at the ear and worn on the body) as required by the FCC. For body worn operation, this mobile phone has been tested and meets the FCC RF exposure guidelines when used with an accessory designated for this product or when used with an accessory that contains no metal and that positions the handset a minimum of 1.0cm from the body.