

Wireless Door Viewer

USER GUIDE

FC Changes or modifications not expressly approved by the party responsible for compliance could void the user's authority to operate the equipment.

This equipment has been tested and found to comply with the limits for a Class B digital device, pursuant to Part 15 of the FCC Rules. These limits are designed to provide reasonable protection against harmful interference in a residential installation. This equipment generates uses and can radiate radio frequency energy and, if not installed and used in accordance with the instructions, may cause harmful interference to radio communications. However, there is no guarantee that interference will not occur in a particular installation. If this equipment does cause harmful interference to radio or television reception, which can be determined by turning the equipment off and on, the user is encouraged to try to correct the interference by one or more of the following measures:

- Reorient or relocate the receiving antenna.
- Increase the separation between the equipment and receiver.
- Connect the equipment into an outlet on a circuit different from that to which the receiver is connected.
- Consult the dealer or an experienced radio/TV technician for help.



307A+

Fashion ● Technology ● Taste

The Wireless Door Viewer is a 2.4G wireless high-tech household intelligent product integrating doorbell, photo-taking and monitor functions into one.

Adopting the latest power saving technology, its stable performance and fashionable appearance design make it the first choice of your high-quality intelligent life.

No wire construction, easy to install, simple to use, which makes it a professional solution for apartment and hotels. It can replace traditional peephole perfectly. Wireless distance could be up to 200meters in open area.

Introduction.....	3
Safety Warning & Attention.....	3
Product features.....	4
Product parameters.....	5
Product Diagram.....	6
Indoor handset.....	7
Installation Guide.....	7
Installation Steps.....	8
Battery Installation.....	9
Handset switch on/off.....	10
Outdoor unit modes setting.....	11
Doorbell.....	11
Photo-taking.....	12
Photo Preview.....	12
Photo Delete.....	12
Match code.....	13
Battery & charge.....	13
Configuration.....	14
Statement.....	14

Introduction

Thank you for choosing this Wireless Door Viewer. Please read this Manual carefully to fully understand its usage, perfect functions and simple operation.

The company reserves the right to modify this Manual from time to time without prior notice.

Safety Warning & Attention

1. Attention

- Do not place this product on an uneven or unstable table-board to prevent failure or damage caused by falling.
- Only the battery and charger designated by the Company can be used on this product. Application of other products may lead to leakage, overheating, blowout and fire of the battery.
- Do not violently strike, shake or toss the unit to prevent failure and fire
- Do not put battery, charger or the unit in the microwave oven or high-pressure device; otherwise, damage and fire of electrical circuit and other accidents may be caused.
- Do not use this product in a place with flammable and explosive gas; otherwise, product failure may be caused.
- Do not use it in places with high humidity and high temperature, amount of dust, otherwise, damage will be caused.

2. Attention for operation of this product

- Do not apply force on LCD screen or knock other objects with it, otherwise, breakage and damage of LCD panel and seepage of crystalline liquid will be caused. If the crystalline liquid enters your eyes, there will be danger of amblyopia. Wash your eyes (be sure not rub your eyes) and go to see the doctor immediately.
- Do not dismantle or remodel this product, otherwise, damage, creepage and electrical fault may be caused to this product.
- If this product is made wet by mistake, shut it down, remove the battery, and restart the product after confirming it complete dry after 24 hours.
- Do not have the metal parts (specially configured interfaces of charger and data line excluded) in contact with charger interface to avoid short circuit.
- Use clean and dry soft cloth to clean the lens.

! Warning: improper operation will void warranty !

3. Attention for operation of charger

- You may charge the device with a charger or through a USB data line connected to the computer.
- Charge with matched alternate current; creepage, fire and damage of the door phone and charger may be caused if other voltage is used.

- It is forbidden to short circuit the charge, otherwise, electrical shock, smoke and damage of the charger will be caused.
- Do not use the charger at the time when the power cord is damaged, otherwise, fire and electrical shock will be caused.
- Do not place a vessel used to retain water beside the charger to prevent overheating, creepage and failure of charger caused by spilling water.
- If the charger is in contact with water or other liquids, disconnect the power supply immediately to prevent overheating, fire electrical shock and failure of the charger.
- Do not dismantle or remodel this product, otherwise, damage, creepage and electrical fault may be caused to this product.
- Do not use the charger in places with high humidity such as bathroom, otherwise, electric shock, fire and damage of the charger will be caused.
- Do not touch the charger, electrical line and power outlet with wet hand(s), otherwise, electric shock may be caused.
- Do not place heavy objects on the electrical line or refit the electrical line, otherwise, electric shock and fire will be caused.
- Before cleaning and maintenance, first pull the plug off the power outlet.
- Grasp the charger while pulling off the plug, as pulling the electrical line will lead to damage of electrical line, electric shock and fire.

Product features



Doorbell



Photo-taking



One key monitor



Power saving



USB Charging



3.5 Inch screen



Photo preview



DIY Installation



Up to 200meters



Mode Switch



170° View



Store 100 photos

Product parameters

Outdoor camera and emitter	Power	Lithium battery 18650(7800mAh)
	Consumption	160mA
	Outline dimension	36*8mm
	Weight	280g
	Environmental condition	Temperature: -10℃~+50℃
	Waterproof grade	IP66
	Placement	Peephole
	Material	Metal,ABS
	Camera	300,000pixels
	View angle	170° wide angle
	Working time	About 39hours continuously
	Standby time (monitoring mode)	About 52days
	Standby time(power saving mode)	About 1year
	Charge time	About 12hours
	External power	DC5V 1A

Handset	Power	lithium battery BP-6M(1100mAh)
	Consumption	200mA
	Outline dimension	126*84*20mm
	Weight	110g
	Environmental condition	Temperature: -0℃~+40℃
	Placement	Table style (handheld)
	LCD size	3.5" TFT color screen
	Wireless connection mode	2.4GHz
	Images spread	25fps
	Picture format	JPEG
	Working time	About 5hours continuously
	Standby time	About 6days
	Charge time	About 3hours
	External power	DC5V 1A
	Application distance	About 200m in open space

Product Diagram

Outdoor camera

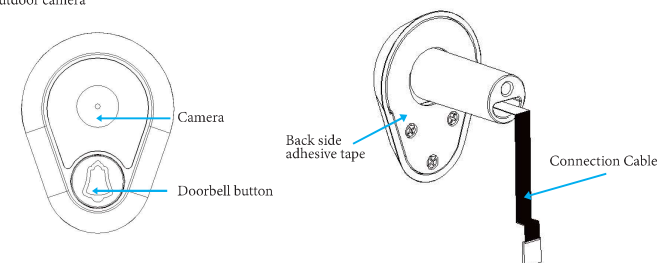

Key of outdoor camera (One key)

() Doorbell button: Press this button to call.

The emitter

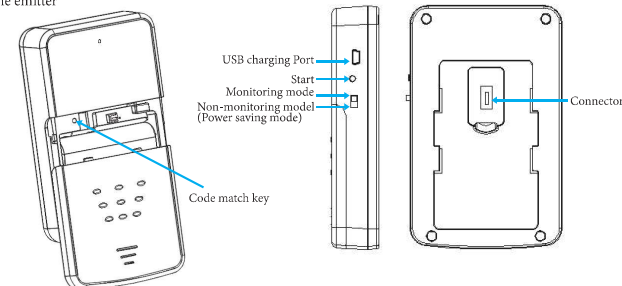

Keys of emitter (3pcs key)

1. ON/OFF (Power saving or non-saving power) Mode select key

ON: Monitoring mode (Can monitor outside from handset)

OFF: Non-monitoring mode (Power saving mode, can not monitor from handset by pressing "OK" button).

After choosing mode, please start up the emitter to confirm.

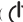
2. () Start up key: Insert battery, press this button to confirm mode.

3. Code match key "Reset": To match code with the indoor handset, incorrect using this button may make device work improperly.

Indoor handset

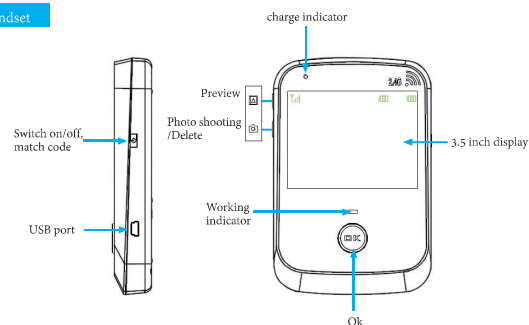

The keys of indoor handset (4pcs Key) :

1. () Turn on/ off key: hold press to switch on or off handset; Press once to match code when screen is on.
2. () Photo shooting/delete key: press once to take a photo, hold press to delete all photos.
3. () Preview: press to preview.
4. (OK Monitor key): ① In standby mode, press once, screen on.
② When screen is on, press again, screen off.
③ In monitoring mode, press to monitor outside from handset.

Installation Guide

1. Outdoor unit shall be installed at 1.4~1.7 meter above the floor.
2. The product is applicable to the door hole ϕ 14~30mm, door thickness 40~95mm.
3. The outdoor camera should not be hidden or blocked by other objects.
4. Do not face outdoor unit to sunlight directly.
5. Install the connection wire correctly, otherwise, normal use shall be failure.

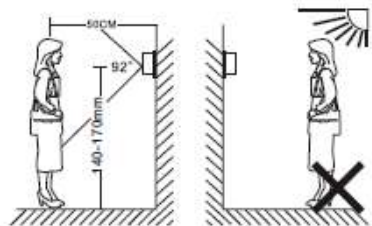

Installation Steps

Warning: flexible connection wire is a kind of flexible material, be sure to install it carefully. Do not pull it with force and avoid being damaged by sharp metal parts.

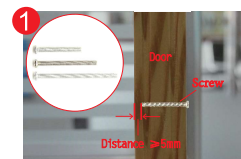

Choose a screw (Screw length should be, at least, 5mm less than door thickness.)



Mount screw.



Tear adhesive front paper.



Please use round steel board if door peephole is bigger than camera.



Wire goes through peephole from outside.

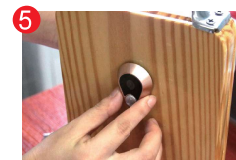

Adjust and fix camera.

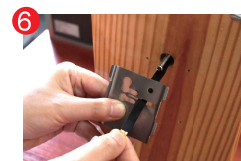

Cable socket goes through steel board (Indoor).



Hang steel board on screw.



Tighten screw to fix steel board.



Connect cable socket to connection base.



Cover back.



Protect cable before fixing emitter.



Buckle up emitter.

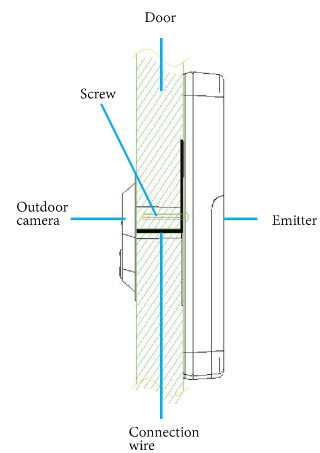

Battery Installation

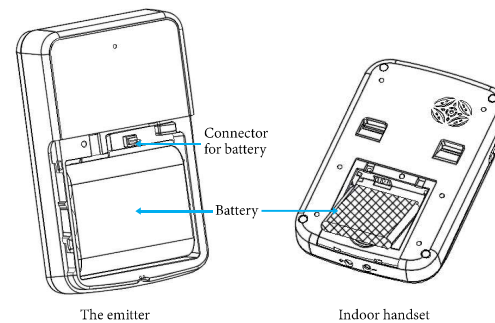

Handset switch on/off

Put battery into the handset, hold press "switch" button for about 3 seconds to start up.

Screen shows the starting page and enters into standby mode.

■ Display: the standby image, signal icon, power icon.

■ Press "OK" button to turn off the screen.

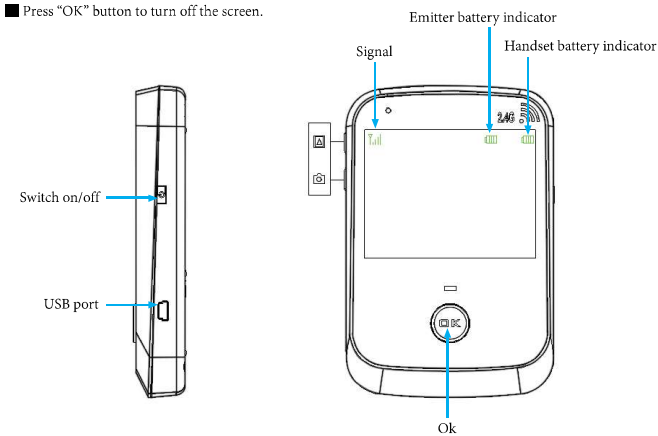

Modes Setting

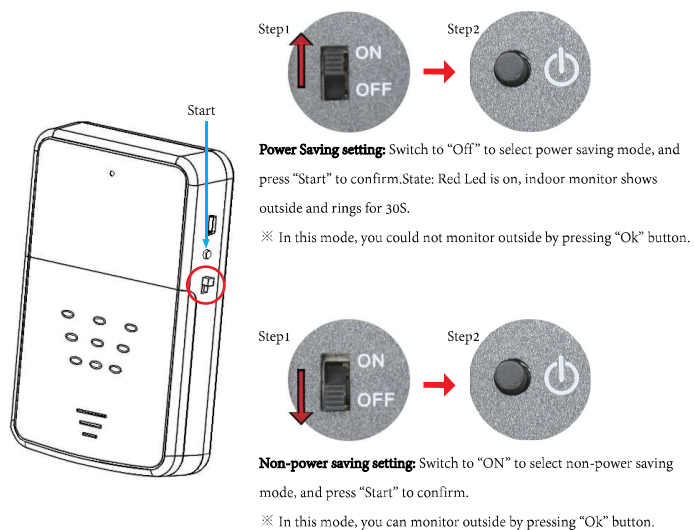

Doorbell

Doorbell: press doorbell, indoor monitor shows outside and rings for 30S. Press "OK" to stop ringing, press "OK" again to turn off screen.

Photo-taking

- Photo: during monitor - > press -taking photo - > one press one photo.
- End: press "OK" to turn off screen.

Photo Preview

In standby mode and when screen is on

- Preview: press , show the latest photos.
- Press again to check previous photo.
- Exit: Press to exit.

Photo Delete

In standby mode and when screen is on

- Delete: Hold press till display shows "Erase".

When "Erase" disappears, all photos deleted.

Note: All photos will be deleted!

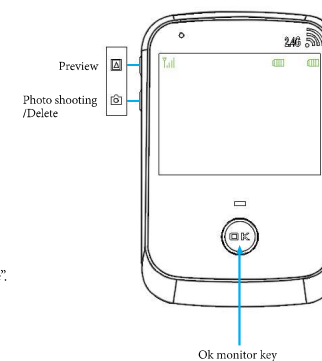

Match code

- Insert battery in emitter, press “Start” once, red indicator on.
- Switch on indoor monitor, when screen is on, press “switch” key quickly for 4 times, monitor displays “Pairing start”.
- At the same time, press “Reset” on emitter once, red indicator flashes.
- Till indoor monitors shows outdoor image, match code succeeds.

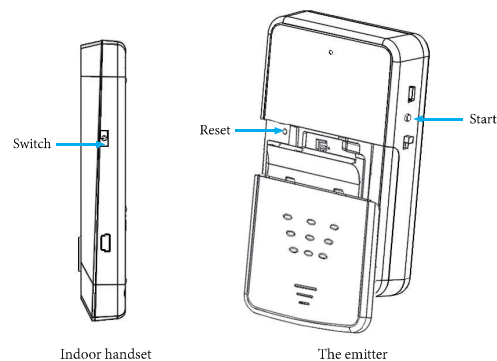

Battery and Charge

- Be sure the activity of the battery, please fully charge the new battery.
- When the outdoor unit is at low power, the lamp of emitter would flash. It remains you to charge.
- The battery of outdoor emitter can be changed or charged by USB. The green light keeps bright.
- When the handset is at low power (\leq a bar), the red indicator lamp will flash every second, please charge immediately.
- The handset can be charged by the USB line, green light keeps bright.
- Charge-and-work supported. When the battery is charged fully, it auto stops charging.
- Battery type: please use specified battery if needs replacement.
- Charging and battery attentions, please reference the chapter “Warms and attentions” in this manual.

Note: Under the low power, display, photo-taking functions can't work Properly.

Configuration

- Outdo camera --1
- Emitter --1
- Indoor unit --1
- Monitor table charger --1
- USB cable --1
- Charger (DC5V) --1
- Lithium battery (BP-6M) --1
- Lithium battery (18650) --1
- Screw M4 --3
- Steel board --1
- Round steel board --1
- Manual --1

Statement

This product supports 1 outdoor unit to 1 handset .The door peephole viewer has finished code match and can be used directly.