



VIDEO DOORBELL

SETUP & INSTALLATION *GUIDE*

Welcome!

Thanks for choosing iseeBell product.

If you need extra help, iseeBell Support Team is available 24/7.

And you can access our online resources anytime at: iseebell.com

Contact iseeBell Support Team directly at :

1.888.600.4010

support@iseebell.com

VIDEO DOORBELL

Meet the front and back of your iSeeBell

Front

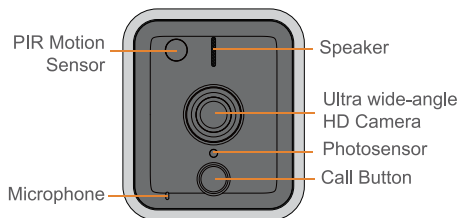

Back

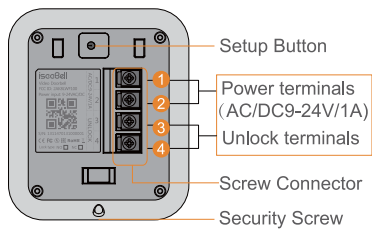

Wall Bracket

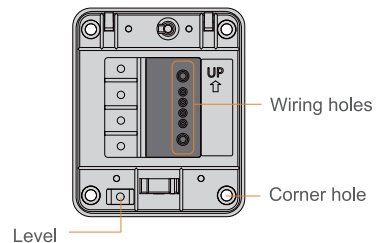

VIDEO DOORBELL

What's in the box



Wi-Fi Video Doorbell

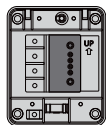

Wall bracket

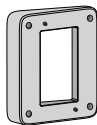

Wedge bracket

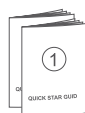

Quick start guide

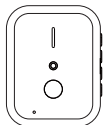

Indoor Chime



AC wall adapter



AC power adapter



Tool kit

Before you start

- If you're installing on concrete, brick, or stucco surface, get a power drill ready.
- Do not install iSeeBell on a metal surface as it may block and/or weaken the Wi-Fi signal.
- ISeeBell works well with standard U.S. doorbell wires.
- If you don't have existing wires or you want to use iSeeBell as an indoor security cam, we've included an AC power adapter (input 100-240V) in the box.
- You can still choose to run new wires, as long as the operation output voltage to iSeeBell is 9-24V AC/DC.
- ISeeBell Video doorbell supports 2.4 Ghz Wi-Fi network only. Please switch your mobile device accordingly if it connects to a 5Ghz network.
- Move your router close to your iSeeBell if your Wi-Fi signal is weak, or invest in a Wi-Fi extender.

VIDEO DOORBELL

Step1 Download the iseeBell App

The App will walk you through the process outlined in this manual. We've also included that in the In-app Setup manual.

Search for "iseeBell Video Doorbell" in any of these app stores: App Store or Google Play.



IOS 8.0 or above

Android 4.4.0 or above

- ❗ iseeBell only supports 2.4Ghz Wi-Fi network. If you are connecting to a 5Ghz network, switch it to a 2.4Ghz instead.

Step 2 Power up your iseeBell Doorbell

- Connect the wires of the power adaptor to the power terminals on the back of iseeBell Video Doorbell. It doesn't matter which wire connects to which screw.
- Plug the power adaptor to a wall outlet (100-240V).
- The front Call button lights up.

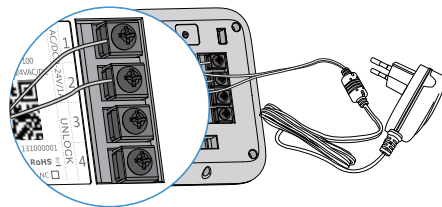

VIDEO DOORBELL

Step 3 Perform the in-app setup

- Log in to the iseeBell App.
- Select the plus sign to set up a new device. You will need your Wi-Fi network name and password.
- As much as is possible, try to perform the setup near your router.
- It may take a little while for iseeBell to upgrade to its latest firmware version. Power cycle the device and try again if setup fails multiple times.

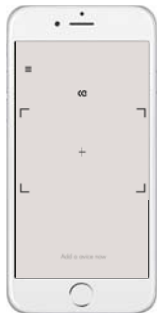

Step 4 Run a test

- After setup, run a test by touching the front button on your iseeBell doorbell indoors near your router to view video.
- Then test the doorbell outside.
- If the outside doorbell video quality is not as good as the indoors, you may need to move your router closer to the door, or buy a Wi-Fi extender.

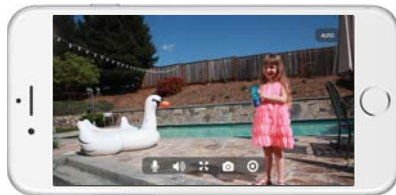

VIDEO DOORBELL

Step 5 Remove Your Existing Doorbell (optional)

- If you're replacing a wired doorbell, turn off the power at the breaker first.
- Remove doorbell from the wall.
- Disconnect the wires.

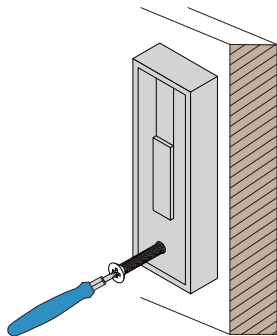

VIDEO DOORBELL

Step 6 Install Wall Bracket

- First, piece the wires from your wall through wiring holes on the Wall bracket.
- Use the bracket and the small level as a template to position.
- Mark the four corner holes.
- On stucco, brick, or concrete install the anchors using a power drill and the drill bit provided.

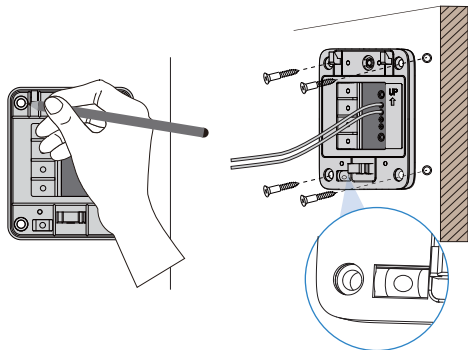

- Drive the screws into the anchors, or directly into your wall until they are flush with the Wall bracket, and the bracket is flat against your wall.
- On wood or siding, you can screw directly into your wall.
- Use the Phillips-head end of the iseeBell screwdriver to screw in your Wall bracket.

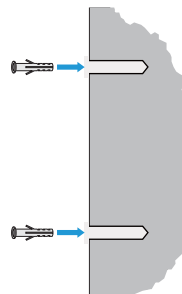

VIDEO DOORBELL

Step 7 Install Wedge Bracket (Optional)

In a Wedge bracket, you will find:
two short screws
two long screws

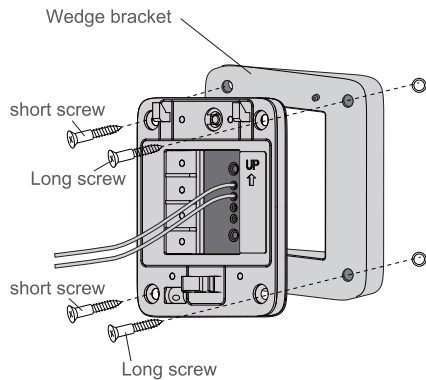

VIDEO DOORBELL

Step 8 Connect wires to iseeBell

- Connect wires to the screws on the back of iseeBell in any order.
- Your new wiring must be connected to a power supply voltage of 9-24 V AC/DC if you don't have existing wire walls.
- If you cannot connect your wires to the screws directly, use the extra wires we provided. Simply connect the "fork end" to the screws first,

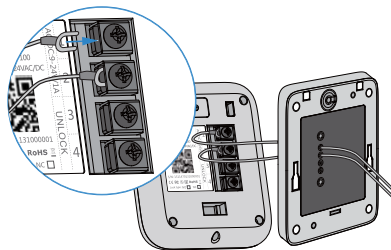
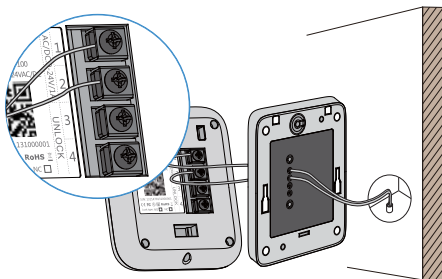

VIDEO DOORBELL

Connect wires to iseeBell (continued)

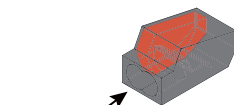

a) Insert the other end to the wire connector.

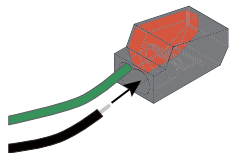

b) Insert the wire from your wall to the wire connector.

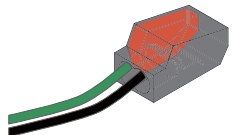

c) Both wires should reach to a completely stop and feel secure.

Step 9 Attach your doorbell to the bracket

- Line up the holes in your iseeBell Doorbell with the slots on the bracket.
- Push firmly towards the wall and then down.

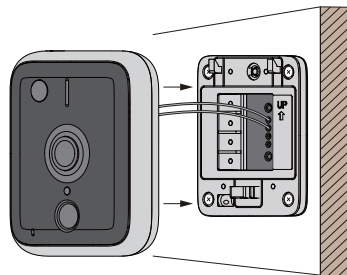

VIDEO DOORBELL

Step 10 Secure Your iseeBell Doorbell

- Use the star-shaped end of your iseeBell screwdriver to tighten the security screws on the bottom of your iseeBell Doorbell.
- Then restore power at the breaker.

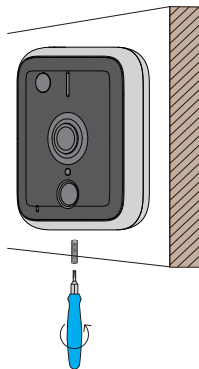

Step 11 Adjust the existing chime (optional)

- Take off the cover of your mechanical chime.
- Use the wire provided to connect to "front" and "trans".
- Put the cover back.

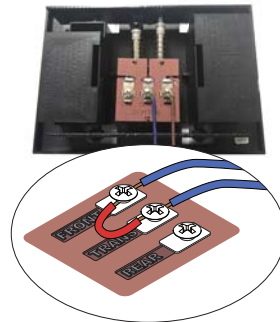

VIDEO DOORBELL

Step 12 Connect iseeBell to your lock (optional)

If you need to connect your lock to iseeBell Doorbell, follow the wiring diagram and connect required wires to Lock terminal screws.

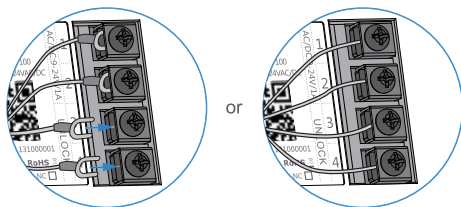

VIDEO DOORBELL

Access Control System Wiring Diagram

a. Normally Open (NO), e.g. Electric Strike

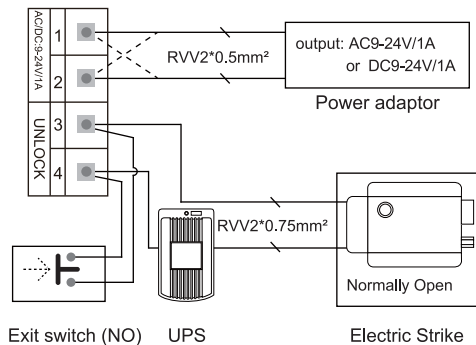

b. Normally Closed (NC), e.g. Magnetic Lock

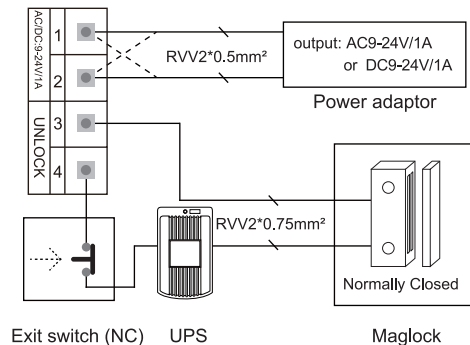

WARNING

Changes or modifications not expressly approved by the party responsible for compliance could void the user's authority to operate the equipment

NOTE:

THE MANUFACTURER IS NOT RESPONSIBLE FOR ANY RADIO OR TV INTERFERENCE CAUSED BY UNAUTHORIZED MODIFICATIONS TO THIS EQUIPMENT. SUCH MODIFICATIONS COULD VOID THE USER'S AUTHORITY TO OPERATE THE EQUIPMENT.

This device complies with Part 15 of the FCC Rules. Operation is subject to the following two conditions:

- (1) this device may not cause harmful interference
- (2) this device must accept any interference received, including interference that may cause undesired operation.

NOTE:

This equipment has been tested and found to comply with the limits for a Class B digital device, pursuant to Part 15 of the FCC Rules. These limits are designed to provide reasonable protection against harmful interference in a residential installation.

This equipment generates, uses and can radiate radio frequency energy and, if not installed and used in accordance with the instructions, may cause harmful interference to radio communications. However, there is no guarantee that interference will not occur in a particular installation. If this equipment does cause harmful interference to radio or television reception, which can be determined by turning the equipment off and on, the user is encouraged to try to correct the interference by one or more of the following measures:

- Reorient or relocate the receiving antenna.
- Increase the separation between the equipment and receiver.
- Connect the equipment into an outlet on a circuit different from that to which the receiver is connected.
- Consult the dealer or an experienced radio/TV technician for help.

This equipment complies with FCC RF radiation exposure limits set forth for an uncontrolled environment.

Enjoy your iseeBell Video Doorbell

Thanks for helping to make you and your family safer.