

Shenzhen Yuetu Network Technology Ltd.

User's manual

HaloCam

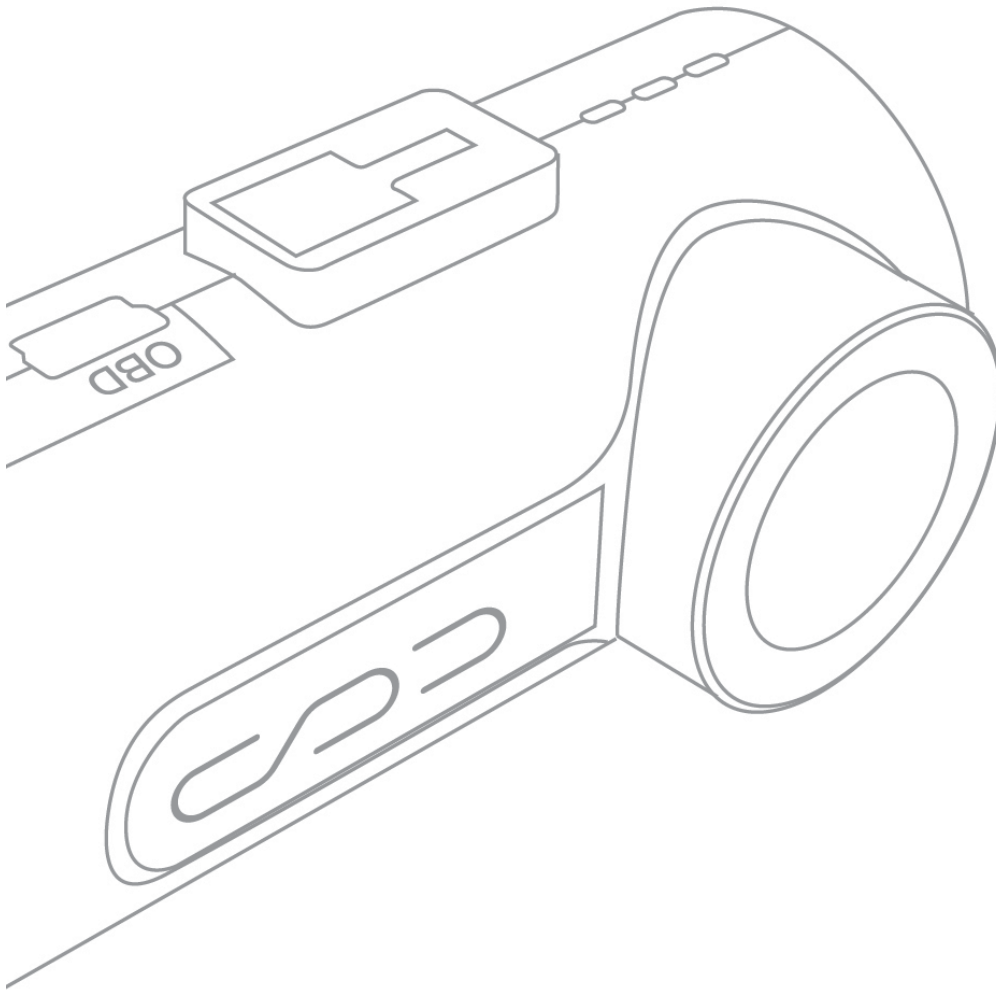

HaloCam C1

1 Accessory List

Standard Accessories

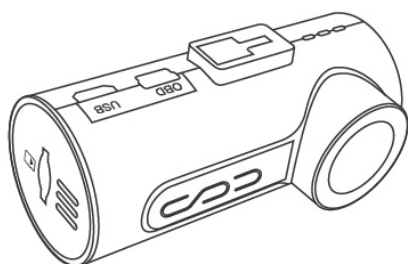

Main Unit

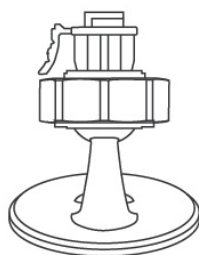

Holder

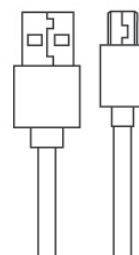

USB Power Cord



OBD Power Cord



GPS Cord

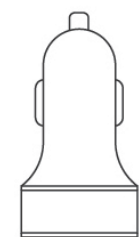

Charger

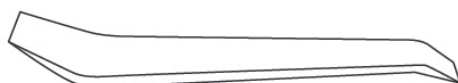

Pry Bar



Remote Control

Optional

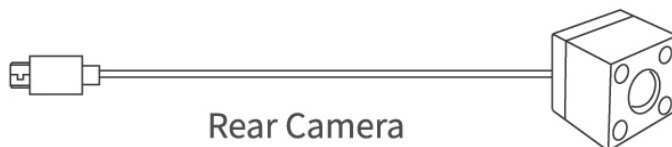

Rear Camera

2 Structure & Button

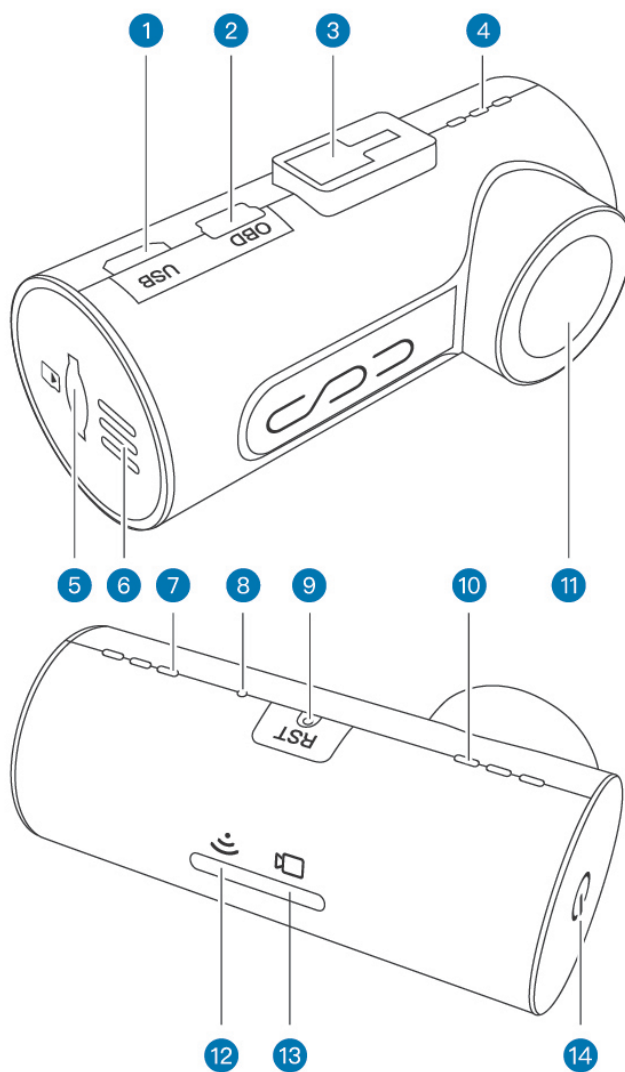

- | | |
|-------------------------|----------------------------|
| 1 Rear Camera Port | 8 MIC |
| 2 OBD Power Port | 9 RESET |
| 3 Holder Slot | 10 Heat Dissipation Hole |
| 4 Heat Dissipation Hole | 11 Front Camera |
| 5 Card Slot | 12 WiFi Indicator Light |
| 6 Speaker | 13 Working Indicator Light |
| 7 Heat Dissipation Hole | 14 Power Button |

3 Remote Pairing

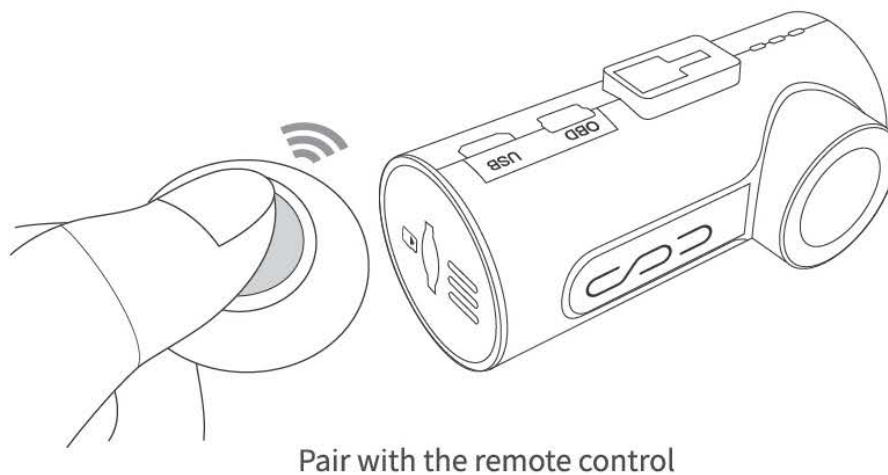

Step 1:

Before pairing, please make sure the device is powered on. Please open the back cover of the remote, and put the battery in. Then bring the remote to the device.

Step 2:

Keep the remote close to the device for 5 seconds until you hear an indication tone, which means the pairing is completed. If the pairing failed, please remove the battery and repeat the first step.

4 Power Line Wiring

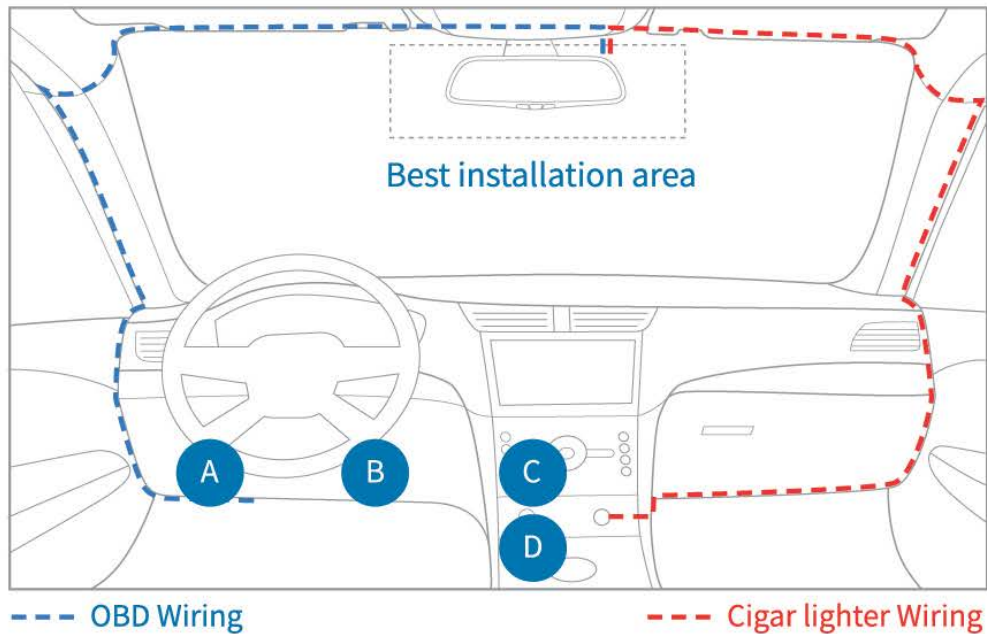

• Power supplied by car charger:



Please choose the 2.1A output if you use USB Power Cord from the car charger to connect the device. We suggest to use HaloCam car charger to avoid any potential malfunctions.

• Power supplied by OBD Port:

Please refer to the blue dotted line to insert the power adapter into the OBD port.

The OBD ports are usually black, white, purple or blue. Suggesting locations are as below:

Area A: Most models of GM, Volkswagen, BMW, Ford, Toyota, Hyundai, Citroen.

Area B: A small amount of models of Volkswagen Touran and Lexus.

Area C: A small amount of models of Citroen.

Area D: A small amount of models of Citroen.

•Version Updates

- (1) App and firmware updates will be provided to enhance user experiences, including new functions and better performance.
- (2) New updates can be found at “**More - Version Updates**” when new version is released. Please download the updates in WiFi environment and connect the device.
- (3) The update will take about 3-4 minutes, the red light will constantly flash during the updating. Please do not turn off the power or unplug the TF card. The device will restart automatically when finishing updating . If the updating failed, please contact our customer service for further instruction.

6 App Instructions

• App Download

Option 1:

Scan the QR code to download.

Option 2:

Search “HaloCam Auto” in App Store and Google Play.

Option 3:

Visit our official website via mobile phone:

<http://m.aidrive.com/download>



• Connect to the device WiFi

- (1) Open “wireless network” in your mobile phone setting, select the network name as “Halocam-xxxxxx”, the default password is 12345678. If you forget the password after modification, please contact our custom service.
- (2) The mobile phone and device are connected via private network connection; No extra network traffic fees.

• Preview, Playback and Download

- (1) **Preview:** After connecting your phone to the device, the preview should show currently recorded video by default.
- (2) **Playback:** Enter the “Media” to view more videos and pictures.
- (3) **Download:** You can download videos or pictures in “Media”.

• Picturing, Wonderful Recording and Download

- (1) **Picturing and Wonderful Recording:** A 10-seconds wonderful video will be recorded when press the remote control or click “take picture” on App preview page. A 15-seconds alert video will automatically recorded when the device detect abnormal shocks.
- (2) **Download:** The pictures and wonderful videos are saved in TF card. You can download them via “Media” in the App when you connect to the device. The App will download intraday pictures and wonderful videos if you choose “Automatically download” in the settings. If “automatically download” is turned off, you will can manually download or delete the files.
- (3) **Sharing:** You can share your pictures and videos to social network.

· ADAS * 1

- (1) Provide “Forward Collision Warning” and “Lane Departure Warning” to ensure your safety.
- (2) Please connect the App to calibrate the device first. Click the “ADAS Adjust” button on the page of preview, follow the guidelines to adjust the installation angle and make sure the device is parallel to horizon.
- (3) ADAS is disabled by default. You can turn it on via “More - Setting - Security Tips Settings”.
- (4) you're your driving safety, the ADAS will be disabled when the device is connected to App. ADAS will be enabled after disconnecting the Apps.

· HUD(Head Up Display) * 2

Through the phone, the Speed, Rotational Speed, Fuel Consumption and other information will be projected on the front windshield of vehicle. The driver do not have to bow his head to check the information. They can focus more on driving, and the safety can be improved.

· Vehicle Condition Detection * 2

Monitor the condition of the vehicle at all times via OBD port. Once a problem occurs, it will automatically feed back to the user and give professional advice.

· 0-100km Speed Measurement * 2

0-100km Speed Measurement can provide professional visual graphic display, including the G-Value curve, the accelerated curve, and test results. To be more stylish and appealing!

· Driving Path * 2

- (1) History path and driving habits are recorded to auto-manage your driving route.
- (2) To view the driving path and related data, please connect the App with the device for further processing and analysis. Furthermore, if your mobile phone is Android phone, due to system limitation, please disconnect with the device WiFi and connect to mobile network to continue further processing.

* 1 : Due to the complexity of driving, ADAS could not be 100 percent accurate. There could be mis-notifications existed in actual situations. Hence please DO NOT rely 100% on the ADAS system. Your own experience is also crucial for your own safety.

* 2: Due to different compliances with OBD, some vehicle models might not support the OBD port in power suppliant and data acquisition. Under this situation, please use cigar lighter to supply the power. Part of the functions such as HUD, Vehicle Condition Detection, 0-100km Speed Measurement and Driving Path cannot be supported under this situation as well.

7 Attention

- (1) The storage temperature should be between -20°C to 70°C.
- (2) Improper change of battery could lead to explosion. Please use same type of battery on the device.
- (3) Do not use irritating chemical solvents for cleaning. Slightly wet paper tissue or soft cloth are suggested.
- (4) For environmental protection, please do not throw away or into fire in case of explosion.
- (5) Do not try to detach the machine or repair by yourself. If the device failed, please contact our official Email.
- (6) For more details or settings, please enter “More-Use Help”.

8 Contact Us

- ✉ service@aidrive.com
- 🏠 www.aidrive.com

Shenzhen Yuetu Network Technology Ltd. reserve the right to change the product and material without further notice.

FCC Statement

This equipment has been tested and found to comply with the limits for a Class B digital device, pursuant to part 15 of the FCC rules. These limits are designed to provide reasonable protection against harmful interference in a residential installation. This equipment generates uses and can radiate radio frequency energy and, if not installed and used in accordance with the instructions, may cause harmful interference to radio communications. However, there is no guarantee that interference will not occur in a particular installation. If this equipment does cause harmful interference to radio or television reception, which can be determined by turning the equipment off and on, the user is encouraged to try to correct the interference by one or more of the following measures:

- Reorient or relocate the receiving antenna.
- Increase the separation between the equipment and receiver.
- Connect the equipment into an outlet on a circuit different from that to which the receiver is connected.
- Consult the dealer or an experienced radio/TV technician for help.

To assure continued compliance, any changes or modifications not expressly approved by the party.

Responsible for compliance could void the user's authority to operate this equipment. (Example - use only shielded interface cables when connecting to computer or peripheral devices).

This equipment complies with Part 15 of the FCC Rules. Operation is subject to the following two conditions:

- (1) This device may not cause harmful interference, and
- (2) This device must accept any interference received, including interference that may cause undesired operation.

RF warning statement:

The device has been evaluated to meet general RF exposure requirement. The device can be used in portable exposure condition without restriction.