

Battery camera kit with touchable monitor manual



Model: NVR-0704mt

Product name: Net Video Recorder

Company: SHENZHEN DC Times Technology CO.,LTD

Address: Floor 3, Building J, Jinchangda, No. 2000089, Shangwei industrial zone, Zhangkengjing community, Guanhu Town, Longhua New District, Shenzhen, Guangdong Province, China

Statement

It is highly appreciated for you buying our products, the main application of our product will be introduced in this guide. Please feel free to contact us if you have any question, and further information will be found on our WEBSITE and technical supporting center. We will not give another information about the inaccurate content in this guide, since the product be updated or changed with software or hardware. If there is any discrepancy between the product description and the actual product, the actual product shall prevail.

Safety Caution

1. In order to make the machine work normally for a long time, the machine should be placed in a relatively dry and dust-free space. Avoid short circuits caused by the machine being wet.
2. Check adaptor voltage, prevent damage device since using wrong adaptor.
3. The machine should work at the range of the temperature and humidity allowed by the technical index.
4. It should be avoided that the machine be set in the vibration environment.
5. Installation of the machine have to comply with local or national standard.

Interface description

NVR interface description

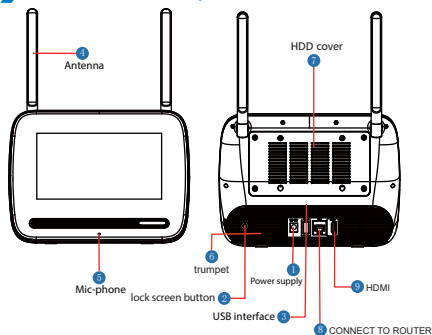

- 1 Power interface: 1 hard disk with screen 12V/3A
- 2 Lock screen button: turn on/off screen display
- 3 USB interface: 1 USB 2.0 interface (support upgrade, and mouse)
- 4 Antenna: for wireless signal transmission
- 5 Microphone: support microphone voice intercom
- 6 Speaker: Audio output
- 7 Hard Disk: Support 2.5" 2TB SSD

IPC

Mini NVR can be combined with different cameras to form a kit. The interface description below only takes common cameras as an example. Please refer to the actual interface position of the camera in the package.

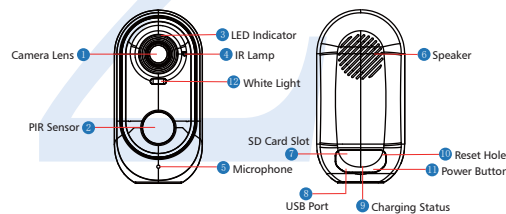

The instructions of LED light :

- Blink Slowly in Red: Awaiting Wi-Fi connection, ready for adding devices
- Blink Fast in Red: Wi-Fi connecting
- Solid in Red: Network problem
- Solid in Blue: Wi-Fi connected, camera running normally
- Blink Slowly in Blue: Firmware update

Button operation for Two-button model:

- Power Button: Keep pressing for 5-10 seconds to power on/power off
- Reset Button: Keep pressing for 5-10 seconds to reset

RF Exposure Warning Statements:

This equipment complies with FCC radiation exposure limits set forth for an uncontrolled environment. This equipment shall be installed and operated with minimum distance 20cm between the radiator & body.

4. Operation instruction



Preview interface

Click on the screen and it will pop up menu button"
" " to open or close the preview interface channel volume, click " " zoom button on single screen, enter into the magnification screen to display it, click " " to enter into the main menu interface, click " " enter into the video playback interface, click " " enter into PTZ control interface.

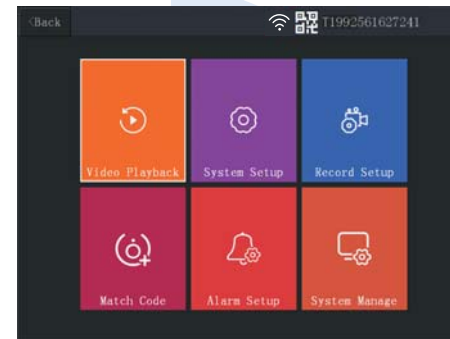

Main menu

- Video playback: Play recorded video
- System setup: System related settings (language, time, network settings, etc.)
- Record setup: Set the recording schedule, TF card information and formatting
- Match code: Add camera
- Alarm setup: Set mobile alarm, APP alarm and other functions
- System manage: system information, factory settings, host upgrade, IPC upgrade, etc.

Add wireless camera

Before leaving factory, the camera has been matched with Wireless NVR with Touch screen, the image will come out when the kit is powered. If users need to re-match code, please operate as below:

Step 1: The user starts the recorder and camera, and the IPC reset enters the code mode.

Step 2: Enter the code interface, click on the code to match.

Tips:

- 1). The camera can only perform the pairing in the reset state; the camera usually presses the reset button to perform the pairing code.
- 2). If the camera still does not match the code after the code has timed out, click "Match Code" again to try again.
- 3). If you need to replace a new camera, please click "X" to delete the channel and then click on the code to match.

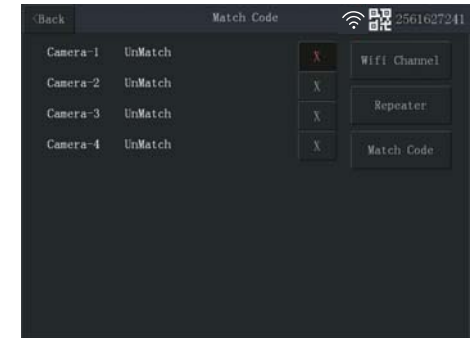

Wireless internet access

Enter the main interface, select system settings, select wireless Internet access, and make wireless connection settings.

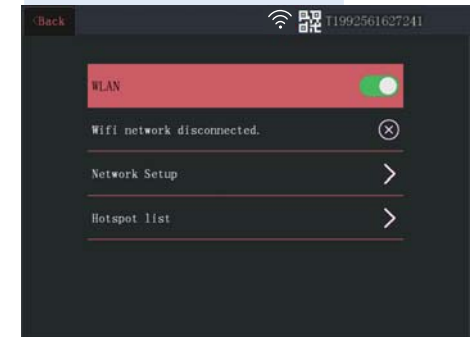

Step 1: Open WLAN

Step 2: Click "Hotspot list" to select the name of the wireless hotspot you want to connect to.

Step 3: Enter the correct password

Step 4: Click "Back" exit to the wireless settings interface to view the wireless connection status, indicates successful connection.

Tips: After the network configuration is successful, wait a while (about ten seconds), and wait until the network icon in the upper right corner changes.

indicates that the device is online (APP can be viewed remotely).

APP remote viewing video

1 Download and install

You can search for "EseeCloud" in App Store, App Store and other application markets to download. Or scan the QR code below to download.

Note: Apple mobile phone system requires iOS system 9.0 or above, Android mobile phone system requires Android 5.1 or above.



2 Registration and Login

- 1). Click Register, input your mobile phone number/email, input the verification code, and complete the registration;
- 2). Enter your registered mobile phone number and password on the login interface, and click Login;
- 3). Click the third-party application icon at the bottom of the login interface, and you can log in successfully after completing the authorization.

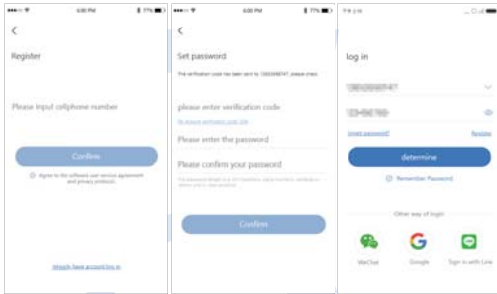

3 Add device

- 1). Click "+" on the device list interface to add a camera;
- 2). Scan the QR code on the recorder (click the QR code icon in the lower left corner of the video preview interface);
- 3). Set the device name to add successfully.

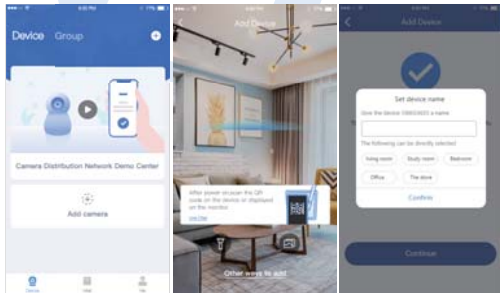

View video screen and video playback

Device List Click the device card to enter the video preview interface, select View Playback to view the channel video recording of the recorder.

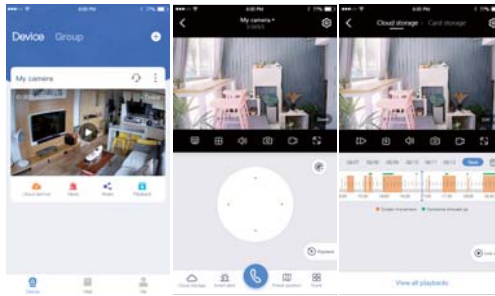

(Tips: Please make sure that your video recorder is connected to the Internet when using the EseeCloud APP to add and view the video recorder screen)

Daily update maintenance

Enter the main interface, select system management, enter into the system management interface.

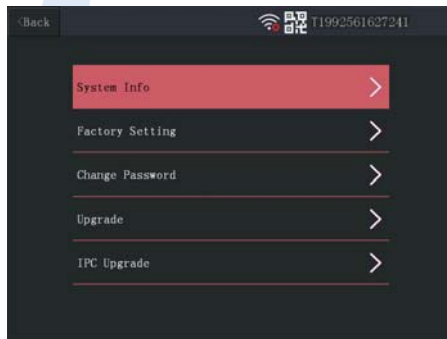

- System info: Including device model, cloud ID, software version, etc.
- Factory setting: Includes simple restore and restore all settings
- Change password: Modify the remote access login password
- Upgrade: Device-side main engine upgrade
- IPC upgrade: Upgrade the camera

Extend Wireless Range

As can be seen from the bar antenna gain chart as shown on the right, the signal coverage of the antennas is similar to an apple. The antenna is located in the center of the apple, and the signal around the antennas is strong. The upper and lower ends of the antenna are recessed, and the signal is weak.

Reasonably adjust the antenna and optimize the signal radiation direction

As can be seen from the bar antenna gain chart as shown on the right, the signal coverage of the antennas is similar to an apple.

The antenna is located in the center of the apple, and the signal around the antennas is strong. The upper and lower ends of the antenna are recessed, and the signal is weak. According to the signal transmission characteristics of the antenna, in order to ensure the optimal image transmission effect of the wireless NVR Kit, it is required:

1. The antennas of the NVR and IPC should be placed in a high and open place, and not near the walls, metal, glass and other obstacles, which will affect the signal's outward divergence.
2. The antenna of the IPC should be placed in parallel with the NVR antenna as much as possible so that the respective maximum radiation direction angles are opposite to form the maximum signal coverage, as shown in the figure below.

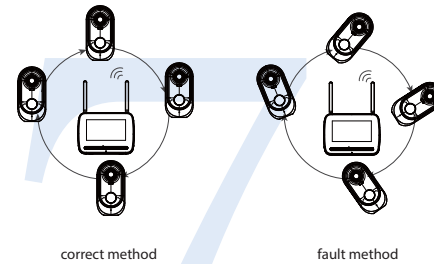
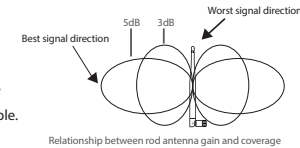

FAQ

Q: Does the battery support charging? How to charge?

A: Support charging, battery switch to "OFF", connect to the power adapter.

Q: How long does the fully charged battery work?

A: Generally it can reach about 1-2 hours (When you need to use battery power, you need to turn the battery switch to "OFF", connect the external power supply and activate it before it can be used normally.).

Q: Does it support voice intercom, how to talk?

A: Support voice intercom, select the intercom IPC channel, zoom in, click the intercom icon, long press the icon to speak, the intercom function can be realized; when released, the speech ends.

Q: How to turn the alarm sound/doorbell button prompt on or off?

A: Enter the main menu, select the alarm setting, adjust the alarm volume, set the alarm volume to 0, mean turn off all alarm sounds; set to non-zero value, mean the alarm sound turned on.

Warning

Warning

Notes:

Device will not in guarantee if caused by below reason:

- 1 Accident; negligence; disaster; mis-operation.
- 2 Do not conform to the environment and conditions, such as power improper, working temperature too high or too low, lightning stroke, etc.
- 3 Ever be maintained by other center which not belong to the real factory.
- 4 Goods already sold more than 12 months.



FCC RADIATION NORM

FCC

This device complies with Part 15 of the FCC Rules. Operation is subject to the following two conditions:

- (1) this device may not cause harmful interference, and (2) this device must accept any interference received, including interference that may cause undesired operation.

FCC Compliance Statement

These limits are designed to provide reasonable protection against frequency interference in residential installation. This equipment generates, uses, and can radiate radio frequency energy, and if not installed or used in accordance with the instructions, may cause harmful interference to radio communication.

However, there is no guarantee that interference will not occur in television reception, which can be determined by turning the equipment off and on. The user is encouraged to try and correct the interference by one or more of the following measures:

- Reorient or relocate the receiving antenna.
- Increase the separation between the equipment and the receiver.
- Connect the equipment into an outlet on a circuit different from that to which the receiver is connected.
- Consult the dealer or an experienced radio/TV technician for help.

CAUTION!

The Federal Communications Commission warns the user that changes or modifications to the unit not expressly approved by the party responsible for compliance could void the user's authority to operate the equipment.

NOTE: This equipment has been tested and found to comply with the limits for a Class B digital device, pursuant to part 15 of the FCC Rules. These limits are designed to provide reasonable protection against harmful interference in a residential installation.

This equipment generates, uses, and can radiate radio frequency energy and, if not installed and used in accordance with the instructions, may cause harmful interference to radio communications. However, there is no guarantee that interference will not occur in a particular installation. If this equipment does cause harmful interference to radio or television reception, which can be determined by turning the equipment off and on, the user is encouraged to try to correct the interference by one or more of the following measures:

- Reorient or relocate the receiving antenna.
- Increase the separation between the equipment and receiver.
- Connect the equipment into an outlet on a circuit different from that to which the receiver is connected.
- Consult the dealer or an experienced radio/TV technician for help.

NOTE: This equipment has been tested and found to comply with the limits for a Class B digital device, pursuant to part 15 of the FCC Rules. These limits are designed to provide reasonable protection against harmful interference in a residential installation. This equipment generates uses and can radiate radio frequency energy and, if not installed and used in accordance with the instructions, may cause harmful interference to radio communications. However, there is no guarantee that interference will not occur in a particular installation. If this equipment does cause harmful interference to radio or television reception, which can be determined by turning the equipment off and on, the user is encouraged to try to correct the interference by one or more of the following measures:

- Reorient or relocate the receiving antenna.
- Increase the separation between the equipment and receiver.
- Connect the equipment into an outlet on a circuit different from that to which the receiver is connected.
- Consult the dealer or an experienced radio/TV technician for help

Changes or modifications not expressly approved by the party responsible for compliance could void the user's authority to operate the equipment.

This device complies with Part 15 of the FCC Rules. Operation is subject to the following two conditions:

- (1) this device may not cause harmful interference, and (2) this device must accept any interference received, including interference that may cause undesired operation.

4折页后再对折 风琴折

420x285mm/128g铜版纸/双面彩印