

# FuzeX

User Manual

Please read the manual carefully before using FuzeX Card

## Getting started with FuzeX Card

01

- First create an account on X Manager App/Website then turn the card on by pressing the power button once. (<http://fuzex.co>)
- Please check FuzeX Card and charging eCHARGER's battery levels and fully charge before using them.
- Please make sure FuzeX Card is in its charging eCHARGER during firmware updates and turned on.
- Always have FuzeX Card in its charging eCHARGER when updating.

## Safety Caution

02

- Do not place heavy objects on top of FuzeX Card.
- Do not deliberately bend the card. Parts inside could get damaged.
- Keep FuzeX Card away from flammable sources.
- Keep FuzeX Card away from water, alcohol and Benzene etc.
- Keep FuzeX Card away from humid and dusty conditions.
- Keep FuzeX Card away from magnetic products.
- Do not disassemble or modify FuzeX Card on your own.
- To dispose of FuzeX Card, cut along the dotted lines on back side of product.
- Keep FuzeX Card in its charging eCHARGER while updating firmware.
- Do not use FuzeX Card in humid places. (eg.Sauna, Spa)
- Sign your signature on FuzeX Card with an oil-based pen.
- In low temperature conditions, the display may show a slight after image.
- FuzeX Card may not be compatible with some POS depending on its terminal type.

## Features and Role of FuzeX Card

03

### <FuzeX Card>

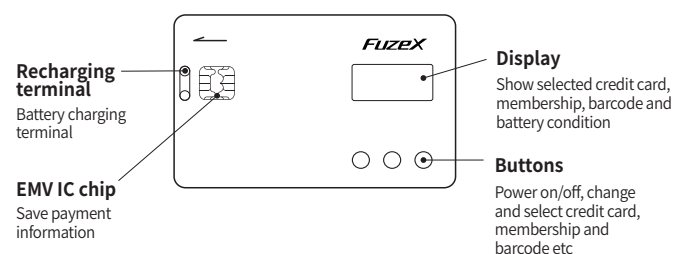

<Please note that the functionality of the control buttons may be changed after you upgrade the software.  
For more information about buttons and display, please check our website or App.>

## Features and Role of FuzeX Card

04



- 1 Power/Change the selection(Left)**  
Press and Hold down button to turn ON/OFF the card.  
Simply press button to select card to the left.
- 2 Hold the current card**  
**Change the selection(Right)**  
Press and Hold down button to lock current card on the display.  
Simply press button to select card to the right.
- 3 Change the Mode**  
Press and hold down button to go into multi display  
Change the payment and membership type by simply pressing the button.

## Features and Role of FuzeX Card

05

### <eCHARGER>

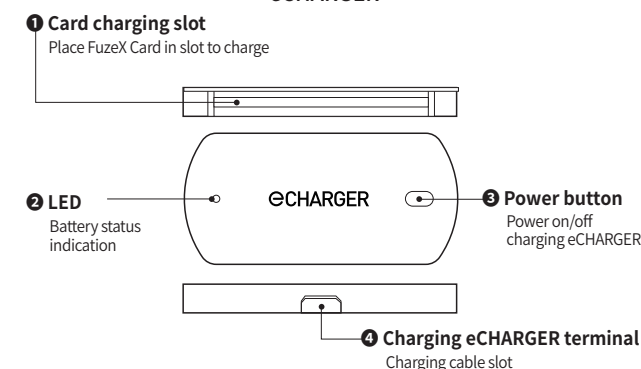

eCHARGER can double as a portable charger for your FuzeX Card with built-in battery.

## How to charge FuzeX Card

06

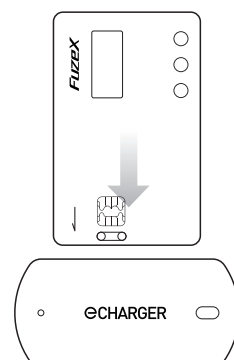

- 1) Insert FuzeX Card into the charging eCHARGER and push the power button on the eCHARGER. A LED light will turn on when it starts to charge.
- 2) The light will change color to indicate charging level.

LED	Status
Red	Charging
Green	Fully Charged
Orange	Error

- \* Charge eCHARGER using a standard micro-USB charging cable.
- \* LED light (Green) will turn off 15seconds after it is fully charged.

## Connect with X Manager

07

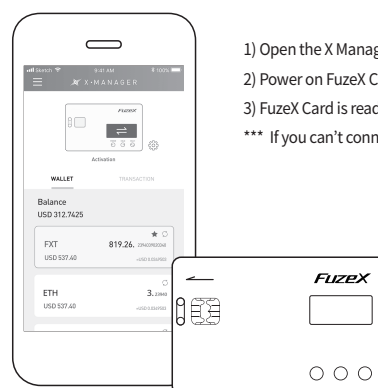

- 1) Open the X Manager and follow instructions to register.
  - 2) Power on FuzeX Card and connect with the App.
  - 3) FuzeX Card is ready for use now.
- \*\*\* If you can't connect FuzeX Card with your smartphone restart the App.

08

- This is a electro magnetic compatible product. It is a home electronic device and it can be used anywhere in the world.
- This is device uses wireless equipment. During the operation, it may have electrical wave interference so it should not be used for life-saving related services.
- FCC Certification Requirements  
This device complies with Part 15 of the FCC Rules. Operation is subject to the following two conditions: (1) this device may not cause harmful interference, and (2) this device must accept any interference received, including interference that may cause undesired operation.
- NOTE : This equipment has been tested and found to comply with the limits for a Class B, Digital device, pursuant to part 15 of the FCC Rules. These limits are designed to provide Reasonable protection against harmful interference in a residential installation. This equipment generates, uses and can radiate radio frequency energy and, if not installed and used in accordance with the instructions, may cause harmful interference to radio communications. However, there is no guarantee that interference will not occur in a particular installation. If this equipment does cause harmful interference to radio or television reception, witch can be determined by turning the equipment off and on, the user is encouraged to try to correct the interference by one or more of the following measures :
  - Reorient or relocate the receiving antenna.
  - Increase the separation between the equipment and receiver.
  - Connect the equipment into an outlet on a circuit different from that to which the receiver is connected.
  - Consult the dealer or an experienced radio / TV technician for help.
- CAUTION: Cahanges or modifications not expressly approved by the party responsible for compliance could void the user's authority to operate the equipment.

Card battery	3.8V / 13mAh , Lithium-Polymer, Rechargeable
Standby time	The usage time of the card may vary depending on the safety mode you choose (Refer to the App or Homepage)
Charging time	About 1 and half hour
eCHARGER rated voltage / Current	Input DC 5.0V / Output DC 4.35V / 12mA / 40mAh
Operating temperature	14°F ~ 122°F / -10°C ~ 50°C
Size / Weight	FuzeX Card size 3.36in. x 2.13in. x 0.2 oz / 0.01lb 85.5mm x 54mm x 0.8mm / 6g eCHARGER size 2.87in. x 1.38in. x 0.56 oz / 0.04lb 73mm x 35mm x 75mm / 16g Reader size 1.85in. x 1.18in. x 0.25 oz / 0.02lb 47mm x 30mm x 11mm / 7g
Display	1.1 inch E-paper display

- Corporate Name : BrilliantTS Co.,Ltd.
- Item title (Model name-Device) : Low power radio equipment and associated ancillary equipment for wireless data communication systems, FUZEX-CTA-01/ FUZEX-CBA-01
- Item title (Model name-Device) : eCHARGER, BPAY-BTC-02
- Rechargeable Li-on : 1ICP3/13/43
- Manufacturer / Country of Orgin : BrilliantTS Co.,Ltd. / Korea
- Manufacturing date :
- Safety Number :

- Battery will last longer with proper care and maintenance.
- Long periods of non-use may result in a decrease of battery life span.
- Keep product away from temperatures over 35°C (95°F) and under -5°C (23°F).
- To maximize battery capacity, use in room temperature.
- Using the product in low temperatures may result in less battery life .

Sevice Center

- Service Center
- FuzeX Website

info@fuzex.co  
fuzex.co  
You can find more information on the website

Button Guide

	POWER ⏻	HOLD ⏻	MULTI ⏻
Single Press	Left	Right	FuzeX Card group selection (payment / membership)
Hold for 3 sec	Power	Hold mode	Multi display (payment + membership)
Hold both buttons for 3 sec	Magnetic wave		
	FUZE Card Information		

► Power on

Press to turn the power on

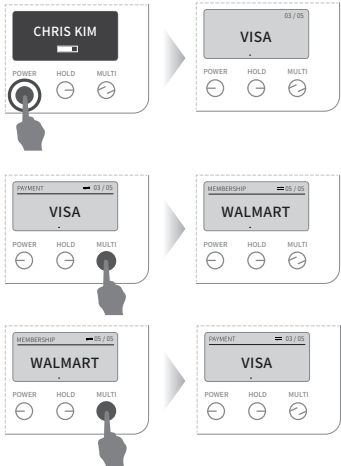

► Card group selection (payment/membership)

Press to toggle between two card groups

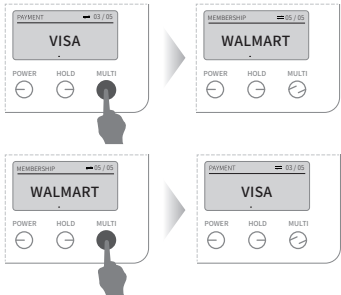

► Select payment card

Press to move right  
Press to move left

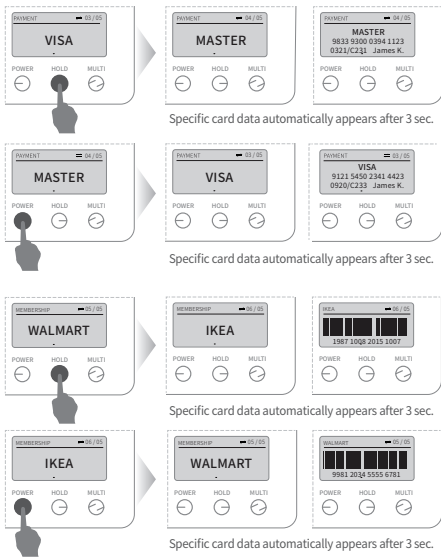

► Select Membership card

Press to move right  
Press to move left

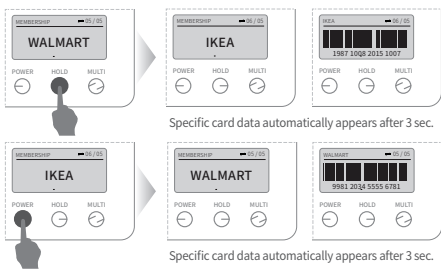

► Multi Display

\*Magnetic stripe holds payment card data, while E-paper displays membership barcode.

Hold for 3 sec to enter / exit multi display mode

Press to toggle between payment cards / membership cards

Press to move left  
and to move right

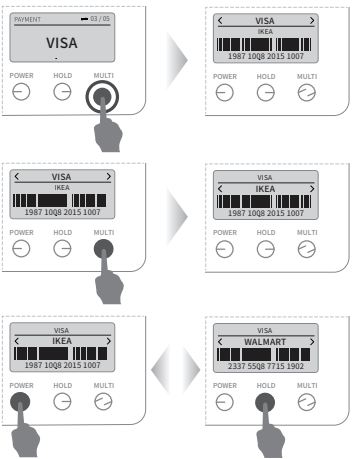

► Hold mode

Hold for 3 sec to enter Hold mode (Hold current payment card on display for 10min)

★ E.g when handing over to a restaurant server

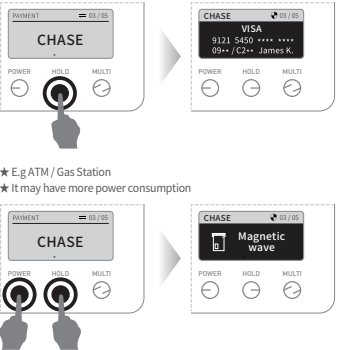

► Magnetic wave

Hold for 3 sec to activate Magnetic wave mode (Used when the card is completely inserted into a machine)

★ E.g ATM / Gas Station  
★ It may have more power consumption

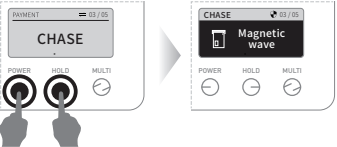

► Information

Hold for 3 sec to access card information

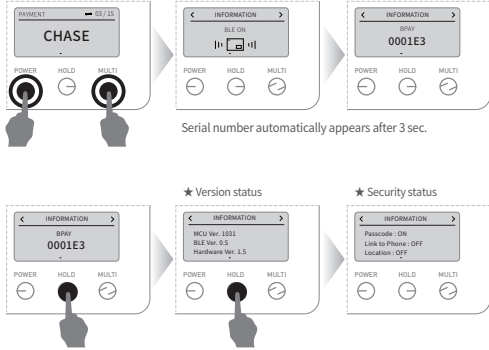

★ Version status

MCU Ver: 1.03  
BLE Ver: 0.5  
Hardware Ver: 1.5

★ Security status

Passcode: ON  
Link to Phone: OFF  
Location: OFF