

RC301C user manual

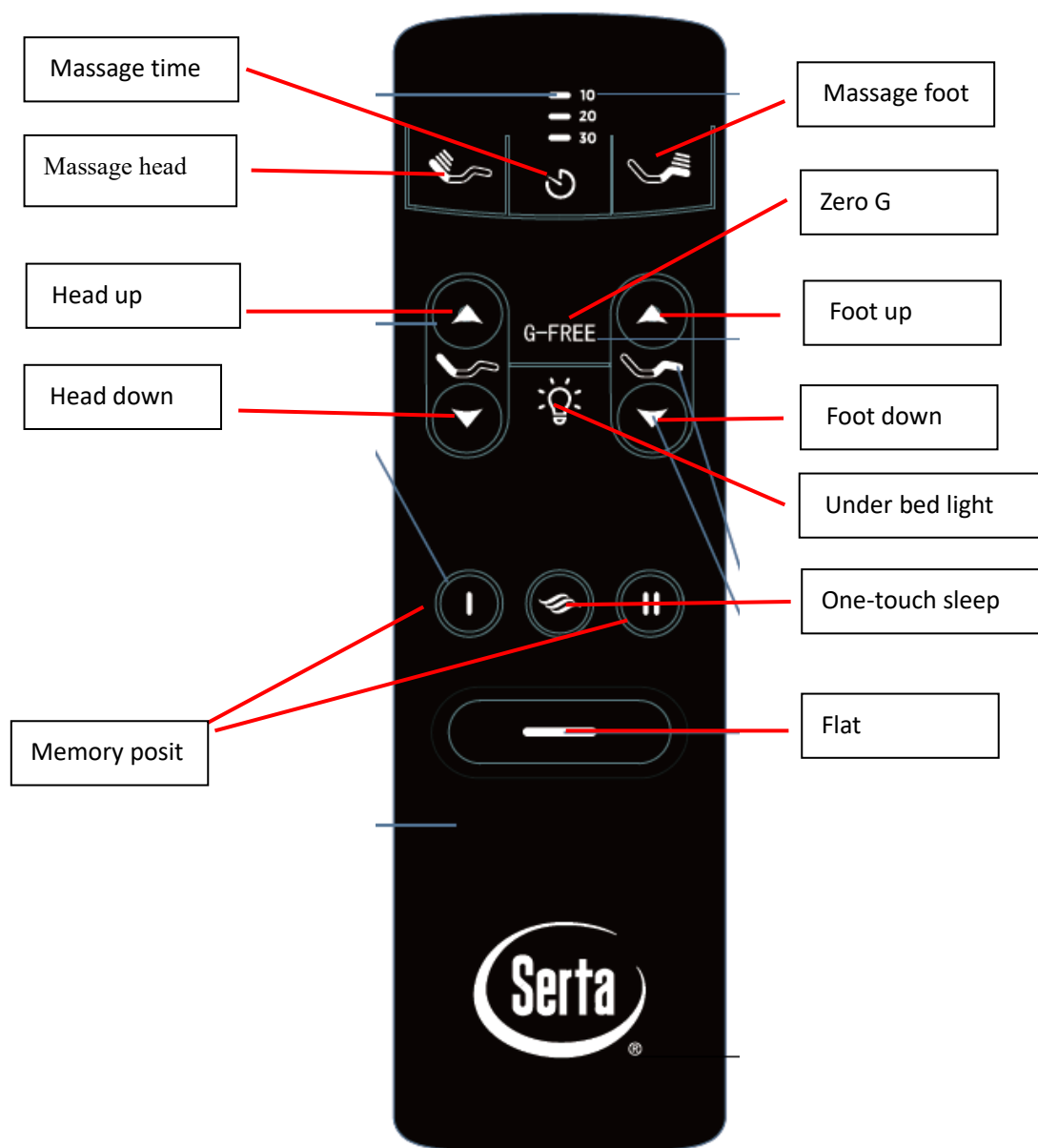
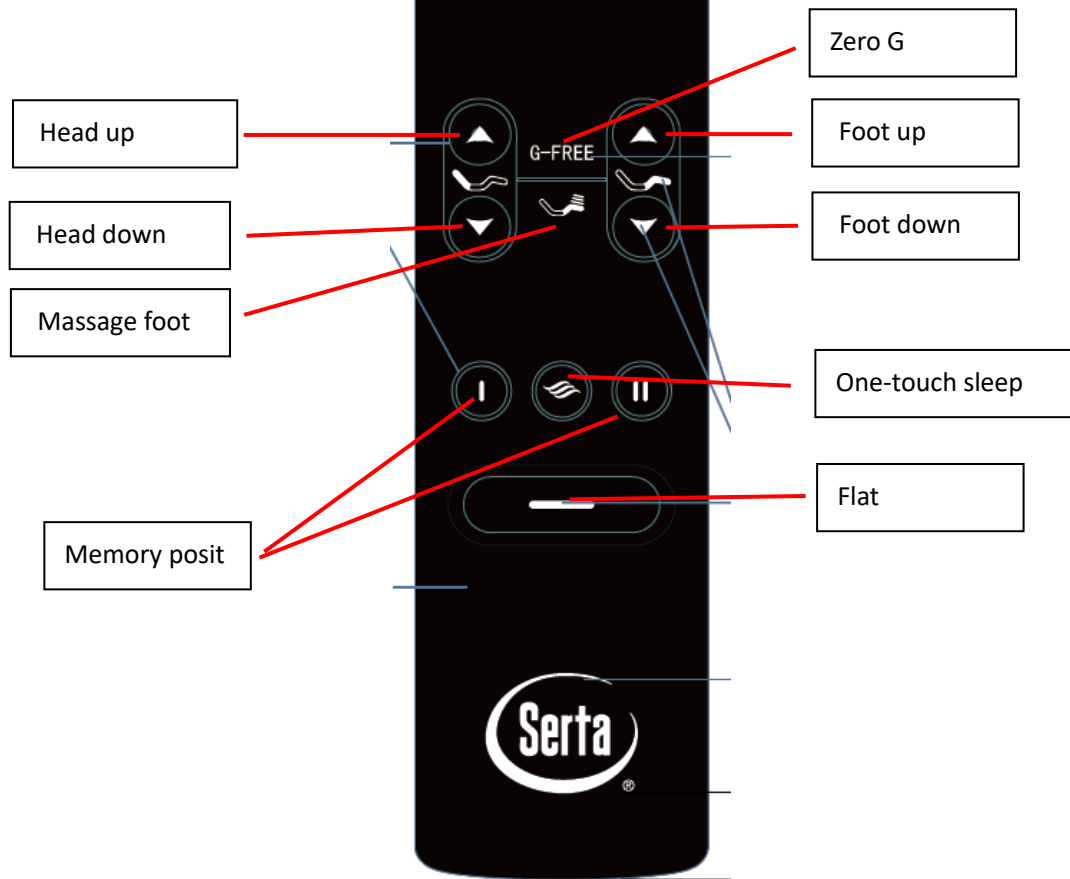
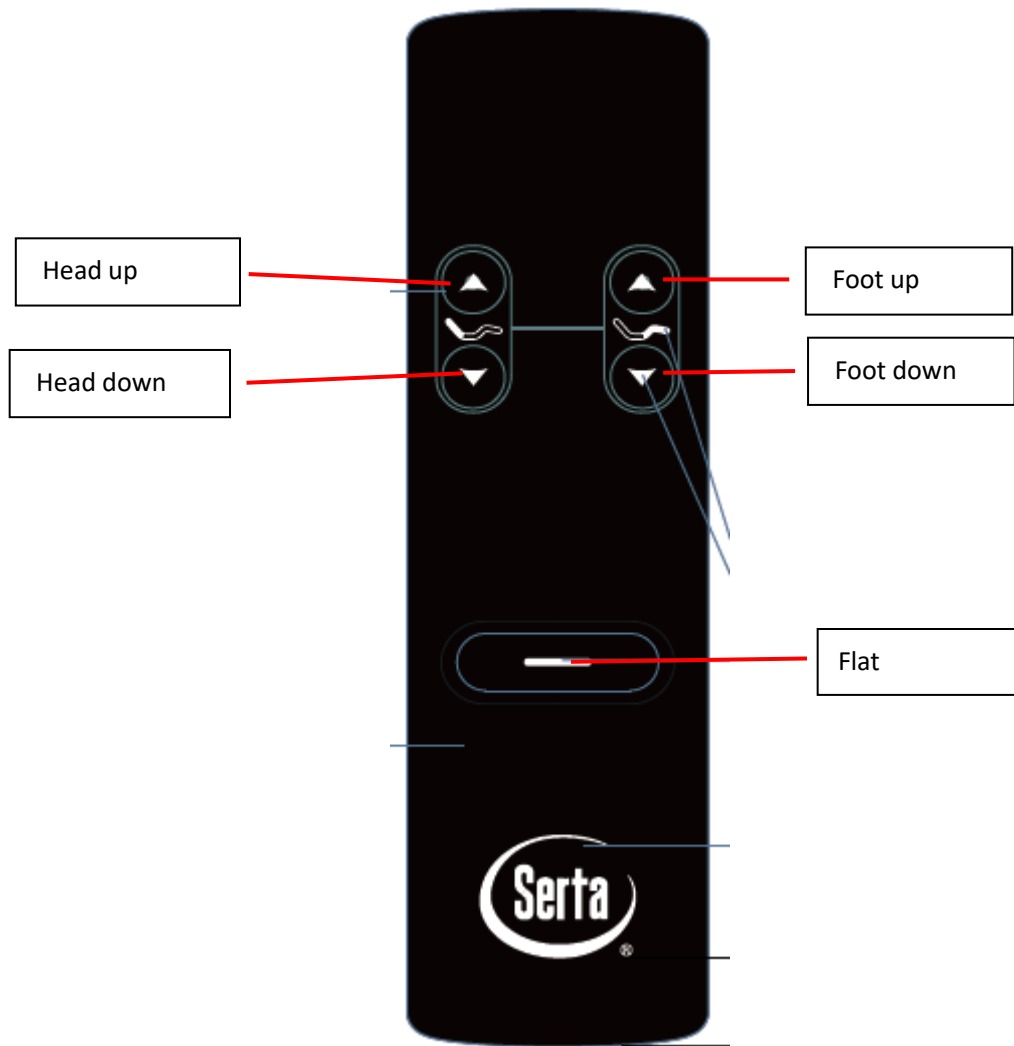

Figure 1 button of remote

RC301B



RC301A



Product Name: REMOTE CONTROL
Model: RC301C, RC301A, RC301B
Input: 3 x Battery AAA 1.5V
Manufacturer: Ergo Intelligent Technology (Jiaxing) Co., Ltd.
Manufacturing country: China

1.1 Head up

Press and hold HEAD UP button of remote, head actuator moves out, stop when released;

1.2 Head down

Press and hold HEAD DOWN button of remote, head actuator moves in, stop when released;

1.3 Foot up

Press and hold FOOT UP button of remote, foot actuator moves out, stop when released;

1.4 Foot down

Press and hold FOOT DOWN button of remote, foot actuator moves in , stop when released;

1.5 Underbed light

Click the Underbed light button to open or shut the light under the bed.

1.6 Massage head

Click MESSAGE HEAD button, head massage motor switches massage intensity, massage intensity switches among 0-1-2-3;

1.7 Massage foot

Click MESSAGE Foot button, head massage motor switches massage intensity, massage intensity switches among 0-1-2-3;

1.8 Massage timer

If the massage motors do not work, the button is invalid, if the massage motors work, click the button to switch the massage time, when massage time switch to 0, turn off the massage;

1.9 Flat

Click FLAT button, the bed goes flat, stop when click any button during the process of going flat;

1.10 Zero G

Click the ZG button, the actuator moves to ZG position, stop when click any button during the movement;

1.11 Memory position

Click memory position to move the actuator to the memory position.

1.12 One-touch sleep

Trigger the sleep-inducing process and sequentially perform the series of sleep-inducing actions

FCC Warning:

This equipment has been tested and found to comply with the limits for a Class B digital device, pursuant to part 15 of the FCC Rules. These limits are designed to provide reasonable protection against harmful interference in a residential installation. This equipment generates, uses and can radiate radio frequency energy and, if not installed and used in accordance with the instructions, may cause harmful interference to radio communications. However, there is no guarantee that interference will not occur in a particular installation. If this equipment does cause harmful interference to radio or television reception, which can be determined by turning the equipment off and on, the user is encouraged to try to correct the interference by one or more of the following measures:

- Reorient or relocate the receiving antenna.
- Increase the separation between the equipment and receiver.
- Connect the equipment into an outlet on a circuit different from that to which the receiver is connected.
- Consult the dealer or an experienced radio/TV technician for help.

Caution: Any changes or modifications to this device not explicitly approved by manufacturer could void your authority to operate this equipment.

This device complies with part 15 of the FCC Rules. Operation is subject to the following two conditions: (1) This device may not cause harmful interference, and (2) this device must accept any interference received, including interference that may cause undesired operation.

Important Note:**RF Exposure Information**

The device has been evaluated to meet general RF exposure requirement. The device can be used in portable exposure condition without restriction.

ISED Statement

- English: This device complies with Innovation, Science and Economic Development Canada license-exempt RSS standard(s).

Operation is subject to the following two conditions: (1) This device may not cause interference, and (2) This device must accept any interference, including interference that may cause undesired operation of the device. The digital apparatus complies with Canadian CAN ICES-3 (B)/NMB-3(B).

RF Exposure Information

The device has been evaluated to meet general RF exposure requirement. The device can be used in portable exposure condition without restriction.

- French: Le présent appareil est conforme aux CNR d'Innovation, Sciences et Développement économique Canada applicables aux appareils

radio exempts de licence. L'exploitation est autorisée aux deux conditions suivantes: (1) l'appareil ne doit pas produire de brouillage, et (2) l'utilisateur de l'appareil doit accepter tout brouillage radioélectrique subi, même si le brouillage est susceptible d'en compromettre le fonctionnement.

Informations sur l'exposition RF

L'appareil a été évalué pour répondre aux exigences générales en matière d'exposition aux RF.

L'appareil peut être utilisé dans des conditions d'exposition portables sans restriction.