

Soundstr Pulse

SETUP GUIDE

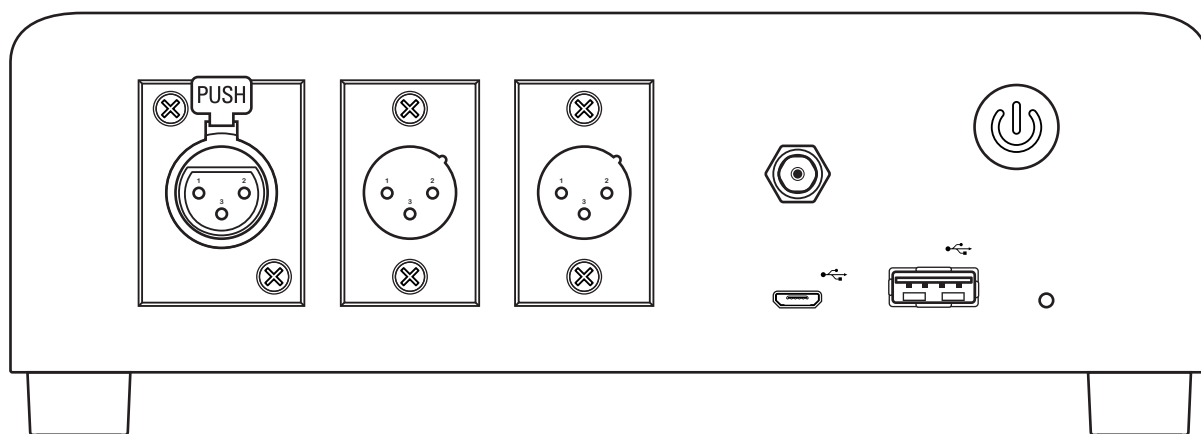

Welcome to Soundstr! We are excited to help you setup your new Soundstr Pulse device.
If you need help at any time, please contact Soundstr via

Phone : +1 (844) 332-2348

Email: help@soundstr.com

Web: <http://support.soundstr.com>

INCLUDED

Included in the Soundstr Pulse package is:

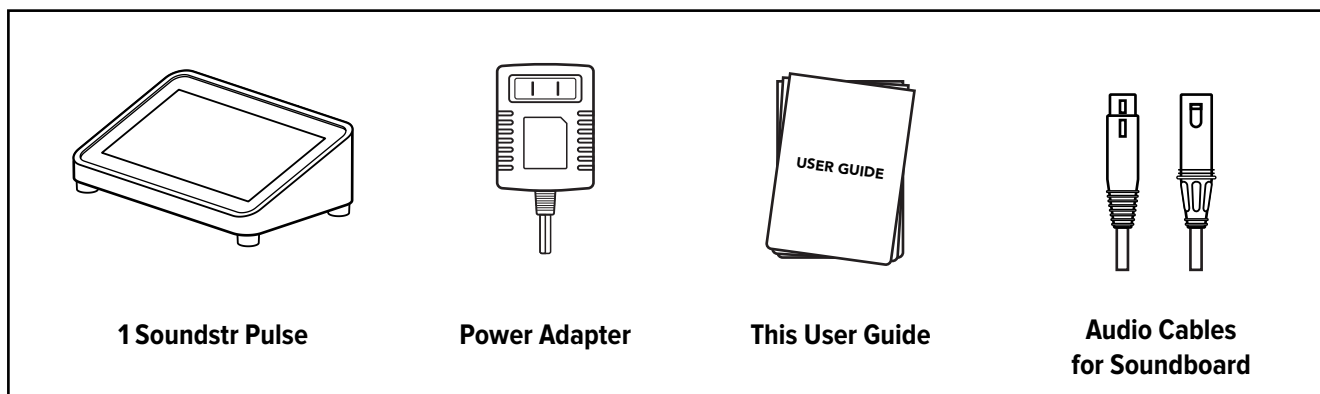

BEFORE YOU START, PLEASE HAVE:

- 15-25 minutes for the setup process.
- Access to your main FOH soundboard
- Access to the mobile phone associated with your Soundstr account
- A location to place the Soundstr Pulse near front of house source
- A power outlet that is consistently on (even after board shutdown)
- Your wireless network name and password
- The XLR cables for your Soundstr device to connect to the soundboard (included in the Pulse box)
- Dedicated mono output from soundboard to the Soundstr Pulse
- Inputs for a Left/Right audio from the Pulse to the soundboard
(Needed for calibration. If using Soundstr ADs, Left/Right audio needs to be setup on a permanent input.)

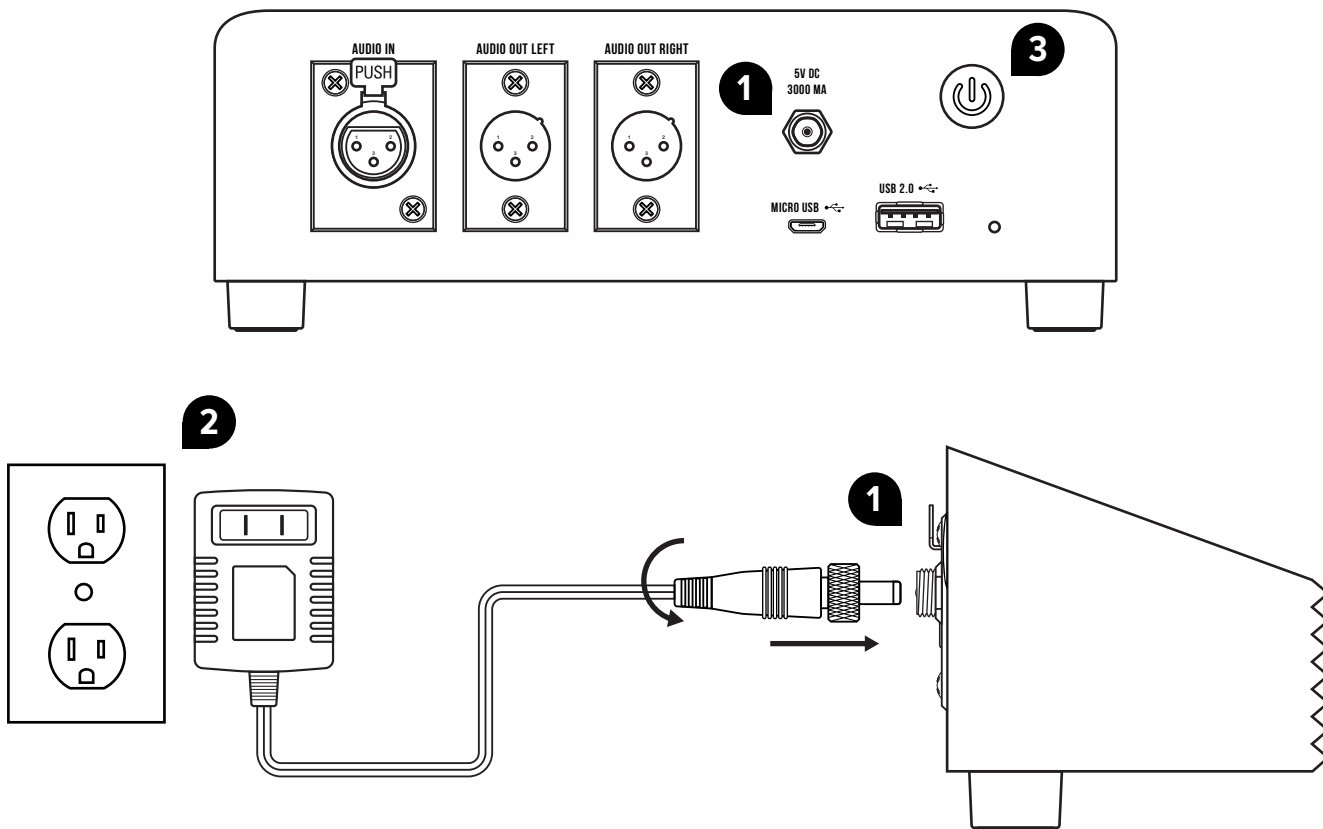

STEP 1 - CONNECT THE POWER TO YOUR DEVICE

- 1.) Screw the power cable connection into the threaded connector on the back of the device. Tighten firmly.
- 2.) Plug the power cable into an “always on” wall outlet
- 3.) Press the power button on the back left of the Pulse. You should see the screen display a Soundstr logo. If the Pulse does not respond, please wait several minutes for the battery to charge and repeat this step.

STEP 2 - ON SCREEN SETUP

The Pulse screen will turn on. You will see this screen.

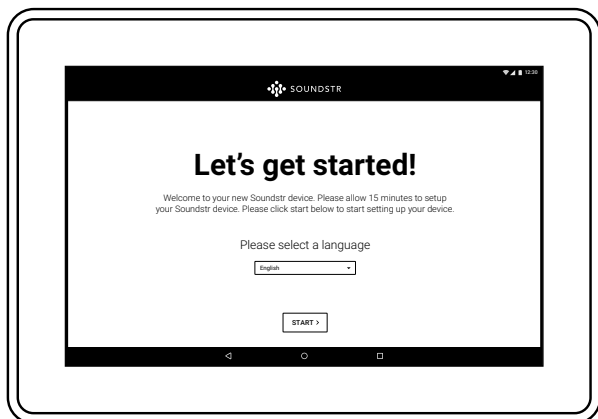

Please follow the instructions on the screen. If you do not see this screen, please contact Soundstr at
Phone : +1 (844) 332-2348

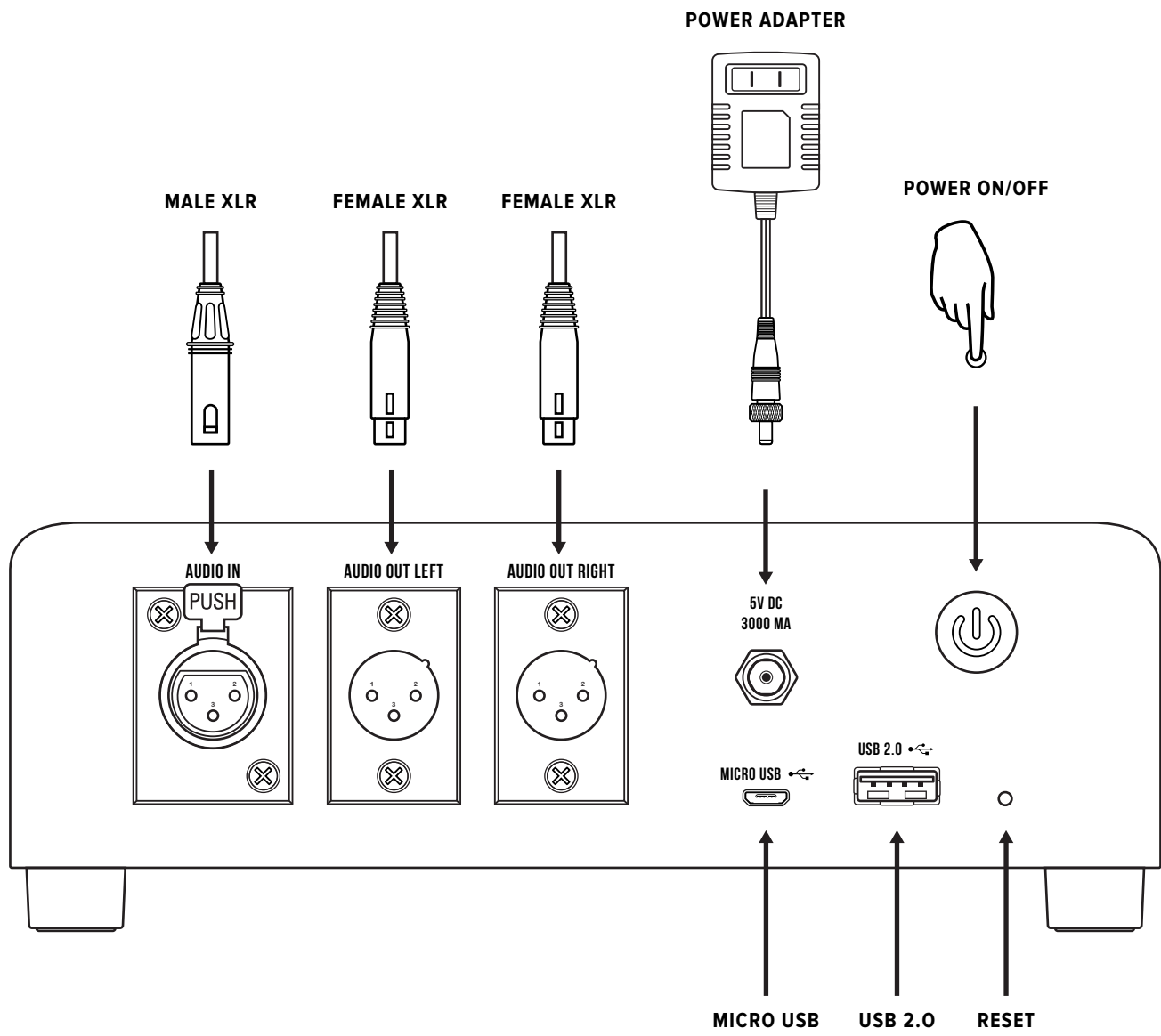

WATER AND MOISTURE:

- Do not expose the Pulse to rain or moisture or use it in damp or wet conditions.
- Do not place containers of liquids on it which might spill into any openings.

VENTILATION:

- Do not obstruct the ventilation slots or position the Pulse where the airflow required for ventilation is impeded.
- If the Pulse is to be placed in a rack unit or flight case ensure that it is well ventilated while turned on.

HEAT AND VIBRATION:

- Do not place the Pulse where it is subject to excessive heat or direct sunlight.
- Keep the Pulse away from any equipment which produces excessive heat or vibration.

SERVICING:

- Switch off equipment and unplug the power cord immediately if it is exposed to moisture, spilled liquid, objects fallen into the openings, if the power cord or plug have become damaged, during lightning storms, or if smoke, odor or abnormal noise is noticed.
- Refer servicing to qualified technical personnel only.

INSTALLATION:

- Install the Pulse in accordance with the instructions printed in this User Guide.
- Only use audio connectors and plugs for their intended purpose.

READ INSTRUCTIONS:

- Retain these safety and operating instructions for future reference.
- Adhere to all warnings printed here and on the Pulse and follow the operating instructions printed in this User Guide.

DO NOT REMOVE COVER:

Never open or tamper with the Pulse enclosure.

POWER SOURCES:

- Only Use provided power cable to power the Pulse.
- If the provided plug does not fit into your outlet consult your service agent for assistance. Contact details found on page 1 of this setup guide.

POWER CORD ROUTING:

Run the power cord so that it is out of the way and not likely to be walked on, stretched or pinched by items placed upon or against it.

FEDERAL COMMUNICATIONS COMMISSION COMPLIANCE INFORMATION

EN



PULSE-001

Model: PULSE-001

FCC ID: 2AJX9-PULSE001

Responsible Party Name: **MusicPlay Analytics LLC. (d/b/a Soundstr)**

Address: **217 Pointers Run,
Englewood, OH 45322
USA**

Phone No./Email: **Phone : +1 (844) 332-2348
Email: help@soundstr.com**

FCC STATEMENT

This device complies with Part 15 of the FCC rules. Operation is subject to the following two conditions:

- (1) This device may not cause harmful interference, and
- (2) this device must accept any interference received, including interference that may cause undesired operation.

Important information:

Any Changes or modifications not expressly approved by the party responsible for compliance could void the user's authority to operate the equipment.

Note: This equipment has been tested and found to comply with the limits for a Class B digital device, pursuant to part 15 of the FCC Rules. These limits are designed to provide reasonable protection against harmful interference in a residential installation. This equipment generates uses and can radiate radio frequency energy and, if not installed and used in accordance with the instructions, may cause harmful interference to radio communications. However, there is no guarantee that interference will not occur in a particular installation. If this equipment does cause harmful interference to radio or television reception, equipment generates, uses and can radiate radio frequency energy and, if not installed and used in accordance with the instructions, may cause harmful interference to radio communications. However, there is no guarantee that interference will not occur in a particular installation. If this equipment does cause harmful interference to radio or television reception,

- Reorient or relocate the receiving antenna.
- Increase the separation between the equipment and receiver.
- Connect the equipment into an outlet on a circuit different from that to which the receiver is connected.
- Consult the dealer or an experienced radio/TV technician for help.

FCC RF Radiation Exposure Statement

This equipment complies with FCC RF radiation exposure limits set forth for an uncontrolled environment.