



MiniVPN_White (WE101VWT)



MiniVPN_Black (BE101VWT)



Zebra Web Site: <http://www.zebravpnbox.com/>

VPN Setup

1 Network Topology

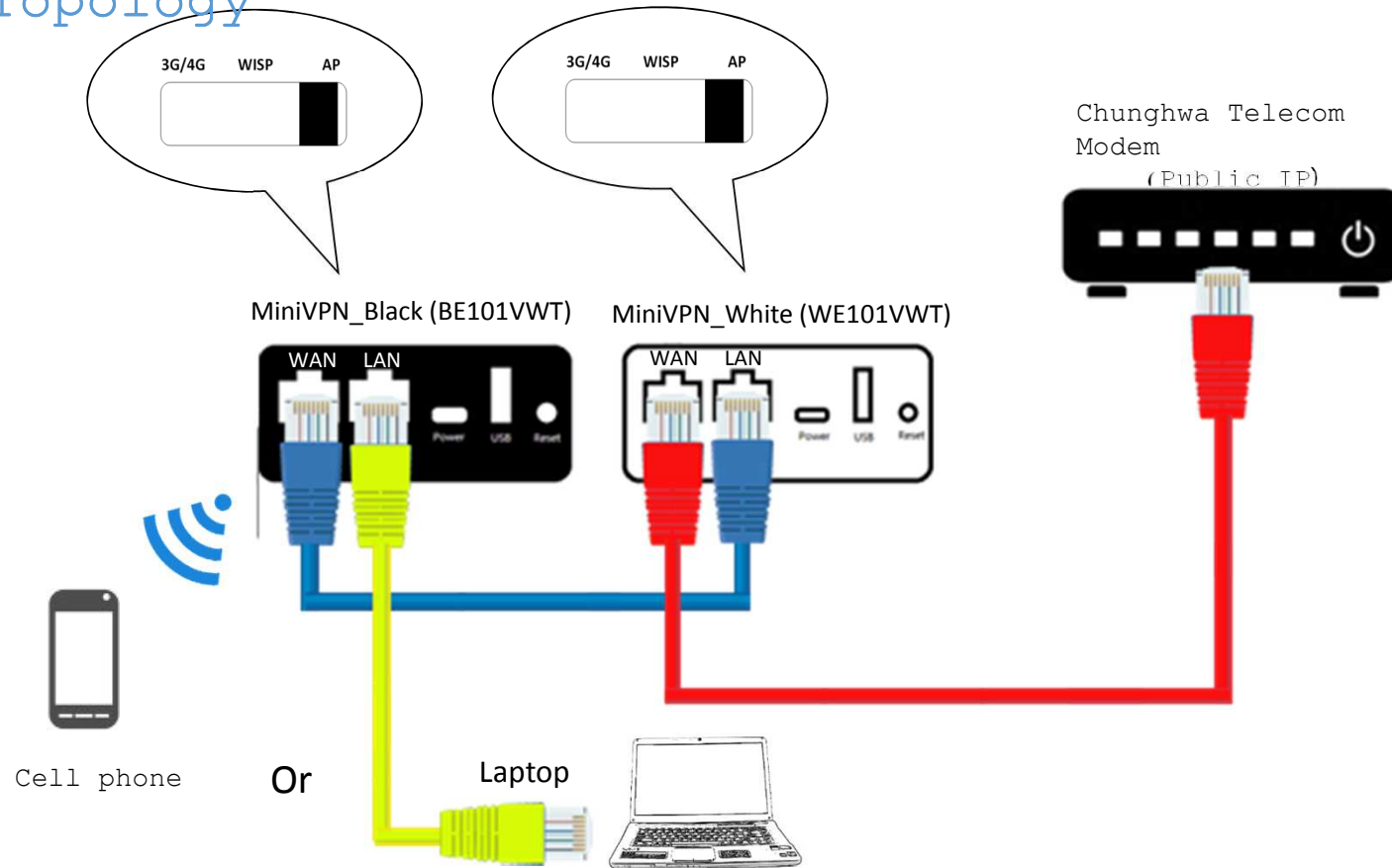

● Please connect Black and White Box as figure shown above

Zebra Web Site: <http://www.zebravpnbox.com/>

VPN Setup

2 Setup via Smart Phone

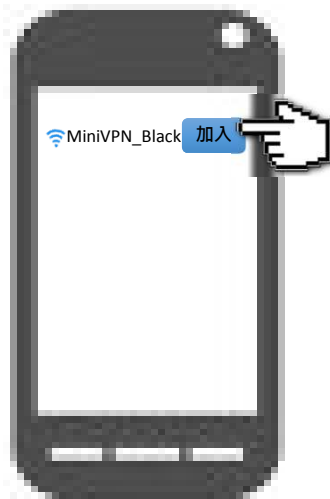

- ① Select mobile phone configuration
- ② Select Wi-Fi option, turn on Wi-Fi
- ③ Search for wireless SSIDs
- ④ Select MiniVPN-Black-xxxxxxx
- ⑤ Join MiniVPN-Black-xxxxxxx

Open your mobile phone browser, enter 10.20.30.1
Key-in black box password
Default Account/Password: admin/admin

Zebra Web Site: <http://www.zebravpnbox.com/>

VPN Setup

2 VPN Configuration Process

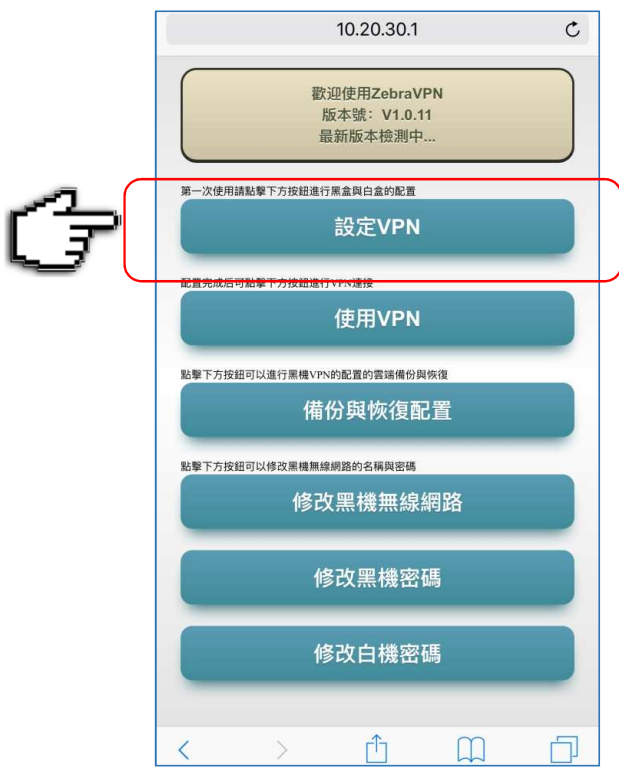

Enter VPN Configuration



Key-in White Box password

Zebra Web Site: <http://www.zebravpnbox.com/>

VPN Setup

2 VPN Configuration Process



Wait 5 minutes for white box

To generate a key automatically
Synch up the key with
Black Box

(close window) Next step

Zebra Web Site: <http://www.zebravpnbox.com/>

VPN Setup

④ White Box Internet

PPPoE mode

10.20.30.1

白機上網設定

白盒廣域網口已經配置完成!
白盒廣域網口IP目前為: 49.64.64.113
白盒IP經測試為公網IP!

方式: PPPoE

賬號:

密碼:

修改白機無線網路

Wifi名稱: MiniVPN-white-ef0f30

Wifi密碼: 12345678

點擊Apply按鈕配置
配置白盒廣域網口, 需要等待30秒...

Apply

Back Next

DHCP mode

10.20.30.1

白機上網設定

白盒廣域網口已經配置完成!
白盒廣域網口IP目前為: 192.168.1.3
白盒IP經測試並非為公網IP, 請重新配置服務器網絡!

方式: DHCP

修改白機無線網路

Wifi名稱: MiniVPN-white-ef0f30

Wifi密碼: 12345678

點擊Apply按鈕配置
配置白盒廣域網口, 需要等待30秒...

Apply

Back Next

Static IP mode

10.20.30.1

白機上網設定

白盒廣域網口已經配置完成!
白盒廣域網口IP目前為: 192.168.1.3
白盒IP經測試並非為公網IP, 請重新配置服務器網絡!

方式: Static IP

廣域網IP:

子網掩碼:

網關IP:

DNS:

修改白機無線網路

Wifi名稱: MiniVPN-white-ef0f30

Wifi密碼: 12345678

點擊Apply按鈕配置
配置白盒廣域網口, 需要等待30秒...

Apply

Back Next

Setup White box WAN configuration according to ISP(Internet Service Provider). In general, PPPoE is used for broadband connection if your ISP is Chunghwa Telecom. White machine will prompt you whether it is a public WAN or not upon configuration applied. Private IP is not allowed in our situation. Please click on the "Next" button to proceed.

Zebra Web Site: <http://www.zebravpnbox.com/>

VPN Setup

5 Complete setup



Download the latest F/W

Backup Configuration

When you finish, be sure to backup the configuration to our cloud (Very important!!!), firmware version number are available in the page. You can download the latest version and upgrade. Click the "OK" button to return to the main menu. You can now disconnect connection between Black and white box. You can use black box as a dedicated VPN network when travelling.

Zebra Web Site: <http://www.zebravpnbox.com/>

VPN Use Case



Click “Use VPN”, make sure how your black box connect to internet. Switch Black box side paddles appropriate for corresponding internet connection.

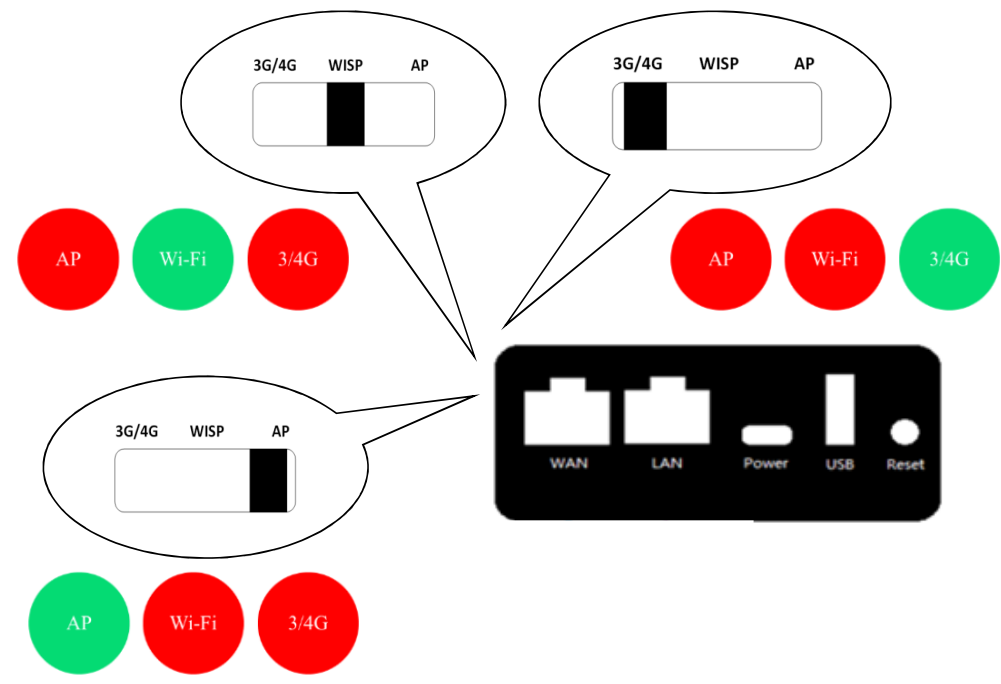

GUI detect router side paddles automatically. Green circle shows the current paddles position.

Zebra Web Site: <http://www.zebravpnbox.com/>

VPN Use Case - AP Mode

AP mode diagram

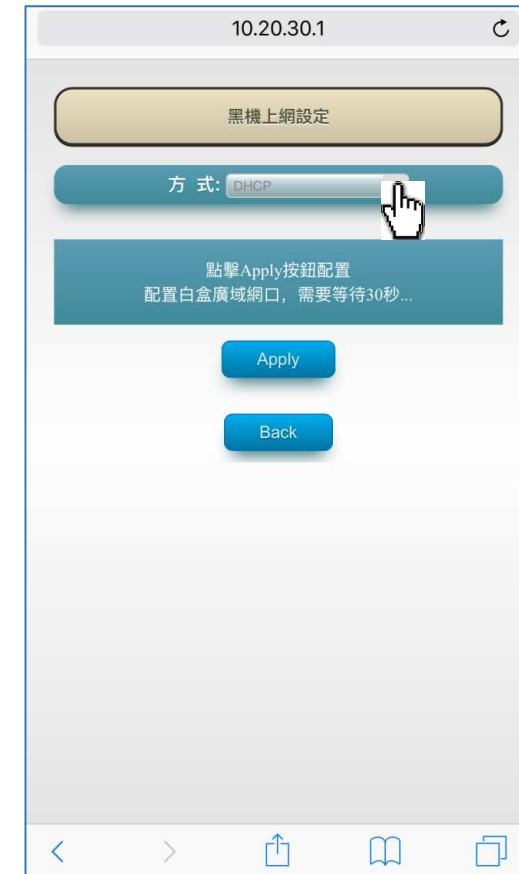
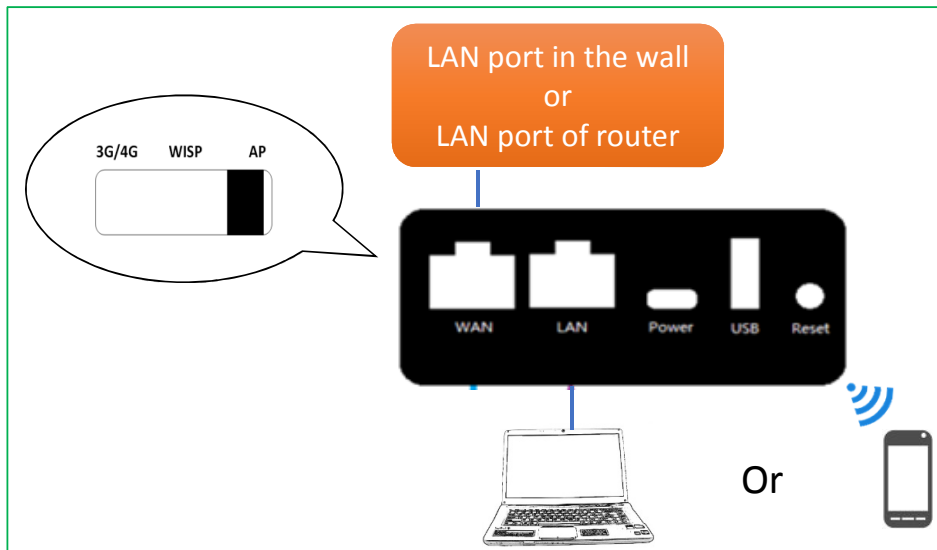

When wired internet connection is used for Black Box, router side paddles should be switched to "AP " Mode. Click the green Internet connection. Set up your black box internet configuration accordingly

Select the appropriate internet connection. Set up your black box internet configuration.

Zebra Web Site: <http://www.zebravpnbox.com/>

VPN use

WISP mode diagram

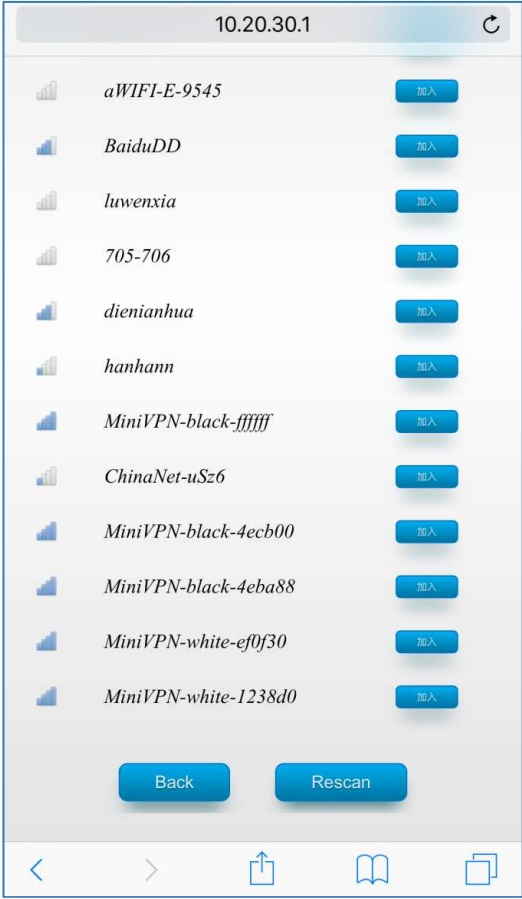
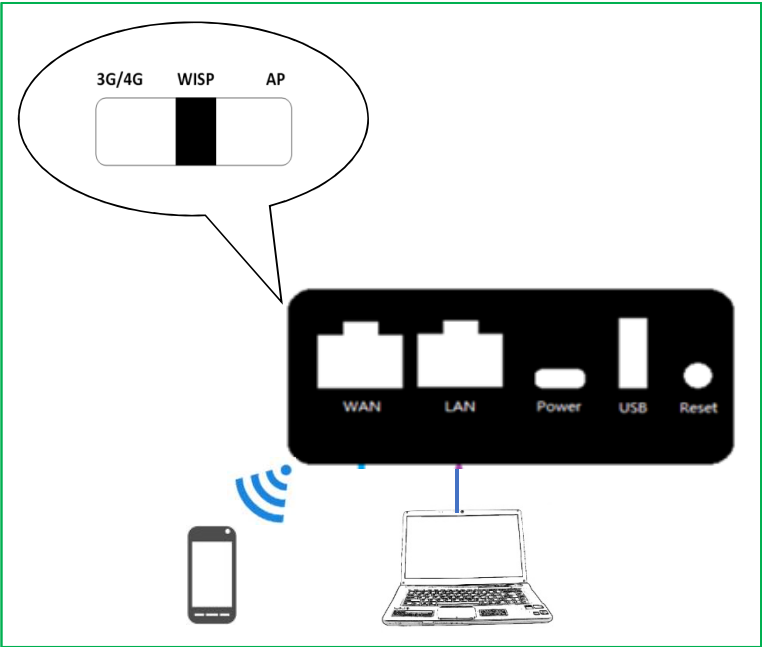

When wireless internet connection is used for Black Box, router side paddles should be switched to WISP Mode. Click the green Wi-Fi Circle to setup Internet configuration accordingly

Select the correct wireless SSID, enter Wi-Fi password. Click the "Connect" button for Wi-Fi Access.

Zebra Web Site: <http://www.zebravpnbox.com/>

Cell Phone to Black Box

VPN use

3G/4G mode diagram

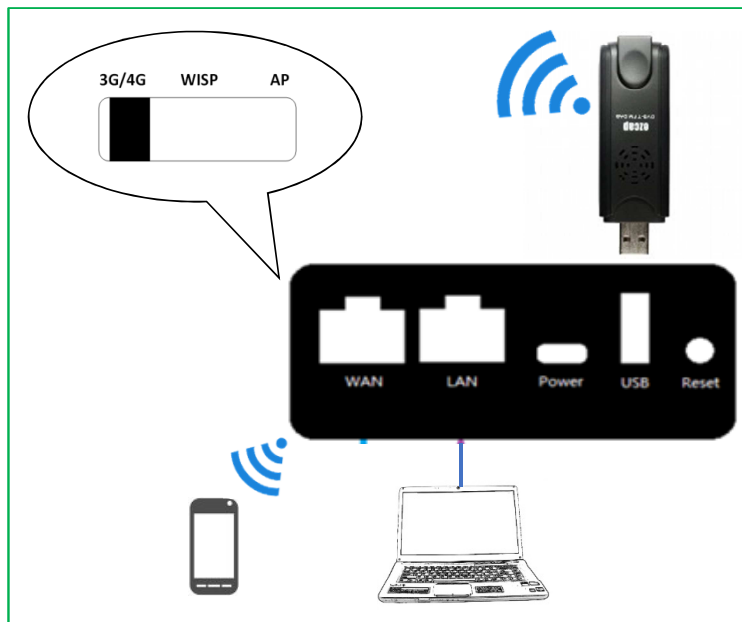

When 3 / 4 G internet connection is used for Black Box, router side paddles should be switched to 3 / 4 G Mode. Black Box can go on line automatically.

Zebra Web Site: <http://www.zebravpnbox.com/>

VPN use

VPN connection

If the VPN is still not connected, please click the "Connect" button to reconnect VPN. You can see the location of black box after VPN connected. At this point, you are ready for your own VPN service.



Zebra Web Site: <http://www.zebravpnbox.com/>

Federal Communication Commission Interference Statement

This equipment has been tested and found to comply with the limits for a Class B digital device, pursuant to Part 15 of the FCC Rules.

These limits are designed to provide reasonable protection against harmful interference in a residential installation.

This equipment generates, uses and can radiate radio frequency energy and, if not installed and used in accordance with the instructions, may cause harmful interference to radio communications. However, there is no guarantee that interference will not occur in a particular installation.

If this equipment does cause harmful interference to radio or television reception, which can be determined by turning the equipment off and on, the user is encouraged to try to correct the interference by one of the following measures:

- Reorient or relocate the receiving antenna.
- Increase the separation between the equipment and receiver.
- Connect the equipment into an outlet on a circuit different from that to which the receiver is connected.
- Consult the dealer or an experienced radio/TV technician for help.

FCC Caution: Any changes or modifications not expressly approved by the party responsible for compliance could void the user's authority to operate this equipment.

This device complies with Part 15 of the FCC Rules. Operation is subject to the following two conditions:

- (1) This device may not cause harmful interference, and
- (2) This device must accept any interference received, including interference that may cause undesired operation.

For product available in the USA/Canada market, only channel 1~11 can be operated. Selection of other channels is not possible.

FCC Radiation Exposure Statement:

This equipment complies with FCC radiation exposure limits set forth for an uncontrolled environment.

This equipment should be installed and operated with minimum distance 20cm between the radiator & your body.