

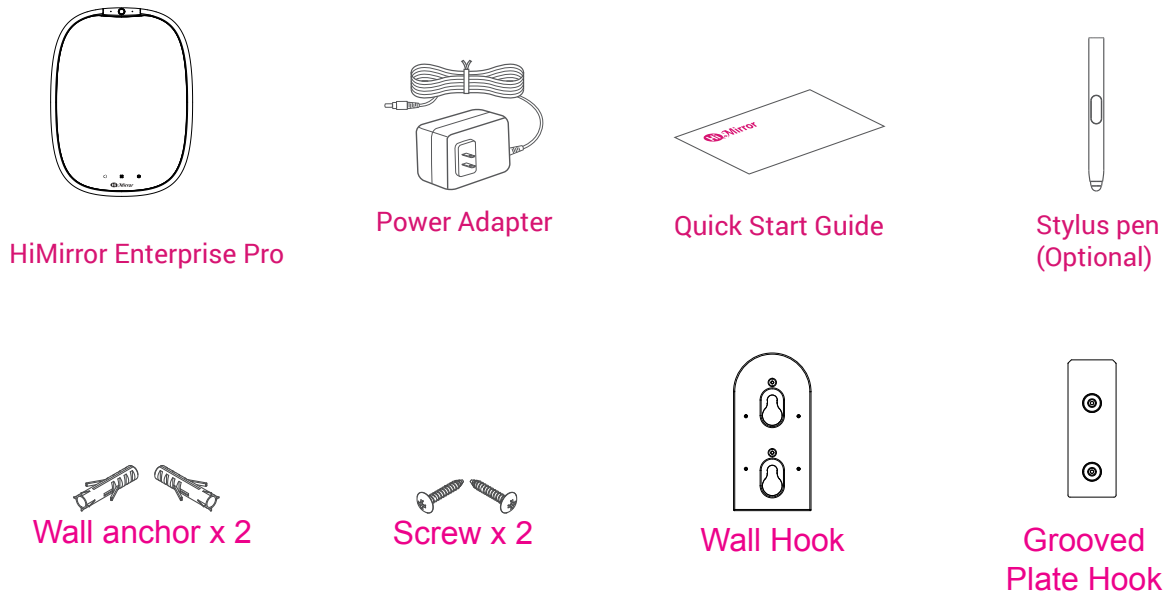

Quick Start Guide



PACKAGE CONTENTS



OVERVIEW

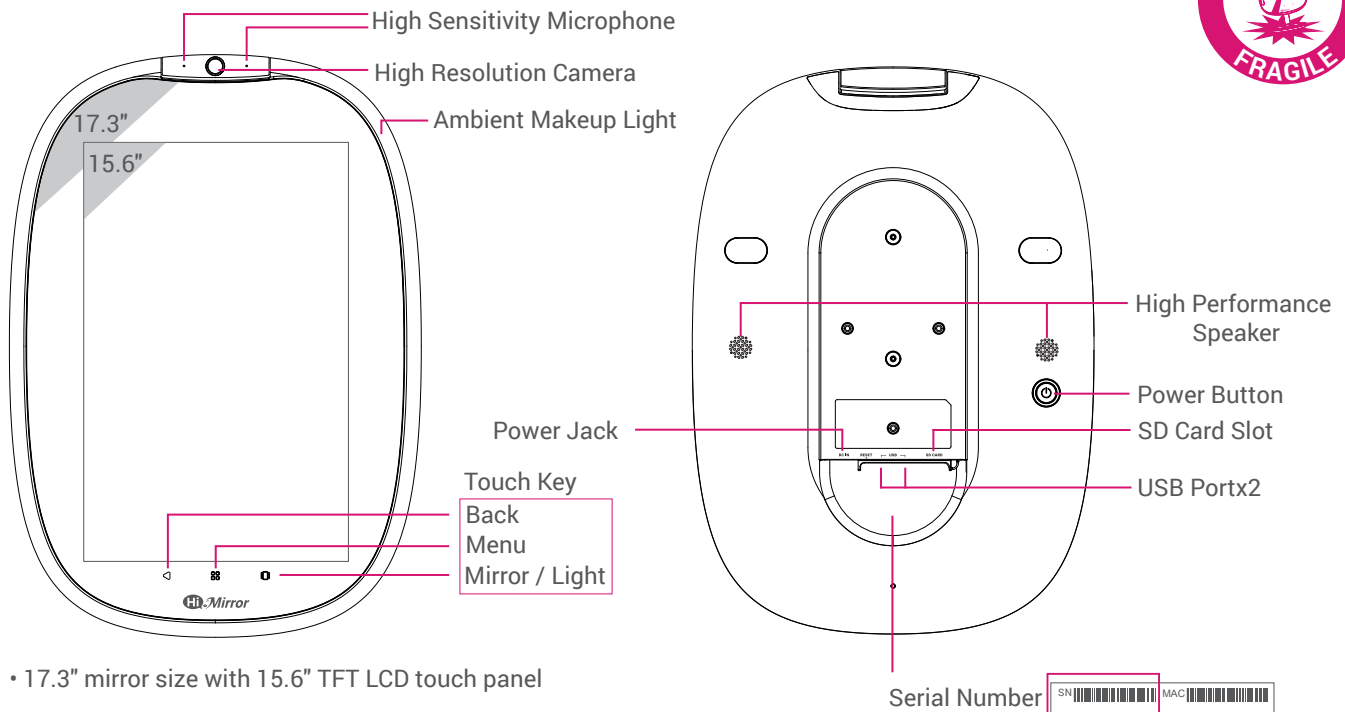

Touch Key	Functions
◀ Back	Back to previous page
☰ Menu	Bring up the menu
☐ Mirror / Light	Switch between Mirror mode and ambient makeup light

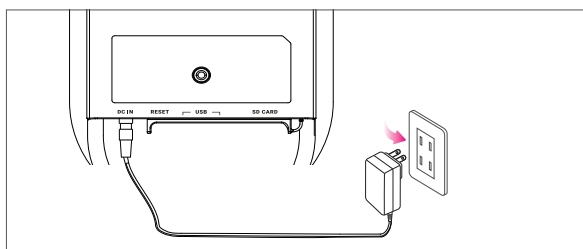

Power Jack –
Connect HiMirror Mini to a power outlet using the provided power adapter.

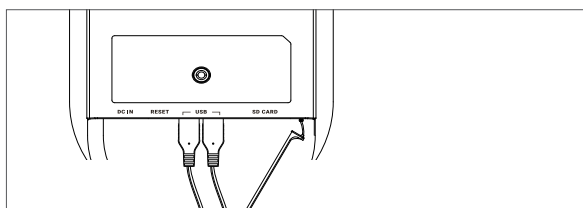

USB Port –
Connect with HiMirror Mini supported peripheral devices.

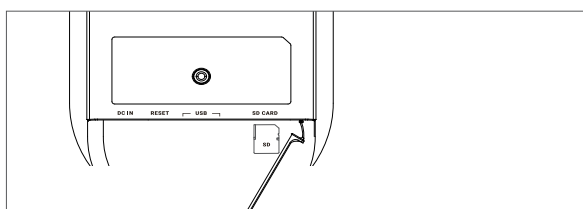

SD Card Slot –
Insert an SD card for additional storage space.

BEFORE YOU START

Note:

1. Children under the age of 13 are not permitted to create a HiMirror account.
2. Please ensure HiMirror Mini is placed on a flat and even surface.

HiMirror Mini must be within range of your WiFi network

You must have a WiFi network available and have your HiMirror Mini installed within its range.

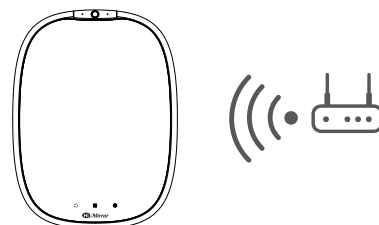

GETTING STARTED

1. Connect HiMirror Mini to a power outlet using the power adapter.*
2. Push and hold the power button for at least 3 sec. to turn on HiMirror Mini.
3. Push to open the camera cover.
4. Follow the on-screen instructions to complete setup.

***Note:** HiMirror Mini must be plugged into a power outlet at all times.

Temperature / Humidity

Operation: 41°~95°F(5°~35°C); 30~80% RH
Storage & Transportation: -4°~140°F(-20°~60°C); 0~95% RH

Power Consumption

Power Input: 100-240V~50/60Hz, 1.0A
Power Adapter: 12V, 36W

WALL HOOK ASSEMBLE

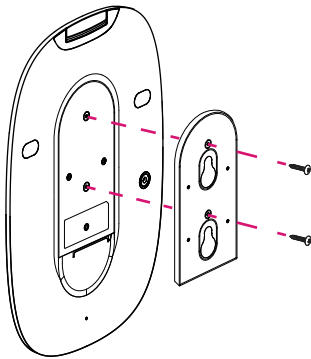

- Put the Hook on the back of HiMirror Pro
- Tighten the screws into the holes as marked in picture to fix the hook on HiMirror Pro.

MOUNTING INSTRUCTION



Mirror Mounting

- Before using make sure the adhesive area and the desired surface are dry and clean.
- Remove the blue protective film from the wall hook, and hold in the desired position for 1 minute to ensure a strong bond.

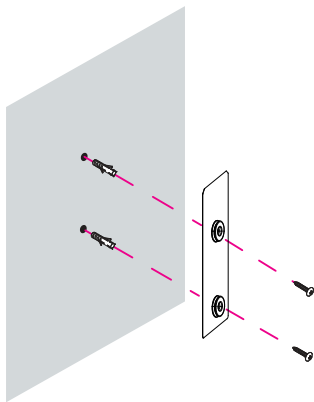

Wall Mounting

- Concrete
 - Drill the mounting holes, insert the wall anchors.
 - Screw the wall hook into the concrete wall.

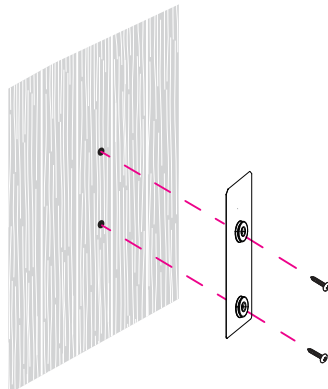

- Wood/ Drywall
 - Screw the wall hook directly into the wall using the supplied screws.

***Note:** Electric Drill Torque: 8.68 lbf/fn (10 kgf/cm)



Address: 20191 Windrow Dr., Suite B Lake
Forest, CA 92630, USA
Toll-free Number: +1-855-999-3348

