



QPC100W  
4K Wireless Document Camera

# **User Manual**



## wandercam pro

4K Wireless Document Camera

QPC100W

## Quick Start Guide

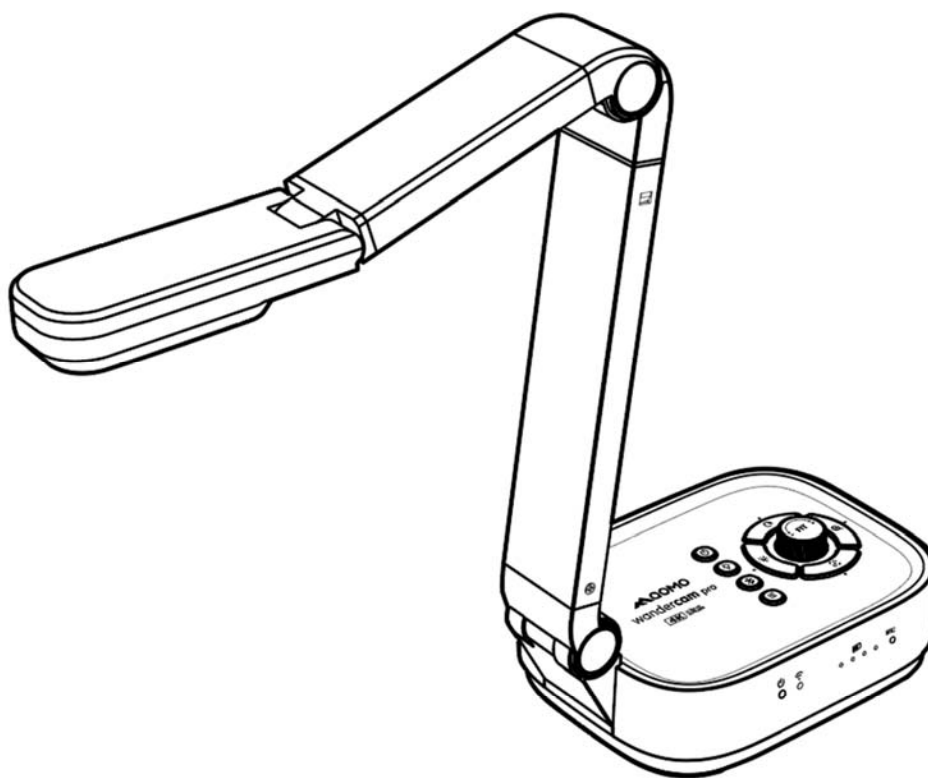

**Please read this guide before using the product.**

## Step 1. Instructions

Thank you for your purchase of the WanderCam Pro (QPC100w) by QOMO. This quick start guide briefly describes the steps to get started using your new document camera. If you have any technical or service questions about the product, please e-mail our customer service at [support@qomo.com](mailto:support@qomo.com). For an extended user manual, software, and tutorial videos visit [www.qomo.com](http://www.qomo.com).

### Limited Warranty

Your QOMO document camera includes a warranty guarantee of 2 years from the date of purchase. For more details on warranty coverage, please visit [www.qomo.com/warranty](http://www.qomo.com/warranty).

### FCC Statement

Changes or modifications not expressly approved by the party responsible for compliance could void the user's authority to operate the equipment.

This equipment has been tested and found to comply with the limits for a Class B digital device, pursuant to Part 15 of the FCC Rules. These limits are designed to provide reasonable protection against harmful interference in a residential installation. This equipment generates uses and can radiate radio frequency energy and, if not installed and used in accordance with the instructions, may cause harmful interference to radio communications. However, there is no guarantee that interference will not occur in a particular installation. If this equipment does cause harmful interference to radio or television reception, which can be determined by turning the equipment off and on, the user is encouraged to try to correct the interference by one or more of the following measures:

- Reorient or relocate the receiving antenna.
- Increase the separation between the equipment and receiver.
- Connect the equipment into an outlet on a circuit different from that to which the receiver is connected.
- Consult the dealer or an experienced radio/TV technician for help

This device complies with part 15 of the FCC rules. Operation is subject to the following two conditions (1) this device may not cause harmful interference, and (2) this device must accept any interference received, including interference that may cause undesired operation.

This equipment complies with FCC radiation exposure limits set forth for an uncontrolled environment. This equipment should be installed and operated with minimum distance 20cm between the radiator & your body.



### System Requirements

Intel i3 Processor or Higher
USB Port
At least 4GB RMB (Recommended 8GB)
20GB Available HDD Space
Windows & Chrome Extension

## Step 2. Specifications

Image Sensor	1/3.06", 13 MP CMOS Sensor
F/NO (Infinite)	2.2
TV lines	1100
Max. Shooting Area	430mm x 320mm (17"x12.6")
Max. HDMI Output Resolution / FPS	3840×2160@30fps (4K, 16:9)
USB Output Resolution / FPS	4192×3104@10fps, 3840x2160@30fps 1920x1080@30fps, 1280x720@30fps 1024x768@30fps, 640x360@30fps
Video Format	H.264 / MJPG / YUY2
Focus	Auto / Manual
Lamp	LED
Image Rotation	0° / 90° / 180° / 270° / Flip / Mirror
PTZ	Yes
Freeze	Yes
Power Frequency	50 / 60 Hz
Wireless Compatibility	802.11a/b/g/n/ac
Wireless Working Frequency	5 GHz / 2.4 GHz
Dual mode	AP / Station DHCP (Server / Client)
Microphone	Built-in Omnidirectional Microphone
Connectivity	USB (Type-C) / HDMI / WiFi
Microphone	Built-in Omnidirectional Microphone 1kHz(0dB=1V/Pa) Min-45 Nom-42 Max-39 dB
Powered By	USB Type-C (5V / 1A)
Built-in Battery	Battery Work 6 Hours
Protocol	UVC / UAC Compliant
Soupport OS	Windows & Chrome Extension
Dimensions	Extended: 347x115x381 mm Closed: 242x115x87 mm
Net Weight	1.36Kg

NOTE: Specifications are subject to change without notice

## Step 3. Unpacking

Before use, make sure the following items are included in the package.  
If anything is missing, contact the retailer where you purchased the product.

1. QPC100W Document Camera
2. USB Type-C Cable
3. Quick Start Guide
4. Warranty Card
5. Power Adapter

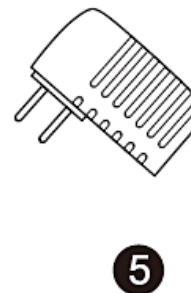
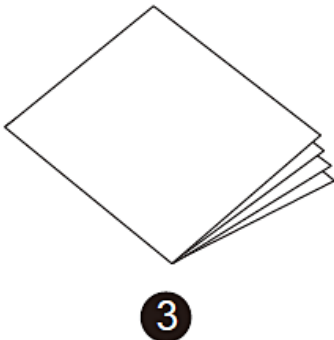
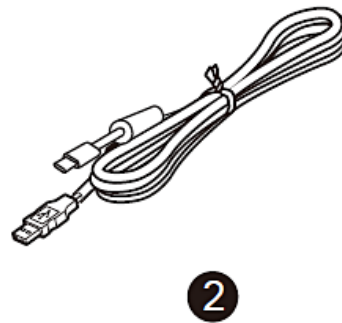
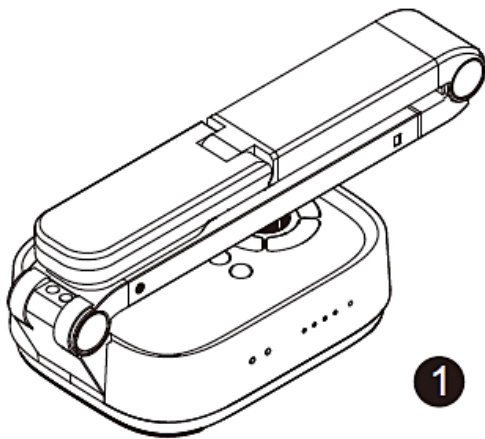

## Step 4. Parts Descriptions

### Control Panel

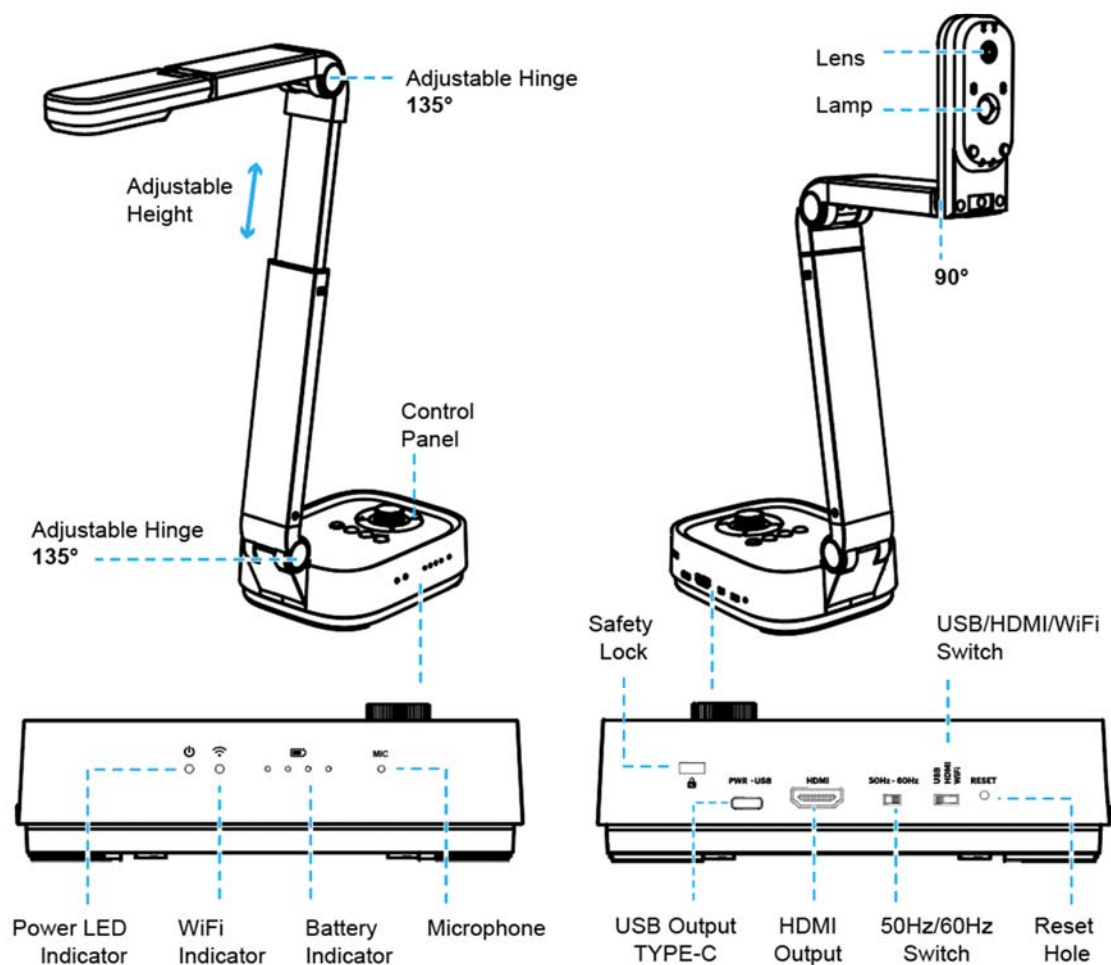
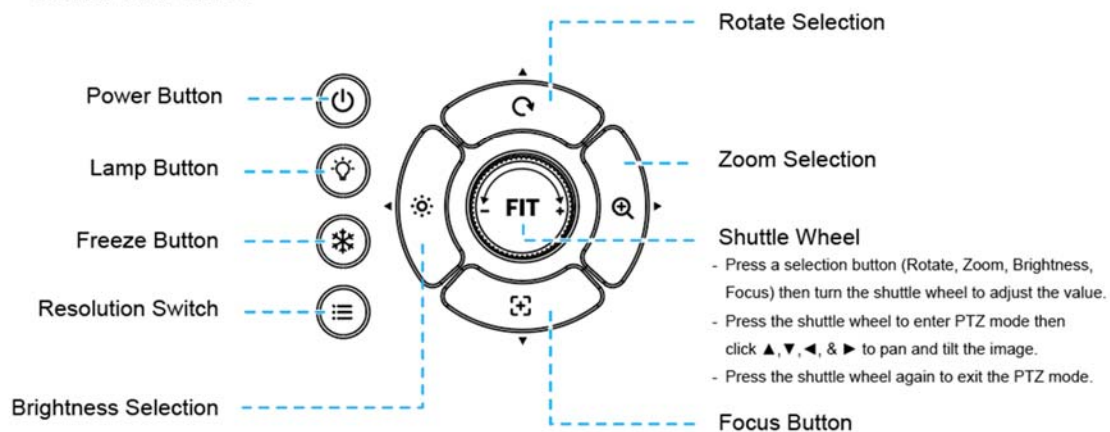

## Step 5. Start Using

1. Start by lifting the camera head.
2. Hold steady the base of the unit to assist.

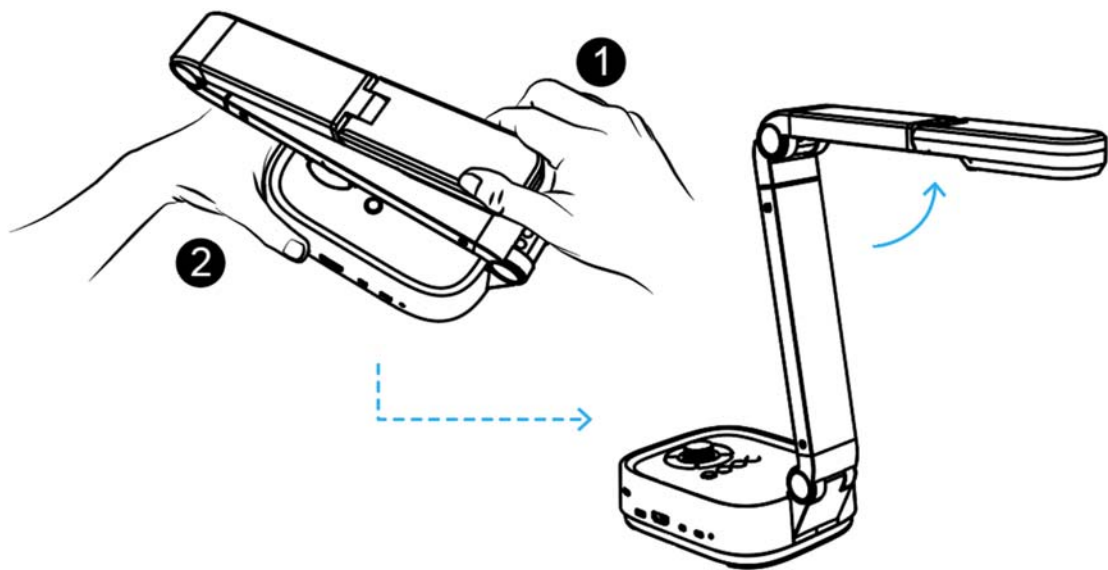

3. Place a document or object to be displayed under the camera.
4. Press the power button to turn on the power.
5. Adjust the arm to change the height and position for capturing your image.

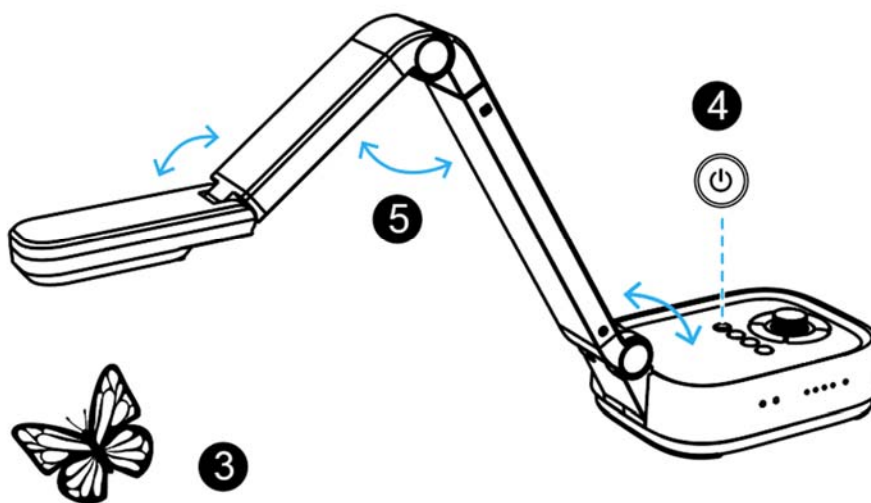



## Step 6. USB & HDMI Connections

### USB Mode Connection

1. Switch to the USB connection mode at the side of the doc cam.
2. Plug the supplied USB type-C cable to the doc cam and connect the other end to your computer's USB port.

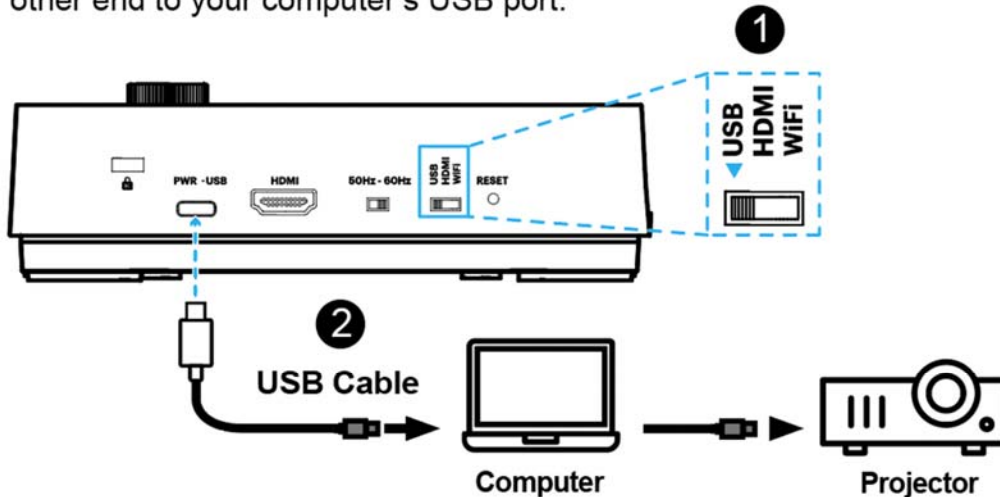

### HDMI Mode Connection

1. Switch to the HDMI connection mode at the side of the doc cam.
2. Plug the HDMI cable to the doc cam and connect the other end into a projector, monitor or TV (HDTV).

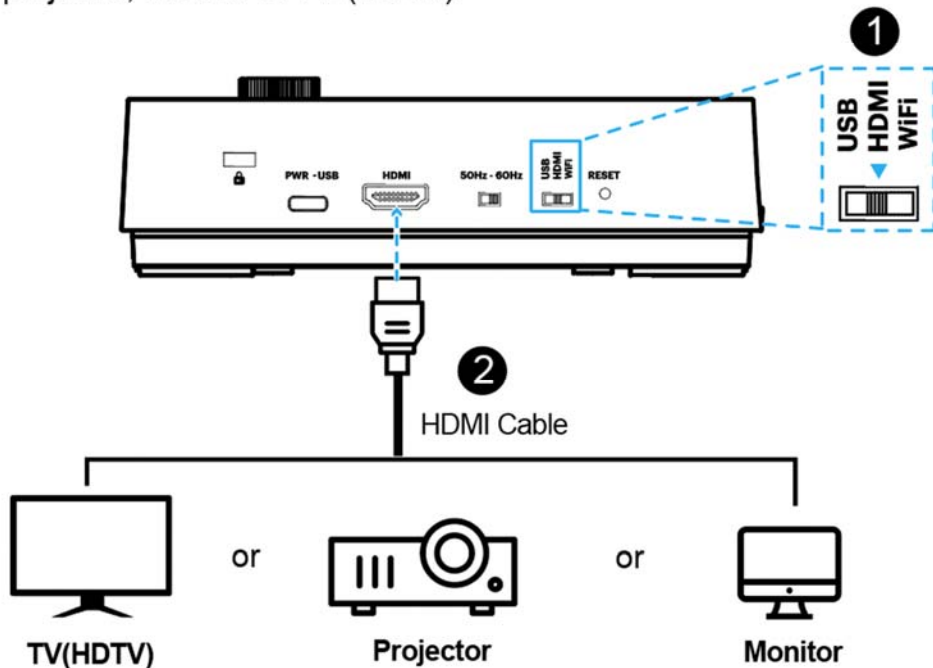



## Step 7. Wi-Fi Connection

### Network Connection

1. Switch to the Wi-Fi mode at the side of your doc cam. The Wi-Fi LED indicator will emit a flashing green light.
2. Open the wireless network list on your computer.
3. Select the [QOMO\_5G\_xxxxxx] in the network list, and input the password for connection (default: 88889999) to start the connection.
4. When the connection is successful, the Wi-Fi LED indicator will emit a steady green light.

### Log in to the web page

1. Open the web browser, and enter the default IP [192.168.100.1] in the address bar.
2. Enter the login account [admin] and default password [9999], and click Login.
3. After logging in to the web page, you can access a live preview and configure the settings on the web page.

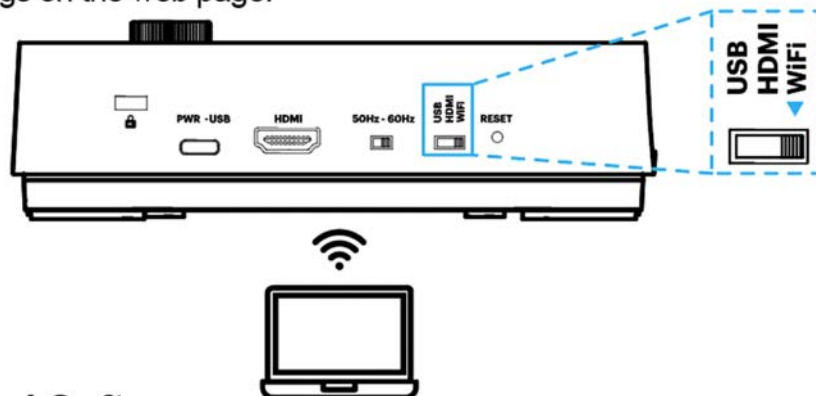

### Download Software

The WanderCam Pro is a standard UVC camera -- you can use it with a variety of software that support UVC camera connection. The WanderCam Pro is compatible with the third-party video conferencing softwares Zoom, Microsoft Teams, or Google Meet. However, to get the full functionality of this 4K document camera, we'd recommend using it with the QCapture Pro and you can download this free from the QOMO website at the link below.

<https://www.qomo.com/software>



qomo.com 1-866-990-7666 support@qomo.com

# Wi-Fi Connection Instructions

V1.1

## Wi-Fi AP Mode Connection

1. Toggle the switch on the side of the unit to the Wi-Fi mode. The Wi-Fi LED indicator will emit a green flashing light.

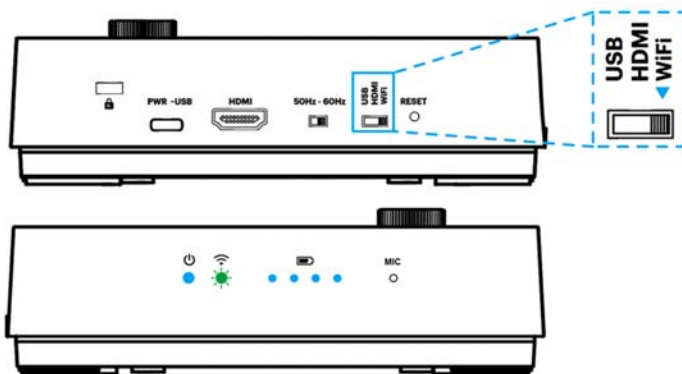

2. Open the wireless network list on the computer then select the [QOMO\_5G\_XXXXXX] in the network list and input the password for

connection (default: 88889999) to start the connection.



3. When the connection is successful, the Wi-Fi LED indicator will emit a solid green light.

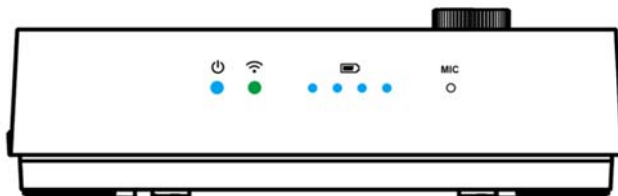

4. Launch the QCapture Pro software and select the mode "**Direct Wi-Fi (AP Mode) Connection**".

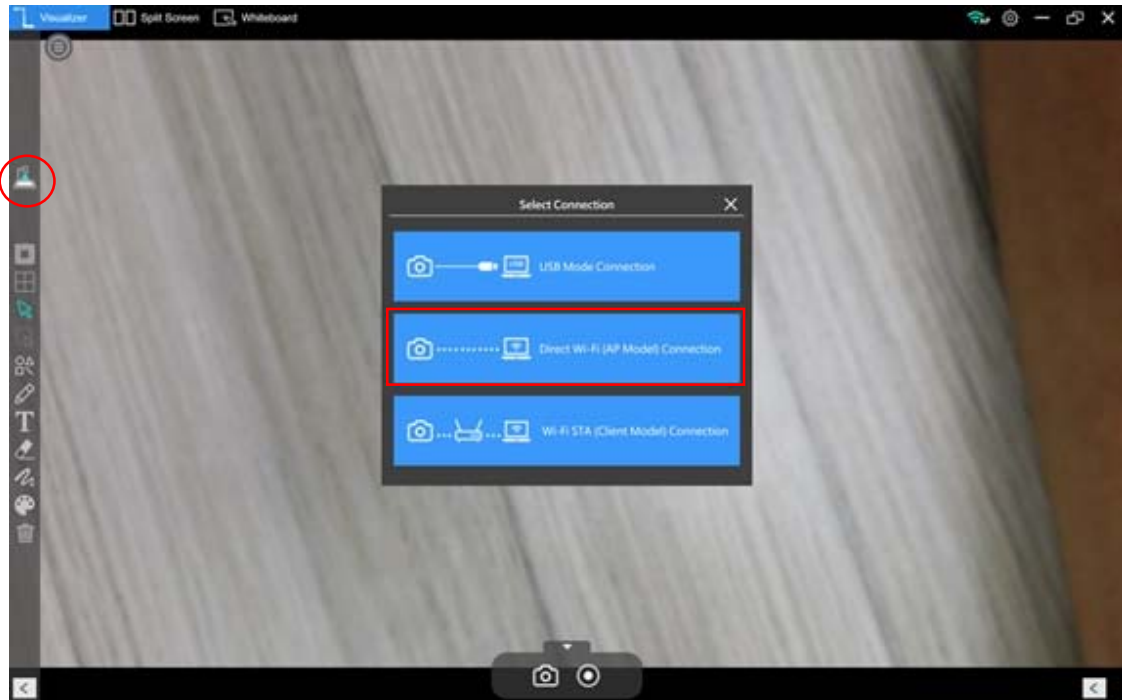

Please note: When the direct Wi-Fi AP mode is connected, the Internet will be disconnected.

## Wi-Fi Client (STA) Mode Connection

1. Toggle the switch on the side of the unit to the Wi-Fi mode. The Wi-Fi LED indicator will emit a blue flashing light.

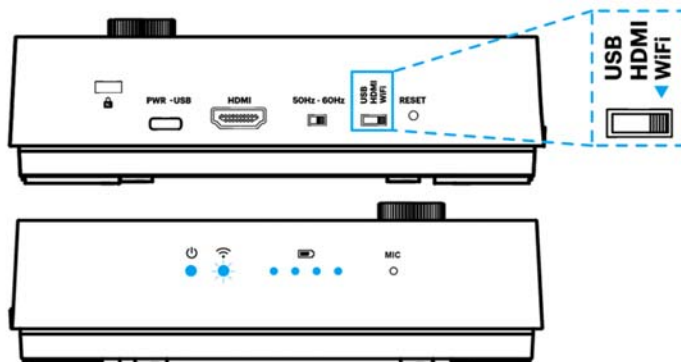

1. Open the wireless network list on the computer then select the [QOMO\_5G\_XXXXXX] in the network list and input the password for

connection (default: 88889999) to start the connection.



2. Open the web browser and enter the default IP [192.168.100.1] in the address bar.

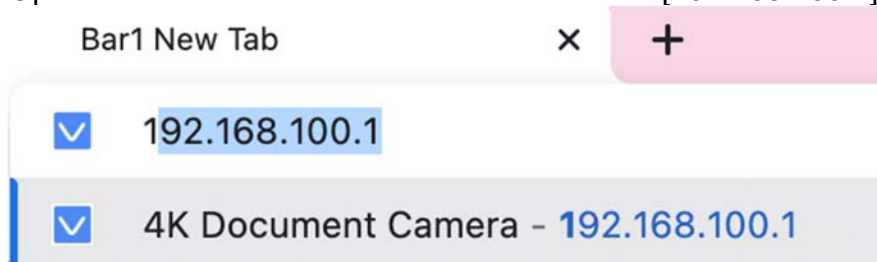

3. Enter the login account [admin] and default password [9999] and click Login.

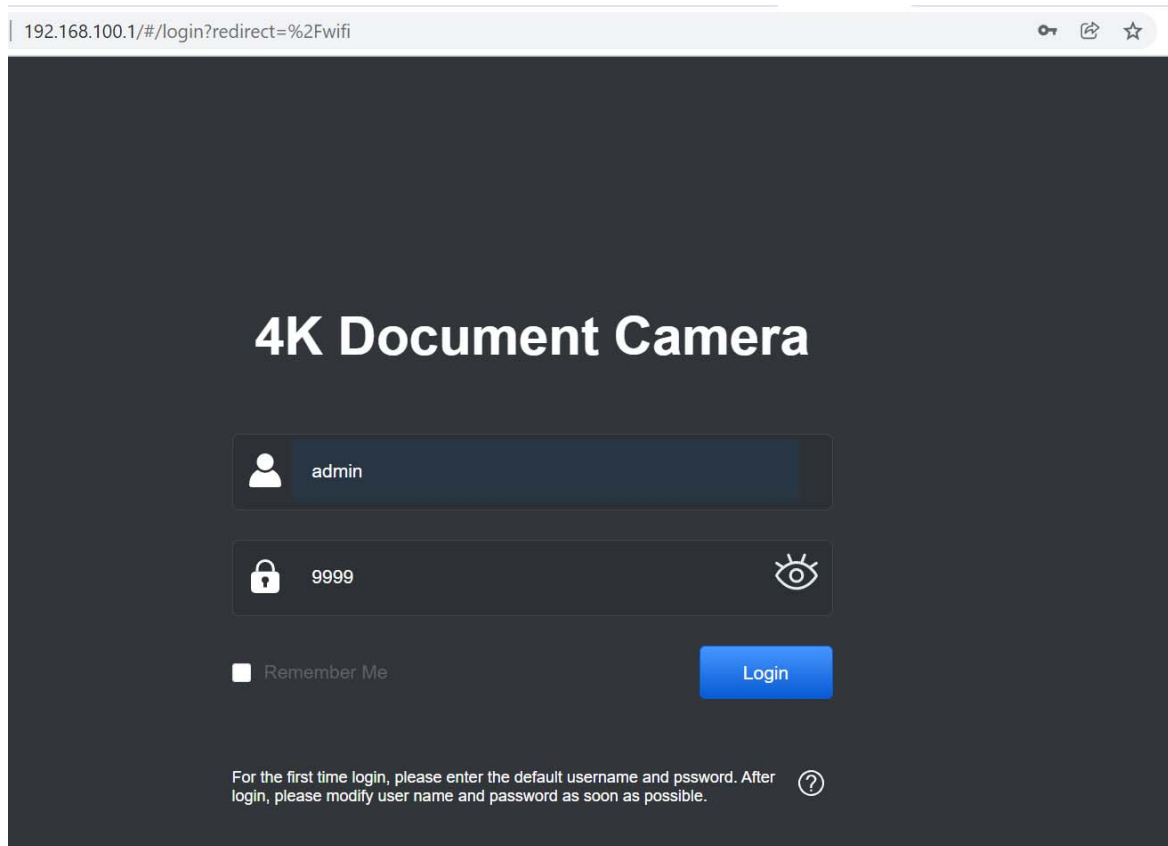

5. After logging in to the web page, you can access a live preview and configure the settings on the web page. When the STA mode is configured, launch QCapture Pro software and select the mode **“WiFi STA (Client Mode) Connection”**.

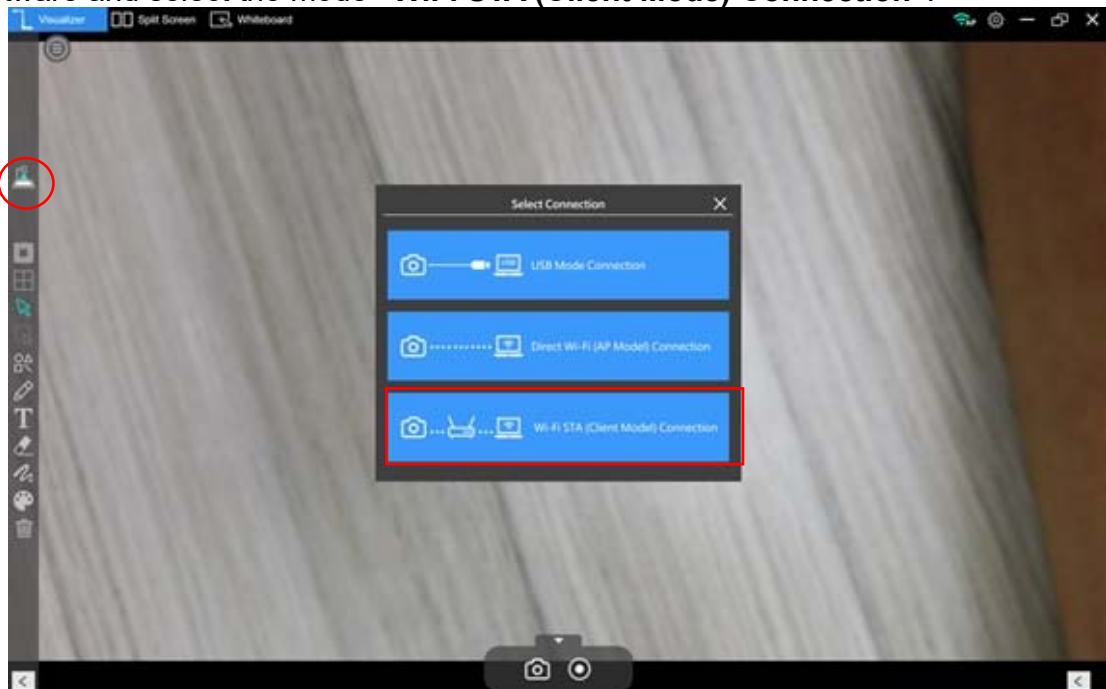

# Web Page Settings Instructions

V1.1



Web Page Menu Function Description

1. Login Screen

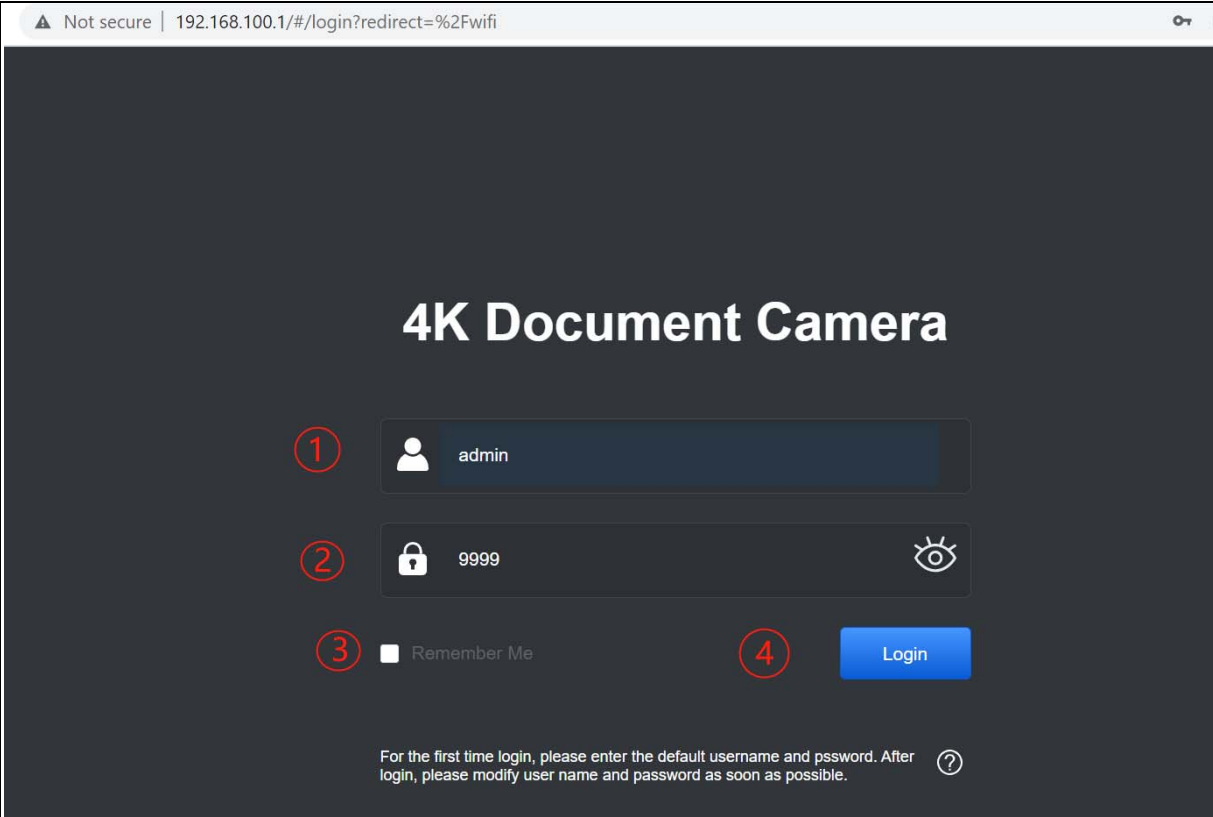

No	Item	Function Descriptions
1	User Login Account	Enter user login account (default: admin)
2	User Password	Enter user password (default: 9999)
3	Remember user account and password	Save user login account and password to the browser. When you log in next time, there is no need to re-enter them
4	Login	Log into the administrator screen on the website

## 2. Live Viewing

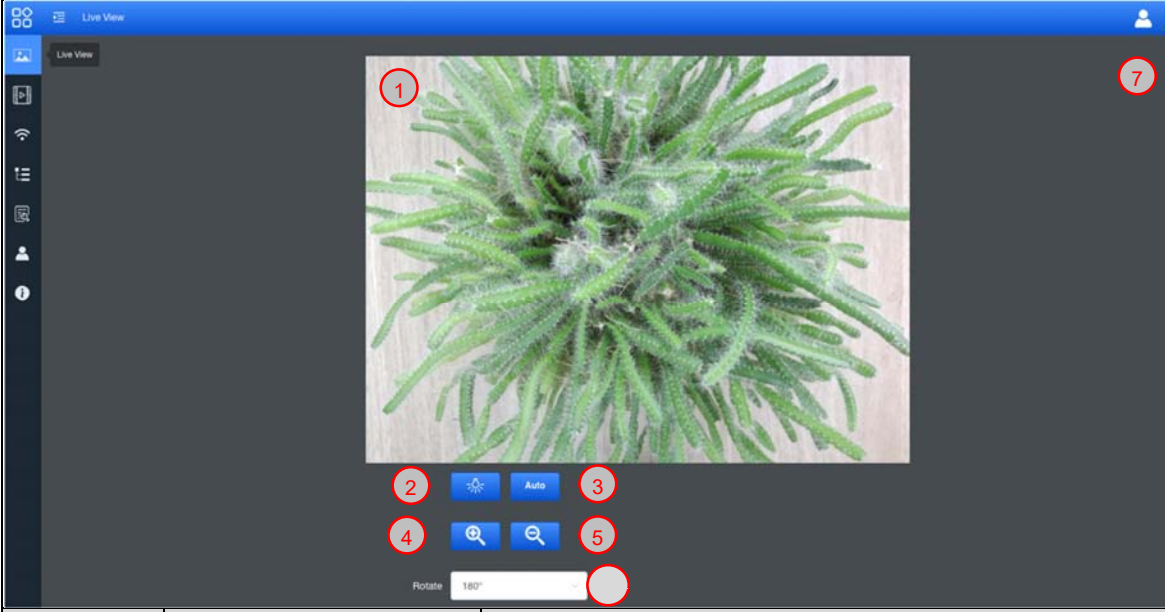
		
No	Item	Function Descriptions
1	Preview window	Display the live preview image captured by the QPC100W
2	Autofocus	Automatically adjusts the image for the optimal brightness and focus
3	Lamp mode toggle switch	Click lamp mode to toggle the light switch: off / brightness 1 / brightness 2 / brightness 3
4	Zoom In	Zoom in image
5	Zoom Out	Zoom out image
6	Rotate the image	Rotate the image: 0° / 90° / 180° / 270° / Flip / Mirror
7	Logout	Log out of the web page

### 3. RTSP Streaming Settings

The screenshot shows the 'RTSP Stream' configuration window. On the left is a sidebar with icons for various settings. The main area contains the following settings:

- 1** Video Resolution: A dropdown menu showing '1024 x 768'.
- 2** Bitrate: A text input field showing '3000' followed by 'kbps'.
- 3** Port Number: A text input field showing '554'.
- 4** Enable Audio: A toggle switch that is currently turned on (blue).
- 5** RTSP URL: A text field showing 'rtsp://192.168.31.77/video1.sdp' with a copy icon to its right.

At the bottom of the settings area are three buttons:

- 6** Save: A blue button.
- 7** Cancel: A blue button.
- 8** Default: A blue button.

No	Item	Function Descriptions
1	Resolution	Show or set the RTSP output resolution and fps
2	Bit Rate (kbps)	Show or set the RTSP Bit rate (0 ~ 20000)
3	Port Number	Set the RTSP port (0 ~ 10000)
4	Audio Setting	Turn on/off RTSP audio
5	RTSP URL	Show current RTSP URL connection
6	Save	Save and change the RTSP streaming settings
7	Cancel	Cancel without saving
8	Default	Restore to default settings

#### 4. Wi-Fi Setting (Access Point Mode)

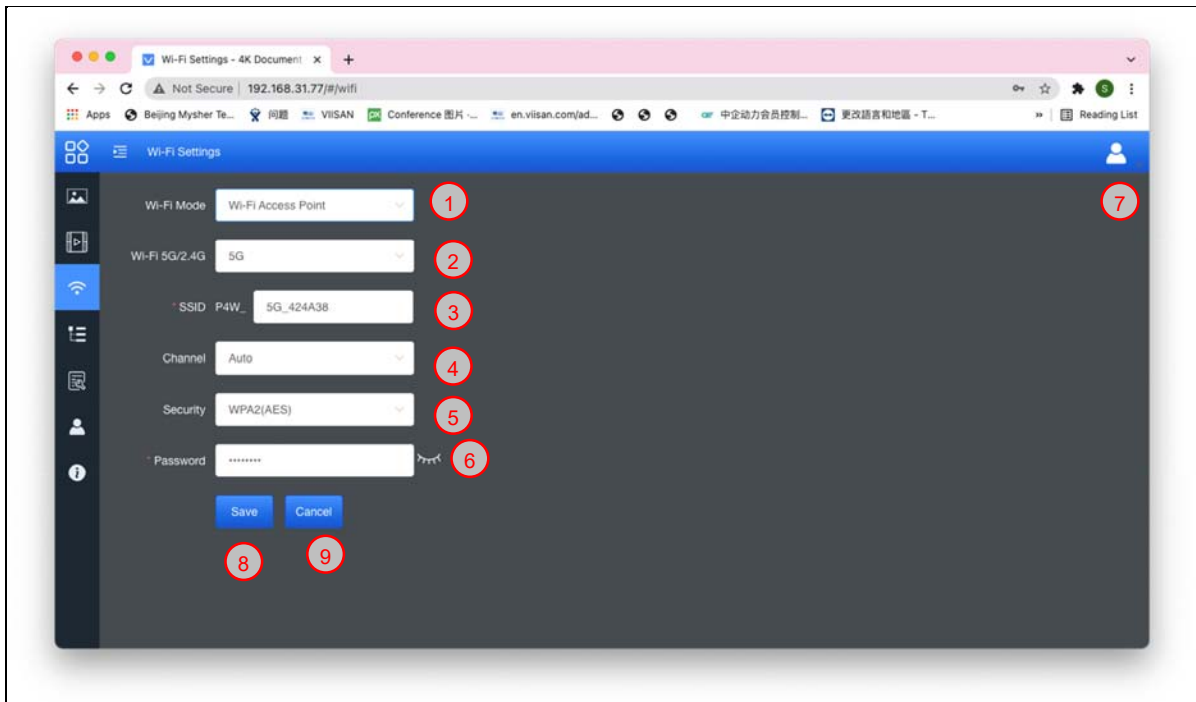

No	Item	Function Descriptions
1	Wi-Fi Mode	Select Access Point or Client Mode
2	Wi-Fi 5G/2.4G	Switch between 5G / 2.4G under Wi-Fi Access Point mode
3	Device Name (SSID)	Device name of wireless network
4	Channel	Select the channel based on different regions
5	Security	Wi-Fi encryption setting
6	Password	Connect the Wi-Fi SSID password
7	Show Password	Show the Wi-Fi SSID password
8	Save	Save and change the wireless network settings
9	Cancel	Cancel without saving

## 5. Wi-Fi Setting (Client Mode)

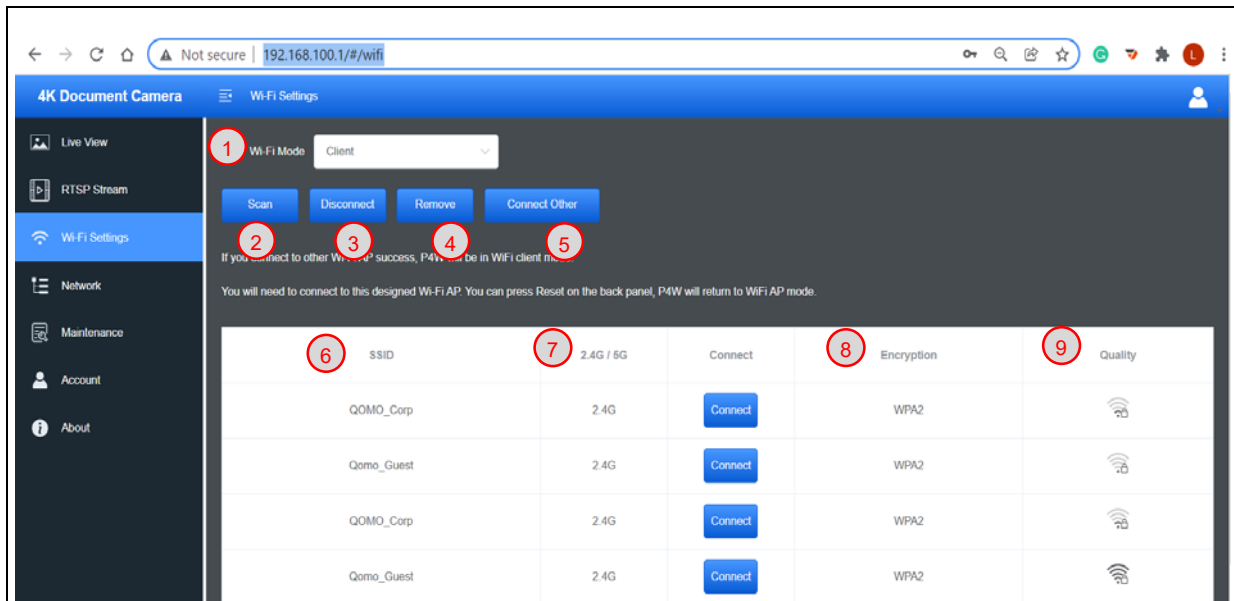

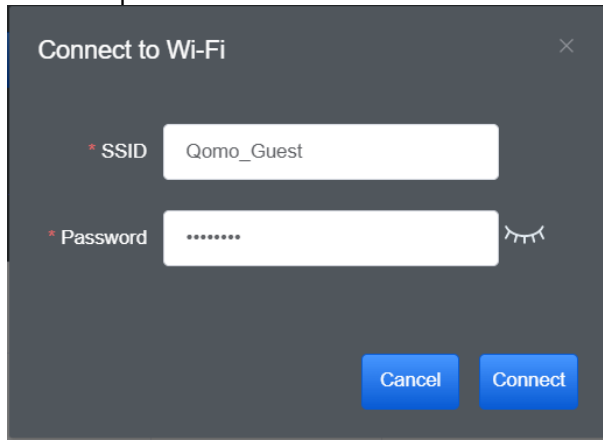
No	Item	Function Descriptions
1	Wi-Fi Mode	Select Access Point or Client Mode
2	Scan	Scan nearby wireless network devices
3	Disconnection	Disconnect from current wireless network device
4	Remove	Remove the selected wireless network device from the list
5	List of Wi-Fi Wireless Network Device Names	<p>Click the wireless device and the following image will be displayed. Enter the password to connect to various wireless network devices</p> 
6	Device Name	Device name of wireless network
7	Connection Status	Display the wireless network device to which QOMO QPC100W is currently connected to. If connected, the corresponding field of the wireless device will display "Connected", otherwise it will stay blank
8	Encryption	The current encryption setting of the wireless network device
9	Signal Status	Show the degree of the Wi-Fi signal

## 6. System Network Information

Wi-Fi Mode:  [Modify](#)

IP Assignment:

IP Address:

Subnet Mask:

Gateway:

Primary DNS Server:

Secondary DNS Server:

[Save](#) [Cancel](#)

No	Item	Function Descriptions
1	Network	The network setting of the QPC100W device. When the DHCP function is closed, click edit to enter edit mode and change the network setting.

## 7. Maintenance

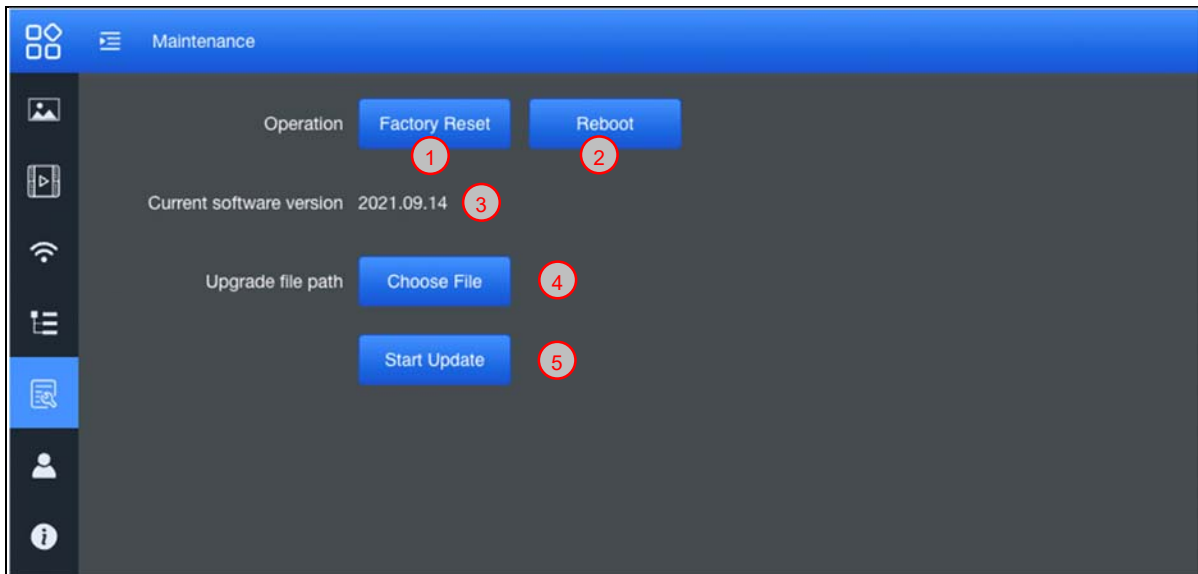

No	Item	Function Descriptions
1	Reset to the default value	Select the reset button to resume the factory default setting as the web page setting
2	Reboot	Click the reboot button and reboot the device
3	Current Firmware version	Display current firmware version
4	Upgrade file path	Choose firmware *.appsw file
5	Start Update	Click and start update the firmware



8. User Account

Account

User Name

admin

Password

....

1

Save

Cancel

No	Item	Function Descriptions
1	User Name	Allow modify the user login account (default: admin)
2	Password	Allow modify the login password (default: 9999)
3	Save	Save and change the wireless network settings
4	Cancel	Cancel without saving

## 9. About

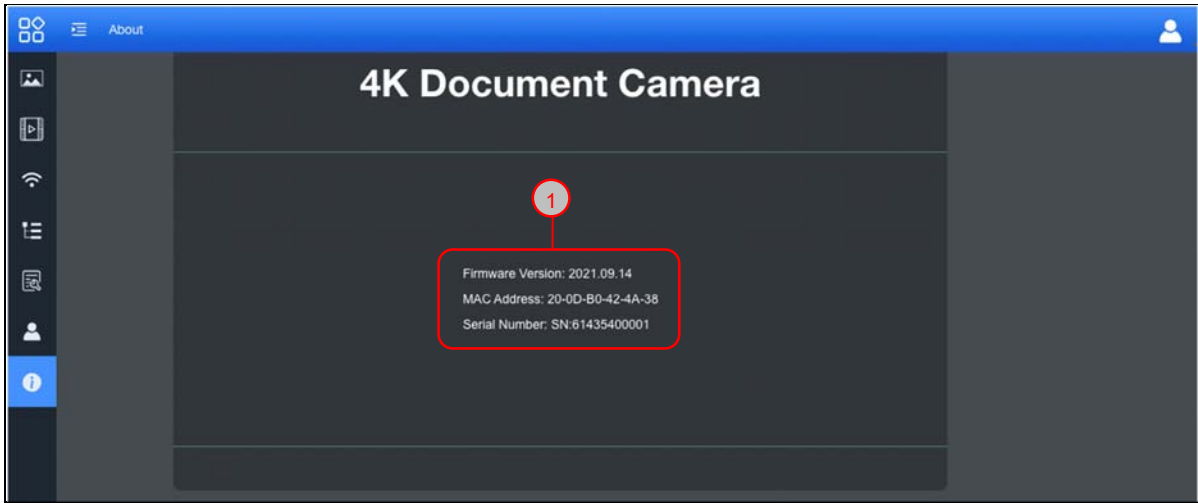

No	Item	Function Descriptions
1	Related Information	Display information about this device.

## **Supplier's Declaration of Conformity 47 CFR § 2.1077 Compliance Information**

**Manufacturer :** QOMO,LLC

**Product Name :** QPC100W

**Model Number :** 4K Wireless Document Camera

### **Responsible Party – U.S. Contact Information**

**Supplier :** QOMO,LLC

46950 Magellan Drive, Lot 4 Wixom, MI 48393, Michigan 48393, United States

**e-mail :** support@qomo.com

### **FCC Compliance Statement**

Changes or modifications not expressly approved by the party responsible for compliance could void the user's authority to operate the equipment.

This equipment has been tested and found to comply with the limits for a Class B digital device, pursuant to Part 15 of the FCC Rules. These limits are designed to provide reasonable protection against harmful interference in a residential installation. This equipment generates uses and can radiate radio frequency energy and, if not installed and used in accordance with the instructions, may cause harmful interference to radio communications. However, there is no guarantee that interference will not occur in a particular installation. If this equipment does cause harmful interference to radio or television reception, which can be determined by turning the equipment off and on, the user is encouraged to try to correct the interference by one or more of the following measures:

- Reorient or relocate the receiving antenna.
- Increase the separation between the equipment and receiver.
- Connect the equipment into an outlet on a circuit different from that to which the receiver is connected.
- Consult the dealer or an experienced radio/TV technician for help

This device complies with part 15 of the FCC rules. Operation is subject to the following two conditions (1) this device may not cause harmful interference, and (2) this device must accept any interference received, including interference that may cause undesired operation.

This equipment complies with FCC radiation exposure limits set forth for an uncontrolled environment. This equipment should be installed and operated with minimum distance 20cm between the radiator & your body.