

COAYU Robot Vacuum Cleaner

MODEL: C560

INSTRUCTION MANUAL

Please keep this instruction manual in your sight, read it thoroughly and carefully before you use this product.

Thanks for your choosing Coayu C560. We sincerely hope you are fully satisfied using your robot as part of your cleaning routine.

Coayu C560 is a high-end robot vacuum cleaner with 360° Panoramic camera helping gyroscope to do cleaning routine navigation. Here is the brief introduction what it can do for you:

1. Wi-Fi APP for remote control (please search "Coayu" in google play store or IOS appstore)
2. Panoramic camera help gyroscope to do navigation, no corner of the house will be missed.
3. Lithium battery 2600 mAh, support a 110-120 minutes cleaning, around 100 - 120m² area.
4. Anti-fall and anti-collision system, automatically back to the charge station system.
5. With VR headset, you can watch the " Robot Adventure" in APP (the camera video).

If you have any questions when using the robot vacuum cleaner, do not hesitate to contact us:
support@cloudsbot.com ,our Technical Customer Service Department will be more than happy to answer you.

We reserve the right to make technical alterations to the appliance without prior notice with the objective of continually improving our products and customer satisfaction.

For more information, you can visit our official website: www.coayu.com

Content

Features	3
Package	4
Diagram	5
Robot Vacuum Cleaner	5
Rolling Brush / Charge Station / Water Tank / Remote Control	5
Display Panel	6
Operation	6
Start / Standby / Sleep	6 - 8
Schedule	8
Charge	9
Cleaning Mode	9
Maintenance	10 - 11
Side Brush / Water Tank and Filters	10
Charging Contactor / Normal Dust Bin and Filters	10
Rolling Brush / Sensors	11
Specification	11
Troubleshooting	11
After Sale Service	12
Safety Instruction	12
Warning about Battery	13
APP Instruction	14 - 15

Features

Fine Industrial Design

- Toughened glass cover with the best scratch proof feature.
- 7.9cm thickness body, the robot vacuum cleaner can go to the bottom of furniture's, no corner would be missed in cleaning.

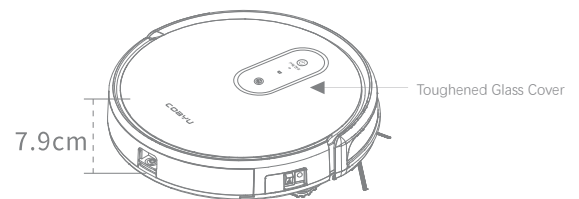

360° Panoramic Camera Helpful in Navigation

- The camera help gyroscope doing more accurate navigating
- With VR headset, you can watch the "Robot Adventure" in Coayu app

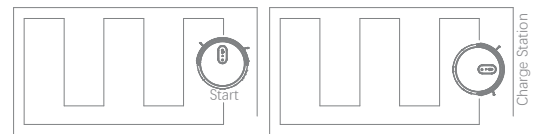

Intelligent Water Tank and Dust Bin Design

- Combined water tank and dust bin design, helps the robot do sweep and mop together
- Intelligent controlled water flow speed, when robot finish cleaning or in charging, it will stop water flow automatically. Never worry the water may destroy your floor.

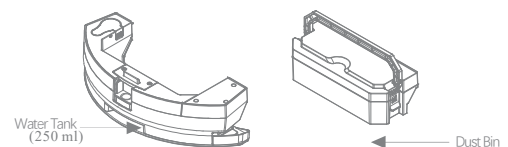

Packages

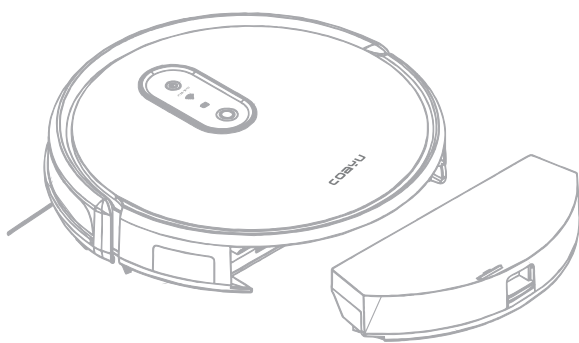

Robot Vacuum Cleaner

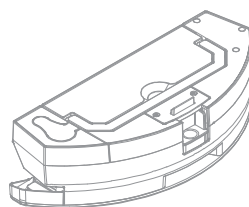

Electronic Controlled Water Tank and Dust Bin

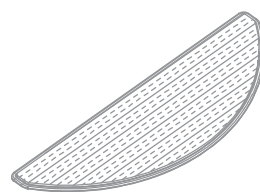

Micro Fiber

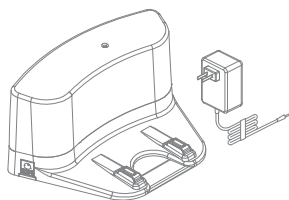

Charge Station

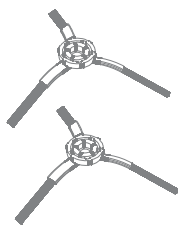

Side Brush

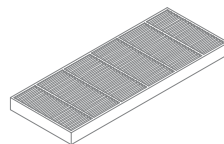

HEPA Filter

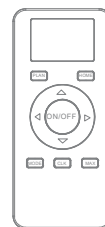

Remote Control

Diagram

Robot Vacuum Cleaner

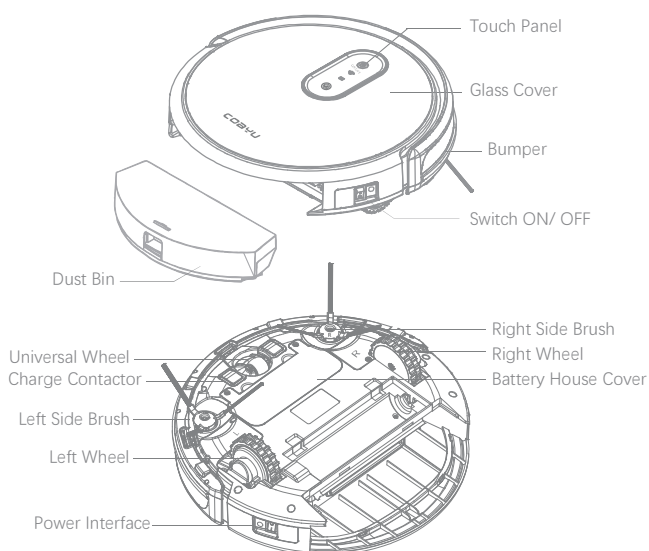

Rolling Brush Kit

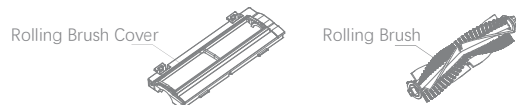

Charge Station

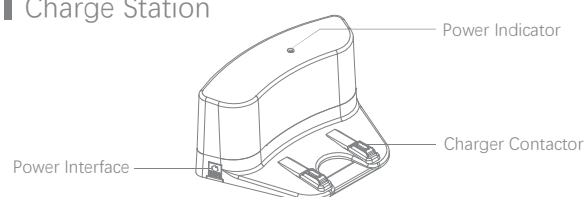

Electronic Controlled Water Tank And Dust Bin

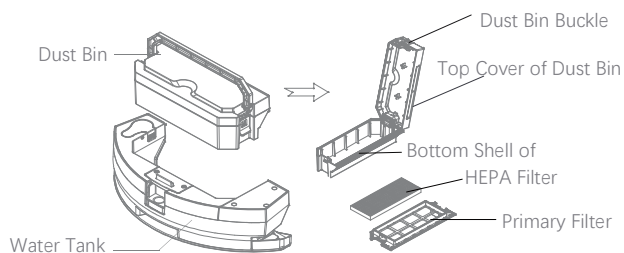

Remote Control

- | | |
|----------------|------------------|
| 1. LCD Display | 2. Auto-recharge |
| 3. Direction | 4. Max power |
| 5. CLK | 6. PLAN |
| 7. ON/OFF | 8. Cleaning Mode |

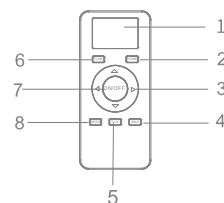



! Tips:

1. 4. Max and 5. CLK key only works in Standby mode.
2. Please install 2PCS A & A battery before using

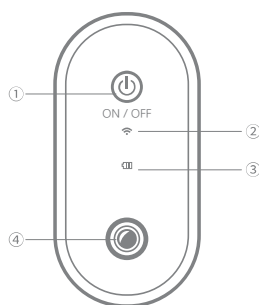
Touch Panel

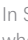

- ① “  ” ON/OFF
 - a. Press “  ” to turn on the robot vacuum cleaner, and press again to start cleaning.
 - b. When robot cleaner in Sleep Mode, press to enter Standby Mode
 - c. When robot cleaner in Standby Mode, press to start cleaning.
 - d. In Standby Mode, press “  ” over 3 second to set up the Wi-Fi when you connect the “Coayu robot ” App.
- ② Wi-Fi Indicator Light

When you using the “Coayu robot ” App and enter Internet Set Up step, it will show the internet connection status.
- ③ Battery Indicator Light

When the robot cleaner need charging, it will be in Red Color; during charging, it will be in Red-Blue color alternating; when charging is over, it will be in Blue color.
- ④ 360 °Panoramic Camera help to do navigation, the robot would know more accurate of the house.
Connect to Coayu app, you can watch the real-time viedo via VR headset.

Operation

Step 1: Side Brush Installation

Both robot vacuum cleaner and side brushes marked “ L ” and “ R ” on the body, please install side brush marked “ L ” to the “ L ” side of robot vacuum cleaner, and “ R ” side brush to “ R ” side of the robot.

Tips: the hair is easy to winded around the side brush, please keep cleaning once a time per week.

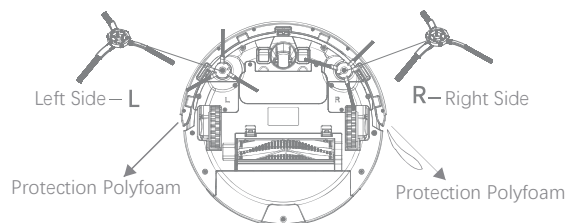

Step 2: Place Charge Station and Charge Robot

■ Please switch on the robot cleaner before charging

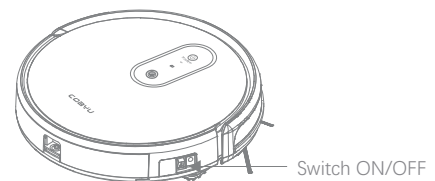

■ Connect the charge station to the power, and place it against the wall, clear the obstacles 1 meter left / right side to the station, and 2 meters in front of the station. After that put the robot cleaner to the charge station, it will start charging automatically.

Tips: Please make sure charge time over 5 hours in first time.

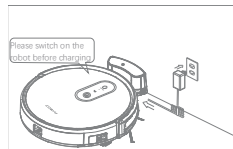
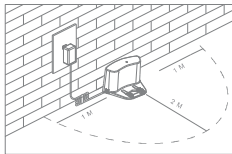

Step 3: Clear Obstacles

1. Pick up peel, paper, clothes etc. on the floor
2. Pick up curtain rope, and entangled wires
3. Pick up curtain, bedsheets hanged more than 5cm over the ground
4. Clean water stains over the ground

Tips

1. Big garbage easy to block the vacuum port and stuck the wheels, entangled wires easy trap the robot cleaner.
2. Robot cleaner cannot vacuum the water, it may damage the motherboard and motors.

Step 4: One Key to Start

Press " ⏻ " on the robot vacuum cleaner to start / Pause the cleaning, when cleaning over, robot will go back to the charge station automatically, please keep the charge station power plugged in.

Step 5: Empty the Dust Bin

Tips: empty dust bin on time to make the robot cleaner keep cleaning effectively.

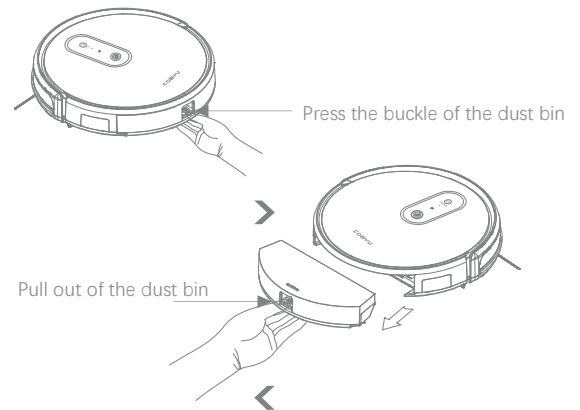

One hand press the buckle of dust bin, another hand open the top cover. Be careful not drop the dust out in opening.

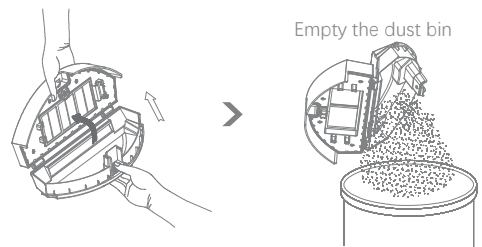

Step 6 : Install Electronic Controlled Water Tank and Dust Bin

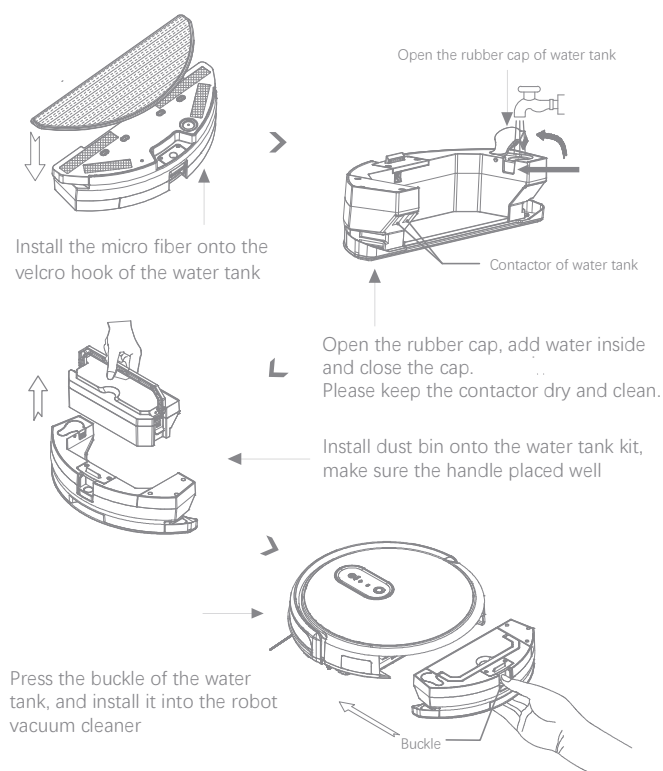

8

Start / Standby/ Sleep

1, Start/ Pause

- Switch On the robot vacuum cleaner
- Press "⏻" of touch panel and wait for the blue indicator light not twinkling, press it again to start the robot cleaner.

2, Standby

Standby means the robot is power on and awaiting for user's operation

- When robot in working status, press "⏻" on robot or "ON/OFF" on remote control to make robot vacuum cleaner enter Standby status.

3, Sleep

In Sleep mode, press "⏻" on robot or "ON/OFF" on remote control to wake up the robot vacuum cleaner. In Sleep mode, the robot could maximumly save battery capacity.

- in Standby mode, the robot cleaner will enter Sleep mode automatically in 10 minutes if no operation command.
- if robot cleaner failed back to charge station, it will enter Sleep mode automatically.

! Attention: in Sleep mode, the robot cannot be waken up in app, should operate with "ON/OFF" on remote control, or "⏻" on touch panel of robot.

Schedule

Please refer the details of App Using Guide : Schedule Setting

Battery Charging

When battery level less than 20%, the robot vacuum cleaner will go back to the charge station automatically.

Or you can use the remote control or "Coayu Robot" app to drive the robot cleaner going back to the station.

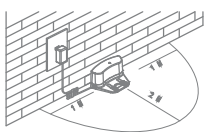

Please keep the charge station in power all 24 hours, then the robot could always receive the signal of the station.

Also you can manual charge the robot cleaner directly like Fig 2.

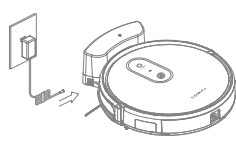

Fig 1

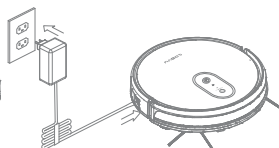

Fig 2

Ways to extend battery life effectively

- charge the robot cleaner over 5 hours in first time charging.
- please charge on time when battery capacity is less than 20%.
- when robot finish the cleaning or battery capacity less then 20%, the robot vacuum cleaner will go back to the charge station automaticall
- please fully charge the robot cleaner and switch off when you will not use it for a certain time.
- If you did not use the robot over 3 months, please charge over 5 hours firstly, and then use it for cleaning.

Cleaning Mode

1. Automatic Cleaning

In Standby Mode, press "⏻" on robot or "ON/OFF" on remote control to enter auto cleaning mode.

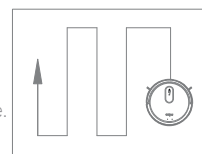

2. Max Cleaning

Press "MAX" on remote control, the robot will enter powerful cleaning mode, bigger power in vacuum.

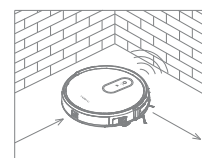

3. Mode Cleaning

Press "MODE" on remote control to enter Mode Cleaning:

- Press "MODE" on remote control to enter MODE 1 cleaning: robot will start edge cleaning.
- Press "MODE" again, the remote control will display MODE 2: the robot will cleaning in a 2 x 2m area.
- Press "MODE" again, the remote control will display MODE 3: the robot will cleaning in random.
- Press "MODE" again, the remote control will display MODE 4: the robot will deep clean one area twice.
- Press "MODE" again, the remote control will no display MODE anymore, robot enter Standby status.

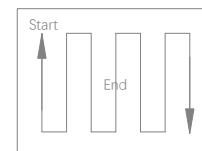

4. Schedule Cleaning

If you set schedule cleaning in "Coayu Robot" app, the robot will cleaning automatically at the setted time.

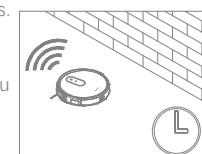

Maintenance

Side Brush

Please clean the side brush every week, if the brushes out of shape, put them into 90° hot water over 5 seconds, it will restore.

Tips : we suggest change new side brushes every 3-6 months



Water Tank and Filters

Please follow steps to clean water tank and filters:

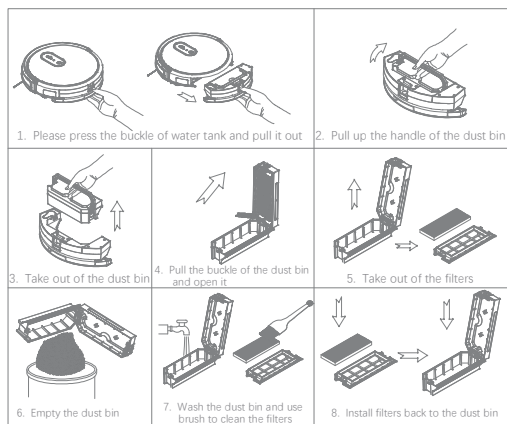

Charging Contactors

Please clean the charging contactors of the station and robot regularly with a soft cloth, never let the sensor get wet.

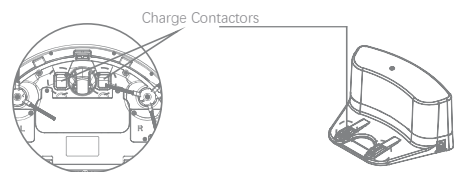

Normal Dust Bin and Filters

Please empty dust bin on time as steps:

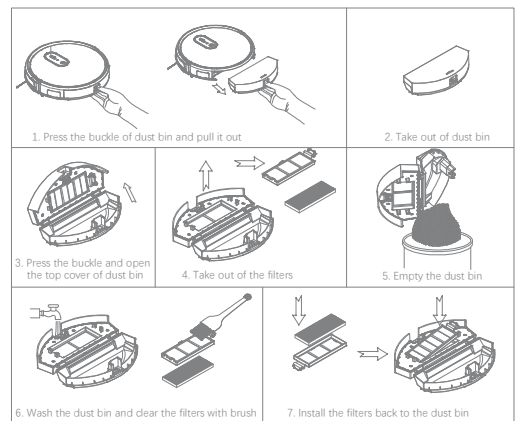

! Attention

Please make sure the primary filter is dry when you install it back to dust bin.

Rolling Brush

Please clean the rolling brush kit every week.

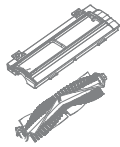

Specification

Classification	Specification	Value
Dimension	Diameter	335mm
	Height	79mm
	Weight	2.5KG
Electronic	Voltage	14.4V
	Battery Capacity	LI 2600mAH
Cleaning	Dust Bin Capacity	0.25L
	Water Tank Capacity	0.2L
	Charge Type	Manual/ Auto re-charge
	Cleaning Type	Auto / Max / Mode / Schedule
	Charge Duration	4—6 Hours
	Cleaning Duration	80±10 Minutes
Operation	Mop Duration	80±10 Minutes
	Touch Panel Operation	

Note: the specification could be modified with the objective continual improvement.

Sensors and Wheels

The universal wheel and anti-fall sensors on the bottom of the robot must be regularly cleaned with a soft cloth. Never let the sensors get wet.

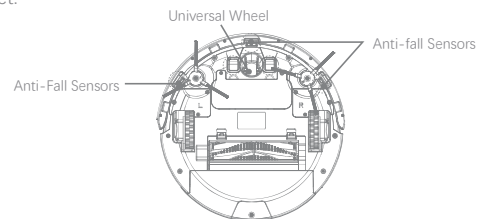

Troubleshooting

Troubleshooting & Solution

Voice Demonstrate	Solution
Please turn on the power switch	Switch on the robot
Please charge	Put the robot onto the charge station
Please put the machine in a safe place	1, the robot off the floor, please put the robot onto floor
	2, the anti-fall sensor may dirty, please clean with cloth
	3, the sensor may send false alarm, please restart the robot
Left front bumper fault	Check the bumper if it spring back correct
Wheel overload	Check if foreign body winded the wheels, and remove it
Side brush overload	Check if foreign body winded the side brush, and remove it
Rolling brush overload	Check if foreign body winded the rolling brush, and remove it

! Attention:

If above solution not work, please try:

1. restart the robot vacuum cleaner
2. contact our customer service center: support@cloudsbot.com for after sale service.

After Sale Service

Warranty

All robot vacuum cleaners from Coayu with 18 months warranty. the battery have 6 months warranty.

Our Coayu Robot customer service department is ready to help you by email: support@cloudsbot.com

NOTE:

The warranty does not cover damage caused by rusting, a collision or misuse. Accessories are not covered by the warranty.

Safety Instruction

Before using an electrical appliance, basic precautions should always be followed, which include:

- * Only authorized technicians can disassemble the product. Users are not allowed to disassemble or repair the product.
- * Only use the original battery and power adapter(Model:GQ12-2400 60-AG/AB/AA/AU) of the product for charging. Using an unmatched adapter may cause electric shock, fire or product damage.
- * Do not touch the power cord, plug or adapter with wet hands.
- * Do not use this product in wet or moist environment (any environment with liquid), e.g. bathroom or laundry.
- * Do not have curtain, any kind of wrapping material or part of user's body wound in the drive wheels.
- * Before use, clean floor environment (remove all fragile objects and cords, clothing, paper, loose cables, as well as make sure to lift curtains and drapes off the floor to avoid any possible accidents.)
- * Make sure this product is not close to cigarette ends, lighters, matches or any flammables.
- * Never use the product to clean combustible or highly volatile liquids, such as gasoline.

- * Only use the product indoors; do not use it outdoors.
- * If the product needs cleaning, clean it after it is fully charged.
- * Do not over-bend or press the flexible cord with heavy or sharp objects.
- * Do not sit on top of this product or attach an object on the top of it. Beware of children or pets while the product is in operation.
- * Do not place this product where it is easy to drop off (tables, chairs, etc.).
- * Turn off the power switch during product transportation or when you don't need to use this product for a long time.
- * Before charging, check whether the adapter and outlet are properly connected.
- * To avoid tripping, all the people in the house should be noticed when this product is on.
- * When dust bin is full, empty it before use.
- * Use this product in temperature from 0°C to 40°C .
- * Do not use this product in high-temperature environment or under baking sunlight for a long time.
- * This appliance contains batteries that are only replaceable by skilled persons. The battery must be removed from the product before it is scrapped. The battery should be disposed of properly for safety sake.
- * The adaptor must be removed from the socket-outlet before cleaning, maintaining the appliance or removing the battery.
- * The power supply must be removed from the socket-outlet before cleaning or maintaining the appliance.

WARNING:

- * This appliance can be used by children aged from 8 years and above and persons with reduced physical, sensory or mental capabilities or lack of experience and knowledge, if they have been given supervision or instruction concerning use of the appliance in a safe way and understand the hazards involved. Children should not play with the appliance. Cleaning and user maintenance should not be made by children without supervision.
- * For the purposes of recharging the battery, only use the detachable supply unit provided with this appliance.

Warnings about Battery



You must not remove (or attempt to remove) the battery incorporated in this product on your own. To replace the battery, you must contact your service provider or an independent qualified professional. These instructions have been prepared for the exclusive use of your service.

FOR YOUR OWN SAFETY, DO NOT ATTEMPT TO REMOVE THE BATTERY ON YOUR OWN OR DISPOSE OF IT IN FIRE. DO NOT DISASSEMBLE, CRUSH OR PUNCTURE THE BATTERY.

Battery Removal

1. Remove the screws on battery cover with a screw driver.
2. Remove the battery cover.
3. Grasp the insulating tape at two sides of the battery and lift the battery.
4. Unplug the wire connector that links the battery and robot.

Correct disposal of batteries in this product (Applicable in countries with separate battery return system.)

The marking on the battery, manual or packaging indicates that the battery in this product should not be disposed of with other household waste. Where marked, the chemical symbols Hg, Cd or Pb indicate that the battery contains mercury, cadmium or lead above the reference levels in EC Directive 2006/66.



The battery incorporated in this product is not user replaceable. For information on this replacement, please contact your service provider. Do not attempt to remove the battery or dispose it in a fire. Do not disassemble, crush, or puncture the battery. If you intend to discard the product, the waste collection site will take the appropriate measures for the recycling and treatment of the product, including the battery.

This device complies with part 15 of the FCC Rules. Operation is subject to the condition that this device does not cause harmful interference (1) this device may not cause harmful interference, and (2) this device must accept any interference received, including interference that may cause undesired operation.

Changes or modifications not expressly approved by the party responsible for compliance could void the user's authority to operate the equipment.

NOTE: This equipment has been tested and found to comply with the limits for a Class B digital device, pursuant to Part 15 of the FCC Rules. These limits are designed to provide reasonable protection against harmful interference in a residential installation. This equipment generates, uses and can radiate radio frequency energy and, if not installed and used in accordance with the instructions, may cause harmful interference to radio communications. However, there is no guarantee that interference will not occur in a particular installation.

If this equipment does cause harmful interference to radio or television reception, which can be determined by turning the equipment off and on, the user is encouraged to try to correct the interference by one or more of the following measures:

- Reorient or relocate the receiving antenna.
- Increase the separation between the equipment and receiver.
- Connect the equipment into an outlet on a circuit different from that to which the receiver is connected.
- Consult the dealer or an experienced radio/TV technician for help.

To maintain compliance with FCC's RF Exposure guidelines, This equipment should be installed and operated with minimum distance between 20cm the radiator your body: Use only the supplied antenna.