

Manual of 99169

(Multifunctional)



Warning: this product is specially designed for children age 3-8, and for one child only, the max carry is 30kgs. To reduce the risk of injury, adult supervision is required. Never use in roadways, near motor vehicles, on or near steep inclines or steps, swimming pools or other bodies of water, always wear shoes, and never allow more than one rider(s). RISK OF FIRE. Do not bypass. Replace only with over-load protector (8A).

CAUTION:

CHANGES OR MODIFICATIONS NOT EXPRESSLY APPROVED BY THE PARTY RESPONSIBLE FOR COMPLIANCE COULD VOID THE USER'S AUTHORITY TO OPERATE THE EQUIPMENT.

NOTE: This equipment has been tested and found to comply with the limits for a Class B digital device, pursuant to Part 15 of the FCC Rules. These limits are designed to provide reasonable protection against harmful interference in a residential installation. This equipment generates, uses and can radiate radio

frequency energy and, if not installed and used in accordance with the instructions, may cause harmful interference to radio communications. However, there is no guarantee that interference will not occur in a particular installation.

If this equipment does cause harmful interference to radio or television reception, which can be determined by turning the equipment off and on, the user is encouraged to try to correct the interference by one or more of the following measures:

- Reorient or relocate the receiving antenna.
- Increase the separation between the equipment and receiver.
- Connect the equipment into an outlet on a circuit different from that to which the receiver is connected.
- Consult the dealer or an experienced radio/TV technician for help.

This device and its antenna must not be co-located or operating in conjunction with any other antenna or transmitter.

Specification:

N.W: 17.8KGS Max speed: 3.3KM/h (high gear) or 1.8km/h (slow gear)

Size: 126.5x71.5x53(cm) Max load: 30KGS

Battery: 12V 5AH

Use the charger: (DC 14.5V 500MA) to charge your battery (12V 5AH).

Continuous run time: approximately 56 minutes. (It subject to the carry weight and environment)

Installation method:

Please remove the parts from the package and follow the installation instructions(Plastic bags may cause danger, in order to prevent from suffocation, please put away from children.)

Attention:

1. The product assembly must be completed by adults.
2. The battery positive and negative electrode must be connected at the same electrode otherwise it will damage car.
3. This product has some tiny components, it is not suitable for children under the age of 3.

1. Back Wheel Installation:

Turn the car over and make sure that it is stable. Cut the tape off of the gear box, and then remove the protective jacket on the rear axle. Smear lube oil on both ends of the rear axle. Install, in order, the fixment, the driving wheel (this wheel has a place for the fixment), Metal gasket, pin, and then fasten the wheel cover. On the other side install a Metal gasket, wheel, Metal gasket, pin, wheel cover. (The rear wheel installation is completed)

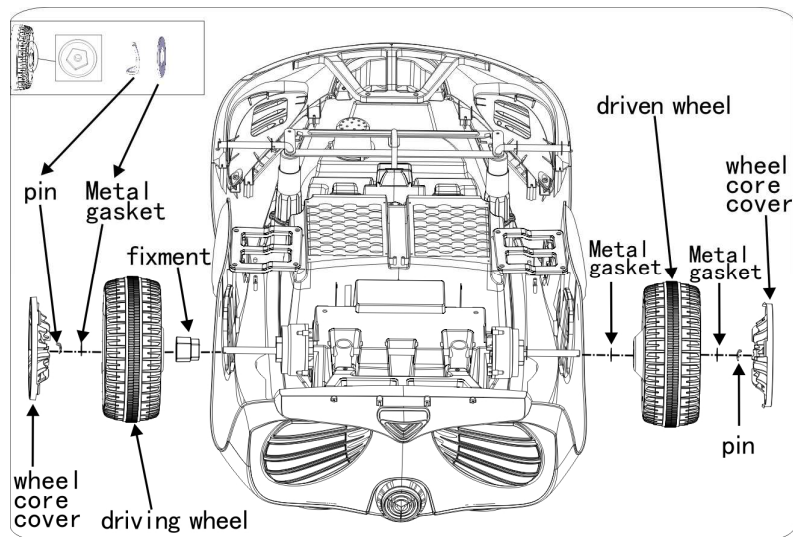

2. Front Wheel Installation

Smear lube oil evenly on the left and right of front axle. Then put on the metal gasket, wheel, metal gasket, put on the pin and the wheel cover for the left and right axle. (Front wheel installation is completed)

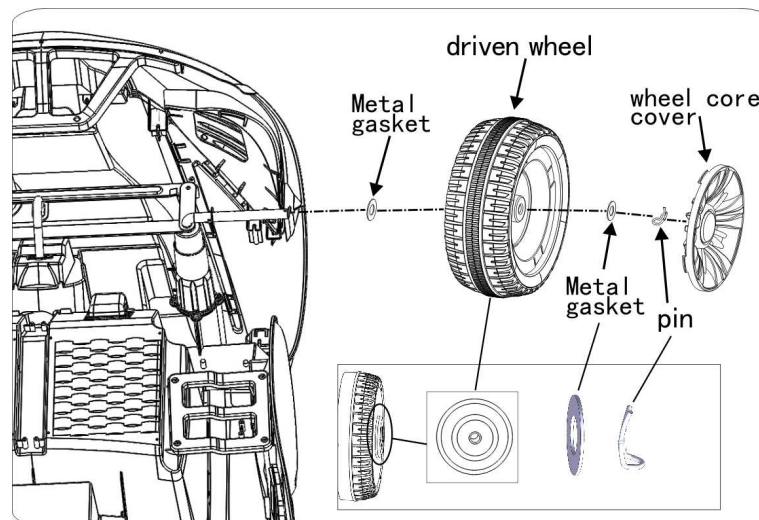

3. Seat Installation

Connect both plugs from the battery and the PCB under car (black wire connected the black terminal, red wire connected the red terminal).

Unfasten the seat belt and then put the belt sides over the side of the car. Insert the seat, first the hooks near the shoulder should be put in the corresponding holes on the car, then line up the locks with the bottom of the seat. Use a screwdriver or coin to turn the "lock" logo. Double check that the seat is locked in place.

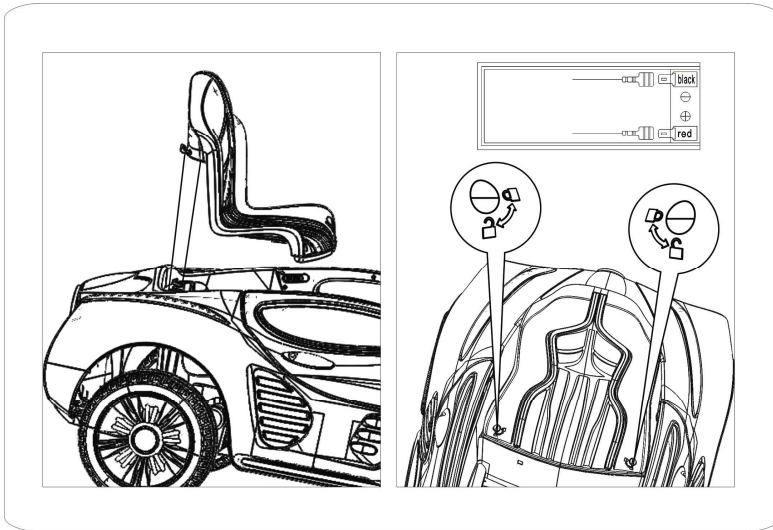

4. Front Cover Installation

Line up the notches on the front cover with the corresponding openings on the front part of the vehicle. Push the notches into these openings. (The installation of Front Cover is finished.)

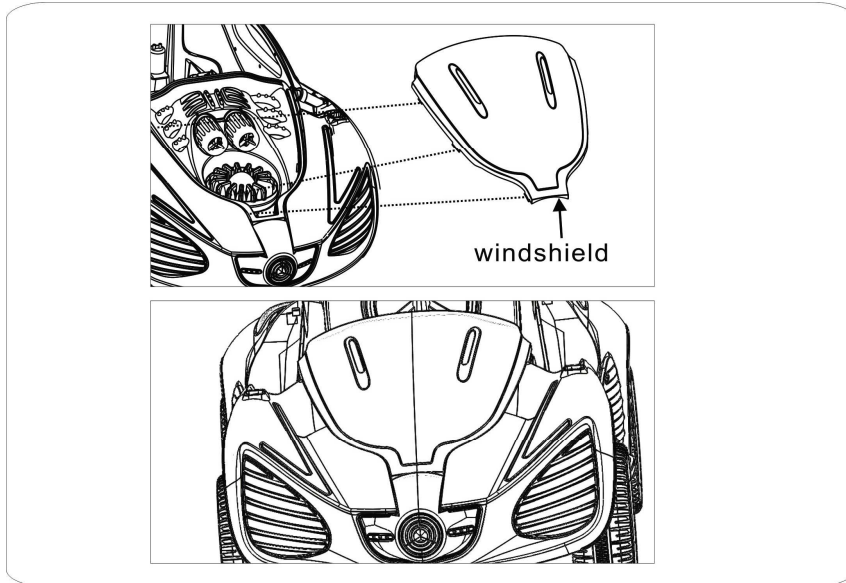

5. Steering wheel installation

Remove the pin and cap nut from the steering wheel, and then connect the steering wheel's plug with dashboard's plug. Then put the steering wheel hole into the steering shaft's hole, (Attention: the steering wheel outlet hole must be in the same direction with the dashboard's hole, otherwise the cable will be damaged.).

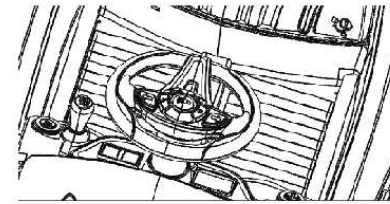
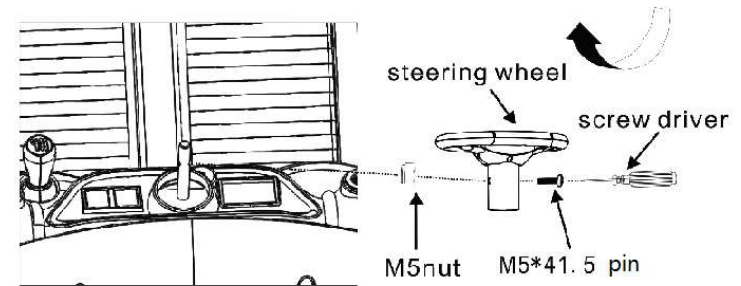

6. Side mirror installation.

Fasten the bottom of the mirror into the corresponding opening (Installation finished)

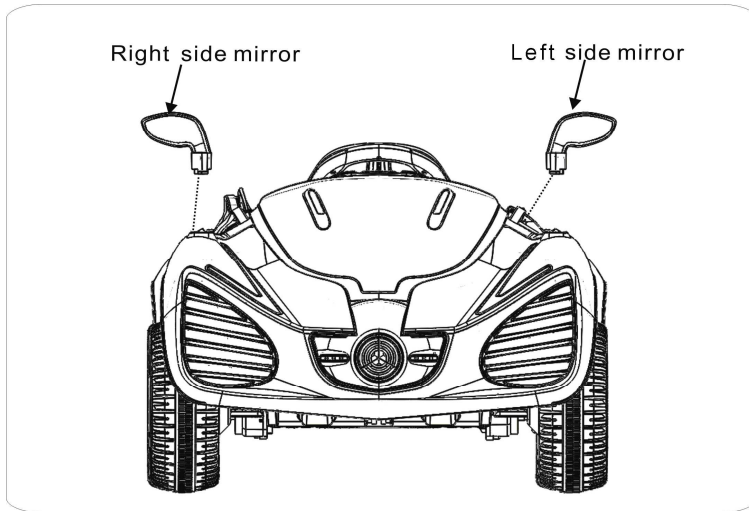

Button Functions

1. Power switch:

When the start button is pressed, the car power will turn on, lights will flash, and there are startup sounds, when pressed one more time, the car will power off.

2. Forward:

There is a forward and backward lever to the right of the steering wheel. Switch to the forward function and step on the throttle pedal, the car will drive forward, loosen it or step on the brake pedal, and the car will stop.

3. Backward:

There is a forward and backward lever to the right of the steering wheel. Switch to the backward function and step on the throttle pedal, the car will drive in reverse, loosen it or step on the brake pedal, and the car will stop.

4. Brake:

While going forward or backward, when you step on the brake pedal, the car will stop.

5. Turn left or right:

Driving direction is controlled by steering wheel, when the car goes forward, if the steering wheel is turned clockwise, the car will turn right, if the steering wheel is turned counter-clockwise, the car will turn left, to the contrary, when the car goes backward, the driving direction is opposite.

6. Horn:

Press the horn button on steering wheel and the horn will sound.

7. Voice

Press on the steering wheel "turn left" button, the horn sounds "please note left turn" voice reminder, press the "right" button, the horn sounds "please note turn right" voice reminder.

8. Music:

Presses the music button on dash board, it sounds music. You press one time, it will change to another music. (Three songs repeats)

9. Volume control:

Presses the "+" or "-", and the volume will increase or decrease.

10. Seat belt:

Be seated, please fasten the seat belts.

11. Low power Voice prompt:

When the battery is in low voltage, voice prompt reminds the user to charge

12. Light switch:

When the light is switched on the front of the car will light up. When it is off the car will not light up.

13. Speed gear

Speed gear switch is under the seat pad, switch the button to "fast" or "slow" the car speed is fast or slow.

14. Slow start

When the car starts to move, it will be slower and then gain speed

15. Swing button

Switch the "swing" button on and the car will rock back and forth. Turn to off and the car will stop rocking.

16. Voice repeating function

Press the voice repetition button, Once the voice prompts are complete, speak clearly into the microphone. The car will repeat what was said in a different tone

Attention:

When changing from forward to backward, the user should loosen the "throttle" pedal first, otherwise it may cause damage to the car.

Before any change in the driving direction, you must to loosen the throttle pedal until the car stops and change to direction, otherwise it is easy to damage the car.

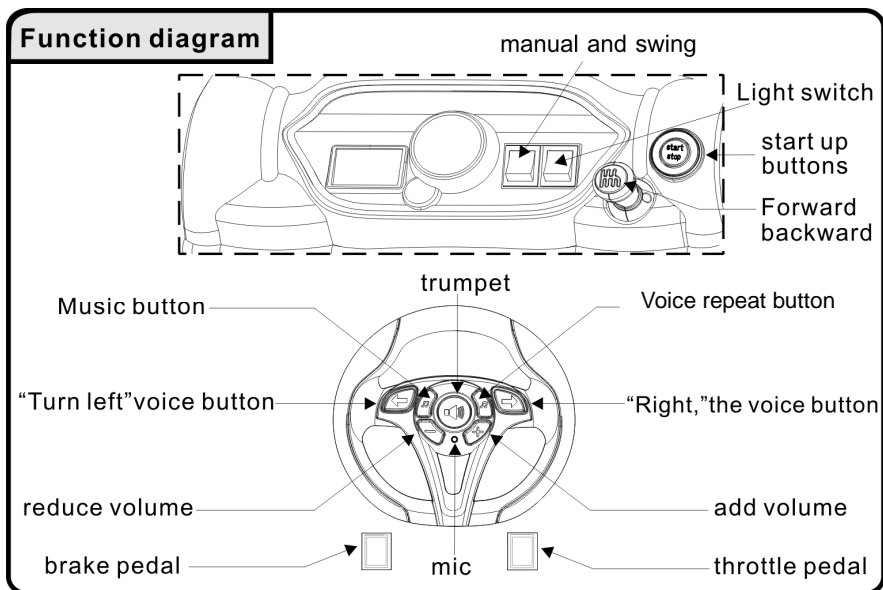

2.4G remote control

- 1, 1) open the batteries box and put in 2 AAA batteries
- 2) then press any button on remote control, the light on remote control will start flashing then start the car, the light on remote control will turn off for a second, then it will flicker at a high frequency, then 2.4G was successfully matched to the car.
- 3) After matching to the 2.4G, the light on remote control is fast flashing as default.

Press one time on speed adjust button, the car's speed will change to medium speed. Press one more time the speed adjust button, the car's speed will change to slow speed. There are three different light flicker frequency, for three different speeds.

2, when press the forward/backward/left/right button, the car will go forward/backward, turn left/right.

3, when the user presses the “pause” on remote control, remote control cannot control the car, it will change to Manual Status Control.

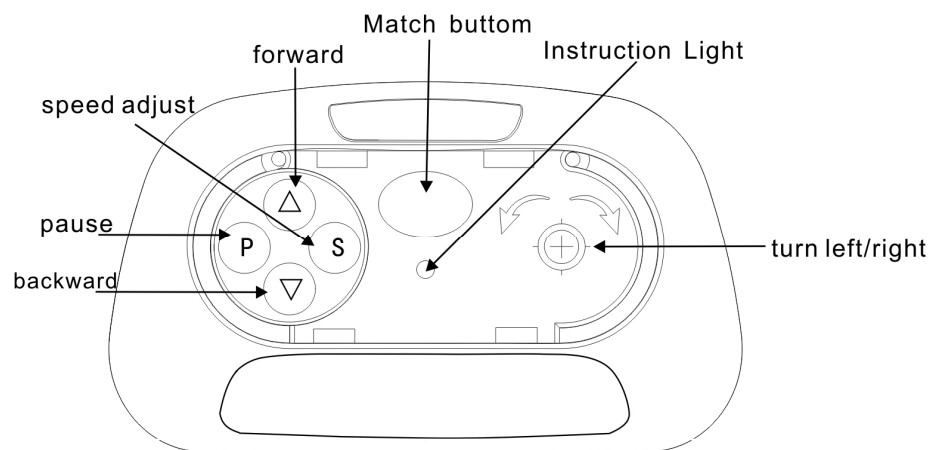

Battery Charging

1. Before Charging, turn off the car and check power supplier input must be comply with charger input, otherwise do not use it .
2. Charging slot is on the left under the seat pad. To insert the input plug to the 110V socket, and then insert the output plug into charging socket. The indicator light on the charger will turn on. The battery charge is working.
3. When you use it for the first time, it has to be charged for 12 hours, but not more than 15 hours. In future general charging time is 8 to 10 hours, but no more than 24 hours.
4. After fully charged, remove the charger and the car can be used.

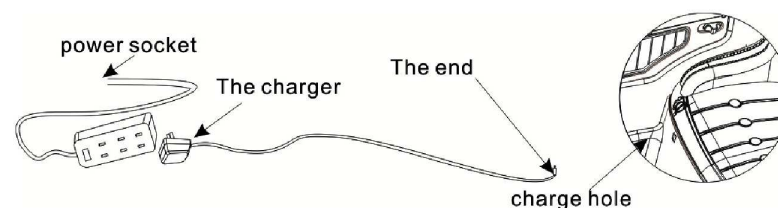

Attention

1. Charging must be done by adults
2. The charger is not a toy, please do not give children to play, and cannot be

used in any other way.

3. Before charging, check the status of the shell and electric wire, be sure they are in good condition

4. When the battery runs out, please re-charge, it is not good to store with an uncharged battery

5. The battery should not be excessively discharged; it will damage the battery; the battery's positive electrode and negative electrode should be connected in the correct method.

6. When the battery is charging, if there is any abnormal situation, please check and stop using it.

7. If you do not to use this product for a long time, please charge the battery once every three months.

8. If the battery damaged, it should be removed, and sent back in case of leakage.

9. When replacing the battery, open the seat pad, unscrew and remove the old battery then replace with the new one. Please connect the positive and negative electrode correctly.

10. Non-rechargeable batteries cannot be charged, please remove the battery from the car before battery charge, the charging work should be finished by an adult.

11. Battery's electrode must correct installed. Do not mix the new and old batteries, if the battery runs out, please take it out from the toy.

12. Do not mix alkaline, standard (carbon-zinc) or rechargeable (nickel-cadmium) batteries.

13. Cleaning should only be done when the product is unplugged and the battery is removed. Cleaning should be done under adult supervision.

14. For proper use of this product, it cannot be used by children under the age of 3.

Please keep this manual for future use.

Inspection and Maintenance

1, troubleshooting

faultsphenomenon	inspectionitem	Exclusion methods
1. Can't drive	1, Start button is pressed or not	Press the start button
	2. check the wheels if there were some sundry	Clean up the sundry
	3, Wire connection is loose or not	Connect the wires
	4, recoverable fuse in the protection state or not	Please stop the operation, wait about 30 seconds.
2, Moving slowly	1, overloaded or not	To reduce weight
	2, check the wheels if there were some sundry	Clean up the sundry
	3, Battery power is enough or not	Charging the battery.
3, Charging rechargeable dissatisfaction	1, charger connect the power socket or not	Connect the power socket
	The Charger broken	Change the charger
	The battery broken	Change the battery

If you cannot find the problem or repair, please send the product back to the dealer for maintenance.

2. Maintenance:

1) Please check the charger, battery, electrical wires, plugs, screw and shell of car body and other parts regularly, if find the damage please, please repair it.

2 When it needs to be cleaned, the car should be cut off from power, and the cleaning work should be done by an adult.

3) Please uses duster cloth with water or other neutral liquids, do not use corrosive liquid or bleach.

Maintenance record

Repair day	fault reason	replacement part	quantity	maintenance man	Customer Signature