

适合年龄14岁以上

⚠️ 温馨提示：本产品为低电流充电设备，请不要使用快充插头进行充电，避免充电器损坏或短路！

1. 遥控器功能键：

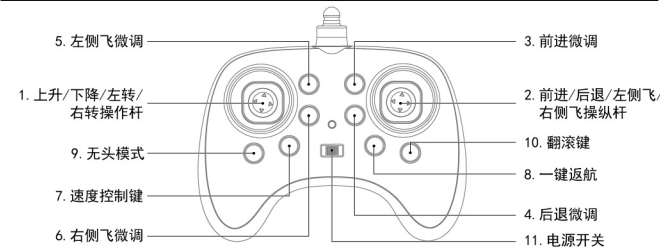

2. 遥控器电池安装说明：

- 2.1 打开遥控器背面的电池盖。(图示A)  
2.2 按照电池箱内的电极指示正确装入3节1.5 “AAA” 电池。(图示B) 不可混用新旧或不同类型的电池。  
2.3 盖上电池盖。

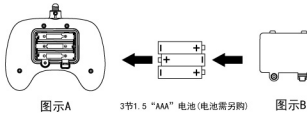

3. 飞行器锂电池充电使用说明：

- 3.1 打开飞行器电池槽盖子将锂电池模块从电池槽中取出。(图示C)  
3.2 将USB充电线插头插入USB电源插口中，然后把另一端连接锂电池模块的充电插口上；当充电时，LED灯常亮，充电结束时，LED灯熄灭，充电时间约为60分钟左右。(图示D)  
3.3 充电完成后，把锂电池模块按下图所示安装进入电池槽中。(图示E)  
⚠️ 特别提示：飞行前请将电池电量充满。  
⚠️ 低压预警提示说明：当飞机进入低压报警时机身灯会慢闪，这时表示飞机电量已经要耗完，需马上飞回。

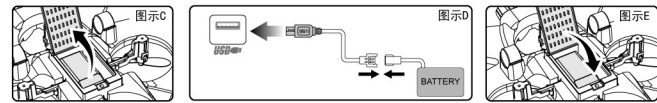

4. 飞行前准备说明：

4.1 飞行器对频

1. 把飞行器电池和遥控器电池安装好，打开飞行器电源开关，机身亮灯闪烁后放在水平地面上。  
2. 打开遥控器电源开关，机身灯变成常亮，遥控器对频成功。(重要提示：产品对频须按步骤操作，不然容易出现连接和操控不良。)

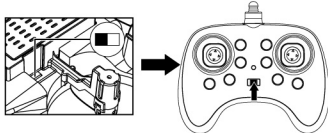

4.2 校准陀螺仪操作：

飞行器与遥控器对频成功后，可对飞行器进行校正，将油门操纵杆和方向操纵杆同时打到右下角，此时飞行器指示灯快速闪烁，待指示灯常亮，松开遥控器全部按键，校正完成。

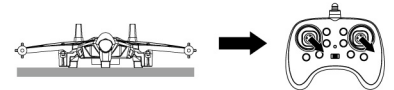

⚠️ 注意：校正必须要在水平面才可以完成校正。

⚠️ 特别提示：如果飞行器起飞偏飞也可以通过校正陀螺仪的方法进行修正。

5. 风叶安装：

请根据图示，取下风叶后进行更换。飞行器的风叶安装有位置要求，请按对应编码安装。确保所有的螺旋桨安装在正确的方位；若安装错误，飞行器将不能正常飞行。

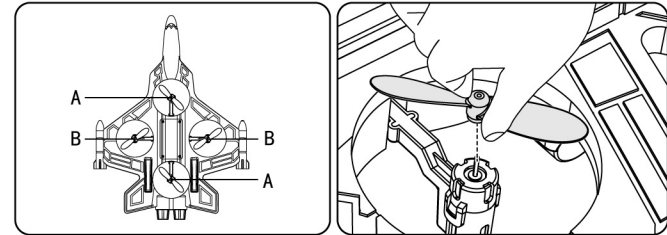

AGE: 14+

⚠️ Special note: this product is a low-current charging device, please do not use the fast charging plug for charging, to avoid charger damage or short circuit!

1. REMOTE CONTROL FUNCTION KEY

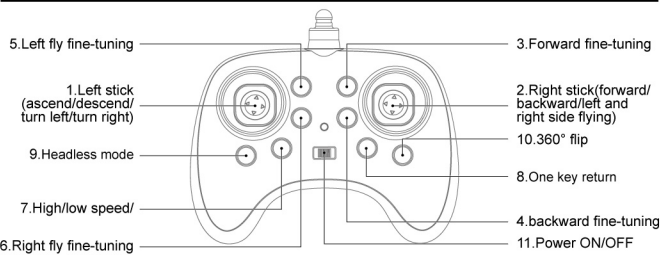

2.REMOTE CONTROL BATTERY INSTALLATION

- 2.1 Remove the battery cover from the back of controller (Fig. A)  
2.2 Install 3 “AAA” batteries into the controller, make sure to install batteries to their correct polarity. (Fig. B) Do not mix old and new batteries or battery types.  
2.3 Replace the battery cover

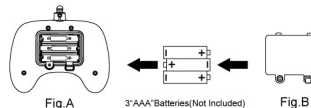

3.DRONE LITHIUM BATTERY CHARGING INSTRUCTIONS

- 3.1 Remove the lithium battery module from the battery bay by opening the aircraft battery bay cover. (Fig.C)  
3.2 Plug the USB charging cable into the USB power socket, and then connect the other end to the charging socket of the lithium battery module. When charging, the LED light is always on. When the charging is finished, the LED light is off, and the charging time is about 60 minutes.(Fig.D)  
3.3 After charging is complete, insert the lithium battery module into the battery slot as shown below.(Fig.E)  
⚠️ Special note: Please fully charge the battery before flying.  
⚠️ Low-pressure warning tips: When the drone enters the low-pressure alarm, the body light will flash slowly. At this time, it indicates that the drone has been exhausted and needs to fly back immediately.

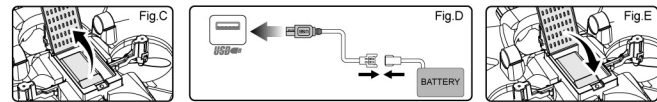

4.PREPARATION BEFORE FLIGHT

4.1 Drone frequency

1. Install the aircraft battery and the remote controller battery, turn on the aircraft power switch, and place the fuselage light on the horizontal ground after flashing.  
2. Turn on the power switch of the remote control, the body light will turn on normally, and the remote control has successfully matched the frequency.(Important note: the frequency alignment of the product must be operated according to the steps, otherwise poor connection and control may occur.)

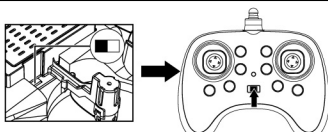

4.2 Calibration of gyroscope operation

After the drone and the remote control have successfully matched the frequency, the drone can be corrected, and the throttle lever and the direction control lever are simultaneously hit to the lower right corner. At this time, the indicator light of the drone flashes rapidly, and the indicator light is always on, and all the buttons of the remote controller are released. The calibration is complete.  
⚠️ Special Tips:If the drone takes off and flies, it can also be corrected by correcting the gyroscope.

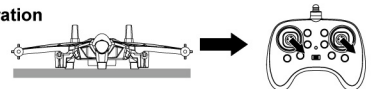

⚠️ Note:Correction should be done at the horizontal level.

5.MAIN BLADE INSTALLATION

Please unscrew the screws to open the fan blades and the connecting parts as shown in the figure below. Remove the fan blades and replace them. Make sure all propellers are installed in the correct orientation; if the installation is wrong, the aircraft will not be able to fly normally.

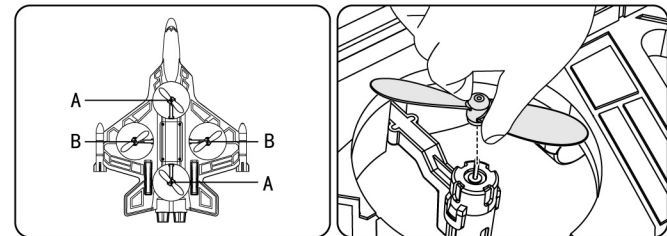

## FCC Warning

This device complies with part 15 of the FCC Rules. Operation is subject to the following two conditions: (1) This device may not cause harmful interference, and (2) this device must accept any interference received, including interference that may cause undesired operation.

Any Changes or modifications not expressly approved by the party responsible for compliance could void the user's authority to operate the equipment.

**Note:** This equipment has been tested and found to comply with the limits for a Class B digital device, pursuant to part 15 of the FCC Rules. These limits are designed to provide reasonable protection against harmful interference in a residential installation. This equipment generates uses and can radiate radio frequency energy and, if not installed and used in accordance with the instructions, may cause harmful interference to radio communications. However, there is no guarantee that interference will not occur in a particular installation. If this equipment does cause harmful interference to radio or television reception, which can be determined by turning the equipment off and on, the user is encouraged to try to correct the interference by one or more of the following measures:

- Reorient or relocate the receiving antenna.
- Increase the separation between the equipment and receiver.
- Connect the equipment into an outlet on a circuit different from that to which the receiver is connected.
- Consult the dealer or an experienced radio/TV technician for help.

The device has been evaluated to meet general RF exposure requirement. The device can be used in portable exposure condition without restriction.