

A quick guide to setting up your new oven

Visit www.juneoven.com/support to ask for help and learn more.

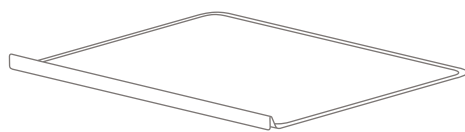

Crumb tray

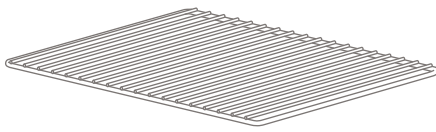

Wire rack

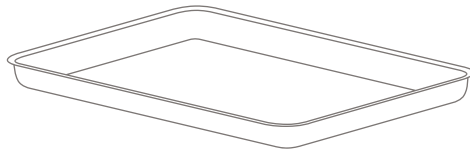

Pan

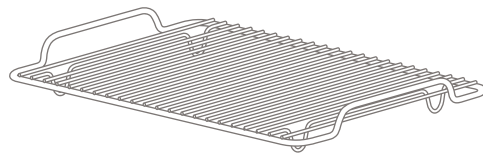

Roasting rack

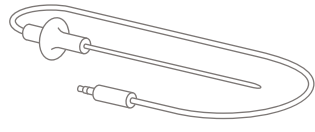

Food thermometer

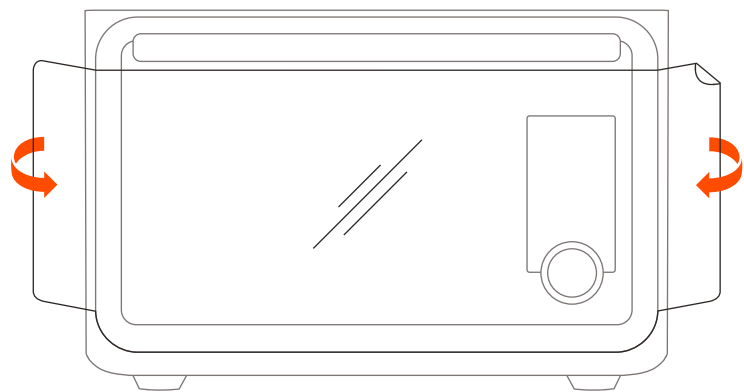

1. Remove protective films

Peel the plastic film off the oven door and top of the oven and remove the cardboard from the back. Remove all packaging from oven accessories.

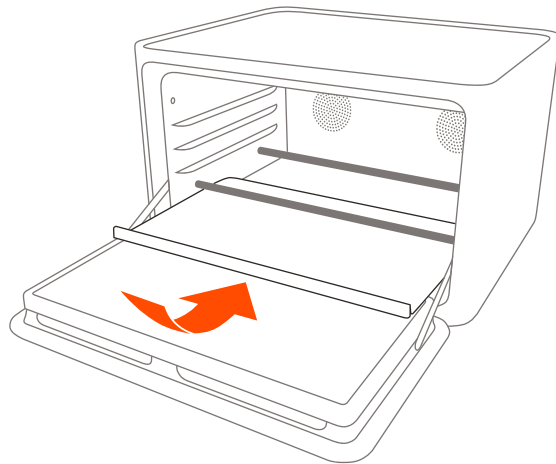

2. Insert crumb tray beneath heating elements

Insert the crumb tray on the floor of the oven, beneath the bottom heating elements.

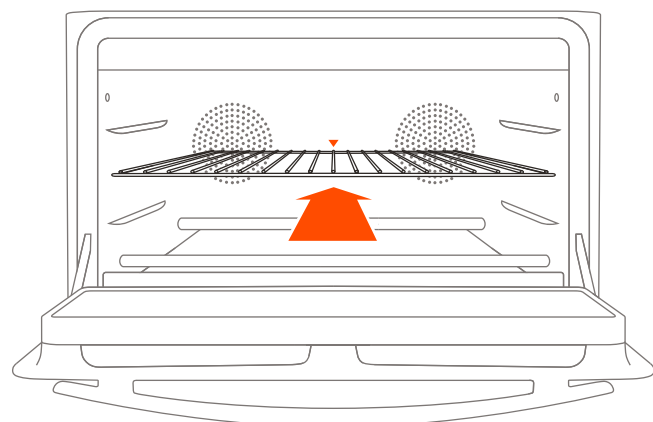

3. Insert wire rack

Insert the wire rack in the middle rack position. The rack's raised cross bars should be on top.

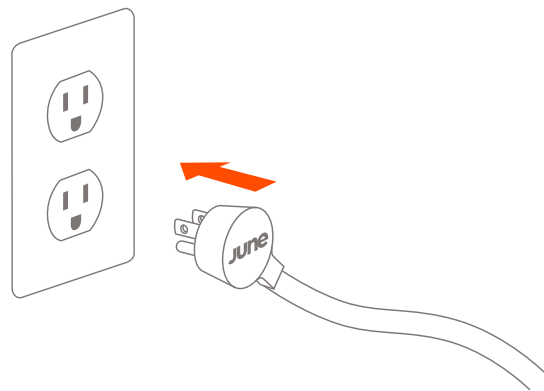

4. Plug in your oven

The touch-screen display will turn on. Make sure your oven is plugged directly into a wall socket—don't use an extension cord or adapter, which could pose risk of fire.

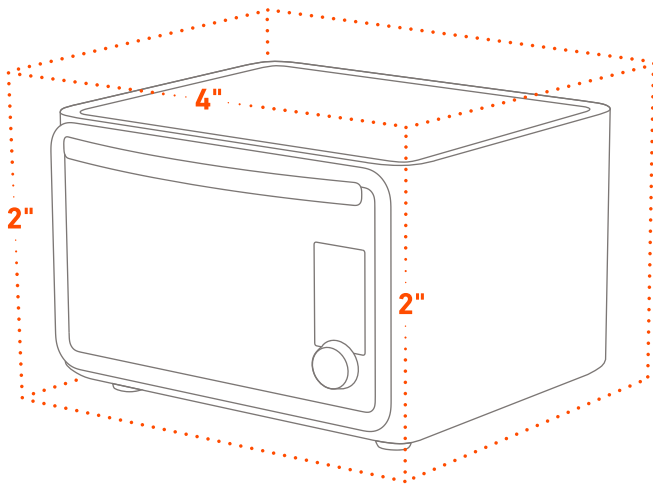

5. Leave space for ventilation

Oven needs 2 inches of space on each side and at least 4 inches above for proper air circulation. A plastic bumper keeps the back from touching any wall. Make sure all perforated vents are clear.



6. Get the app

Use the app to set up your oven and control it from your device. Search 'June oven' in the Apple App Store or go to www.juneoven.com/app.