

Touch Switch

User Guide

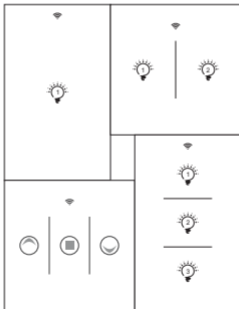



- A WiFi Router with internet and WiFi access has to be ready.

- DHCP setting is enable in your WiFi router.

- Your smart phone or tablet device is iOS or Android system.

- Your smart phone or tablet device must have access to APP STORE, GOOGLE PLAY or QR code scanner.

- Your smart phone or tablet device can connect internet if you need remote access.

1 Parameters

Input	100–240Vac 50/60Hz
Net work	802.11b/g/n
Security	WPA-PSA/WPA2-PSA/WPA/WPA2
Encryption Type	TKIP/AES
Operating Temperature	–20°C to 55°C

2 Wiring Diagram

Warning: please cut off the mains power switch before installation!

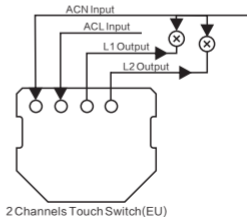
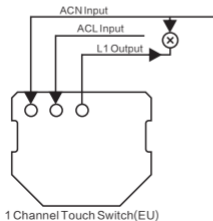

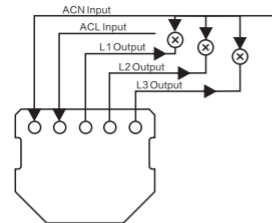

3 Channels Touch Switch(EU)

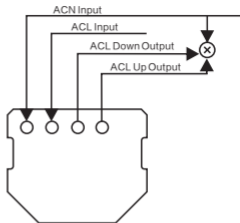

Curtain Touch Switch(EU)

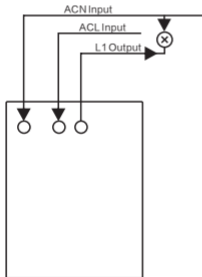

1 Channels Touch Switch(US)

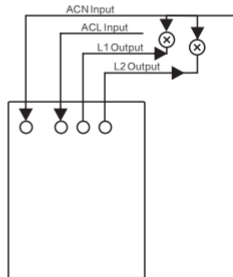

2 Channels Touch Switch(US)

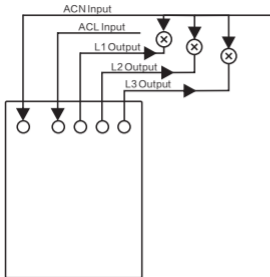

3 Channels Touch Switch(US)

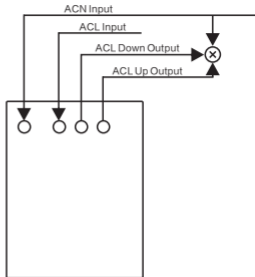

Curtain Touch Switch(US)

3 Installation

- 3.1 Install APP into smart phone or talbet device .
- 3.2 iOS : search and install “iWiFis” from APP STORE or scan the iOS QR code.
- 3.3 Android: search and install “iWiFis” from Android STORE or scan the android QR code.



iOS



Android

4 iWiFis App User Guide

- 4.1 Connect WLAN iWiFisxxxxxx before opening App in Settings menu.

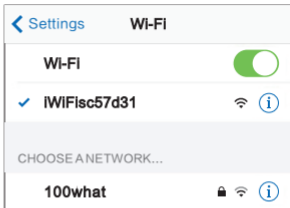

- 4.2 Select the WLAN router SSID and input router password. The iWiFisxxxxxx will disappear after connection done and one new device will be found in app. (IOS:Input WLAN router SSID and password.)

Long press   5 seconds to recover factory settings!

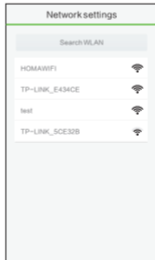

Android

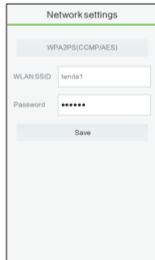



iOS

- 4.3 User can input the name and set the device options in new device menu.
 Enable/Disable finding device option is to set finding the device by mobile phone or tablet in WLAN.
 Enable/Disable remote access option is to set remote security.

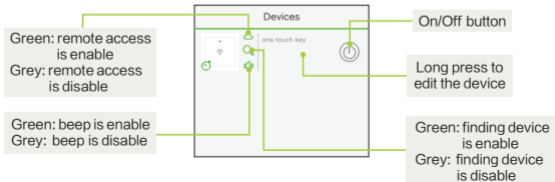

- 4.4 User can control devices in WLAN or control devices remotely via internet.



- 4.5 Click  to open timer menu, then click  to add timer. The function can set touch switch status based on timer setting.

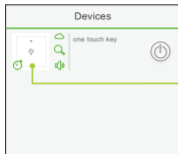

Click the device icon to open timer menu

Green: Timer is enable
Grey: Timer is disable

Add timer



Repeat option

Long press to edit the timer



Enable the repeat option

- 4.6 Click  to add scene. The function can preset the touch switch devices and their status. Then one button can set different status for all devices in this scene.

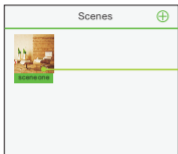

Long press to edit the scene

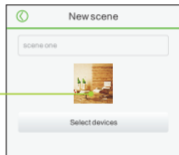

Select the picture

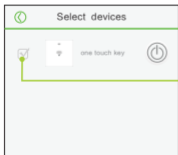

Green: Select the device
in this scene
Grey: Remove the device
in this scene

This device complies with part 15 of the FCC Rules. Operation is subject to the condition that this device does not cause harmful interference (1) this device may not cause harmful interference, and (2) this device must accept any interference received, including interference that may cause undesired operation.

Changes or modifications not expressly approved by the party responsible for compliance could void the user's authority to operate the equipment.

NOTE: This equipment has been tested and found to comply with the limits for a Class B digital device, pursuant to Part 15 of the FCC Rules. These limits are designed to provide reasonable protection against harmful interference in a residential installation. This equipment generates, uses and can radiate radio frequency energy and, if not installed and used in accordance with the instructions, may cause harmful interference to radio communications. However, there is no guarantee that interference will not occur in a particular installation.

If this equipment does cause harmful interference to radio or television reception, which can be determined by turning the equipment off and on, the user is encouraged to try to correct the interference by one or more of the following measures:

- Reorient or relocate the receiving antenna.
- Increase the separation between the equipment and receiver.
- Connect the equipment into an outlet on a circuit different from that to which the receiver is connected.
- Consult the dealer or an experienced radio/TV technician for help.

To maintain compliance with FCC's RF Exposure guidelines, This equipment should be installed and operated with minimum distance between 20cm the radiator your body: Use only the supplied antenna.

FCC ID: 2AJ7E-HTP601-W