

COULAX CX10 BLUETOOTH HEADPHONES

USER Guide

Welcome

Thank you for purchasing
"COULAX CX10 BLUETOOTH HEADPHONES"

Please take the time to follow the instructions
in this owner's guide carefully. It will help you
set up and operate your product properly and
enjoy its advanced features.

Please save this Owner's Guide for
future reference.

www.Coulax.com

2

IN THE BOX



Eartips (S,M,L) X 2

USB Cable x 1

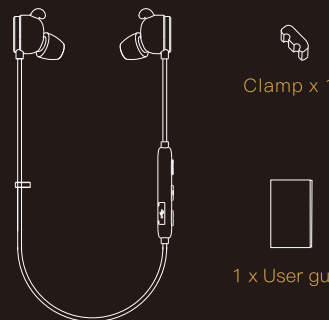

Clamp x 1

1 x User guide

Wireless Sports Headset x 1

3

HEADSET OVERVIEW

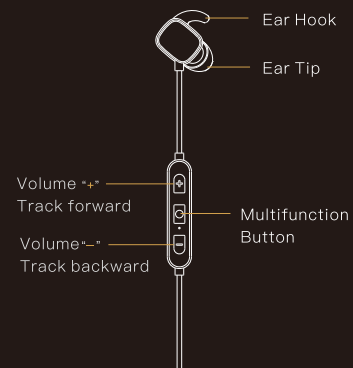

4

CHARGE

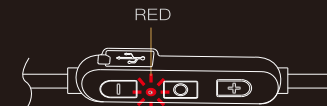

CHARGING

- Your headset has enough power to complete the pairing and a few calls. It takes 3 hours to fully charge the headset. The RED will turn off and the BLUE will turn on after being fully charged.

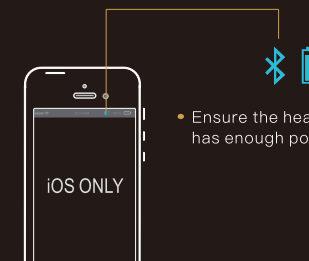

- Ensure the headset has enough power

5

GET PAIRED

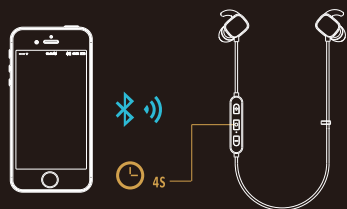

- Press and hold Multi-function Button for 4 seconds, the indicator light flashes RED and BLUE
- Activate Bluetooth on your phone and set it to search for new devices.
- Select "COULAX CX10".[If your phone asks, enter 0000 (four zero to accept the connection)]. The LED indicator will slowly flashes in BLUE.

6

PLAY MUSIC



MUSIC PLAY / PAUSE

- Press MULTI-FUNCTION BUTTON to play / pause music. (Some phones may require you to start a media player first)
- Simultaneously Press Multi-function Button and Volume "-" about 4 seconds to reset the headset



TRACK BACKWARD/FORWARD

- Long Press VOLUME "+" to skip track forward. Long Press VOLUME "-" to skip track backward.

7

TAKE A CALL

ANSWER / END A CALL

- Press the MULTI-FUNCTION BUTTON.

REJECT A CALL

- Press and hold the MULTI-FUNCTION BUTTON for about 2 seconds.

REDIAL THE LAST CALL

- Double-press the MULTI-FUNCTION BUTTON in standby mode. The mobile phone will redial the last call number.

VOLUME CONTROL

Press the VOLUME "+" or "-" to turn volume up or down, you will hear "BEEP" once reach the maximum

MUTE ON/OFF

- Press the VOLUME "+" and VOLUME "-" to mute on/off while calling.

8

SPECIFICATIONS

- Model: COULAX CX10
- Net Weight: 13g
- Bluetooth Version: v4.1
- Bluetooth Range: 10m
- Battery Capacity: 120 mAh
- Talking Time: 9H
- Music Time: 8H
- Charge Time: about 2H
- Working Voltage: 3.3-4.2V
- Charge Voltage: 5V

9

NOTE: This equipment has been tested and found to comply with the limits for a Class B digital device, pursuant to part 15 of the FCC Rules. These limits are designed to provide reasonable protection against harmful interference in a residential installation. This equipment generates uses and can radiate radio frequency energy and, if not installed and used in accordance with the instructions, may cause harmful interference to radio communications. However, there is no guarantee that interference will not occur in a particular installation. If this equipment does cause harmful interference to radio or television reception, which can be determined by turning the equipment off and on, the user is encouraged to try to correct the interference by one or more of the following measures:

- Reorient or relocate the receiving antenna.
- Increase the separation between the equipment and receiver.
- Connect the equipment into an outlet on a circuit different from that to which the receiver is connected.
- Consult the dealer or an experienced radio/TV technician for help

Changes or modifications not expressly approved by the party responsible for compliance could void the user's authority to operate the equipment. This device complies with Part 15 of the FCC Rules. Operation is subject to the following two conditions:

- (1) this device may not cause harmful interference, and
- (2) this device must accept any interference received, including interference that may cause undesired operation.