

Wireless & Stereo Bluetooth Headset for Sports

User Manual Model : SP-7

Chinese Version

Thanks for using wireless & stereo Bluetooth headset for sports, please carefully read the user manual before use.

Product features

The design and development theme of this product is freedom, leisure sports, business leisure and entertainment. Wireless Bluetooth is compatible with SD card for MP3 to play music. The MP3 music play is designed with timing and time alarming functions. The rope design is novel without restraint, and it's convenient to wear, which completely conforms to humanity. Once you put on the headset, you will fully enjoy the music feast and never worry about losing.

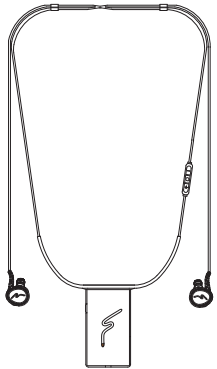

Descriptions of line control

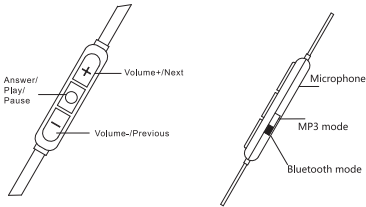

Bluetooth emitter

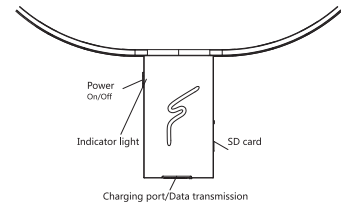

Wearing illustrations

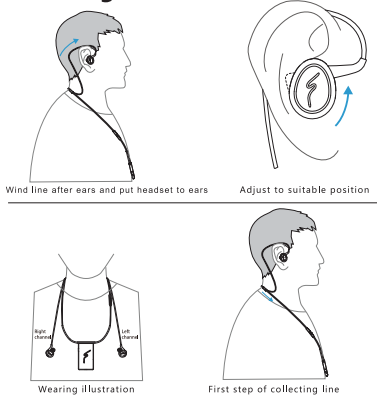

一. Start

● Start for immediate use:

- Supporting mode: Bluetooth mode, MP3 mode
- Under off mode, long press power button and indicator light flickers red/blue light. Press mode button to switch Bluetooth play and MP3 music play.

● Pair new mobile:

- Under off mode, long press power button for 3 seconds and LED indicator light flickers red/blue light. The headset activates search mode.
- Open Bluetooth to search "device name" and click to connect. The blue light flickers after successful connection.

Remark: After starting headset, it must connect with mobile successfully within 2 minutes. In the case of unsuccessful connection within 2 minutes, restart headset.

● MP3 play:

- After opening the power of headset, you can switch Bluetooth play and MP3 play at will.
- After headset successfully connects with Bluetooth, switch to MP3 mode and call reminder will be available.

二. On/Off

- On: Under off mode of Bluetooth headset, long press power key for 3 seconds and indicator light flickers red/blue light.
- Under on mode, long press power key for 3 seconds and indicator light flickers red light.

三. Settings of Bluetooth pairing

After opening the power of headset, the Bluetooth will automatically enter "search" or "scan" function. Use the menu of mobile to "search" new Bluetooth device and it must successfully connect within 2 minutes. In the case of failure within 2 minutes, restart the headset. The menus of different mobiles are different, please set as per below methods:

- iPhone: Settings - Bluetooth - On (starts the search for devices) - start searching device automatically - click "device name" - mobile indicates "connection"
- Android: Settings - Bluetooth: On - Scan for devices - click "device name" - mobile indicates "connection"

*** After successful pairing/connection, the indicator light of headset will stop flicking red/blue light and blue light flickers slowly. Now, you can use the function of voice call.**

***If Bluetooth successfully connects with mobile, when reusing it, open the power of headset and Bluetooth will automatically connect with mobile.**

Support multipoint connection (connect 2 mobiles at the same time)

Two mobiles and one headset, answer the call with one key.

四. Key functions (call and music control)

- Answer call or end call <click power key for 1 time>
- Reject call <long press power key for 2s>
- Redial last call <continuously press power key for 2 times>
- Play or pause music <click power key for 1 time>
- Adjust volume <click "+" , volume increases> <click "-" , volume reduces>
- Switch song <long press "+" for 2s, switch to next song> <long press "-" for 2s, switch to previous song>

Remark: due to different operating systems of different mobiles, the operation method will be also different. This operating instructions refer to iPhone. In the case of different systems, please operate as per your own mobile system.

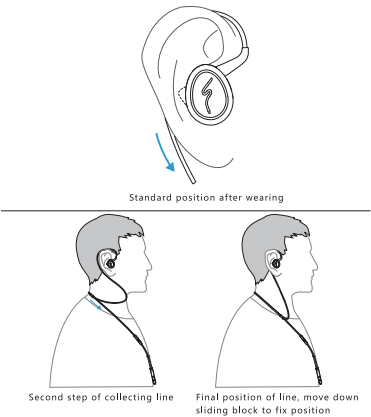

五. Technical indicators

Bluetooth

Bluetooth version: V4.1
Charging way: DC5V, 1A
Holding time: about 8h
Operating frequency: 2.4GHz

Effective range: 10m
Charging time: about 2h
Standby time: about 100h
Weight: about 38g

Headset

Drive unit: double moving coil
<14.2mm×5.8mm>
Impedance: 16ohm
Frequency response: 5Hz-24,000Hz
Microphone: silicone -40dB±3dB

Support call reminder and voice broadcast

In the case of incoming call, there will be voice prompt with headset. When switching the song under state of MP3 play, the headset will automatically identify and broadcast present song (e.g. "the 3rd song"). Timing and time alarming functions are available under state of MP3 play, and it gives one prompt every 15 minutes (e.g. prompt tone of 15 minutes...90 minutes...180 minutes).

Display iPhone power

The power of Bluetooth headset is displayed on iPhone in real time to decide whether charging.

Mini USB charging port (read & write SD card)

- Recharge the headset when the indicator light flickers red and gives alarm. The red indicator light means being charged.
- 2 hours are required at most to be fully charged. Indicator light is blue after full charge.
- Connecting original charging USB cable with computer can read and write data in SD card of headset.
- Do not use the charger exceeding 1AH to charge product.

Remark: SD card is not presented as a gift and the largest memory of SD card is 8GB.
***Please use original certified SD card (suggest buying in JD shop).**

Safety & Maintenance

Please read below suggestions for use to abide by guarantee clauses and prolong product lifespan.

- Keep the product dry and never put in humid place to avoid influencing internal circuit. Do not put the product in place with direct sunlight or high temperature, as high temperature will shorten lifespan of electronic components, damage battery, deform some plastic components.
- Never put the product in too cold place to avoid damaging internal circuit board.
- Never try to take apart product especially for non-professional personnel to avoid damaging internal circuit.
- Never fall, sharply shake or strike the product with hard objects to avoid damaging internal circuit.
- Never clean product with strong chemicals or detergent.
- Never scratch product surface with sharp objects to avoid damaging shell and influencing appearance.
- Never charge product successively for above 10 hours to avoid influencing lifespan.

In the case of abnormal operation, please send the product to our maintenance agencies and our staff will solve your problem wholeheartedly.

Statement: to enhance product performance, we will upgrade product constantly, so the description content may change at any time without prior notice, please understand.

Quality guarantee

A. Product without quality guarantee: accessories such as packing box, storage bag, charging line and earmuff, etc; product beyond period of "three guarantees"; product without authorization or from informal channels; not certified product and gift; product with man-made damage; product being damaged by external force.
B. Authentication of quality guarantee: check period of "three guarantees" (bill or buying record as proof) - check certification (identification code) - check damage condition (if any man-made damage and damage trace by water, fire, chemicals or heavy objects) - check product quality (test if effect conforms to product descriptions under normal use) - check buying channel (be limited to manufacturer).

FAQ

1. Unable to start

- Please charge to check if indicator light is normal (red light should brighten when charging).
- Please charge about 10 minutes or charge until blue light brightens. Long press on button for about 3s and indicator light brightens.

2. Bluetooth fails to connect with mobile

- Ensure enough power of headset to start normally. After starting, the mobile must search Bluetooth headset within 2 minutes. Click searched device name to connect.
- If the mobile can't search Bluetooth headset within 2 minutes, please check if the indicator light of headset flickers red/blue light.
- Restart Bluetooth headset and scan to search.

3. MP3 fails to play

- Please check if the switch on line control points to MP3 position.
- If the switch points to MP3 position, but the headset has no sound, please check if SD card is assembled properly and if SD card is damaged. Please use original certified SD card.
- In the case of slow response of switching song under state of MP3 play, it's caused by rate of SD card, please use original certified SD card.

4. Fail to connect automatically when reusing headset

- Check if the headset connects with another mobile. In the case of pairing for use before, please delete original Bluetooth name and pair again.

This device complies with part 15 of the FCC rules.

Operation is subject to the following two conditions (1) this device may not cause harmful interference, and (2) this device must accept any interference received, including interference that may cause undesired operation.

FCC Warning Statement

Changes or modifications not expressly approved by the party responsible for compliance could void the user's authority to operate the equipment.

This equipment has been tested and found to comply with the limits for a Class B digital device, pursuant to Part 15 of the FCC Rules. These limits are designed to provide reasonable protection against harmful interference in a residential installation. This equipment generates uses and can radiate radio frequency energy and, if not installed and used in accordance with the instructions, may cause harmful interference to radio communications. However, there is no guarantee that interference will not occur in a particular installation. If this equipment does cause harmful interference to radio or television reception, which can be determined by turning the equipment off and on, the user is encouraged to try to correct the interference by one or more of the following measures:

- Reorient or relocate the receiving antenna.
- Increase the separation between the equipment and receiver.
- Connect the equipment into an outlet on a circuit different from that to which the receiver is connected.
- Consult the dealer or an experienced radio/TV technician for help.

This device complies with Part 15 of the FCC rules.

Operation is subject to the following two conditions:

- this device may not cause harmful interference, and
- this device must accept any interference received, including interference that may cause undesired operation.

After-sales service guide

1. Guarantee returns for 7 days

A. Guarantee returns: for the product being purchased from authorized boutique and retail shop, if there is no quality problem caused by man-made damage or external force, the manufacturer promises to return & replace product within 7 days from date of purchase.
B. Process of sales return: the user takes (or send at own expense) product, package and bill to buying shop for detection - the seller detects as per authentication rules of quality guarantee and identify the quality problem - the seller returns buying expenses or replace goods for the user.

2. Guarantee replacement for 15 days

A. Guarantee replacement: for the product being purchased from authorized boutique and retail shop, if there is no quality problem caused by man-made damage or external force, the manufacturer promises to return & replace product within 15 days from date of purchase.
B. Process of replacement: the user takes (or send at own expense) product, package and bill to buying shop for detection - the seller detects as per authentication rules of quality guarantee and identify the quality problem - the seller replaces goods and issue new bill for the user.

3. Guarantee repair for 12 months

A. Guarantee repair: for the product being purchased from authorized boutique and retail shop, if there is no quality problem caused by man-made damage or external force, the manufacturer promises guarantee repair within 12 months from date of purchase.
B. Process of guarantee repair: the user takes (or send at own expense) product, package and bill to buying shop for detection - the seller detects as per authentication rules of quality guarantee and identify the quality problem - the seller fills in quality guarantee card and seals - the seller sends product to manufacturer for repair - the manufacturer sends to seller after repair - the seller inform user of taking the goods.

Warranty card (please fill in carefully)

Product type	Barcode	Shop name
User name	User phone	Date of purchase
User address		Date of repair
		Damage condition