

WIFI Thermometer Hygrometer User Manual

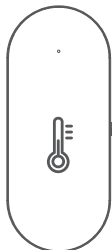

● OVERVIEW

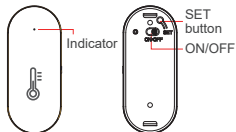

● FUNCTIONS

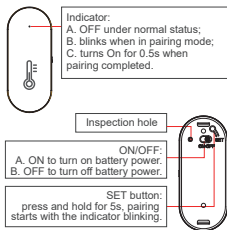

● PAIRING

1. Scan the QR code below, or search 'Smart Life' at APP store or Google Play to download the app.



2. Pairing with smartphone
(1) Connect your smartphone to WiFi (2.4GH) and enable Bluetooth.

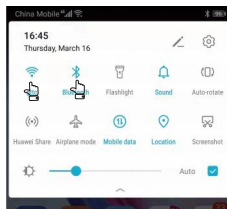

- (2) Switch ON the detector, press and hold SET button until the LED indicator blinks. Detector enters pairing mode.

- press and hold for 5s, Indicator blinks constantly

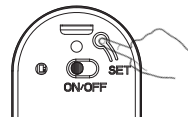

- (3) Open 'Smart Life' app., click 'Add Device' on the upper right corner.

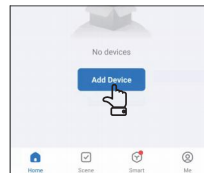

- (4) When the detector is discovered, click 'Add'.

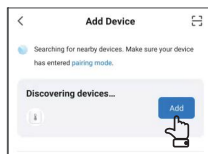

- (5) Enter WiFi password, then click 'Next'.

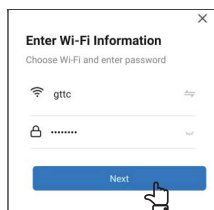

- (6) Detector being added.

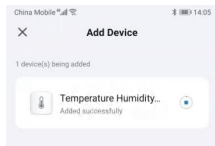

- (7) Click 'Done' to complete.

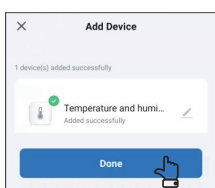

● APP OPERATION

1. Main Interface.



2. Historical alarm
(1) Click on 'Record';
(2) You can view 'Record' and 'Automation record'.

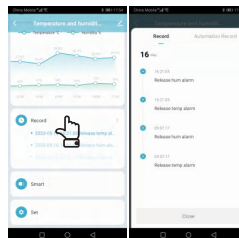

3. Linkage settings

- (1) Click on 'Smart';
- (2) Enter the 'Smart' interface and click the '+' sign;
- (3) Enter the linkage setting interface, set the linkage, and save it.

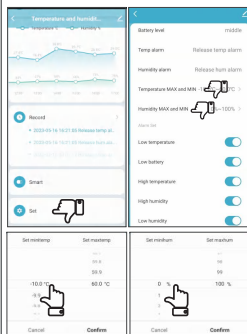
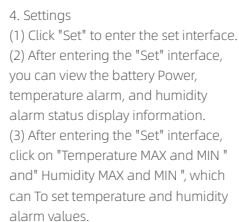

(4) Slide down to check the settings for 'Alarm set', all options turned ON by default. Turn it OFF if you don't want any of the alarm notification pushes.

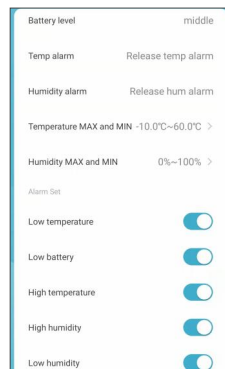

1、 Battery installation.

① pry out the back case on the detector with a screwdriver.



②Load the batteries.

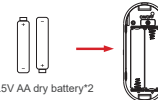

1.5V AA dry battery*:

③ Battery loaded. ④ Close the back cover.

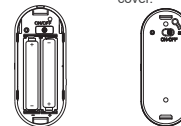

2、 Installation with adhesive tape.

① Peel off one side of the adhesive tape and paste it onto back cover of the detector.

② Peel off the other side of the adhesive tape, and paste the detector onto the installation position.

Attention: Do not apply the foam adhesive backwards to cover the sensor detection port, otherwise the temperature and humidity values detected will be inaccurate.

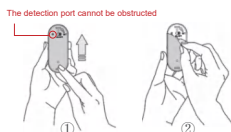

3、Like the following.



- BATTERY REPLACEMENT

①detach the sensor

② pry out the back case with a screwdriver.



③take out the batteries

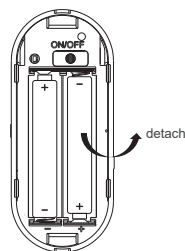

- TECHNICAL SPECIFICATIONS

Input Voltage: DC3V

Static Current: $<100\mu\text{A}$

Alarm Current: <30mA

Low Voltage Threshold: <2.4V

Wi-Fi:802.11/b/g/n

Detection Temperature: -10°C~+60°C

Detection Humidity: 0~100%RH

Working Temperature: -10°C~+60°C

Working Humidity: max.90%RH

Product Dimension: 76*32*20mm

Date: 2023.5.26			
产品型号	PG-1001w	部件名称	WiFi温湿度英文说明书
设计		材 料	70g书写纸（正反印）
品 号			
工 艺		成品尺寸	35*63mm
注：印刷尺寸140*126mm, 成品对折成四等份			

FCC Statement

This device complies with part 15 of the FCC rules. Operation is subject to the following two conditions: (1) this device may not cause harmful interference, and (2) this device must accept any interference received, including interference that may cause undesired operation.

Caution: Changes or modifications not expressly approved by the party responsible for Compliance could void the user's authority to operate the equipment.

NOTE: This equipment has been tested and found to comply with the limits for a Class B digital device, pursuant to part 15 of the FCC Rules. These limits are designed to provide reasonable protection against harmful interference in a residential installation. This equipment generates uses and can radiate radio frequency energy and, if not installed and used in accordance with the instructions, may cause harmful interference to radio communications. However, there is no guarantee that interference will not occur in a particular installation. If this equipment does cause harmful interference to radio or television reception, which can be determined by turning the equipment off and on, the user is encouraged to try to correct the interference by one or more of the following measures:

- Reorient or relocate the receiving antenna.
- Increase the separation between the equipment and receiver.
- Connect the equipment into an outlet on a circuit different from that to which the receiver is connected.
- Consult the dealer or an experienced radio/TV technician for help important announcement .

Radiation Exposure Statement

To comply with FCC RF exposure compliance requirements, this grant is applicable to only mobile configurations. The antennas used for this transmitter must be installed to provide a separation distance of at least 20 cm from all persons and must not be co-located or operating in conjunction with any other antenna or transmitter.