

APP Controller User's Manual

1、 Main function and specification

1.1 Main function

- A 、 Start and stop generator effectively through phone within 40m distance;
- B、 Monitor generator running condition in real time.
- C、 ATS function;
- D、 Auto-choke function;
- E、 Service function: auto-dial service number through APP, or message problem to assigned mailbox;

1.2 Specification

Item	Specification
Voltage	12 VDC
Transmit-receive frequency	2.4GHz
Max current flow	3 A
Model	Dual-mode

2 Operation

2.1 Download the APP program from APP store and install it.



2.2 Run the APP program and enter the control page like this:

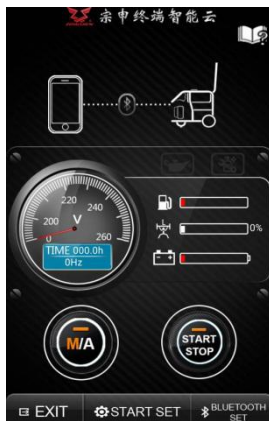

2.3 Connect the power supply of APP controller and keep signal indicator shining. Click BLUETOOTH SET on the right corner of this page to enter blue tooth setup page like this:

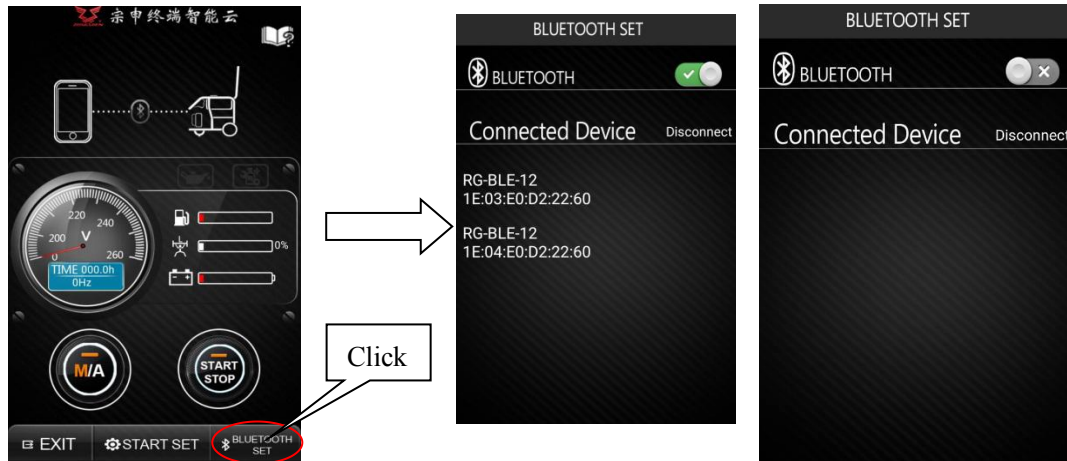

2.4 Slide the option button to change BLUETOOTH status from × to √; for the popup menu, chose ALLOW; Then chose the corresponding device, insert password and click SURE, it will match each other automatically like this:

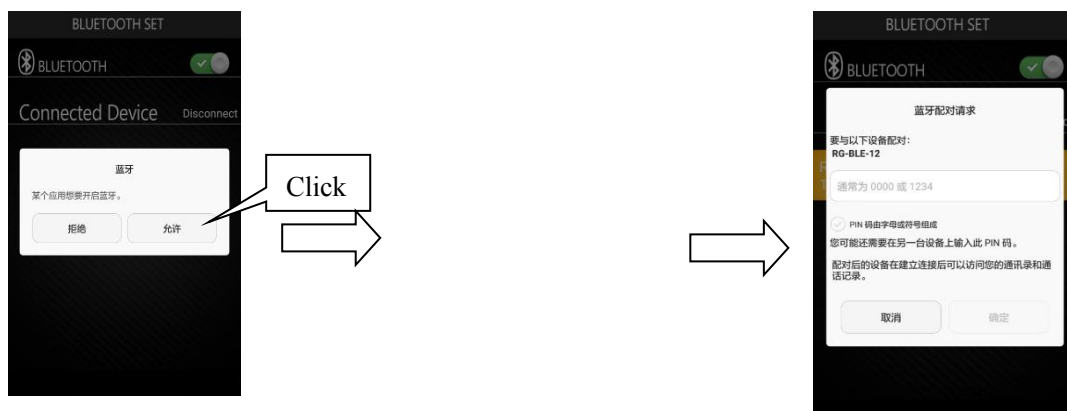

2.5 Click BACKUP bottom to back APP control page like this after matching successfully:

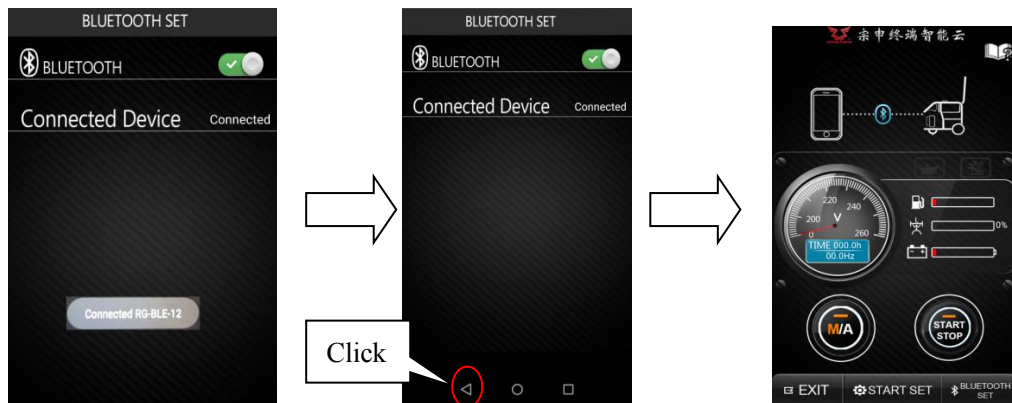

2.6 Start process:

a) Click the start bottom;



b) When for the popup menu (start?), click ON to start the generator like this;



c) Generator Bluetooth model will send real time running information to your phone after starting successfully;

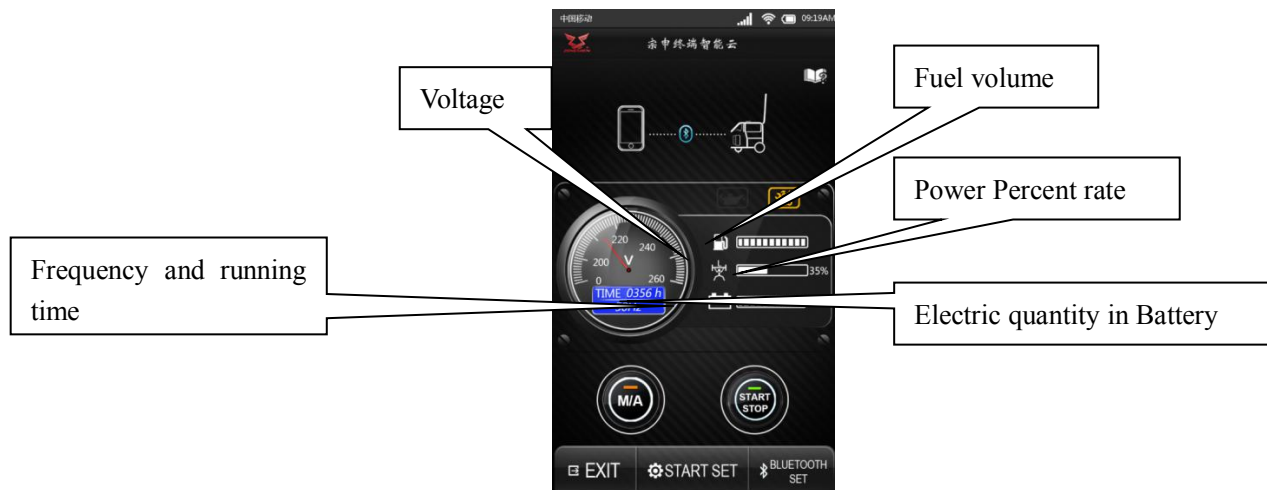

2.7 Stop process:

a) Click the stop bottom



b) When for the popup menu (stop?), chose YES

c) Generator will be stop.

2.8 Model Switching Process:

Click M/A to interchange between manual control and auto control;



3、 Notice

3.1 Please make sure the voltage of battery is over 12V and the battery switch in the ON position;

3.2 The indicator shining means controller is in regular work condition.;

3.3 This device complies with part 15 of the FCC Rules. Operation is subject to the following two conditions: (1) This device may not cause harmful interference, and (2) this device must accept any interference received, including interference that may cause undesired operation.

Changes or modifications not expressly approved by the party responsible for compliance could void the user's authority to operate the equipment.

This equipment has been tested and found to comply with the limits for a Class B digital device, pursuant to part 15 of the FCC Rules. These limits are designed to provide reasonable protection against harmful interference in a residential installation. This equipment generates uses and can radiate radio frequency energy and, if not installed and used in accordance with the instructions, may cause harmful interference to radio communications. However, there is no guarantee that interference will not occur in a particular installation. If this equipment does cause harmful interference to radio or television reception, which can be determined by turning the equipment off and on, the user is encouraged to try to correct the interference by one or more of the following measures:

- Reorient or relocate the receiving antenna.
- Increase the separation between the equipment and receiver.
- Connect the equipment into an outlet on a circuit different from that to which the receiver is connected.
- Consult the dealer or an experienced radio/TV technician for help.