

X-CAM VISION

X-Cam Smart Selfie Stick with Shutter Control and
Face Detection and Tracking
Instruction

自动追踪智能自拍杆
使用说明书

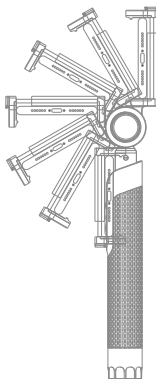

Material :ABS, Aluminum

Dimension 227*55*40mm

Weight: 200g

Battery Capacity:3.7V900mAh lithium battery

Max. Length: 450mm

材质：ABS, 铝合金

规格：227*55*40mm

重量：200g

容量：3.7V900mAh锂电池

拉伸长度：450mm

Download and install “X-CAM VISION”

Please download and install the “X-CAM VISION” App from the Apple App Store or Google Play



X-CAM APP requires iOS 8.0 or later versions and Android 5.0 or later versions.

Please review our detailed written user instruction, instructional videos and all relevant information regarding our product before using X-CAM T3.

Please go to www.ruipai-tech.com to download the X-CAM T3 User Manual.



The manual's content is subject to change without prior notifications.

Lights and Buttons

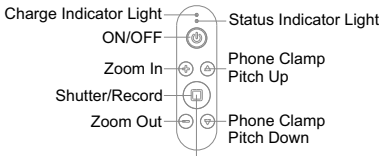

Long Press: Enable/Disable the Face Detection and Tracking Function

Toggle Between the Front and Rear Facing Cameras

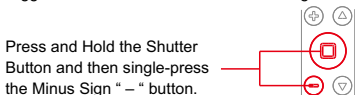

Toggle Between Photography and Videography Modes with a single button.

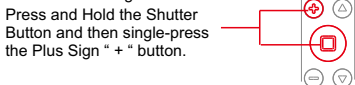

- Photo & Video Modes: Single Press: Shutter / Record
Double Press: 5-Shot Burst
- Toggle the Face Detection and Tracking Mode:
Long Press the Shutter Button for 4 Seconds.
- Toggle between Photo and Video Modes: Press and Hold the Shutter Button and then single-press the Plus Sign “ + ” button.
- Toggle Between the Front and Rear Facing Cameras:
Press and Hold the Shutter Button and then single-press the Minus Sign “ – ” button.
- Charge Indicator Light:
Green Light ON: Charging
Green Light OFF: Charging Complete.
- Status Indicator Light:
Solid Blue Light: X-Cam is successfully connected.
Slow Flashing Blue Light: Your X-Cam is not connected, and is in Pairing Mode.
Quick Flashing Blue Light: Your X-Cam is low on power, needs to be charged.

Installation Instructions

Warning:

Please **ONLY** Extend and Fold the Cell Phone Clamp with the Pitch Up / Down buttons. Please **DO NOT** force the Cell Phone Clamp while your X-CAM T3 is powered off, as internal hardware damages may occur.

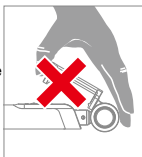

Adjust the Telescopic rod to desired length

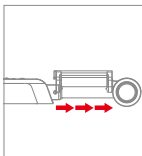

Press the T3's Power On Button

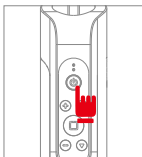

Use the Pitch Up / Down buttons to adjust the Cell Phone Clamp to your desired angle.

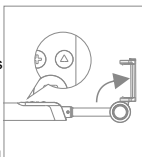

Open the Cell Phone Clamp and place your Phone securely onto the Clamp. Please make sure your phone is oriented correctly (the top of your phone should be facing left), otherwise the Face Detection and Tracking feature will not function correctly and adjust your phone camera to the reverse direction.

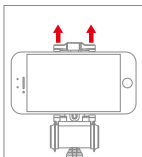

Our Recommended Bluetooth Pairing Procedure:

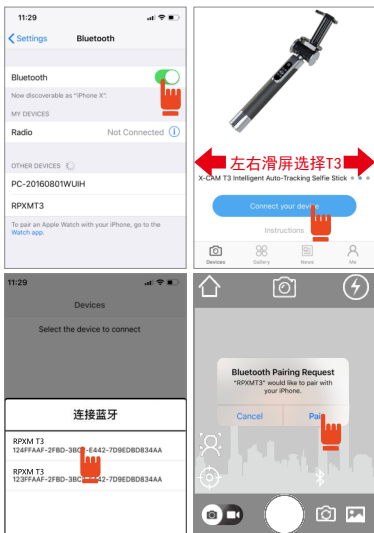

- 1) **TURN ON:** Go to your device's "Bluetooth Settings" and turn ON your device's Bluetooth.
- 2) **CONNECT:** Turn on the X-CAM VISION App, and select "T3" and connect to this device.
- 3) **SELECT:** If there is only one device nearby, your phone will connect to it automatically. If there are multiple devices nearby, you will need to find your device from a list of nearby devices. Please see the illustration.
- 4) **PAIRING:** Select your device and pair. If you see a solid blue light on your X-CAM, the device is successfully connected to your phone.

Default Bluetooth Connections only enable basic X-CAM functions.

In-APP Bluetooth Connections enables more functions on your X-CAM device. Please download our APP.

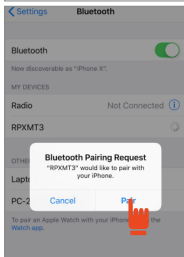
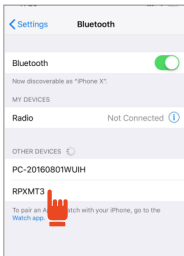
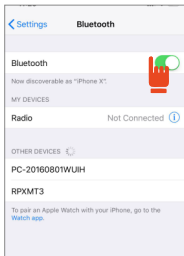

- 1) **TURN ON:** Go to your device's "Bluetooth Settings" and turn ON your device's Bluetooth.
- 2) **CONNECT:** Select T3 in your phone's Bluetooth Settings to connect.
- 3) **PAIRING:** Select your device and pair. If you see a solid blue light on your X-CAM, the device is successfully connected to your phone.
- 4) **START:** Turn on your phone camera. X-CAM will not interfere with any 3rd party photo filtering apps in this mode.

APP Icons

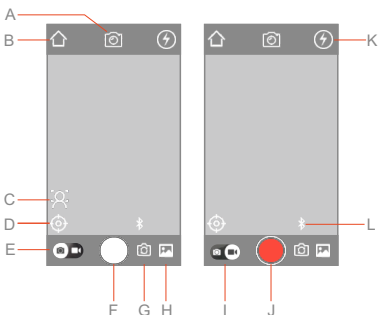

Photo Interface

Video Interface

- A: Size: Select Picture Size
- B: Return: Return to Main Menu
- C: Face Snap-Shot: Character-centered Snap-Shot after 3 seconds of screen-freeze time.
- D: Tracking: toggle the tracking function ON/OFF
- E: Photo Capture: Right Swipe to switch to Video Mode
- F: Camera Shutter
- G: Front/Rear Camera Switch
- H: Media: view and share your photos and videos.
- I: Video Recording: Right Swipe to switch to Photo Mode
- J: Video Record Shutter
- K: Flash ON/OFF
- L: Bluetooth Status: Connected/Not Connected

Intelligent Facial Recognition and Tracking



Please securely attach your phone to your X-CAM, and turn on the X-CAM VISION App. Switch to Videography Mode, and press the on-screen logo shaded in RED (see illustration). The function is **TURN ON** when the logo becomes BLUE; the function is **CANCELLED** when the logo becomes WHITE. With the function turn ON, your X-CAM will recognize and track the subject of your recording automatically.

Intelligent Facial Recognition Snap Shot



Under Videography Mode: press the on-screen logo shaded in RED (see illustration). The function is **TURN ON** when the logo becomes BLUE; the function is **CANCELLED** when the logo becomes WHITE. With the function turn ON, if the photo frame/scene does not shift within 5 seconds, your camera will take a **SNAP SHOT** after a further 3 seconds. If the photo frame/scene is shifted within these 3 seconds, the **SNAP SHOT** will be cancelled.

Please DO NOT force it open.

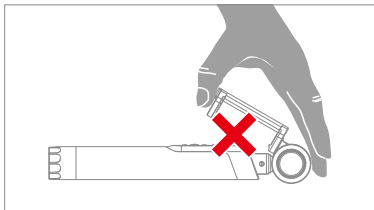

Please ONLY Extend and Fold the Cell Phone Clamp with the Pitch Up / Down buttons. Please DO NOT force the Cell Phone Clamp while your X-CAM T3 is powered off, as internal hardware damages may occur.

Please make sure your phone is oriented correctly.

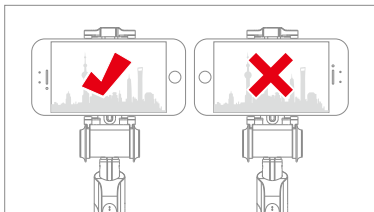

Please make sure your phone is oriented correctly (the top of your phone should be facing left), otherwise the Face Detection and Tracking feature will not function correctly and adjust your phone camera to the reverse direction. (See illustration)

WARNING

Name of the manufacturer or trademark: X-CAM
CREATIVE SIGHT

Model number: X-CAM T3

Rating: Input: 5V 500mA

Series number: FCC ID : 2AIQX-1806

This device complies with part 15 of the FCC
Rules. Operation is subject to

the following two conditions: (1) This device may not
cause harmful interference, and (2) this device must
accept any interference received, including

interference that may cause undesired operation

This equipment has been tested and found to
comply with the limits for a Class B digital device,
pursuant to part 15 of the FCC Rules. These limits
are designed to provide reasonable protection
against harmful interference in a residential
installation. This equipment generates, uses and
can radiate radio frequency energy and, if not
installed and used in accordance with the
instructions, may cause harmful interference to
radio communications. However, there is no
guarantee that interference will not occur in a
particular installation. If this equipment does cause
harmful interference to radio or television reception,
which can be determined by turning the equipment
off and on, the user is encouraged to try to correct
the interference by one or more of the following
measures: —Reorient or relocate the receiving
antenna. —Increase the separation between the
equipment and receiver. —Connect the equipment
into an outlet on a circuit different from that to which
the receiver is connected. —Consult the dealer
or an experienced radio/TV technician for help.

SAFETY INSTRUCTIONS

- 1、 Please keep your X-CAM away from
combustible material and heat sources when it's
being charged. Please leave your device
uncovered, and only charge your device in a
ventilated and fire-proof environment.
- 2、 Please do not charge your X-CAM unattended.
- 3、 Please keep your X-CAM away from water, oil,
or any corrosive liquids and gases, as they may
cause permanent damages to your device's
circuit boards, or short and combust the device's

lithium battery.

- 4、 Please periodically charge your X-CAM when it's only used infrequently.
- 5、 Please TURN OFF your X-CAM device right away if there is any burning smell, deformation, or other unusual signs of malfunction when you are using or charging the device, in order to prevent the battery from combusting.

(Please only dispose of your electronic devices in full compliance with your local laws).

The European Union Guide for Electronic Product Disposal

Your X-CAM device cannot be combined and disposed with household wastes. You are responsible for the bringing your device to the designated Electronic Waste Recycling facilities in accordance with your local laws. Please contact your local Administration or relevant agencies for additional information on how to dispose of your household electronic products. The proper disposal and recycling of electronic products are crucial for the maintenance of our environment.

DISCLAIMER

The USER of this device fully acknowledges the potential fire hazard and the associated bodily and property damage WHEN the device is IMPROPERLY charged.

WARNING

X-CAM, and its associated suppliers, distributors and retailers are NOT, legally or civilly, responsible for any damages CAUSED BY non-quality related MIS-USE of the X-CAM device. Please read the user manual, and specifically the Charging Instruction thoroughly. If you are unsure how to charge your X-CAM device, please contact your local retailer for instructions. Any changes or modifications to this unit not expressly approved by the party responsible for compliance could void the user's authority to operate the equipment. Any changes or modifications to this unit not expressly approved by the party responsible for compliance could void the user's authority to opera

CE **RoHS** **FC**



X-CAM VISION

自动追踪智能自拍杆

使用说明书

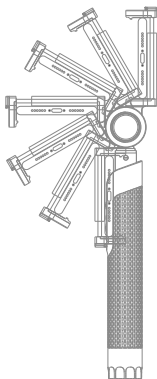

名称：X-CAM T3智能追踪自拍杆

材质：ABS, 铝合金

规格：227*55*40mm

重量：200g

容量：3.7V900mAh锂电池

拉伸长度：450mm

下载安装X-CAM VISION

使用本产品过程中，需要下载安装X-CAM VISION
请用手机软件商店搜索“X-CAM VISION”
并安装或使用手机扫描下方二维码安装



锐拍APP要求使用 iOS 8.0 及
以上系统或Android5.0以上系统

了解本产品全部信息、详细使用说明及使用视频，
请下载：X-CAM T3 用户手册

www.ruipai-tech.com



内容如有更新，恕不另行通知。

按键指示灯说明

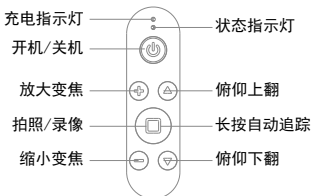

前后摄像头切换

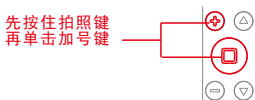

录像/摄像一键切换

拍照/录像：单机拍照/录像

双击：拍照连拍5张

启动自动追踪：长按住拍照/录像键4秒后松开

录像/拍照切换：先按住拍照/录像键，同时单击放大变焦键，可切换录像和拍照模式

前后摄像切换：长按住拍照/录像键，同时单击缩小变焦键，可切换前后摄像头。

充电指示灯：绿灯常亮充电状态

绿灯灭表示充电完成

状态指示灯：蓝灯开机慢闪，蓝牙未连接

蓝灯常亮，蓝牙已连接

蓝灯快闪，电量低，需及时充电

安装指示

注意：

打开手机夹时使用俯仰控制按键调整打开和收纳，切勿在关机状态用强行打开，内置电机，使用不当，会造成电机扫齿损坏。

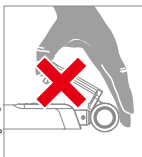

拉开伸缩杆到合适的长度。

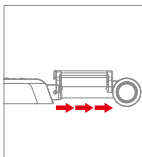

开启T3电动自拍杆开机键盘。

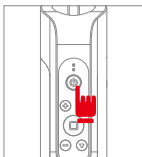

使用俯仰按键将折叠手机夹头打开，打开到合适的角度。

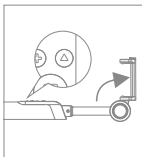

拉开手机夹支架拉手，将手机安全固定在手机支架上。手机不能装反，如果装反会导致自动追踪人脸方向变反的。

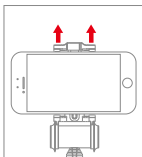

APP连接蓝牙（推举）



- 1) 开启：点击手机设置中蓝牙设置，选择“开启”。
- 3) 连接：打开APP，选择T3设备并点击连接设备，
- 2) 选择：附近有一台设备则自动连接。如果附近有多台设备则弹出连接蓝牙供用户选择，如图。
- 4) 配对：选择配对。设备蓝灯常亮，表示配对成功。

系统连接蓝牙（仅基本功能）

系统连接（仅启动基本功能，更多体验请下载APP）

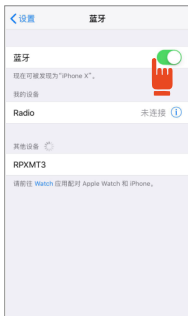

- 1) 开启：点击手机设置中蓝牙设置，选择“开启”。
- 2) 连接：选择T3设备。
- 3) 配对：选择配对。设备蓝灯常亮，表示配对成功。
- 4) 启动：启动相机，支持第三方美颜APP拍摄。

APP图标指示

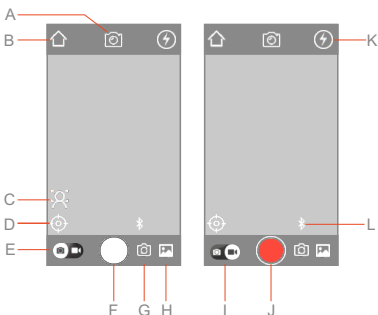

拍照界面

录影界面

- A: 规格: 选择图像尺寸
- B: 返回: 点击后返回主页
- C: 人脸抓拍: 屏幕静止3秒后抓拍角色
- D: 目标跟踪: 点击启动/关闭跟踪功能
- E: 拍照: 右滑切换到录影模式
- F: 拍照快门: 点击拍照
- G: 前后摄像头设置: 切换手机前/后摄像头
- H: 多媒体: 查看拍摄素材, 一键分享各种社交软件
- I: 录影: 右滑切换到拍照模式
- J: 录影快门: 点击开始/结束录影
- K: 闪光灯开关: 开启/关闭闪光灯
- L: 蓝牙状态: 蓝牙连接状态指示

人脸智能识别追踪

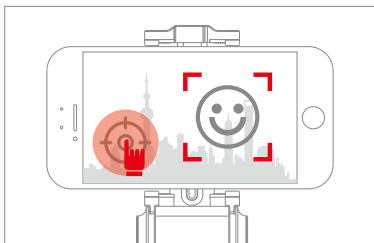

手机平稳安装后，登陆X-CAM T3 APP后，切换录影模式下，轻触手机红色标记图标(如图)，图标变蓝，功能开启；图标变白，取消操作。然后手机屏幕自动识别跟拍人物，俯仰轴达到自动跟随的效果。

人脸智能识别抓拍

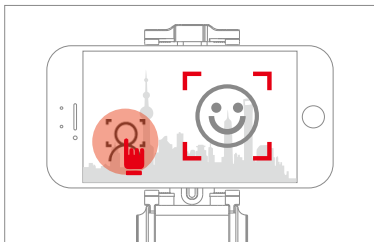

录影模式下，轻触标记图标(如图)，图标变蓝，开启此功能。图标变白，取消此功能。启动此功能后如果画面5秒内不移动，会自动启动3秒倒计时拍摄，如果在3秒内又移动，则取消。

切勿强行掰开

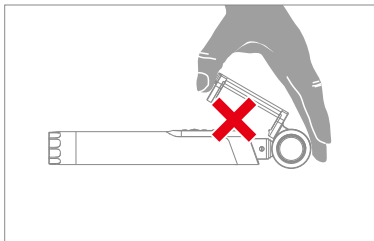

打开手机夹时使用俯仰控制按键调整打开和收纳，切勿在关机状态用强行打开，内置电机，使用不当，会造成电机扫齿损坏。

切勿手机装反

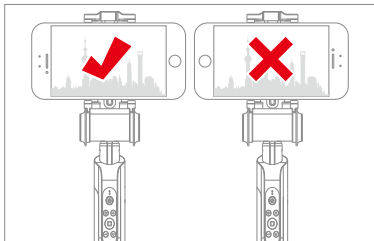

手机安装时请注意不能装反，如果装反会导致自动追踪人脸方向变反。如图所示

注意：

制造商或商标名称：X-CAM CREATIVE SIGHT
型号：X-CAM T3
参数：5V 500mA
系列号：FCC ID：2AIQX-1806

本设备符合FCC规则的第15部分。操作受制于以下两个条件：（1）此设备可能不会造成有害干扰，以及（2）此设备必须接受任何干扰，包括可能导致意外操作的干扰。

本设备已经过测试，符合FCC规则第15部分对B类数字设备的限制。这些限制旨在提供合理的保护，以防止住宅安装中的有害干扰。本设备会产生，使用并辐射射频能量，如果不按照说明进行安装和使用，可能会对无线电通信造成有害干扰。但是，不能保证在特定的安装中不会发生干扰。如果此设备确实对无线电或电视接收造成有害干扰（可通过关闭和打开设备来确定），建议用户尝试通过以下一种或多种措施纠正干扰：调整或重新定位接收天线。增加设备和接收器之间的距离。将设备连接到与接收器连接的电路不同的电路插座上。咨询经销商或有经验的无线电/电视技术人员寻求帮助。

具体安全指引：

- 1、充电时请保证电池远离易燃物和热源，禁止覆盖充电器和本产品，保持充电时候的通风并确保充电在 安全防火的环境下进行。
- 2、禁止在无人看管的情况下进行充电。
- 3、本产品严禁接触水、油及腐蚀性液体、气体，以防止插接件短路而损坏电子系统或引起电池燃烧。
- 4、当长时间不使用本产品时，建议定期进行充电。
- 5、若本产品在使用时或充电发现异味、变形或者出现其他任何异常现象时应立刻关闭电源停止充电或使用！（出现不良现象的本产品严禁乱扔乱，需采取安全措施处理。）以免引起本产品中的电池燃烧。

欧盟关于电子电器废弃物的处理指导

此产品不能与其他废物一起处理，使用者有义务将废弃设备拿到指定的电子设备回收站处理，废弃设备的分类收集和及时回收将有利于保护自然资源和人类的健康及自然环境。要取得更多废弃设备回收站的信息，请联系当地的的城市办公室、家庭废物处理中心或者是您购买产品的店铺。

免责声明

在误操作下，给本产品充电可能会引起火灾，人身伤害以及财产的损失。使用者必须意识到使用此类产品所存在的风险。

警告

“上海锐拍智能科技有限公司”的生产商、批发商和零售商不为用户在使用过程中所发生的非产品质量引起任何事故承担法律责任，在使用该产品前请认真阅读指导说明、充电说明等信息。若您不确定如何充电时，请向当地的零售商咨询。

未经本机构明确批准，对本机的任何更改或修改负责合规的一方可能会使用户无权操作设备。

CE RoHS FCC

