

Get started!

Let's discover the first steps on using Equisense MotionS



Need help? Go to <https://help.equisense.com/l/en>

Notice d'utilisation / Instructions / Bedienungsanleitung / Instrucción de uso / instruções / Instrucion de usa / gebruikershandleiding / ملاحظات المستخدم / руководство пользователя: go to [equisense.com/help](https://help.equisense.com/help)
FCC ID 2A1QJ-EQSMS01
Rev 1.0

1. Download the app

Go to [Equisense.com/start](https://equisense.com/start) on your Android or iOS smartphone.



2. Wake up your sensor

To turn off the sleeping mode, connect your sensor to a laptop with the supplied USB cable or plug it with the charger into a socket.

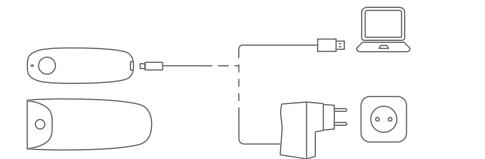

Use the charger with the appropriate adapter according to your country.

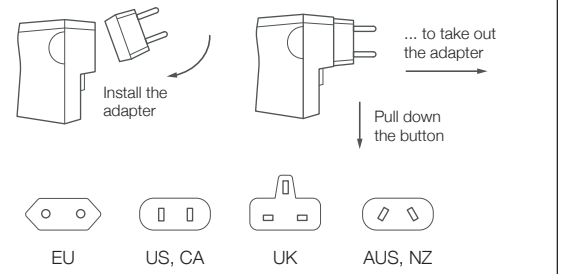

Your tracker can run for at least 10 hours. Don't forget to charge it sometimes !

3. Create your account

Follow the step-by-step instructions provided in the app for creating both your profile and your horse profile. Then, connect your sensor.

4. Now you are ready!

Put your sensor in the attachment* and place the electrode* on your horse skin. (tips : have a look to the instructions provided with the attachment).

Your sensor is now autonomous. It switches on when detecting a movement.

*not included in this pack

5. Sync your data

While you are riding, the sensor records up to 10 hours of training.

Synchronisation is done automaticaly as soon as you connect your smartphone to your sensor.

Note: if your phone is connected to your sensor while riding, data will be synced continuously...

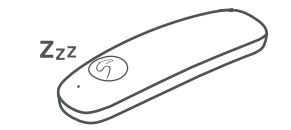

Your sensor talks to you...

Light color:

BLUE: Your sensor is connected to your smartphone (via Bluetooth)
RED: It is running out of battery!
ORANGE: Your sensor is charging
GREEN: It is now charged and ready to be used.

Blink:

SLOW BLINKS: It is recording
FAST BLINKS: Your sensor is synchronizing data.

Caution

Motion is splashproof (do not submerge it in a water bucket).

To not expose you sensor to extreme temperatures: not less than -5°C and no more than +40°C.

Please do not hit or damage you sensor.

The sensor contains a lithium Polymer battery. 3.7V, 320mAh, 1.11Wh UN 3481.
Communication is wireless (Bluetooth Low Energy BLE4.0+, 2.4Ghz.)
Do not use the sensor if it's broken and/or the battery is opened.

*This device complies with part 15 of the FCC Rules. Operation is subject to the following two conditions: (1) This device may not cause harmful interference, and (2) this device must accept any interference received, including interference that may cause undesired operation.
Changes or modifications not expressly approved by the party responsible for compliance could void the user's authority to operate the equipment.*

For more information about the sensor, safety instructions and updates, please visit our website <https://help.equisense.com/l/en>

The last word



In November 2015, our first product was funded by demanding and passionate riders that thought that digital could help to improve the horse's health and the performance of the horse and the rider. Today, we provide you the best product to help you monitor your horse' heart-rate, and much more.

Thanks to your feedback, we will keep on improving our product so that it fits your needs.

Join the adventure and send us your remarks, needs and ideas !

feedbacks@equisense.fr