



# Wi-Fi LED Lighting Controller

Model: ALWIFI14

## INSTALLATION GUIDE

Download the full feature guide at [www.armacostlighting.com/wifi](http://www.armacostlighting.com/wifi)

Compatible with Android and Apple (iOS) smartphones and tablets

Works with five different types of LED lighting (both 12 and 24 volt):

1. White and single color LED lighting – provides 0-100% full range dimming
2. White color adjustable LED tape Lighting – dimming and CCT control
3. Standard RGB LED lighting – full function color control and effects
4. RGB + White 4 channel LED enhanced color control and effects
5. RGB + CCT dual white 5 channel enhanced color control and effects

## Features

- Works with or without a wireless network, use your phone as a simple remote or utilize any existing wireless network for advanced control features.
- Connect and control up to 50 Wi-Fi controllers with one device. Control individually or in groups for large area, multi-zoned lighting control (Requires router and network connection)
- Control your lighting remotely from anywhere in the world when configured through your network
- Sync lighting to the beat of music stored locally on your device, or use your microphone to sync to ambient music.
- Programmable, set the time of day to turn your lighting on or off
- When used with RGB LED lighting, use the color wheel touch screen to create virtually any color. Create your own color changing effects or choose from 20 preprogrammed modes. Bookmark and save favorite colors and effects. Match colors in your environment using your device's camera, or manually enter RGB values for precise color selections.

**IMPORTANT** – Always first read and follow the Installation Guidelines provided with your LED lighting and power supply. If you are unclear as to how to install and wire this product, contact a qualified professional. Low voltage safe, the Wi-Fi Controller is direct wired inline anywhere between the low voltage output of your power supply and your LED lighting. Each Wi-Fi Color controller requires a separate LED power supply. Never connect multiple Wi-Fi Controllers to one power supply.

## Easy to wire, easy to connect

Direct wire connect your lighting and power supply based on the type of lighting you are using.

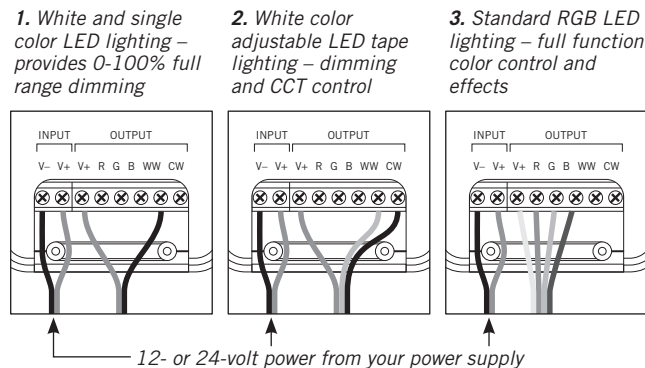

Note: For 4 and 5 channel RGB connection illustrations, consult the full instruction manual



## Download and connect the free Armacost Lighting app

Go to Apple iTunes Store or Google Play for Android devices. Search for Armacost Wi-Fi MyLED, download and install the app.

Make sure the controller is correctly installed and powered on before attempting to use the app to connect your device

1. Go to Settings on your mobile device.
2. Enable Wi-Fi and open the Wi-Fi networks list on your device
3. By default, the Armacost Wi-Fi LED Lighting controller will appear with the network name (SSID) of "ArmacostXXXXXXXXXX." The X's represent a combination of letters and numbers unique to each Wi-Fi controller
4. Connect your device to the Wi-Fi controller. No password is required.
5. Open the Armacost Lighting app. The application will automatically scan for the Armacost Wi-Fi Controller.
6. You will then see a screen where you can connect to your network's wireless router or direct connect to the W-Fi controller. Note: you can access this function at any time through the setup menu.

### Direct connection vs. wireless router setting

If you do not have, or do not want to connect through a wireless router, choose direct connect to the controller. With this method, you will have no access to the internet while connected to your controller, and cannot group controllers for multi-zone control. Direct-connection is a quick and easy way to test your lighting, but a wireless router connection to your home network is recommended to enable full app features.

By going through the router setup, you will link your Wi-Fi controller through your existing wireless network. This will allow you to access the web and your color controller, without switching between Wi-Fi networks. Additionally, you will have access to the remote access settings, and any Wi-Fi controller connected to the same network can be grouped together for synchronized control across multiple zones.

The first time connecting to your Wi-Fi LED controller, you will be prompted to select the type of lighting connected to the Wi-Fi controller. Simply choose the mode that applies to the type of lighting you are using. For example, if you are using single color or white LED lighting, select "DIM," your app will then be configured as an LED dimmer.

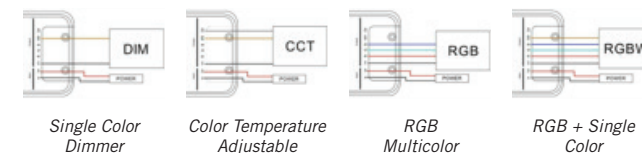

Next, you will be brought to a screen that will list all the Wi-Fi controllers connected on this network. Here you can access settings, controller properties, and turn your lighting on/off. Tap the controller name to begin using your lighting, or press and hold to change basic device properties.

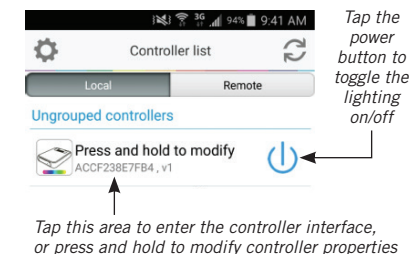

## Troubleshooting

If your device displays this error message, press the refresh button in the upper-right corner.

Cannot find any LED controller(s). Please check your device WiFi settings and confirm that the LED controller(s) are plugged in

If your controller still does not appear, turn your Wi-Fi connection off and back on and check your network settings.

### Factory Reset

If you've password protected your Wi-Fi controller and lost the credentials, or have entered the wrong password when attempting to connect to a wireless network, you will be unable to access the controller until a factory reset has been performed.

1. Locate the pinhole reset on the front of the unit, labelled RST.
2. Using the included pin, or a straightened paper clip, insert straight into the reset pinhole and press until the reset button clicks.
3. Continue to press and hold the reset for 5 seconds, then release. The unit will power off and back on, then cycle through colors to indicate the the reset has been successful.

You can now connect back to your Wi-Fi controller using its default settings. Return to step 1 under "Download and connect the free Armacost Lighting App."

For detailed app instructions and how-to videos, visit [armacostlighting.com/wifi](http://armacostlighting.com/wifi)

[armacostlighting.com](http://armacostlighting.com)

© 2016 Armacost Lighting. All rights reserved.

## FCC Caution.

### § 15.19 Labelling requirements.

This device complies with part 15 of the FCC Rules. Operation is subject to the following two conditions: (1) This device may not cause harmful interference, and (2) this device must accept any interference received, including interference that may cause undesired operation.

### § 15.21 Changes or modification warning

Any Changes or modifications not expressly approved by the party responsible for compliance could void the user's authority to operate the equipment.

### § 15.105 Information to the user.

Note: This equipment has been tested and found to comply with the limits for a Class B digital device, pursuant to part 15 of the FCC Rules. These limits are designed to provide reasonable protection against harmful interference in a residential installation. This equipment generates uses and can radiate radio frequency energy and, if not installed and used in accordance with the instructions, may cause harmful interference to radio communications. However, there is no guarantee that interference will not occur in a particular installation. If this equipment does cause harmful interference to radio or television reception, which can be determined by turning the equipment off and on, the user is encouraged to try to correct the interference by one or more of the following measures:

- Reorient or relocate the receiving antenna.
- Increase the separation between the equipment and receiver.
- Connect the equipment into an outlet on a circuit different from that to which the receiver is connected.
- Consult the dealer or an experienced radio/TV technician for help.

### \*RF warning:

This equipment complies with FCC radiation exposure limits set forth for an uncontrolled environment. This equipment should be installed and operated with minimum distance 20cm between the radiator & your body.