



1201800
User's Guide

RadioShack®



RadioShack Bluetooth® Music Transmitter

We hope you enjoy your RadioShack Bluetooth® Music Transmitter. This transmitter adds Bluetooth wireless technology to your device allowing for wireless streaming to your speakers/headphones. Please read this user's guide before using your transmitter.

Package Contents

- RadioShack Bluetooth® Music Transmitter
- AC Adapter
- 6ft (1.82m) 1/8" (3.5mm) **Stereo** Audio Cable
- 6ft (1.82m) **Stereo** RCA Cable
- User's Guide

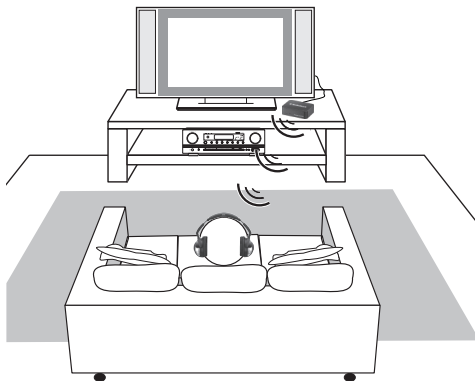

Setup

1. Connect your device using one of these three options:
 - **Using RCA cable (included):** Connect the 1/8" (3.5mm) plug into the **AUX IN** jack on the transmitter, then the RCA plugs into the AUX OUT jacks on your device.

OR

- **Using 1/8" (3.5mm) audio cable (included):** Connect one end to the **AUX IN** jack on the transmitter and the other end into the 1/8" (3.5mm) phone jack on your device.

OR

- **Using a TOSLINK cable (not included):** Connect one end to the **OPTICAL IN** jack on the transmitter, then the other end into the OPTICAL OUT jack on your device.

Note: If both OPTICAL IN and AUX IN devices are connected at the same time, the AUX IN device takes priority. Disconnect the AUX IN connection to use OPTICAL IN device.

2. Connect the adapter into the **DC IN** jack on the transmitter then plug the adapter into a wall outlet.

Device without Bluetooth wireless technology

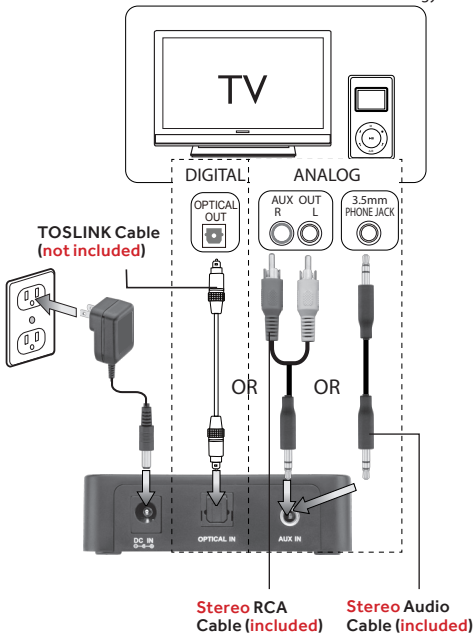



LED Indicator

- Flashes blue - Standby
- Flashes blue and red alternatively - pairing mode
- Lights blue steadily - paired

Connect Button

- Press and hold to turn on/off
- If no previously paired device is in range, press once to enter pairing mode
- When a previously paired device reconnects, press once to activate sound output
- Press **twice** when Bluetooth is connected to disconnect a currently paired device. Press again to enter pairing mode.

Pairing

1. Press and hold the connect button to turn on the transmitter. The LED indicator flashes blue.
2. Activate the Bluetooth function and enter pairing mode on your wireless headphones/speaker with Bluetooth wireless technology (see speaker/headphones user's guide for details).

3. **If no device is connected (LED flashes blue):**

Press the connect button once on the transmitter to enter pairing mode. The LED flashes blue and red alternatively as the transmitter searches for a device and lights blue steadily once successfully.

If already paired to a device (LED lights blue):

Press the connect button **twice** to disconnect the paired device. LED indicator flashes blue. Press the connect button again to enter pairing mode. The LED flashes blue and red alternatively, then lights blue steadily once successfully paired to a new device.

4. To turn off the transmitter, press and hold the connect button.

Notes:

- If your Bluetooth-enable device was previously paired with the transmitter, they will reconnect automatically once both are turned on. **Press the connect button once to activate sound output.**
- **If the Bluetooth-enabled device does not reconnect with the transmittter, restart the transmitter and pair your device again.**

Specifications

Power.....	5V DC 300mA
Bluetooth Protocol.....	V3.0 + EDR A2DP
Operation Range	33 ft. (10m)

Specifications are subject to change and improvement without notice. Actual product may vary from the images found in this document.

FCC Information

This equipment has been tested and found to comply with the limits for a Class B digital device, pursuant to Part 15 of the FCC Rules. These limits are designed to provide reasonable protection against harmful interference in a residential installation. This equipment generates, uses, and can radiate radio frequency energy and, if not installed and used in accordance with the instructions, may cause harmful interference to radio communications. However, there is no guarantee that interference will not occur in a particular installation. If this equipment does cause harmful interference to radio or television reception, which can be

determined by turning the equipment off and on, the user is encouraged to try to correct the interference by one or more of the following measures:

- Reorient or relocate the receiving antenna.
- Increase the separation between the equipment and receiver.
- Connect the equipment into an outlet on a circuit different from that to which the receiver is connected.
- Consult your local dealer or an experienced radio/TV technician for help.

If you cannot eliminate the interference, the FCC requires that you stop using your equipment. Changes or modifications not expressly approved by the party responsible for compliance could void the user's authority to operate the equipment.

This device complies with Part 15 of the FCC rules. Operation is subject to the following two conditions: (1) this device may not cause harmful interference, and (2) this device must accept any interference received, including interference that may cause undesired operation.

Limited Warranty

Go to www.radioshack.com/help for details.

RadioShack Customer Relations
300 RadioShack Circle, Fort Worth, TX 76102

The Bluetooth® word mark and logos are owned by Bluetooth SIG, Inc. and any use of such marks by General Wireless Operations Inc. is under license.

RoHS Complies with the European Union's "Restriction of Hazardous Substances Directive," which protects the environment by restricting specific hazardous materials and products.



© 2017 General Wireless Operations Inc.
All rights reserved. RadioShack is a registered trademark used by General Wireless Operations Inc. dba RadioShack.
radioshack.com

01A17
1201800
Printed
in China