



# User manual E300

High-Fidelity Sound Motorcycle Intercom

E300 is an enthusiast class high-quality Bluetooth intercom headset with a unique mix of ultra bass sound units to meet the user's need for HD sound. E300 could make a full duplex communication between two main units, not only answer phone calls automatically but also could be connected to a common walkie-talkie via a dedicated PTT transfer cable (PTT transfer cable is optional). E300 ensures the safety of vast numbers of motorcycle riders, as well as the close range full duplex communication and the long range group conference. It is the best choice for motorcycle enthusiasts to ride safely and communicate freely.



## Instructions

### Power on

Press and click the button “power on” for 2 seconds

### Power off

Press the button “Power on” and “Phone” for 2 seconds at the same time

## Pairing with a Mobile Phone

Turn on E300, Press the button "Phone" for 5 seconds till the red and blue lights flash alternately, find "E300" in the Bluetooth Setting of your mobile phone, then start pairing between them.

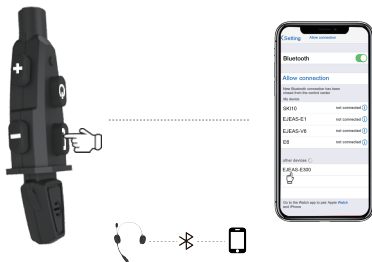

## Pairing between Two E300

First, please make sure the devices were turned off.

Second, Press the button "Power On" of the two units for 5 seconds till the red and blue lights flash alternately, click either button "Power On", the device would search the other E300 automatically.

Third, When you hear the voice reminder "successful", that means the pairing is done, and by this time, the two machines are flashing blue slowly.



## Reconnect with a Mobile Phone

It is defaulted an auto-reconnection once the unit is turned on.

If a E300 is not connected when standby, click the button "Phone", it would search and connect to the mobile phone automatically.

## Clear all Pairing Records

Turn on the E300, press the button "Phone" and "Volume —" at the same time, hold on for 5 seconds or so, when you see the red and blue light quickly flashes 4 times and shut down, that indicates the pairing records were removed.

## Control the Mobile Phone

1. Answer Phone Calls:
  - i. E300 would automatically answer a phone call in 5 seconds
  - ii. Click the button "Phone" when there is a phone coming
2. Refuse Phone Calls:
 

Press the button "Phone" for 2 seconds when a phone call is coming.
3. Hang up Phone Calls: Click the button "Phone" when you're in the call state.
4. Redial the Last Number: Press the button "Phone" for 3 seconds when the E300 is standby.
5. Cancel the Redial: Click the button "Phone" when you're redialing.
6. Voice Dialing (Voice Assistant): Double click the button "Phone" to activate the voice service (your mobile phone should support voice assistant at first) when you've connected the E300 with your mobile phone.
7. Volume Control:
  - i. Click the button "Volume +" or "Volume —"
  - ii. Press the button "Volume +" or "Volume —" for seconds
8. Music Playback/Pause: Click the button "Phone"
9. Previous Track: Double Click the button "Volume -"
10. Next Track: Double Click the button "Volume +"

## Intercon control

1. Start the Intercom Communication: Click the button "Intercom"
2. End the Intercom Communication: Click the button "Intercom"
3. Volume Control:
  - i. Click the button "Volume +" or "Volume —"
  - ii. Press the button "Volume +" or "Volume —" for seconds

## Status description

1. Standby: The E300 was turned on, but didn't entered the mode of intercom and phone call
2. Intercom: The E300 has entered the mode of intercom communication
3. Phone/Music: Paired with a mobile phone successfully
4. Charging: Red Light is always on. Full Charged: Red light off

## Istruzioni dei parti di prodotto

### Helmet installation

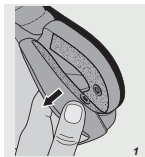

1. Snap off the cheek pads

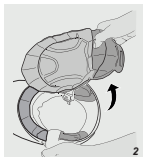

2. Take off the inner lining

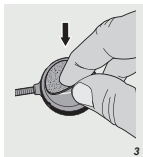

3. Stick the smaller Velcro patch on both earpieces.

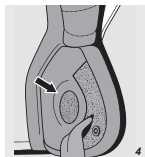

4. Stick the larger Velcro patch on the center of cheek pads where the surface is recessed.

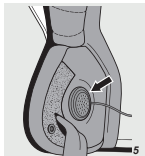

5-6. Place the earpieces on the Velcro patch

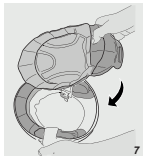
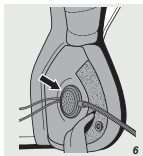

7. Put cheek pads and lining back in place

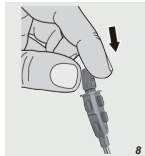

8. Glide the foam bonnet on the microphone end.

## The set contains

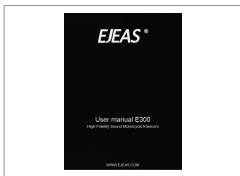
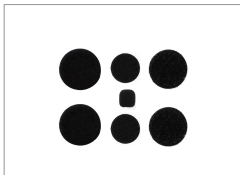

## Parameters

Bluetooth version: Bluetooth 4.2	Bluetooth Protocol: A2DP, AVRCP, HFP & HSP
Frequency Range: 2402MHz ~ 2480MHz	Max. Distance: 300m
Battery Capacity: 250mAh	Standby Time: 300 hours
Operating Voltage: 3.7V	Charger Requirements: DC5V/500mA
Charging Time: approx. 1 hour	Working Temperature: -10~40 °C
Talking Time: 8 hours	
Battery Type: rechargeable polymer lithium-ion battery	
Charge and Discharge Times: more than 500 times	

NOTE: This equipment has been tested and found to comply with the limits for a Class B digital device, pursuant to part 15 of the FCC Rules. These limits are designed to provide reasonable protection against harmful interference in a residential installation. This equipment generates uses and can radiate radio frequency energy and, if not installed and used in accordance with the instructions, may cause harmful interference to radio communications. However, there is no guarantee that interference will not occur in a particular installation. If this equipment does cause harmful interference to radio or television reception, which can be determined by turning the equipment off and on, the user is encouraged to try to correct the interference by one or more of the following measures:

- Reorient or relocate the receiving antenna.
- Increase the separation between the equipment and receiver.
- Connect the equipment into an outlet on a circuit different from that to which the receiver is connected.
- Consult the dealer or an experienced radio/TV technician for help

Changes or modifications not expressly approved by the party responsible for compliance could void the user's authority to operate the equipment.

This device complies with Part 15 of the FCC Rules. Operation is subject to the following two conditions:

- (1) this device may not cause harmful interference, and
- (2) this device must accept any interference received, including interference that may cause undesired operation.