

HOVERAir

Quick Start Guide



© 2022 Shenzhen Zero Zero Infinity Technology Co., Ltd.
All rights reserved.

V202408

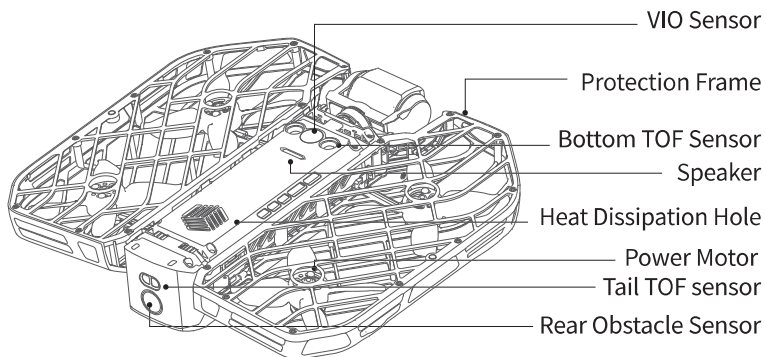
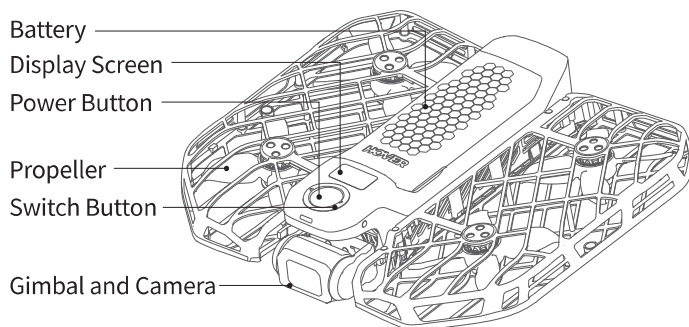

Step 1 Charge the battery

- Please charge the battery first to activate it.

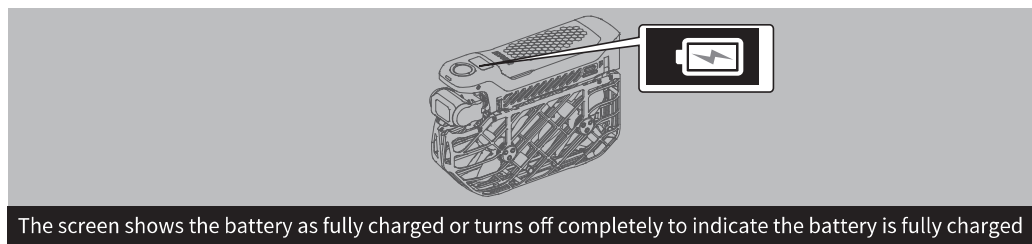

Step 2 Download the App

- Scan the QR code to download and install the Hover X1 App to activate the device.



Step 3 Power on/off

- Press and hold the power button.

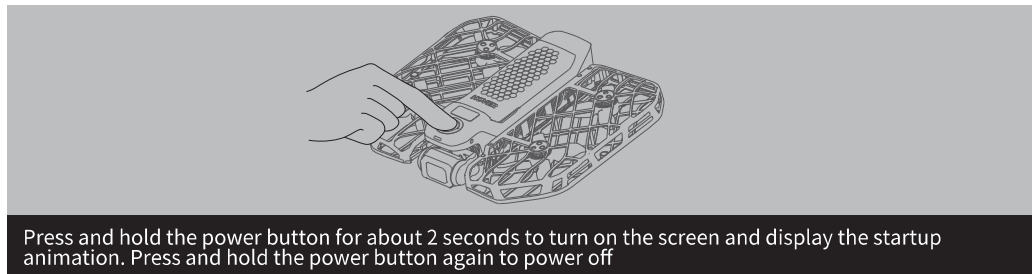

Step 4 Connect the App

- HOVERAir X1 PRO/PROMAX connects to the app via Bluetooth. Please follow these steps:

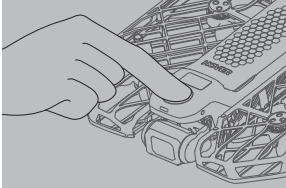

Turn on the HOVERAir X1 PRO/PROMAX



Open the Hover X1 App

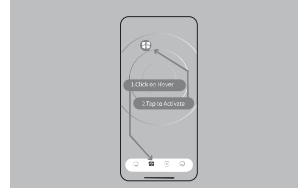

Tap to enter the 'Hover' page, follow the prompts to enable Bluetooth. Tap 'Hover' to search for nearby HOVERAir devices, then select to connect

Note: Press and hold both side switch buttons simultaneously until the status light turns blue. This indicates the device has entered Bluetooth pairing mode and can be connected to your phone.

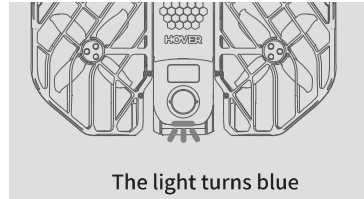
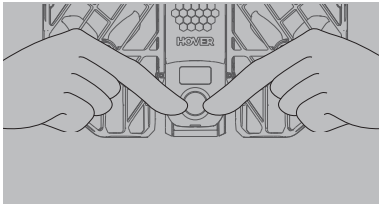

Step 5 Launch the HOVERAir X1 PRO / PROMAX

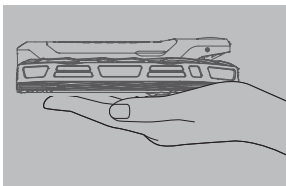

Unfold the HOVERAir X1 PRO/PROMAX as shown in the illustration and place it flat

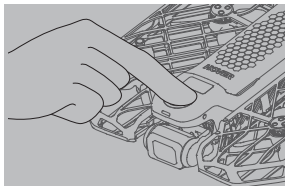

Press the power button

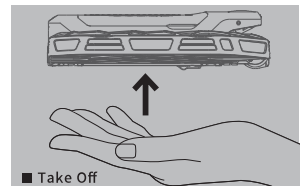

Release the device when the propellers start spinning rapidly

Step 6

Land/retrieve the HOVERAir X1 PRO/PROMAX

Intelligent Flight Paths

- Upon completion of the Intelligent Flight Paths, the HOVERAir X1 PRO/PROMAX will automatically return to the vicinity of the takeoff point. When the HOVERAir X1 PRO/PROMAX arrives near the takeoff location, place your hand approximately 20cm directly beneath it. The device will then autonomously land on your palm, and the propellers will stop rotating.

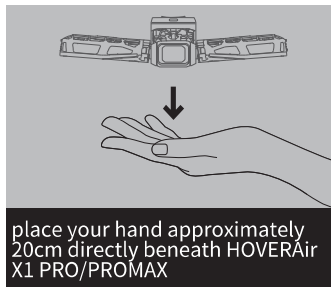

- In case of an emergency, you can retrieve the flying HOVERAir X1 PRO/PROMAX by following it and briefly pressing the power button, or by rotating the device 180 degrees to stop the propellers from spinning.

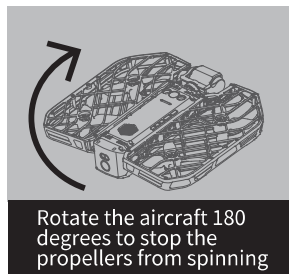

Manual control

- In manual control mode, pilot the HOVERAir X1 PRO/PROMAX to a suitable location and land it manually. Alternatively, use the one-click return function to bring the HOVERAir X1 PRO/PROMAX back to the vicinity of the takeoff point.

Notice:

Do not insert fingers or other objects into the protection frame. For additional safety precautions, please refer to the disclaimer and safety manual on our official website (<https://hoverair.com/pages/x1-pro-and-promax-support>).

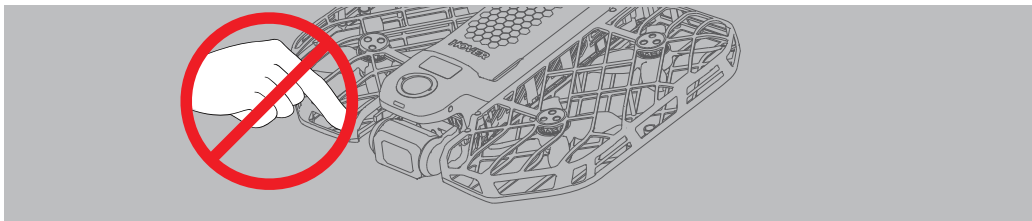

Step 7 Switch Modes and Set Parameters

Introduction to Screen Functions

■ Water Surface Flight Icon

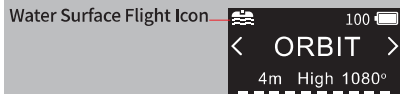

Water surface



Large-area
monochromatic
ground surface



Rice fields,
flower meadows



Low-light
environments

Note: When the 'water surface flight icon' is illuminated, the flying camera can capture a broader range of scenes, including water surfaces, expansive monochromatic landscapes, swaying rice fields, flower meadows, and low-light environments. It is recommended not to fly in these scenes when the icon is not illuminated.

■ Switch the Intelligent Flight Path

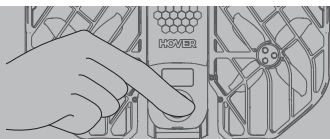

Flight Path



Switch flight path by short pressing the switch button

■ Switch settings parameters



Flight path parameters

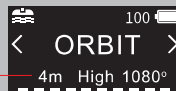

Press and hold the switch button to enter the flight path parameter settings. The parameters will start flashing, indicating that they can be adjusted. Use short presses of the switch button to cycle through the flashing flight path parameters.

■ Switch parameter settings

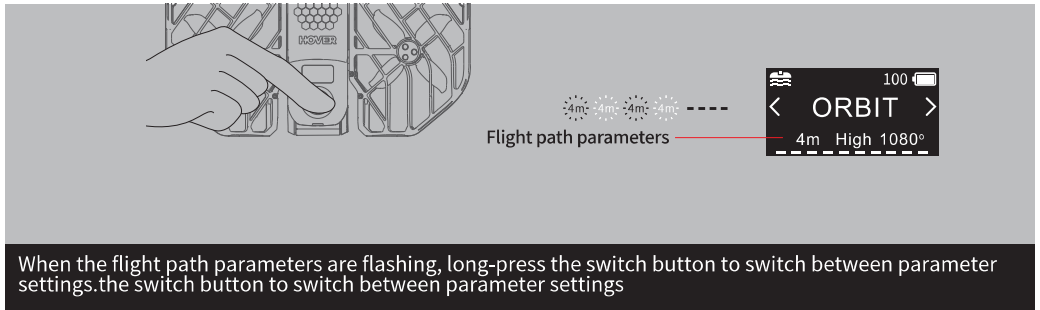

- Both mode switching and parameter settings can be done through the App.

Step 8 Video and photo downloads

- After connecting via Bluetooth to the HOVERAir X1 PRO/PROMAX, you can view low-resolution thumbnails of newly captured footage on the 'Hover' page in the app. Select your preferred works for downloading.
- After downloading, you can view the downloaded content in 'Home > Moments' or in your phone's local gallery.

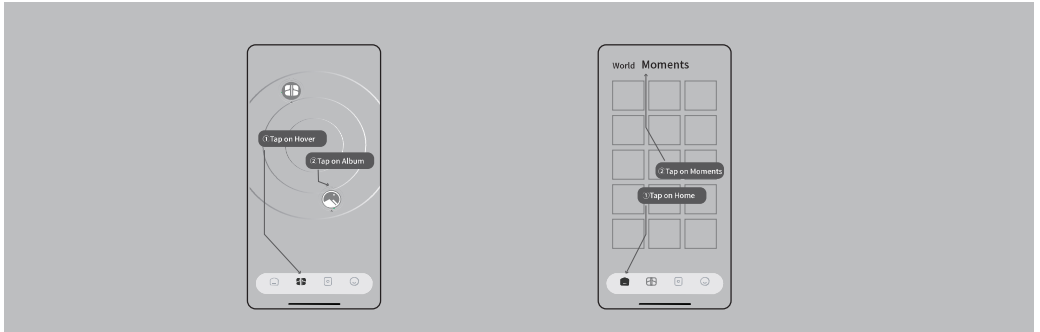

Note: To download content, please connect to the Wi-Fi of the Hover flying camera and follow the prompts until the connection is complete.

Flight restrictions

1. You should use this product in accordance with local laws and regulations for safety. Ensure that both the firmware of the flying camera and the app are updated to the latest versions.
2. Flight restricted areas include but are not limited to major airports worldwide, major cities/regions, event venues, etc. Before operating this product, please consult and comply with all local laws and regulations.

Product Specifications

Takeoff Weight: 190g

Expanded Dimensions: 173mm x 149mm x 39mm

Folded Dimensions: 105mm x 149mm x 34mm

Maximum Horizontal Flight Speed: 42km/h

Maximum Flight Altitude: 2500m. Be cautious at altitudes above 5000m.

Maximum Wind Resistance: 10.7 m/s (Level 5 wind)

Operating Temperature: -10°C to 40°C

Supported Connector Type: USB-C

WIFI/BT/BLE

Protocol: 802.11 a/b/g/n/ac/ax

Frequencies: 2412MHz-2462MHz, 2402-2480MHz(BT/BLE), 5180MHz-5240MHz, 5745MHz-5825MHz

Transmit Power: max ERP <=28dBm, adjustable; Conductive max tx power: 2.4G 22dBm, 5G 21dBm

Storage: 64GB

Supported Chargers: HOVER 30W Charger, HOVER 65W Charger, or other chargers that support USB PD fast charging protocol.

FCC Caution

§ 15.19 Labeling requirements.

This device complies with part 15 of the FCC Rules. Operation is subject to the following two conditions: (1) This device may not cause harmful interference, and (2) this device must accept any interference received, including interference that may cause undesired operation.

§ 15.21 Information to user.

Any Changes or modifications not expressly approved by the party responsible for compliance could void the user's authority to operate the equipment.

§ 15.105 Information to the user.

Note: This equipment has been tested and found to comply with the limits for a Class B digital device, pursuant to part 15 of the FCC Rules. These limits are designed to provide reasonable protection against harmful interference in a residential installation. This equipment generates uses and can radiate radio frequency energy and, if not installed and used in accordance with the instructions, may cause harmful interference to radio communications. However, there is no guarantee that interference will not occur in a particular

installation. If this equipment does cause harmful interference to radio or television reception, which can be determined by turning the equipment off and on, the user is encouraged to try to correct the interference by one or more of the following measures:

-Reorient or relocate the receiving antenna.

-Increase the separation between the equipment and receiver.

-Connect the equipment into an outlet on a circuit different from that to which the receiver is connected.

-Consult the dealer or an experienced radio/TV technician for help.

This equipment complies with FCC radiation exposure limits set forth for an uncontrolled environment. This equipment should be installed and operated with minimum distance 20cm between the radiator & your body.

Operations in the 5.15-5.25GHz band are restricted to indoor usage only.

ISED Caution

English:

This device contains licence-exempt transmitter(s)/receiver(s) that comply with Innovation, Science and Economic Development Canada's licence-exempt RSS(s). Operation is subject to the following two conditions:

(1) This device may not cause interference.

(2) This device must accept any interference, including interference that may cause undesired operation of the device.

The device meets the exemption from the routine valuation limits in section 2.5 of RSS102 and compliance with RSS-102 RF exposure, users can obtain Canadian information on RF exposure and compliance. This transmitter must not be co-located or operating in conjunction with any other antenna or transmitter. This equipment should be installed and operated with a minimum distance of 20 centimeters between the radiator and your body.

French:

Le présent appareil est conforme aux CNR d'Industrie Canada applicables aux appareils radio exempts de licence. L'exploitation est autorisée aux deux conditions suivantes:

(1) l'appareil ne doit pas produire de brouillage, et.

(2) l'utilisateur de l'appareil doit accepter tout brouillage radioélectrique subi, même si le brouillage est susceptible d'en compromettre le fonctionnement.

Le dispositif rencontre l'exemption des limites courantes d'évaluation dans la section 2.5 de RSS102 et la conformité à l'exposition de RSS-102 rf, utilisateurs peut obtenir l'information canadienne sur l'exposition et la conformité de rf.

Cet émetteur ne doit pas être Co-placé ou ne fonctionnant en même temps qu'aucune autre antenne ou émetteur. Cet équipement devrait être installé et actionné avec une distance minimum de 20 centimètres entre le radiateur et votre corps.