

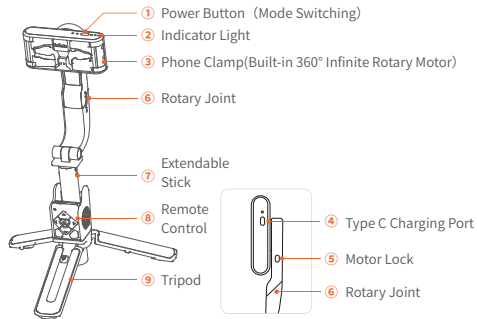

For quick start tutorial,  
please scan the QR code below

### 1 iSteady Q Overview



### 2 Handheld Use

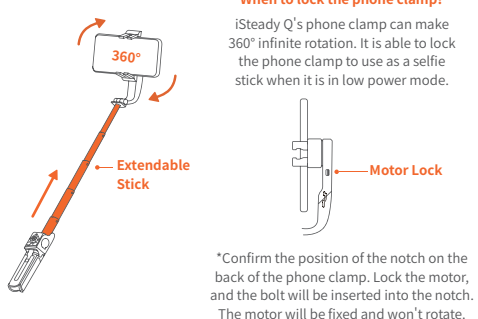

### 3 Desktop Use

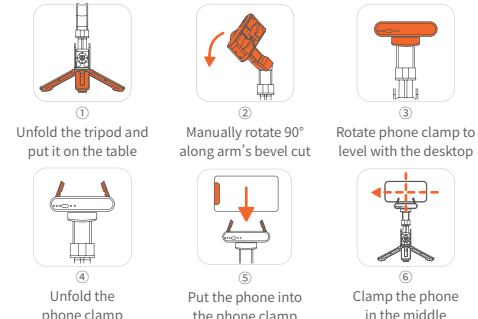

\*To use 360° tracking, please make iSteady Q in desktop use, launch Hohem Joy app, turn on iSteady Q's power button, and ensure the Bluetooth is connected. Hohem Joy app supports face tracking, gesture control, motion timelapse, and moment mode.

### 4 Phone Mounting

#### 1 Unfold the Stick

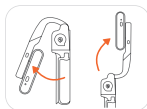

#### 2 Phone Mounting



#### 3 Phone Balancing

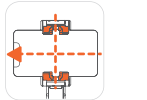

- Unfold the phone clamp and turn 'hohem' logo towards the **left**.
- Meanwhile, turn the phone camera towards the **left**, put the phone stuck in the bottom of the phone clamp, and pull the head of the phone clamp to mount your phone.



\*The stabilizing stick would work improperly if there is no mobile phone mounted.  
\*Make sure your phone clings to the rubber mat and clamps in the middle, otherwise the stabilizing stick would vibrate or turn off automatically.

### 5 Powering On: Long press the power button for 3s

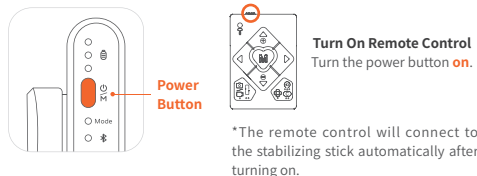

**If the remote control is not working properly, please follow the steps to pair the device again:**

- 1 Turn on the stabilizing stick first. Press the power button **7 times** to enter the pairing mode, and the working mode indicator light flashes alternately in yellow and green.
- 2 Then turn on the remote control. Pairing is complete in about 1 second, and the working mode indicator light stays on green.

### 6 Single Press: Switch the landscape and portrait modes

**Double Press:** Recenter the stabilizing stick  
**Press Five Times:** Auto calibration  
(Please do calibration on a flat surface when the stabilizing stick is not level or drifting. There will be a beep sound after enabling the calibration, and do not move the stabilizing stick until the calibration is done and hear another beep sound.)

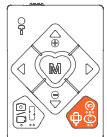

**Long Press 5s:** Power off the stabilizing stick

**Triple Press:** Auto rotation  
(300° Auto Inception/360° Horizontal Rotation)

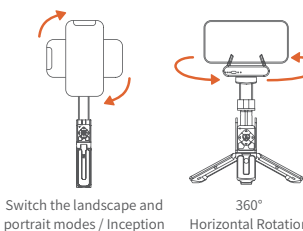

### 7 M Button: Switch Working Mode



#### Single Press: Lock Mode (Default Mode)

\* When the handle rotates along the motor shaft, the phone does not follow the motor to rotate, and the working mode indicator light stays on green.

#### Double Press: POV Follow Mode

\* When the handle rotates along the motor shaft, the phone does follow the motor to rotate slowly, and the working mode indicator light single flashes green.

#### Long Press 5s: Low Power Mode (Longer battery life)

\* The motor will stop working, and it can be used as a regular selfie stick by locking the motor.

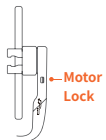

## 8 Download the Hohem Joy App, Register and Login

(App supports face tracking, gesture control, motion timelapse and moment mode)



Scan the QR code  
to enter the download page

Search " Hohem Joy " in the App Store or Google Play.

\*Hohem Joy app requires iOS 10.0 or above,  
Android 6.0 or above.

\*More product tutorial videos can be found  
on the app homepage.

## 9 Connect iSteady Q with Phone Bluetooth in the App

### ① Turn on iSteady Q



### ② Enable Phone Bluetooth



### ③ Follow the Prompts at the top of Hohem Joy App Homepage and Click 'Connect'

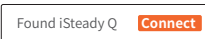

\*Press stabilizing stick power button 9 times  
to cancel the Bluetooth pairing.

## 10 Single Press the Shutter Button: Take Photo/Video



Please ensure Bluetooth is successfully  
connected to use the feature.

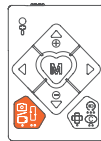

**Double Press:**  
Switch the photo and video modes

**Triple Press:**  
Switch the front and rear cameras

(Only available in the app)

## 11 Navigation Button



**Long Press Left/Right Button:**  
Control the rotation of stabilizing stick

**Double Press Left/Right Button:**  
90° counterclockwise / clockwise fast rotation



**Long Press Up/Down Button:** Zoom in/out  
(Only available in Hohem Joy app and  
some smartphone native cameras)



Please ensure Bluetooth is successfully  
connected to use the feature.

## 12 More Functions of Power Button



**Single Press:**  
Switch between lock/POV follow mode  
(Lock mode is the default mode)

**Double Press:** Recenter the stabilizing stick

**Triple Press:** Auto rotation  
(300° Auto Inception/360° Horizontal Rotation)

**Press Five Times:** Auto calibration  
(Please do calibration on a flat surface when the stabilizing stick is not level  
or drifting. There will be a beep sound after enabling the calibration, and do  
not move the stabilizing stick until the calibration is done and hear another  
beep sound.)

**Press Seven Times:** Remote control pairing

**Press Nine Times:** Cancel the phone Bluetooth pairing

## 13 About Indicator Lights

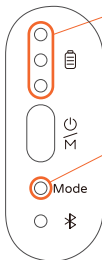

### Battery Indicator Light

**Stay on:** Battery remaining/Charging completed  
**Single flashing:** Charging  
(Only one grid shows single flash indicates low  
battery warning)

### Working Mode Indicator Light

**Green light stay on:** Lock mode  
**Green light single flashing:** POV follow mode  
**Yellow light flashing:** Response of pressing the  
remote control  
**Yellow light stay on:** Low power mode  
(The motor of iSteady Q stops  
operating, but the remote  
control is still connected)

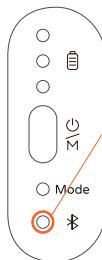

### Bluetooth Indicator Light

**Stay on:** Connected  
**Light off:** Unconnected  
**Blink:** Firmware updating

## Specifications

Model	iSteady Q
Weight	195g
Folded Dimensions	140 x 54 x 36mm
Material	PA&PC + ABS
Battery	460mAh
Operating Time	3 hours
Mechanical Range	* Pan: 360° / Roll: 360°
Controllable Range	* Pan: 360° / Roll: 360°
Compatible Phones	Weight: ≤ 280g Thickness: ≤ 11mm Width: 55.5mm~100mm

## Warranty Card

User Name: \_\_\_\_\_

Contact No.: \_\_\_\_\_

Address: \_\_\_\_\_

Purchase Date: \_\_\_\_\_

Prod. Serial No.: \_\_\_\_\_

Failure Cause: \_\_\_\_\_

Service Record: \_\_\_\_\_

- Within 15 days upon the purchase date.  
Any functional disorder or quality problem  
enjoys free replacement service. But  
ensure the commodity and package with  
no damage, and we will offer a brand new  
replacement after confirming the product  
problem.
- Warranty valid only under normal use.
- Used in the normal circumstances, 1 year  
warranty, maintenance of life (not include  
the All accidents or artificial damage,  
improper disassembly or misuse damage is  
NOT covered by the warranty).
- Please keep and offer the warranty card for  
claiming the warranty service.

### CALL CENTER -Toll Free

UNITED STATES:	+1(888)9658512	Mon-Fri: 9:00AM-5:00PM(EST)
UNITED KINGDOM:	+44(0)808 2737578	Mon-Fri: 2:00PM-10:00PM(GMT +0)
CANADA:	+1(855)758-8939	Mon-Fri: 9:00AM-5:00PM(EST)
BRAZIL:	+55 (0)800 5911897	Mon-Fri: 10:00AM-6:00PM(GMT -3)

### Contact us

Email: service@hohem.com

Website: www.hohem.com

Manufacturer: Hohem Technology Co., Ltd

Connect us at Facebook

—@HohemTechOfficial—

FCC Statement:

Federal Communication Commission (FCC) Radiation Exposure Statement

The device has been evaluated to meet general RF exposure requirement, The device can be used

in portable exposure condition without restriction

This device complies with part 15 of the FCC rules. Operation is subject to the

following two conditions:

(1) this device may not cause harmful interference, and

(2) this device must accept any interference received, including interference that may cause undesired operation.

NOTE: The manufacturer is not responsible for any radio or TV interference caused

by unauthorized modifications or changes to this equipment. Such modifications or

changes could void the user's authority to operate the equipment.

NOTE: This equipment has been tested and found to comply with the limits for a

Class B digital device, pursuant to part 15 of the FCC Rules. These limits are designed

to provide reasonable protection against harmful interference in a residential

installation. This equipment generates uses and can radiate radio frequency energy

and, if not installed and used in accordance with the instructions, may cause harmful

interference to radio communications. However, there is no guarantee that

interference will not occur in a particular installation. If this equipment does cause

harmful interference to radio or television reception, which can be determined by

turning the equipment off and on, the user is encouraged to try to correct the

interference by one or more of the following measures:

- Reorient or relocate the receiving antenna.
- Increase the separation between the equipment and receiver.
- Connect the equipment into an outlet on a circuit different from that to which the receiver is connected.
- Consult the dealer or an experienced radio/TV technician for help.

FCC ID:2AIB7S2

CE:

This device is operated the frequency bands and the maximum output power (E.I.R.P) :

2402MHz - 2480MHz : 6.51dBm

CAUTION RISK OF EXPLOSION IF BATTERY IS REPLACED BY AN INCORRECT TYPE.

DISPOSE OF

USED BATTERIES ACCORDING TO THE INSTRUCTIONS.

The adapter shall be installed near the equipment and shall be easily accessible.

the recommended output voltage/current of the adaptor is 5Vdc/1A.,and the adapter shall be CE

approval type.

The suitable temperature for the product and accessories is -10 C ~45 C .