



Wireless Display Dongle
User Guide

Thank You for Purchasing our Wecast wireless display dongle

Dongle is mainly used to cast from the small screen to big screen. It applies to most mobile phones and tablet PC((Android/IOS) and Windows/Mac laptop,etc.

System Requirements:

iOS	iOS 7 and above, iPhone 4+,iPad 2+,iPod 4+
Android	Android 4.2 model with 1GB RAM
Windows	Windows 8.1+ (Intel CPU)
MAC	MAC10.8

1.Connecting devices

1.1 Connecting the dongle to the TV or projector with HDMI port as follows:

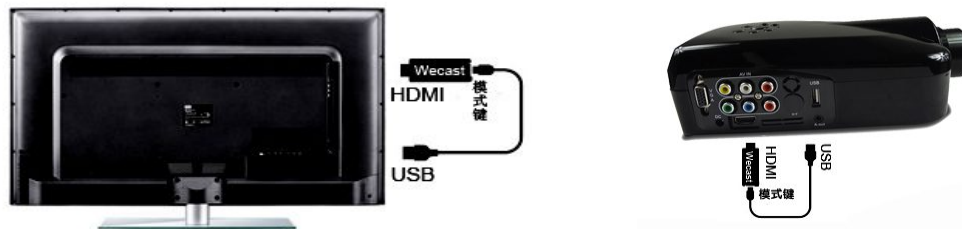

Note: pls check whether the USB Port of TV or projector is workable or not.If not, pls use USB cable to connect the USB power adapter to charge the dongle.

1.2 pls set the TV or projector's output mode to HDMI and connect with dongle to watch the wecast menu.



2.Notice

- 2.1 If long time not use the dongle, pls unplug the usb power cable to save electricity.
- 2.2 Pls put the dongle in a relatively good singal environment,then it can be ensure that the interaction among the dongle, the android/iOS devices and WIFI router/hotspots have the good bandwidth and low latency wireless signal.
- 2.3 pls make sure that wifi singal is strong enough between wifi router,dongle and portable smart phone/laptop/windows8.1/Mac10.8 laptop.
- 2.4 The lastest firmware will be updated automatically time to time online while the dongle connecting well with internet.

3.Setting the dongle's wifi

(1) Go to WIFI, find "Wecast-xxxxxx", input password "12345678" and connect.

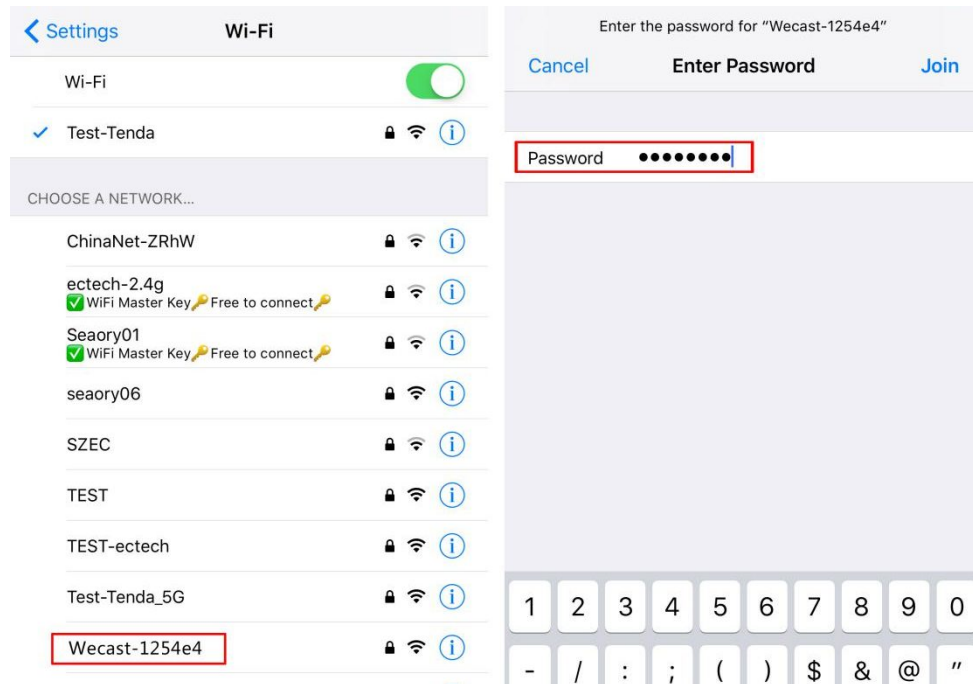

(2) Go to Browser, input "192.168.49.1" and "Go " then click "WIFI".

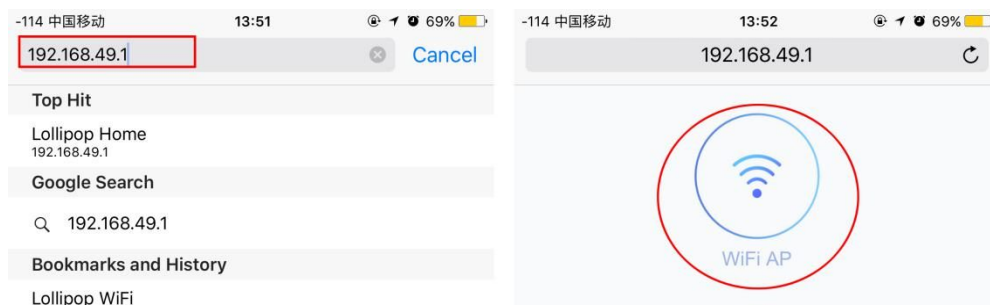

(3) Click "Scan" and choose available WIFI.

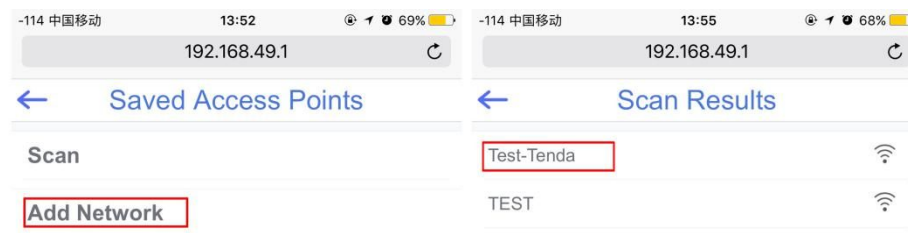

(4) Input password and connect.



4.Wecast

4.1,Wecast just support android mirroring Netflix.Download “home” on your phone, and install “Home”APP .Click “Home”APP,find “cast screen/audio”.

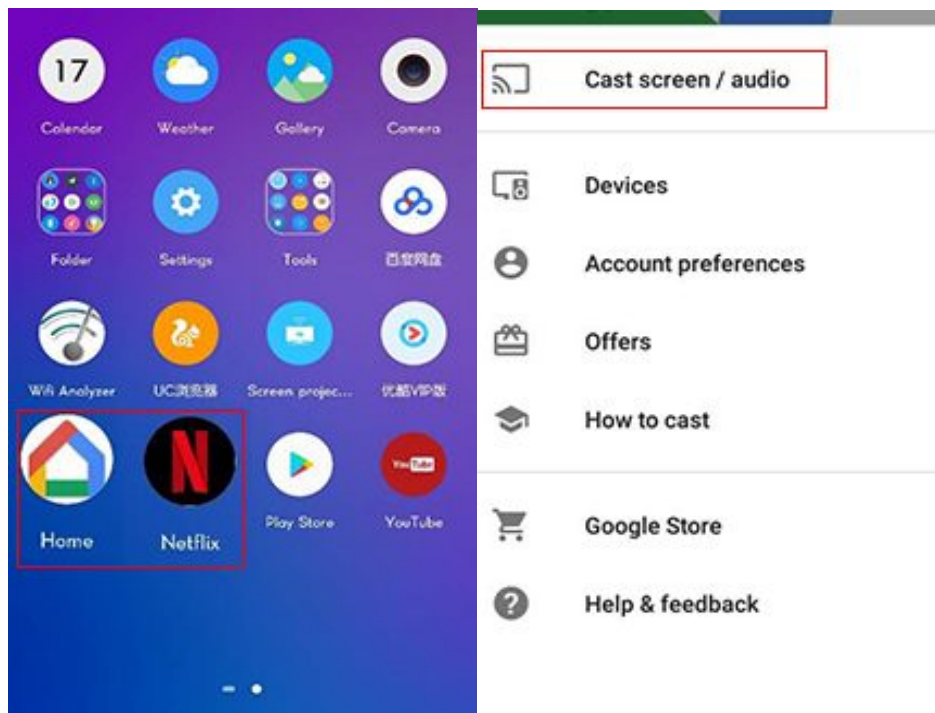

4.2,Connect wecast-xxxx,open the Netflix APP.

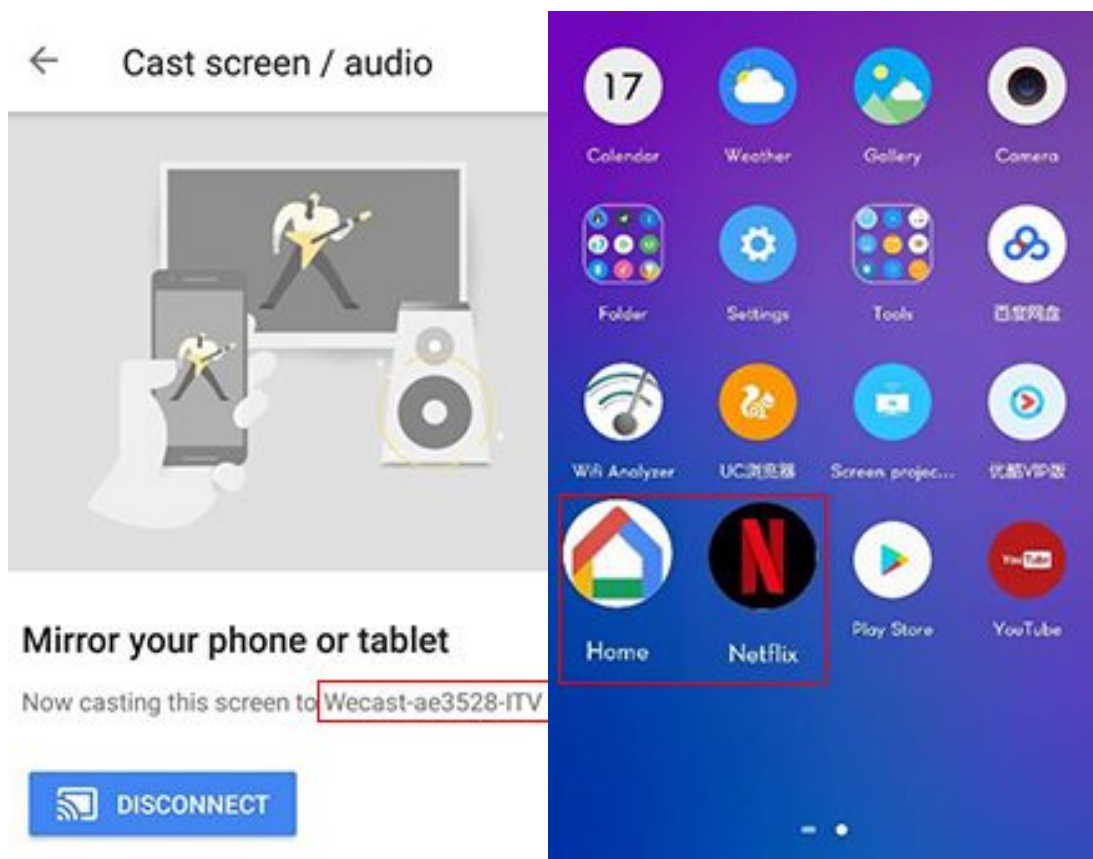

4,3 Wecast support Android OS mirroring Netflix.



5.IOS Device Operation(Airplay Mirroring)

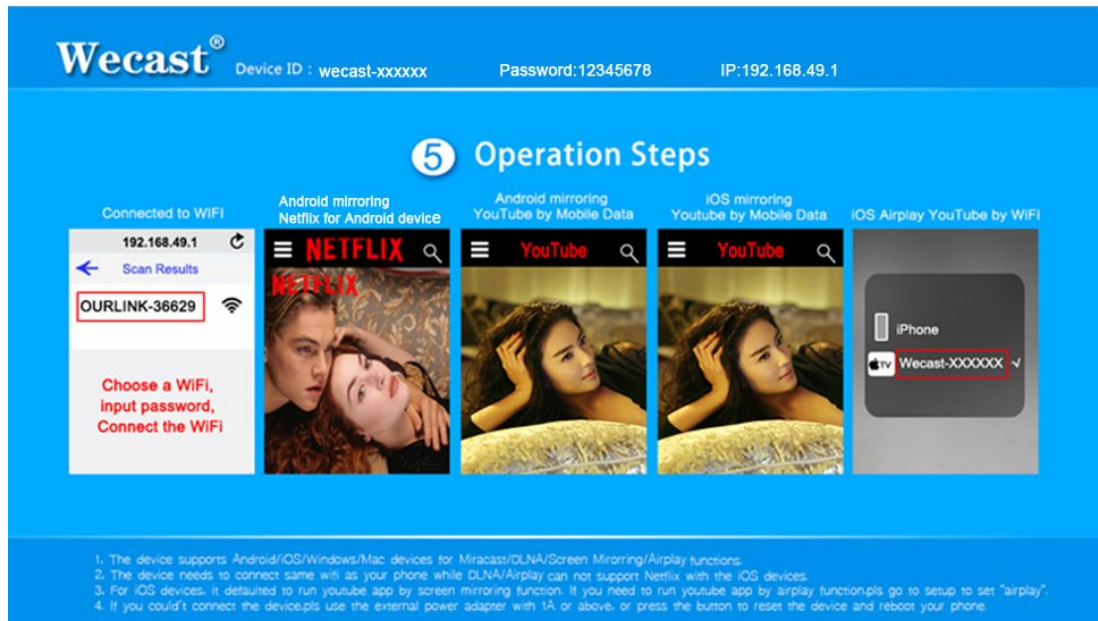

(1) Go to WIFI, find “Wecast-xxxxxx”, input password “12345678” and connect.

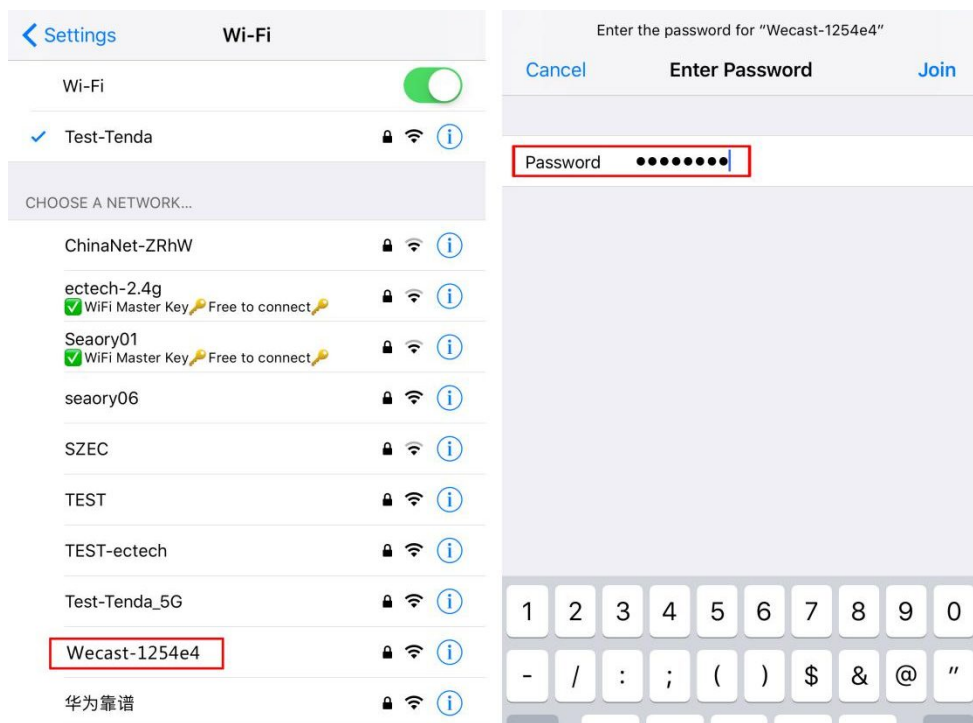

(2) Open Airplay Mirroring, choose “Wecast-xxxxxx” to do the cast.

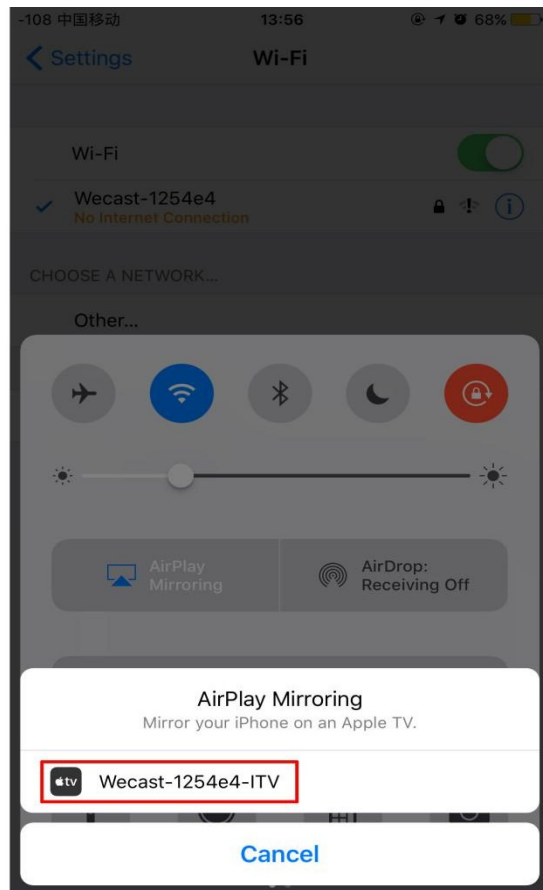
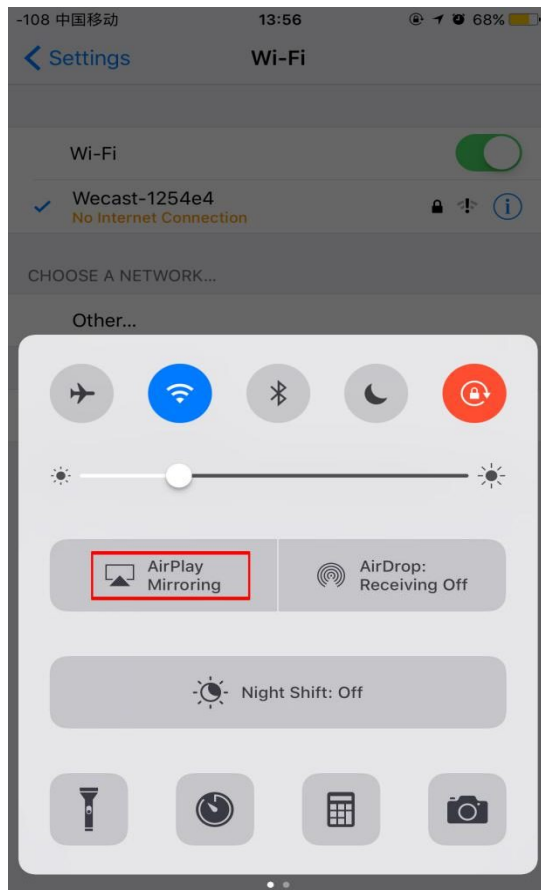

6. Android Device Operation(Miracast)

(1) Find SmartView/Allshare, search the device and choose our "Wecast"

(Smartview/Allshare - Samsung, Multi - Screen - HUAWEI, Wireless Display - XiaoMi, etc)

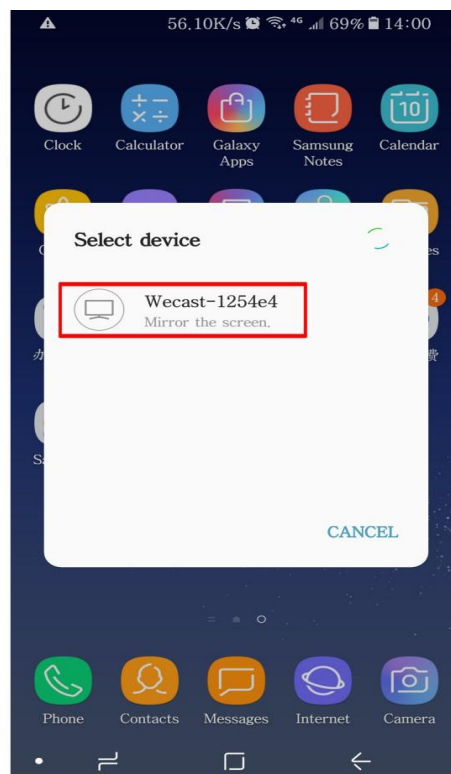
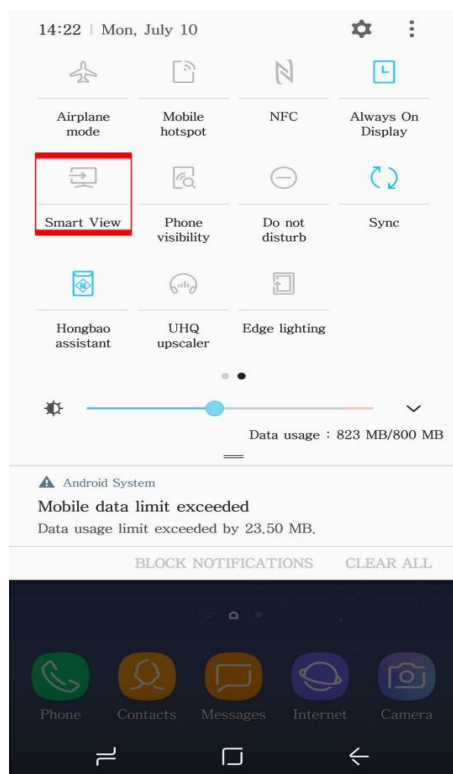

Other android smartphone Miracast Operation

Android phone	Miracast Operation	
Samsung	Setting - More - Allsharecast Setting - Screen mirroring	
Huawei	Setting - Smart assistance - Multi-screen	
HTC	Setting - Medid Link	
SONY	Setting - Display - Screen mirroring	
LG	Setting - More - Miracast Or Setting - Display - Wireless Display	
OPPO	Setting - More - WLAN Display	
Xiaomi	Setting - Display - Wireless Display	
Lenovo	Setting - Display - Wireless Display	
ZTE	Setting - Display - Wireless Display	

7.DLNA/Airplay Function

- 1: Switch the mode to "DLNA", Connect the Dongle with the external WIFI router, and make sure your phone connect with the same wifi router.
(The operation for connecting the external router, please check 1.(2)-(3)-(4). The operation is the same for Android and IOS Phones.)
- 2: Open the music/video Apps(Youtube) with the  (airplay function) in the IOS device, choose music or videos, and you could Airplay/DLNA them to the HDTV/Projector.
- 3: After that, you could run the player in background. And your phone could do other things, like chatting on facebook/twitter, sending emails, or browsing online, etc. These won't influence the movies/music playing.

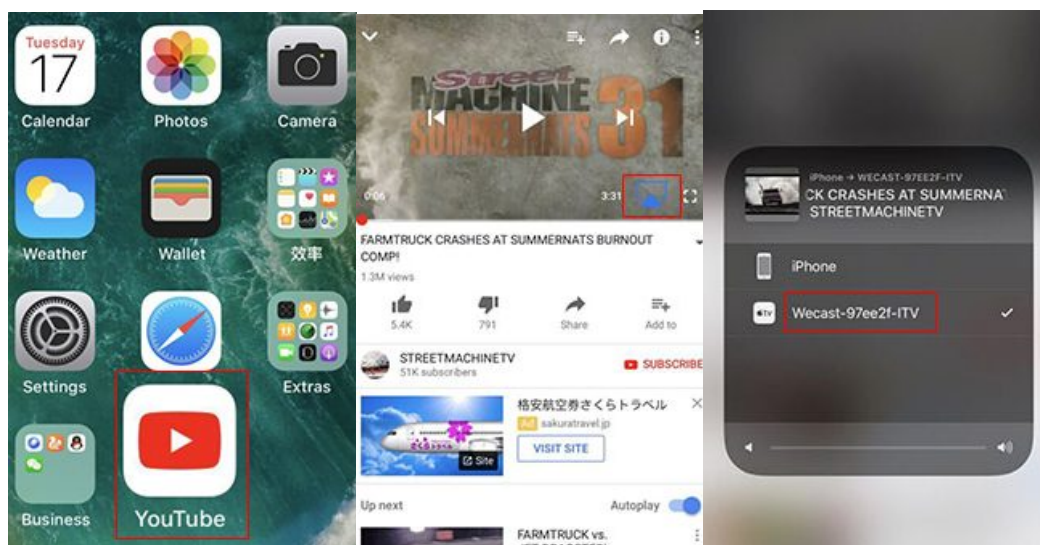

8: Windows Device Operation(Miracast)

Please make sure your laptop is windows 8.1 or above, and with Intel CPU.

(1) Go to Settings

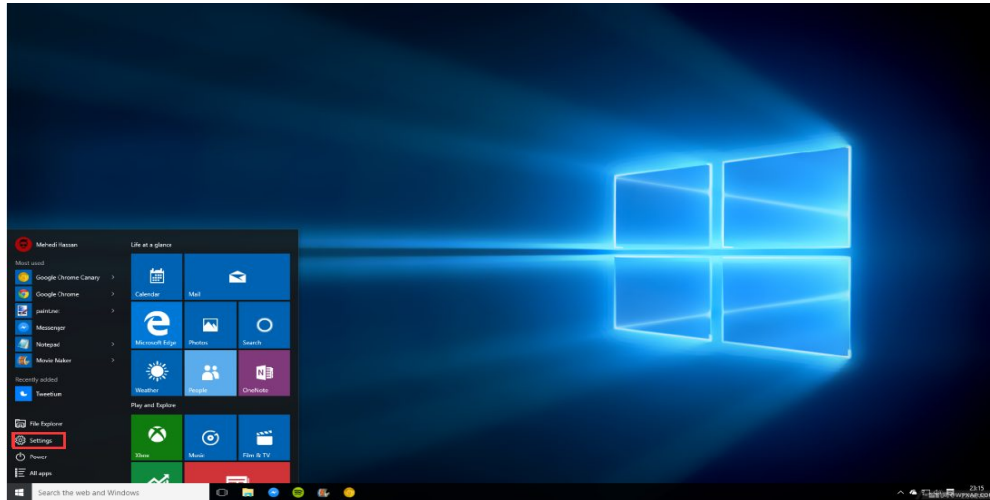

(2) Device - Connected Devices - Add a printer or a scanner

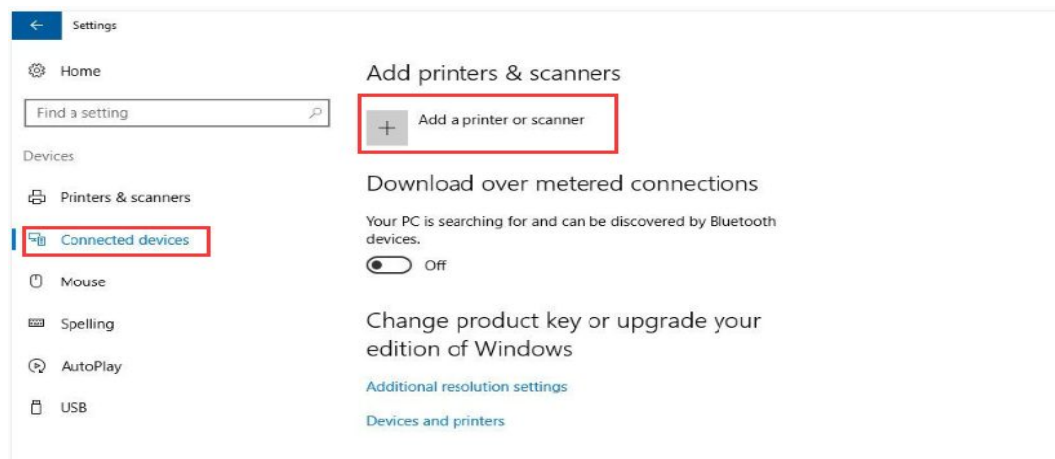

9: Choose our “Wecast - xxxxxx”

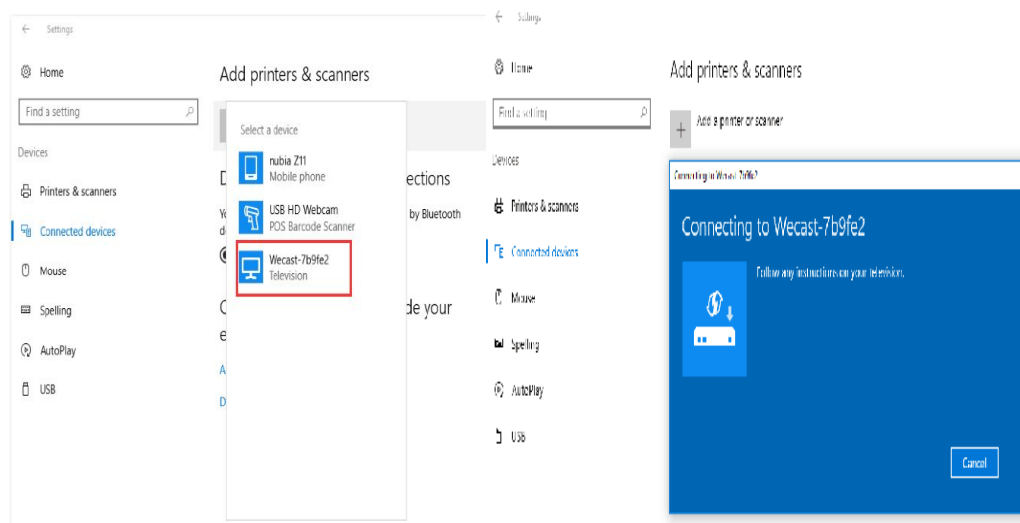

10: Mac Device Operation (Screen Mirroring)

(1) Go to WIFI

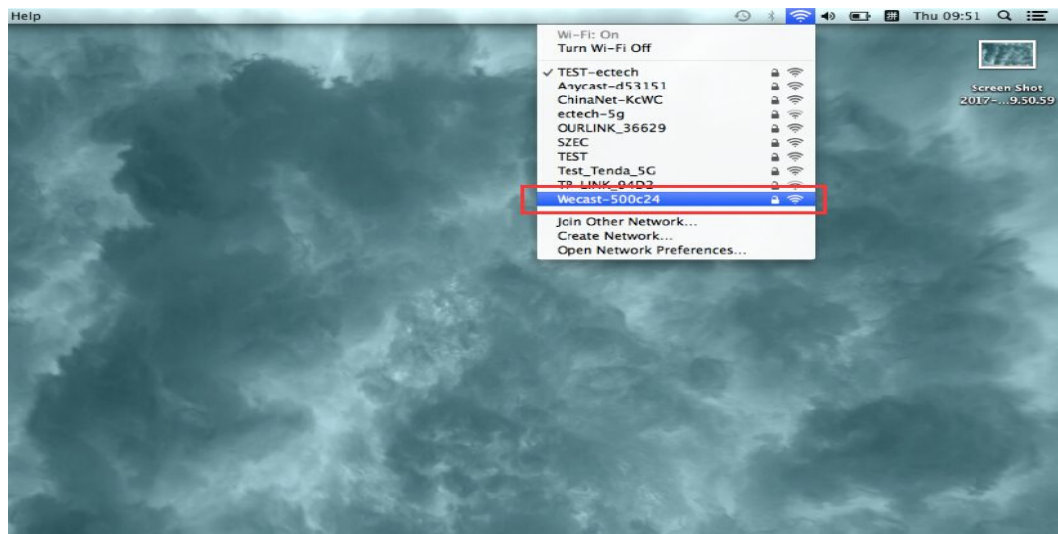

(2) Choose our “Wecast - xxxxxx” and input password “12345678”, then Join.

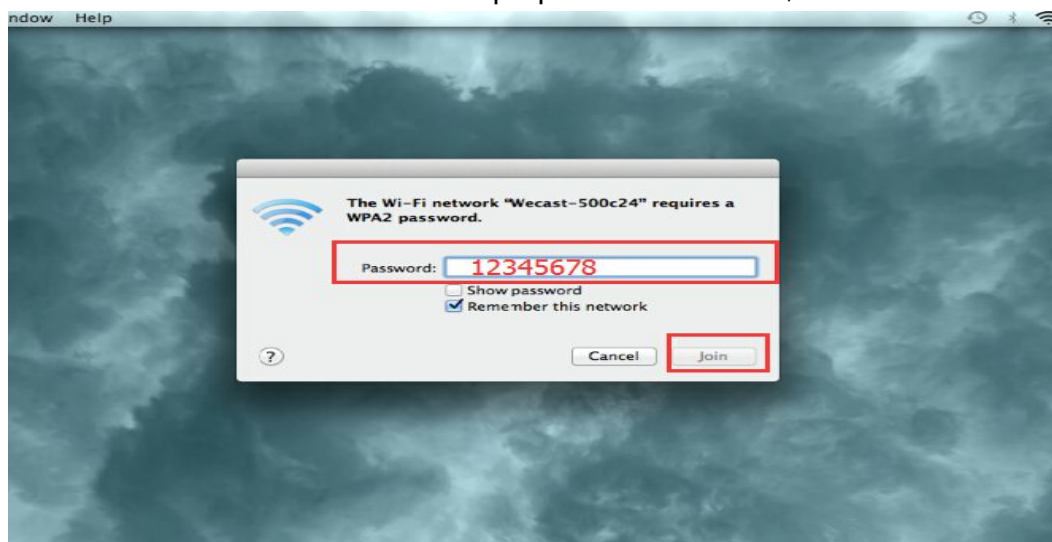

(3) Go to Browser, input “192.168.49.1” and “Go ” then click “WIFI”.

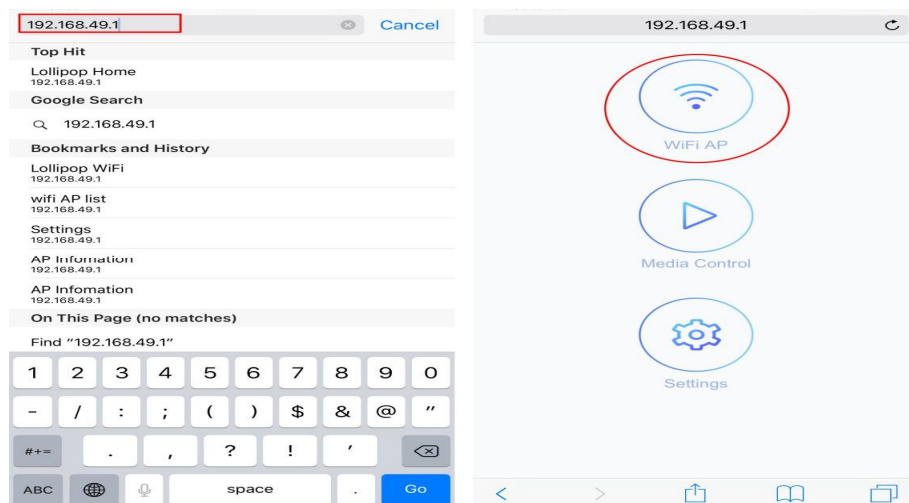

(4) Click “Scan” and choose available WIFI.

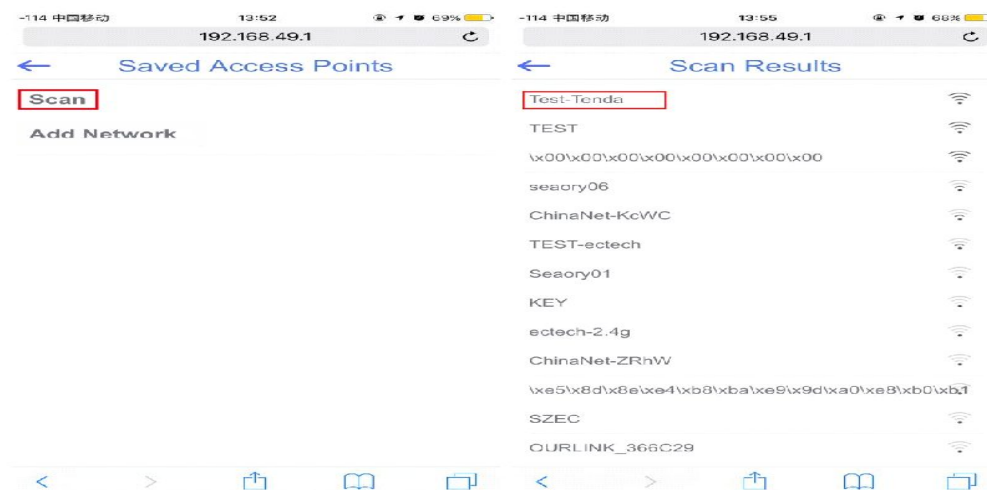

(5) Input password and connect.



(6)The Wecast and MAC connect the same wifi “test-tenda”

(7)Go to “Displays”



(8) Choose "Airplay Displays"

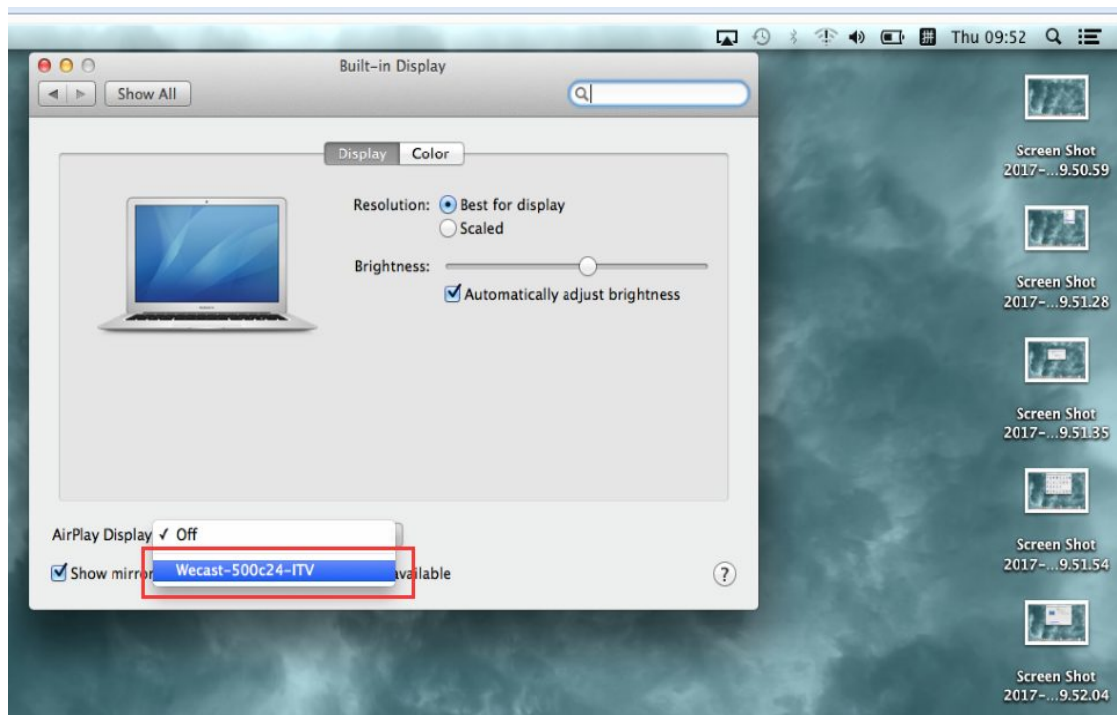

11. Online Upgrade

Please don't do any operation on the dongle when upgrading, the dongle will proceed the whole upgrade automatically.

Wecast® Device ID : wecast-xxxxxx Password: 12345678 IP: 192.168.49.1

5 Operation Steps

Connected to WiFi
192.168.49.1
Scan Results
OURLINK-36629
Choose a WiFi,
input password,
Connect the WiFi

Android mirroring
Netflix for Android device

Android mirroring
YouTube by Mobile Data

iOS mirroring
Youtube by Mobile Data

iOS Airplay YouTube by WiFi

1. The device supports Android/iOS/Windows/Mac devices for Miracast/DLNA/Screen Mirroring/Airplay functions.
2. The device needs to connect same wifi as your phone while DLNA/Airplay can not support Netflix with the iOS devices.
3. For iOS devices, it defaulted to run youtube app by screen mirroring function. If you need to run youtube app by airplay function, pls go to setup to set "airplay".
4. If you couldn't connect the device, pls use the external power adapter with 1A or above, or press the button to reset the device and reboot your phone.

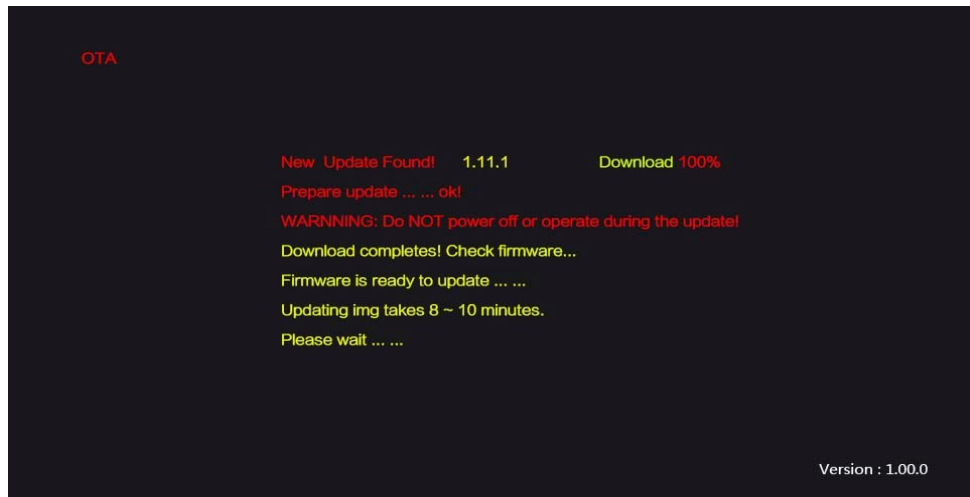

- (1): Connect the external WIFI Router.
 - (2): Dongle will detect the new firmware itself and download.
 - (3): It will install the new firmware itself after firmware downloading.
 - (4): Then it will turn off and reboot itself with new version of software.
- (Please note, don't turn off the power and make sure WIFI is available.)

Notice:

- 1, If you don't use it, please unplug the power cable to save electricity.
- 2, Please put the device in an wifi environment with relative good signal, to make sure a stable connection among dongle, Android/IOS/Windows/Mac devices and WIFI router.
- 3, Please make sure your WIFI is stable and good to make sure a fluent performance of our dongle's miracast/dlna/airplay function.
- 4, The latest firmware will be updated automatically time to time online while the dongle connecting well with internet.
- 5, If you want to do the dongle factory default, pls long pressing the button.

FCC Caution:

This device complies with part 15 of the FCC Rules. Operation is subject to the following two conditions: (1) This device may not cause harmful interference, and (2) this device must accept any interference received, including interference that may cause undesired operation.

Any Changes or modifications not expressly approved by the party responsible for compliance could void the user's authority to operate the equipment.

Note: This equipment has been tested and found to comply with the limits for a Class B digital device, pursuant to part 15 of the FCC Rules. These limits are designed to provide reasonable protection against harmful interference in a residential installation. This equipment generates uses and can radiate radio frequency energy and, if not installed and used in accordance with the instructions, may cause harmful interference to radio communications. However, there is no guarantee that interference will not occur in a particular installation. If this equipment does cause harmful interference to radio or television reception, which can be determined by turning the equipment off and on, the user is encouraged to try to correct the interference by one or more of the following measures:

- Reorient or relocate the receiving antenna.
- Increase the separation between the equipment and receiver.
- Connect the equipment into an outlet on a circuit different from that to which the receiver is connected.
- Consult the dealer or an experienced radio/TV technician for help.

This equipment complies with FCC radiation exposure limits set forth for an uncontrolled environment. This equipment should be installed and operated with minimum distance 20cm between the radiator & your body.