

# MINI OBD TOOL

## User Manual

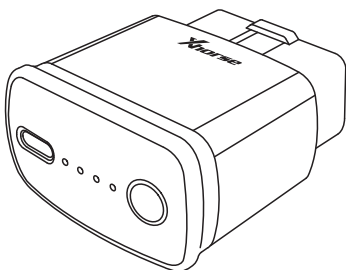

## 1. Product Overview

### 1.1 Product Diagram



MINI OBD TOOL

1

### 1.2 Product Introduction

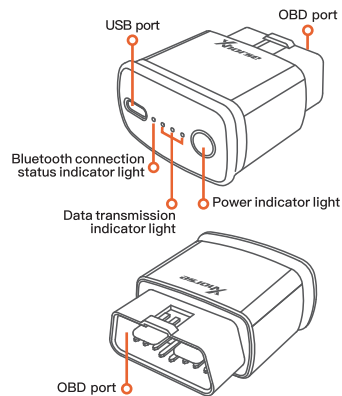

MINI OBD TOOL is a vehicle matching diagnostic tool that supports multiple functions such as Toyota brand vehicle diagnosis, vehicle immobilizer program, and connects software and hardware devices through Bluetooth.

2

## 2. Function Introduction

### 2.1 Device Connection

Switch to the MINI OBD TOOL homepage in Xhorse APP, and click **【Select】**. The page displays the currently connectable devices. Select the correct device to connect.

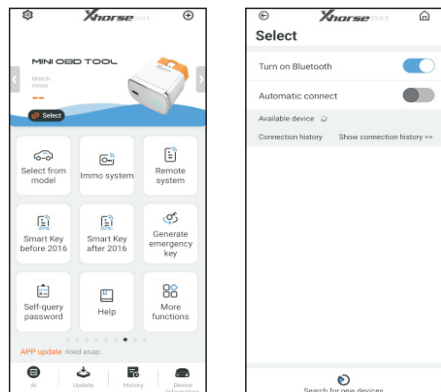

3

### 2.2 Home Page Function

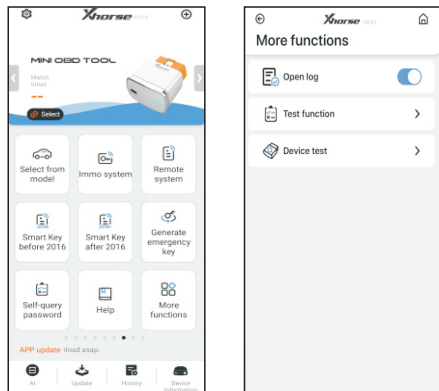

4

- 【Select from model】**, **【Immo system】**, **【Remote system】**, **【Smart Key before 2016】**, and **【Smart Key after 2016】**: Toyota vehicles remote programming according to the above five types, selecting the corresponding type of vehicle type for vehicle diagnosis and Immo program operations.
- 【Generate emergency key】**: Connect the MINI KEY TOOL device to generate emergency key.
- 【Self-query password】**: You can query the vehicle password.
- 【Help】**: You can view relevant Immo information for Toyota vehicles.
- 【More functions】**: Enables device log, device self-test, and other functions.

5

## 3. Warranty And After-sales Instructions

The warranty period for MINI OBD TOOL is one year, subject to the date on the transaction voucher; If there is no transaction voucher or the transaction voucher is lost, the factory date recorded by the manufacturer shall prevail.

### \* The following situations are not subject to free warranty:

- Failing to use the device according to the requirements of the manual, resulting in device failure;
- Damage to the device due to self-repair or modification;
- Failure of the device due to falls, collisions, or improper voltages;
- Damage to the device due to force majeure;
- Device failure or damage caused by long-time use in harsh environments or on vehicles or ships;
- The main engine housing is dirty and worn due to use.

For product after-sales maintenance and technical support, please contact the dealer or scan the QR code on the back of the manual, download the official Xhorse app, and consult online customer service.

The pictures are for reference only, and the product is subject to the actual object. Xhorse reserves all rights to this manual. Without permission, any person or organization is prohibited from copying and disseminating any part of this manual in any form. Due to product improvements, the contents of this manual are subject to change without notice.

6



Scan QR Code to download Xhorse APP

Scan QR code to get MINI OBD TOOL User Manual

Xhorse

DOWNLOADABLE FROM GOOGLE PLAY STORE AND APPLE APP STORE





# KEY TOOL LITE

## FCC statements:

This device complies with part 15 of the FCC rules. Operation is subject to the following two conditions:

(1) This device may not cause harmful interference, and (2) This device must accept any interference received, including interference that may cause undesired operation.

**NOTE:** The manufacturer is not responsible for any radio or TV interference caused by unauthorized modifications or changes to this equipment. Such modifications or changes could void the user's authority to operate the equipment.

**NOTE:** This equipment has been tested and found to comply with the limits for a Class B digital device, pursuant to part 15 of the FCC Rules. These limits are designed to provide reasonable protection against harmful interference in a residential installation. This equipment generates uses and can radiate radio frequency energy and, if not installed and used in accordance with the instructions, may cause harmful interference to radio communications. However, there is no guarantee that interference will not occur in a particular installation. If this equipment does cause harmful interference to radio or television reception, which can be determined by turning the equipment off and on, the user is encouraged to try to correct the interference by one or more of the following measures:

- Reorient or relocate the receiving antenna.
- Increase the separation between the equipment and receiver.
- Connect the equipment into an outlet on a circuit different from that to which the receiver is connected.
- Consult the dealer or an experienced radio/TV technician for help.

Federal Communication Commission (FCC) Radiation Exposure Statement  
When using the product, maintain a distance of 20cm from the body to ensure compliance with RF exposure requirements.

## CE & UKCA statements:

Declaration of Conformity Hereby, Shenzhen Xhorse Electronics Co., Ltd. declares that the radio equipment type XDKML0 is in compliance with directive 2014/53/EU and RER 2017 (SI 2017/1206).



RF exposure information: The Maximum Permissible Exposure (MPE) level has been calculated based on a distance of d=20 cm between the device and the human body. To maintain compliance with RF exposure requirement, use product that maintain a 20cm distance between the device and human body.

	Bands	Operation Frequency	Max.Power
WiFi	2.4GHz	2412-2472MHz	EIRP 15.05 dbm
Bluetooth	2.4GHz	2402-2480 MHz	EIRP 7.55 dbm