

INSTALLATION INSTRUCTIONS

VOLT® LOW VOLTAGE LANDSCAPE LIGHTING

VOLT® Low Voltage Smart Spot Light

ITEM: SM-VAL-2055 & SM-VAL-2056

1-813-978-3700 • Mon-Fri 8am-8pm • Sat-Sun 10am - 6pm (ET)

**IMPORTANT: PLEASE READ BEFORE INSTALLATION**

This fixture is intended for installation in accordance with local codes and the National Electric Code (NEC). Failure to adhere to these codes and instructions may result in serious injury, property damage and void the warranty.

These instructions do not intend to cover all variations in installation, operation maintenance or mounting situations.

1. Make sure that the power is turned OFF before installing or servicing this fixture.
2. Warning: this fixture is not intended to be installed within 10 feet [3 meters] of a pool, spa or fountain.
3. This fixture is intended to be used only with a power supply (transformer) rated maximum of 300 watts (25 AMPS) at 15 Volts.
4. Underground Low Energy Cable must not be buried over 6" (15.2 cm) in order to connect to the main low AMPage cable.
5. Fixture wires must be connected to smart platform transformer correctly.
6. Position the wire connector so that it is located within 6 inches (15.2 cm) from a building structure, a luminaire, or fitting.
7. The low voltage cable should be protected by routing in close proximity to the luminaire or fitting, or next to a building structure such as a house or deck.
8. Contact only switch/plug when turning on.
9. When ordering additional wire or cable, please contact the manufacturer customer service or contact a qualified electrician.

IMPORTANT SAFETY INSTRUCTIONS

LIGHTED LAMP IS HOT!

WARNING – TO REDUCE THE RISK OF FIRE OR INJURY TO PERSONS.

1. Turn off/unplug and allow to cool before reducing lamp.
2. Lamp gets HOT quickly!
3. Do not touch the hot lens, guard or cowl.
4. Keep lamp away from materials that may burn.
5. Do not touch lamp at any time. Use a soft cloth. Oil from skin may damage lamp.
6. Do not operate the fixture with a damaged or missing lens or shield.

SAVE THESE INSTRUCTIONS

WARNING

NOTE: This equipment has been tested and found to comply with the limits for a Class B digital device, pursuant to part 15 of the FCC Rules. These limits are designed to provide reasonable protection against harmful interference in a residential installation. This equipment generates, uses and can radiate radio frequency energy and, if not installed and used in accordance with the instructions, may cause harmful interference to radio communications. However, there is no guarantee that interference will not occur in a particular installation. If this equipment does cause harmful interference to radio or television reception, which can be determined by turning the equipment off and on, the user is encouraged to try to correct the interference by one or more of the following measures:

- Reorient or relocate the receiving antenna.
- Increase the separation between the equipment and receiver.
- Connect the equipment into an outlet on a circuit different from that to which the receiver is connected.
- Consult the dealer or an experienced radio/TV technician for help.

Warning: Changes or modifications not expressly approved by the party responsible for compliance could void the user's authority to operate the equipment.

RF Exposure Statement: The distance between user and products should be no less than 20cm.

PACKAGE CONTENTS

- A. (1) Fixture Body, with 60° Lens Installed
- B. (1) 38° Lens
- C. (1) Allen Wrench

PARTS REQUIRED (SOLD SEPARATELY)

- A. (1) Mounting Accessories
- B. (1) VOLT Smart Transformer

*** Visit our website www.voltlighting.com to purchase. ***

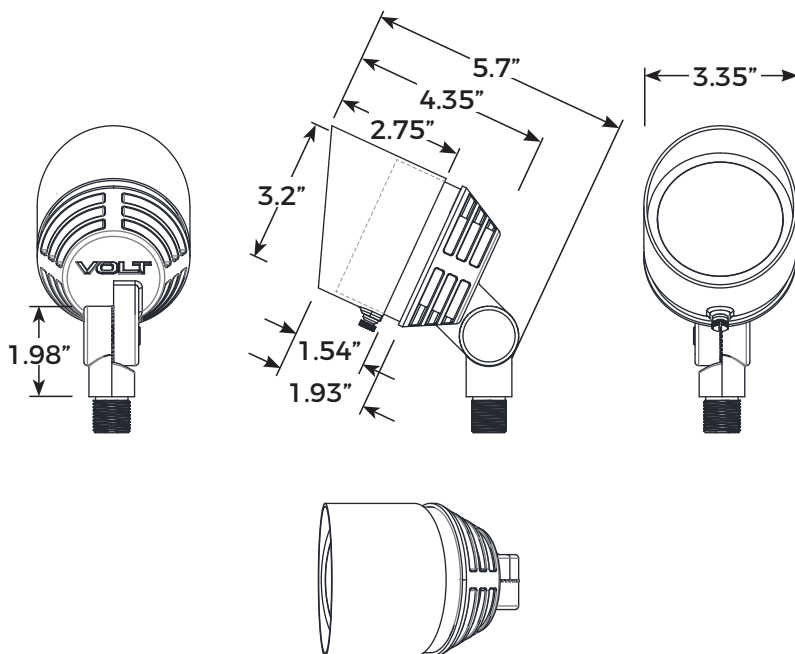
PRODUCT DIMENSIONS

NOTE: The RGBCW LED module may or may not be included.

1 INSTALL STAKE

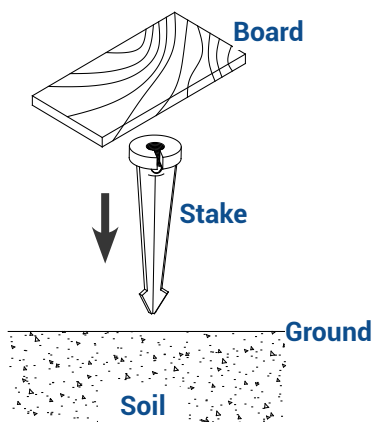

Determine the desired location for mounting the stake. Hammer the stake into the ground until flange of stake is flush to grade. To avoid damage to the stake, place a board on top of the stake while hammering.

Note: If the ground is hard and the stake is difficult to install, make a crosscut in the ground using a flat shovel.

2 INSTALL SMART SPOT LIGHT

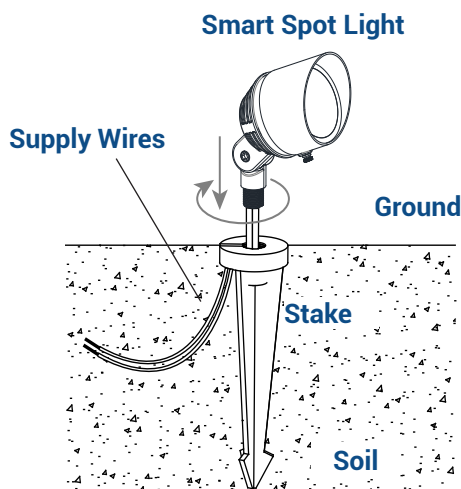

Pass supply wires through the center hole of the stake and thread the smart spot light onto the stake. Hand tighten until snug. Clear away area in ground and lay supply wires into wireway slots.

3 INSTALL SMART SPOT LIGHT

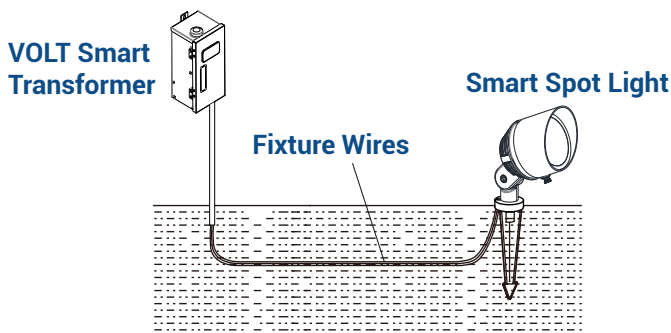

For one smart spot light, connect the fixture wires from the smart spot light to the smart transformer directly.

*** The illustration shows one of VOLT hubs. Other VOLT hubs are also compatible for this system.

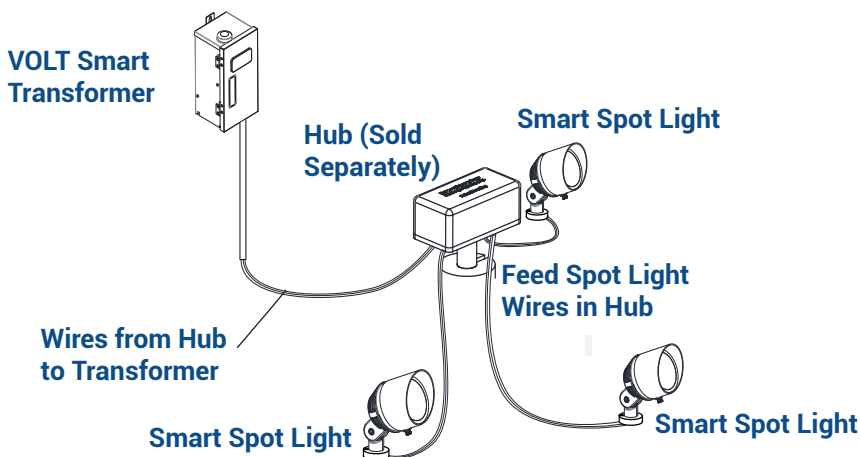

For multiple smart spot lights, we suggest using the hub to connect all the lights to the smart transformer.

1. Place the hub that is used to connect multiple smart spot lights near the smart transformer. Use the proper length wires to connect the hub and the smart transformer.
2. Feed all the supply wires from the smart spot lights into the hub.

4 INSTALL HAT TO SMART SPOT LIGHT

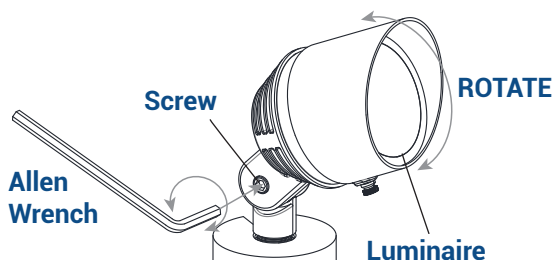

By using the Allen wrench, unlock the screw at the joint to adjust the luminaire to your desired direction. Always re-tighten the screw after adjustment.

Please refer to the "HOW TO CONNECT SMART SPOT LIGHT TO LIGHTING SYSTEM" for the functions. If you need to replace the lens or install the LED module, please refer to "HOW TO REPLACE LENS" or "HOW TO INSTALL LED MODULE".

HOW TO REPLACE LENS

1 REMOVE GLARE GUARD

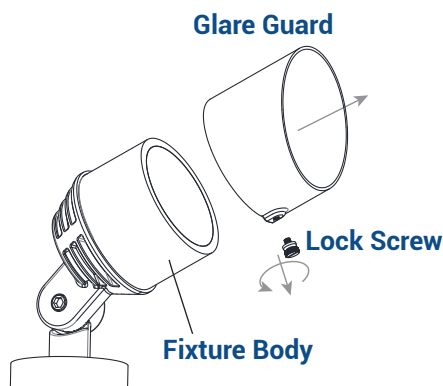

Unlock the lock screw and remove the glare guard from the fixture body.

2 REMOVE TOP COVER

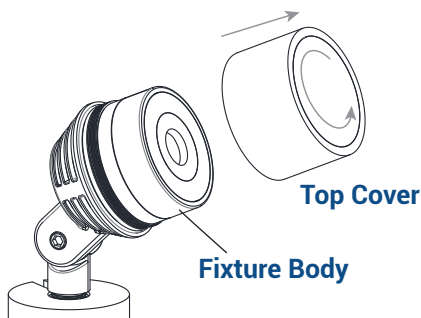

Unscrew the top cover to remove it from the fixture body.

3 REPLACE LENS

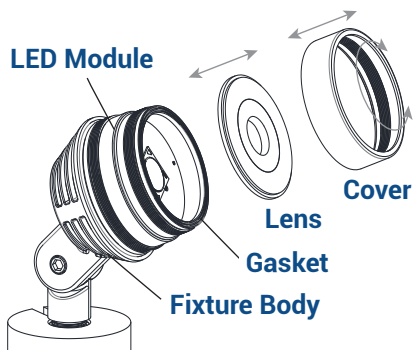

1. Unscrew the cover to remove it from the LED module.
2. Remove the existing lens.
3. Check and make sure the gasket is installed in place.
4. Place the supplied 38° Lens.
5. Thread the removed cover back onto the LED module and hand tighten until snug.

4 INSTALL TOP COVER

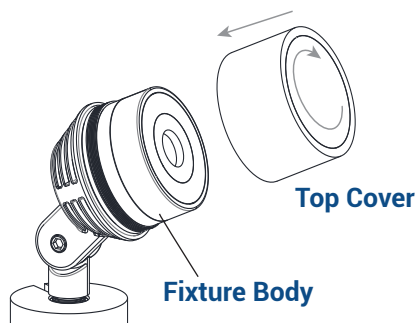

Thread the top cover back onto the fixture body and hand tighten until snug.

5 INSTALL GLARE GUARD

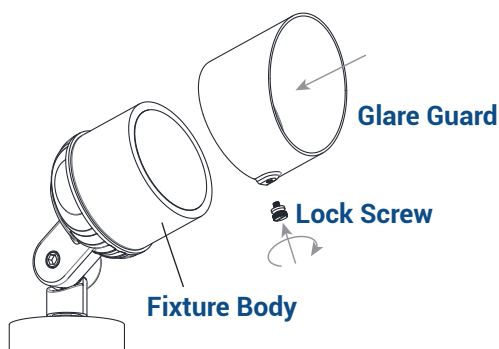

Install the glare guard back onto the fixture body and secure with the previously removed lock screw. Hand tighten until snug.

HOW TO INSTALL LED MODULE

1 REMOVE GLARE GUARD

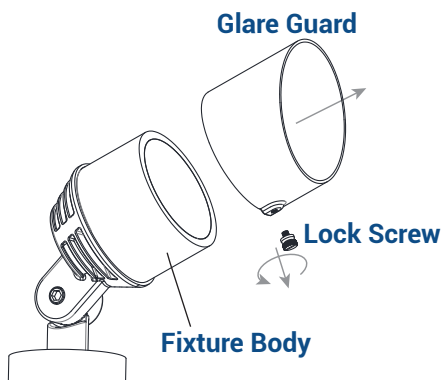

Unlock the lock screw and remove the glare guard from the fixture body.

2 REMOVE TOP COVER

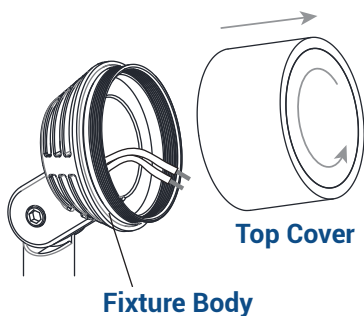

Unscrew the top cover to remove it from the fixture body.

3 CONNECT LED MODULE

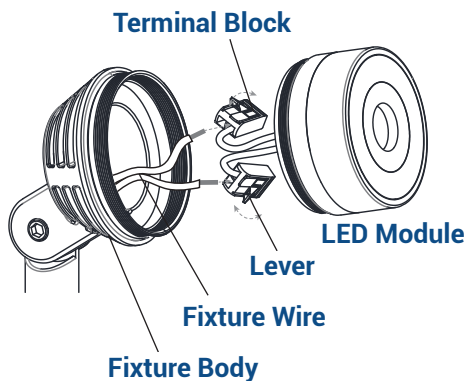

1. Strip both leads from fixture wire inside of the fixture body.
2. Open the lever above the free port on one terminal block. Insert one of the wire into the terminal block and then push the lever down to engage it.
3. Use the same method to connect another wire into another terminal block.

4 INSTALL LED MODULE

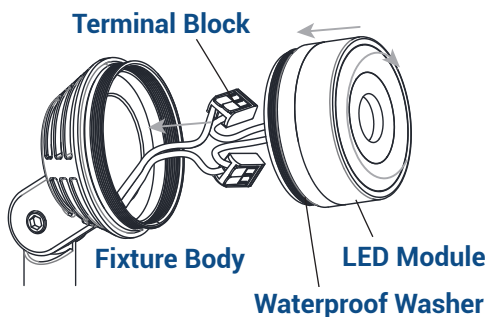

Make sure the waterproof washer is installed in place first. Carefully tuck terminal blocks and slack wires in the fixture body. Thread the LED module onto the fixture body and hand tighten until snug.

5 INSTALL TOP COVER

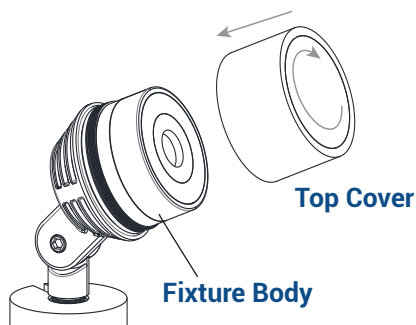

Thread the top cover back onto the fixture body and hand tighten until snug.

6 INSTALL GLARE GUARD

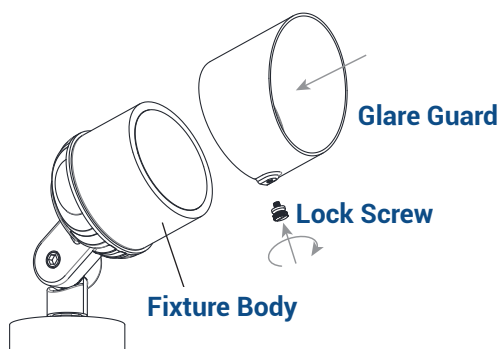

Install the glare guard back onto the fixture body and secure with the previously removed lock screw. Hand tighten until snug.

HOW TO CONNECT SMART SPOT LIGHT TO LIGHTING SYSTEM

Before connecting the smart spot light to your lighting system, please ensure that:

- The APP “VOLT Smart” has been installed on your smartphone.
- The smart transformer has been successfully on boarded, is powered on, and shows three solid LEDs on the front display.

All products default to a factory setting. The lights must be paired to “VOLT Smart” APP before using them.

Whenever the smart spot light is powered on, it will sequentially display five colors: red, green, blue, cool white, and warm white, with each color lasting for one second. After the color-cycling sequence:

1. When the smart spot light has not yet been paired to the smart transformer, it will begin blinking alternately between warm white and cool white.
2. When the smart spot light is paired to the smart transformer for the first time, the color temperature will turn to 2200K.
3. When the smart spot light has been paired to the smart transformer already, it will be restored to the last working state.

HOW TO CONNECT SMART SPOT LIGHT TO LIGHTING SYSTEM (CONTINUED)

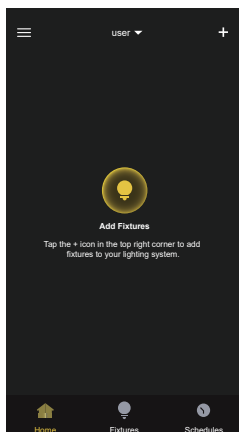

1. Start the APP "VOLT Smart" on your smartphone. Tap the "+" icon in the top right corner to add the smart spot light to your lighting system.

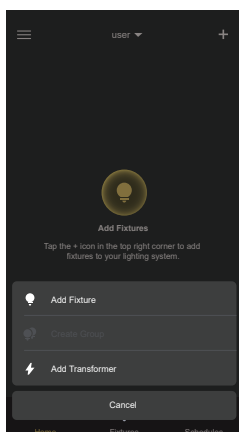

2. Click "Add Fixture".

HOW TO CONNECT SMART SPOT LIGHT TO LIGHTING SYSTEM (CONTINUED)

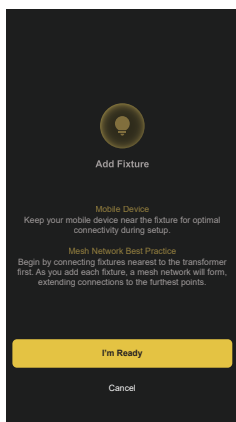

3. Before click "I'm Ready", please check below notes on the screen:
 - **Mobile Device:** Keep your mobile device near the fixture for optimal connectivity during setup.
 - **Mesh Network Best Practice:** Begin by connecting fixtures nearest to the transformer first. As you add each fixture, a mesh network will form, extending connections to the furthest points.

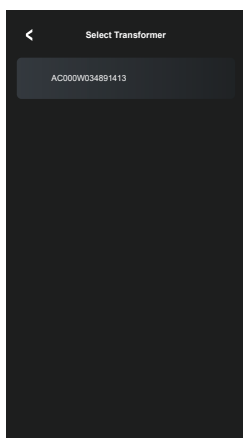

4. Select the transformer to which you would like to connect your smart spot light.

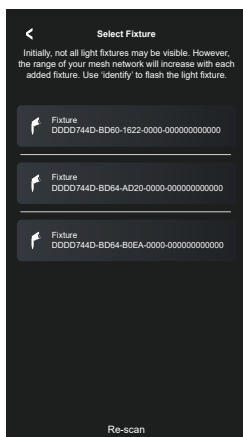

5. Select the smart spot light you would like to onboard. If the desired spot light is not displayed, click the "Rescan" button until it becomes visible.

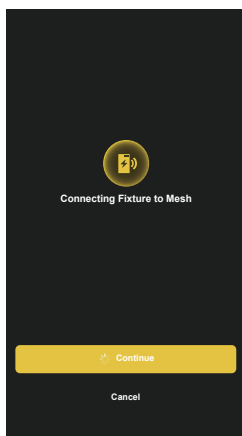
HOW TO CONNECT SMART SPOT LIGHT TO LIGHTING SYSTEM (CONTINUED)

6. Wait until the smart spot light is connected to the Bluetooth Mesh. When the fixture successfully connects to the Bluetooth Mesh, it will change to a solid white color.

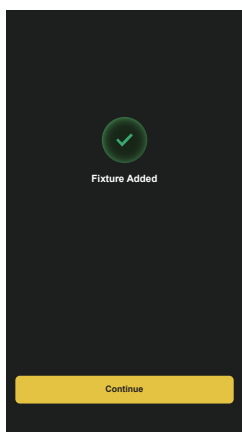

7. Once the smart spot light has been successfully onboarded to your lighting system, click "Continue" to operate the fixture and/or return to another menu.

Congratulations! The installation and configuration of your VOLT Smart Spot light is complete.

TROUBLESHOOTING

*** An NFC-enabled smartphone is required for this step. ***

If you cannot control the smart spot light by using the “VOLT Smart” APP, refer to the following troubleshooting steps:

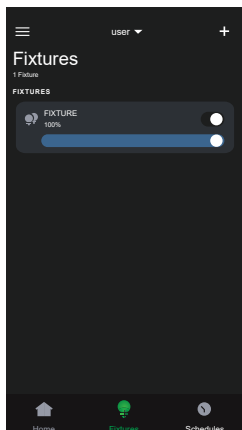

1. Open the “VOLT Smart” APP, find the fixture name that cannot be controlled. Click the fixture name to start the troubleshooting.

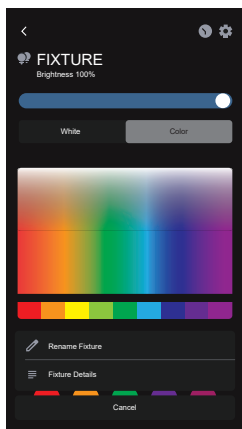

2. Click “Fixture Details”.

TROUBLESHOOTING (CONTINUED)

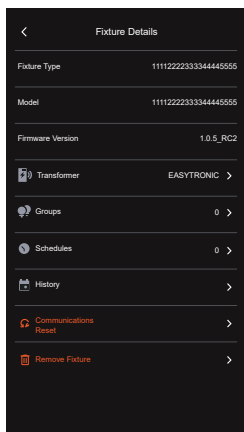

3. Click "Communication Reset".

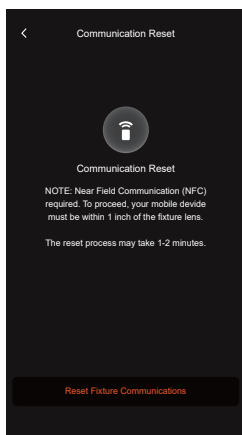

4. Click "Reset Fixture Communications".

TROUBLESHOOTING (CONTINUED)

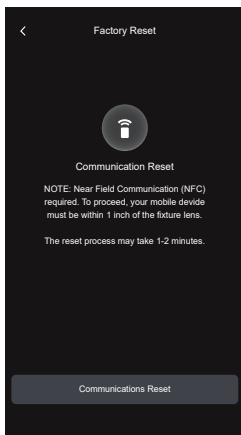

5. Click "Communication Reset".

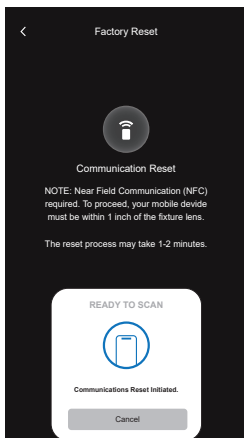

6. Now the screen shows "Ready to Scan". Keep your smartphone on the current page and prepare to place your phone within 1 inch of the fixture lens.

Smart Spot light



7. Put your smartphone within 1 inch of the fixture lens and wait for a few seconds.

TROUBLESHOOTING (CONTINUED)

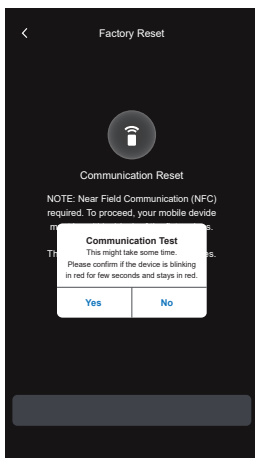

8. Click "Yes" to start communication test.

9. Now the smart spot light is blinking red for few seconds and finally stays red. The progress bar displays the same color synchronously. This process might take some time.

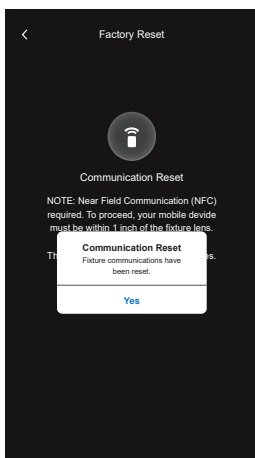

10. Click "Yes" to continue.

The smart spot light communication has now been reset and can once again be controlled via the VOLT Smart app.

If your smart spot light still cannot be controlled after following these steps, you will have to perform a factory reset, described in the next section, and re-onboard the fixture.

HOW TO RESTORE THE DEFAULT SETTINGS

To restore the smart spot light to its factory default settings, perform the following steps:

1. Locate the wire termination point of the cable feeding the fixture. This is usually at a hub or the transformer.
2. With power on to the fixture, disconnect the fixture's wire termination for 1-2 seconds.
3. Reconnect the wire termination so that the fixture proceeds through its startup color sequence.
4. Repeat steps 2-3 for a total of five (5) off-on cycles.
5. On the fifth ON cycle, leave the fixture's wire termination intact. The fixture should now go through its red-green-blue-cool white-warm white sequence, then begin blinking alternately between warm white and cool white.

IMPORTANT NOTE: Do not perform the five off-on sequence mentioned above on the transformer using the transformer's power button or output power switch. Performing this sequence in this manner will force ALL fixtures powered by the transformer into a factory reset mode.

Once the smart spot light has been successfully onboarded to your lighting system, click "Continue" to operate the fixture and/or return to another menu. For any further questions, please contact VOLT customer service.



1-813-978-3700 • Mon-Fri 8am-8pm • Sat-Sun 10am - 6pm (ET)

Specifications and product details subject to change without notice.
© Copyright 2024, VOLT® Lighting, Lutz FL USA 33549 • All rights reserved.
customersupport@voltlighting.com • www.voltlighting.com