

LATEST AND GREATEST

Our team is constantly improving your product experience. This model may have new features or controls which are not detailed in this guide.

For the latest version of the manual, scan the QR code below.



OFFICIAL AUDIO PARTNER OF MAJOR LEAGUE SOCCER

BETTER TOGETHER

JLab is a proud to provide Major League Soccer athletes and gamers with the best personal tech in the locker rooms, for travel and pre-game focus. We're introducing JLab's real innovation and surprisingly awesome value to the passionate, authentic fans of MLS.

FCC ID: 2AHYV-JAPNC

WITH LOVE FROM THE LAB

We have lots of different ways to show we care.

GET STARTED + FREE GIFT

Product updates | How-to tips | FAQs & more

Go to jlab.com/register to unlock your customer benefits including a free gift.

Gift for US only. No APO/FPO/DPO addresses.

THE COMPLETE EXPERIENCE



Download the JLab Store app for sound tools, exclusive product alerts, and the latest news.



WE GOT YOUR BACK

We're obsessed with creating the best possible experience around owning our products. If you have any questions, concerns, or feedback, we're here for you. Contact a real human on our U.S.-based customer support team:

Website: jlab.com/contact **Email:** support@jlab.com

Phone U.S.: +1 (405) 445-7219 (Check hours jlab.com/hours)

Phone U.K./EU: +44 (20) 8142 9361 (Check hours jlab.com/hours)

Visit jlab.com/warranty to initiate a return or exchange.

FIND YOUR FIT

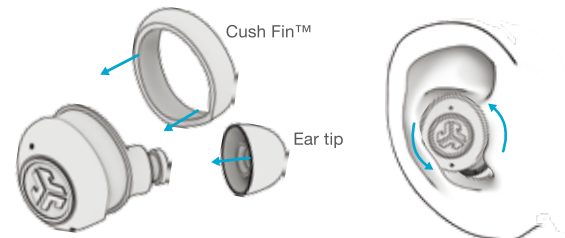

Try all the optional Cush Fins and ear tips for best fit and proper seal.

Place in ear and rotate for best fit.

VOICE PROMPTS

"Ready to Pair": JBuds Air Pro ANC are ready to pair to Bluetooth device

"Battery Full": 100-80%

"Battery Medium": 80-20%

"Low Battery": Less than 20%

When power decreases to 10%, "Low Battery" will play

DOWNLOAD THE APP

Customize JBuds Air Pro ANC features and update the latest software.

Download the **JLab App** in Apple/Google Play Store.



SCAN ME



QUICK TIPS

- Fully dry off the earbuds before putting in the charging case to avoid any damage to the case. The earbuds are sweat/water resistant but the case is not.
- Either earbud can connect to your device and be used independently. Simply take out the earbud from charging case and it will auto connect.
- Choosing the correct ear tip makes a significant improvement in audio quality due to proper seal for the driver. Try all ear tips for best results.

TROUBLESHOOTING

NO AUDIO IN ONE EARBUD OR EARBUDS DISCONNECTED (MANUAL RESET)

- Keep earbuds in the charging case and forget "JLab JBuds Air Pro ANC" in your Bluetooth device settings.

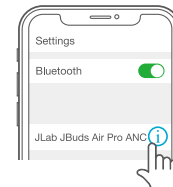

- Quick tap 7x on one earbud in charging case. Earbud **blinks blue 4 times**.

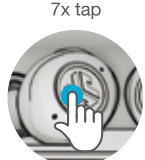

- Quick tap 7x on other earbud in charging case. Earbud **blinks blue 4 times**.

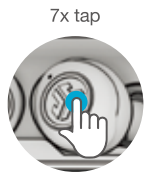

- Take both earbuds out of the charging case. One earbud will **blink blue/white** indicating ready to pair to your device.



JBUDSAIR
PRO ANC
TRUE WIRELESS

QUICK START GUIDE



WELCOME TO THE LAB

The Lab is where you'll find real people, developing really great products, in a real place called San Diego.

PERSONAL TECH DONE BETTER



Designed for You

We actually listen to what you want and we're always looking for ways to make everything easier and better for you.



Lab Quality Sound

Choose from different settings and customize your sound style to match exactly what you're doing.



Surprisingly Awesome Value

We always pack in the most functionality and fun into every product at a truly accessible price.

#yourkindoftech

Tech all about you

PAIR UP

- 1 Take earbuds out of case and remove stickers. Place earbuds back in case and close door.



- 2 Blue lights on case indicates charging. Remove earbuds from case.



- 3 One earbud will blink blue/white indicating ready to pair to your device. Select "JLab JBuds Air Pro ANC" in your device's Bluetooth settings.



GO AHEAD, PRESS THE BUTTON



VOLUME DOWN: 1x Tap

SIRI (iOS) or "OK GOOGLE" (ANDROID): 2x Tap

BE AWARE / ANC ON / ANC OFF: Press & hold 1+ sec

CHANGE EQ: 3x Tap (cycles 4 EQ settings)

VOLUME UP: 1x Tap

ANSWER: 1x Tap

HANGUP: 2x Tap

REJECT INCOMING CALLS: Press & hold 1+ sec

PLAY / PAUSE: 2x Tap

TRACK FORWARD: Press & hold 1+ sec

CHANGE EQ: 3x Tap (cycles 4 EQ settings)

MUSIC / MOVIE MODE: Press & hold both buttons simultaneously 2+ sec

TURN OFF WITHOUT CASE: Turn off Bluetooth from device settings. Earbuds will power off after 3 minutes.

ADDING NEW/ADDITIONAL DEVICES:

Turn OFF Bluetooth from any previously connected device. Turn ON Bluetooth from new device. Earbuds will automatically enter Bluetooth Pairing. Select "JLab JBuds Air Pro ANC" in new device settings to connect.

GET CHARGED (EARBUDS)

Placing in the charging case will auto power OFF and start charging. **Blue lights** will indicate earbuds are charging and will turn OFF when fully charged.

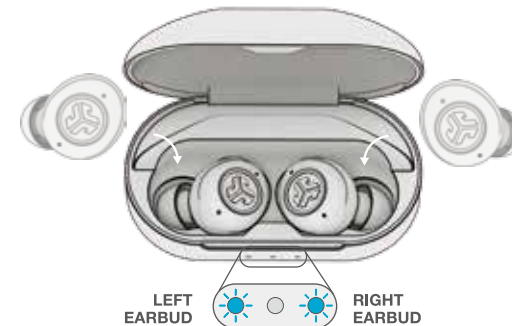

Removing the earbuds will auto power ON and connect to last device.

GET CHARGED (CASE)

Connect JBuds Air Pro ANC to computer or USB 5V 1A (or less) output device.

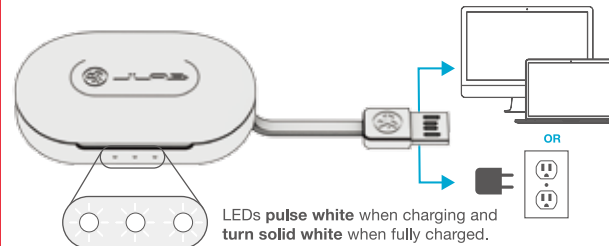

THE RIGHT SOUND FOR EVERY MOMENT

We get it, sound is personal. Choose your sound preferences from our EQ3 settings and customize your sound style to match exactly what you're doing.

EQUALIZER MODES

"JLab SIGNATURE"
JLab C3™ signature sound with amplified vocals and bass

BEST FOR

Best option for most music
Pop, rock, country, electronic and more

"BALANCED"
Even sound with no additional sound enhancements

BEST FOR

Podcasts, Audiobooks
Classical music

"BASS BOOST"
Amplified bass and sub-bass

BEST FOR

Working out, sport and fitness
Hip hop, rap, electronic

"CUSTOM"
Customize your EQ through the JLab App

MULTIPOINT (connect 2 devices simultaneously)

- 1 Once **FIRST** device is connected, turn off Bluetooth in device settings. Earbuds will auto enter Bluetooth Pairing.



- 2 Enter your **SECOND** device Bluetooth settings and connect to JBuds Air Pro ANC.



- 3 Enter your **FIRST** device Bluetooth settings. Turn on Bluetooth and connect to JLab JBuds Air Pro ANC.

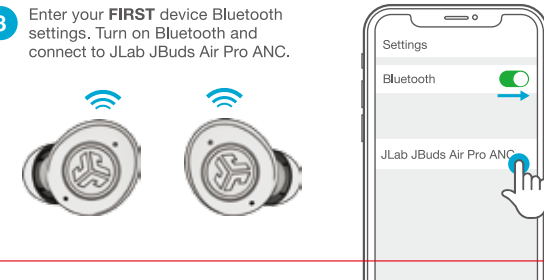

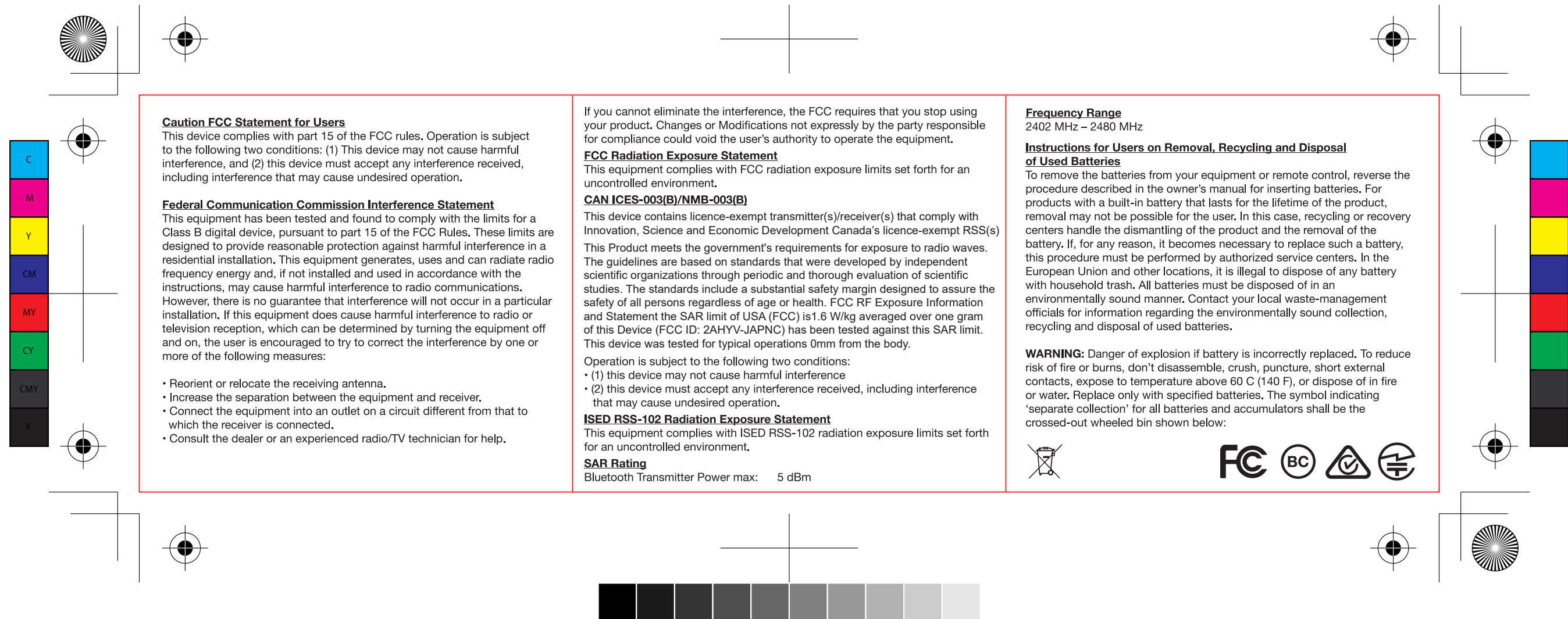

Caution FCC Statement for Users

This device complies with part 15 of the FCC rules. Operation is subject to the following two conditions: (1) This device may not cause harmful interference, and (2) this device must accept any interference received, including interference that may cause undesired operation.

Federal Communication Commission Interference Statement

This equipment has been tested and found to comply with the limits for a Class B digital device, pursuant to part 15 of the FCC Rules. These limits are designed to provide reasonable protection against harmful interference in a residential installation. This equipment generates, uses and can radiate radio frequency energy and, if not installed and used in accordance with the instructions, may cause harmful interference to radio communications. However, there is no guarantee that interference will not occur in a particular installation. If this equipment does cause harmful interference to radio or television reception, which can be determined by turning the equipment off and on, the user is encouraged to try to correct the interference by one or more of the following measures:

- Reorient or relocate the receiving antenna.
- Increase the separation between the equipment and receiver.
- Connect the equipment into an outlet on a circuit different from that to which the receiver is connected.
- Consult the dealer or an experienced radio/TV technician for help.

If you cannot eliminate the interference, the FCC requires that you stop using your product. Changes or Modifications not expressly by the party responsible for compliance could void the user's authority to operate the equipment.

FCC Radiation Exposure Statement

This equipment complies with FCC radiation exposure limits set forth for an uncontrolled environment.

CAN ICES-003(B)/NMB-003(B)

This device contains licence-exempt transmitter(s)/receiver(s) that comply with Innovation, Science and Economic Development Canada's licence-exempt RSS(s). This Product meets the government's requirements for exposure to radio waves. The guidelines are based on standards that were developed by independent scientific organizations through periodic and thorough evaluation of scientific studies. The standards include a substantial safety margin designed to assure the safety of all persons regardless of age or health. FCC RF Exposure Information and Statement the SAR limit of USA (FCC) is 1.6 W/kg averaged over one gram of this Device (FCC ID: 2AHYV-JAPNC) has been tested against this SAR limit. This device was tested for typical operations 0mm from the body.

Operation is subject to the following two conditions:

- (1) this device may not cause harmful interference
- (2) this device must accept any interference received, including interference that may cause undesired operation.

ISED RSS-102 Radiation Exposure Statement

This equipment complies with ISED RSS-102 radiation exposure limits set forth for an uncontrolled environment.

SAR Rating

Bluetooth Transmitter Power max: 5 dBm

Frequency Range

2402 MHz – 2480 MHz

Instructions for Users on Removal, Recycling and Disposal of Used Batteries

To remove the batteries from your equipment or remote control, reverse the procedure described in the owner's manual for inserting batteries. For products with a built-in battery that lasts for the lifetime of the product, removal may not be possible for the user. In this case, recycling or recovery centers handle the dismantling of the product and the removal of the battery. If, for any reason, it becomes necessary to replace such a battery, this procedure must be performed by authorized service centers. In the European Union and other locations, it is illegal to dispose of any battery with household trash. All batteries must be disposed of in an environmentally sound manner. Contact your local waste-management officials for information regarding the environmentally sound collection, recycling and disposal of used batteries.

WARNING: Danger of explosion if battery is incorrectly replaced. To reduce risk of fire or burns, don't disassemble, crush, puncture, short external contacts, expose to temperature above 60 C (140 F), or dispose of in fire or water. Replace only with specified batteries. The symbol indicating 'separate collection' for all batteries and accumulators shall be the crossed-out wheeled bin shown below:

