

REPACE USER MANUAL

## Device overview

The REPACE is a device that can measure muscle oxygen saturation ( $\text{SmO}_2$ ) in real time.

REPACE is developed by OBELAB Inc. It is a portable muscle oxygen saturation measuring device that measures changes in oxygen saturation in the muscle tissue by shining near-infrared light with wavelengths of 780 nm and 850 nm. The REPACE illuminates a weak LED light for the measurement, which is harmless to the human body. An mobile application is provided with the REPACE that will be used to observe changes in muscle oxygenation in real time extracted by measured multiple-channels.

Device overview

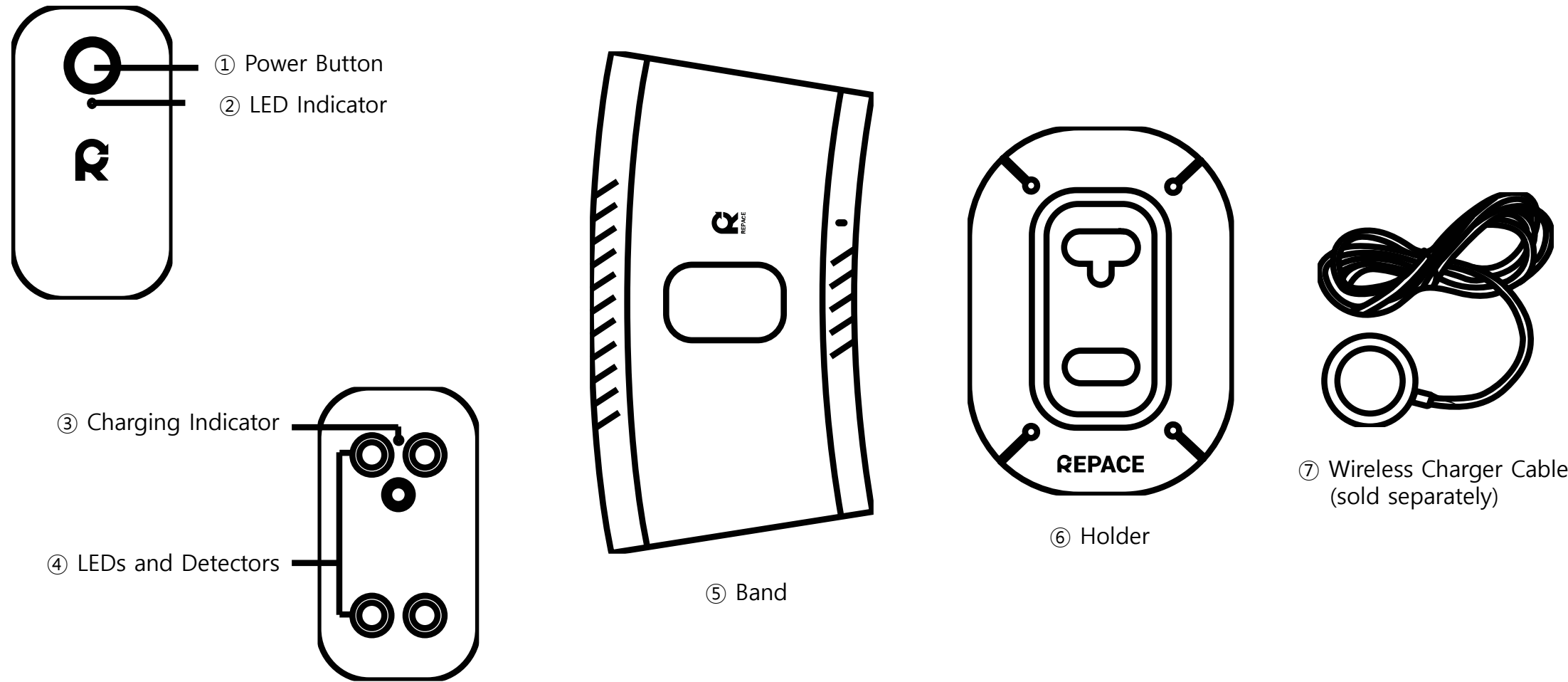

## Device overview

- ① **REPACE Power Button** : A long press on the power button turns the REPACE ON/OFF.
- ② **REPACE LED Indicator** :
  - A solid green light indicates the REPACE is ON but not paired to any device.
  - A solid blue light indicates it is paired and not recording.
  - A blinking blue light indicates the data is recording.
  - A blinking green light indicates the data is being recorded without bluetooth connection.
- ③ **REPACE Charging Indicator** :
  - A red light indicates the REPACE is charging.
  - An orange light indicates the REPACE is charged up to 80% and charging.
  - A green light indicates the REPACE is charged up to 90% and charging.
- ④ **REPACE LEDs and Detectors** : The LEDs and Detectors are used to measure muscle oxygensaturation.
- ⑤ **Band** : The band is used to wear REPACE on your thigh.
- ⑥ **Holder** : The holder is used to attach REPACE with the band.
- ⑦ **Wireless Charger Cable** : The wireless charger cable is used to charge the REPACE.

# How to wear REPACE

The REPACE is designed to be worn on your right thigh.

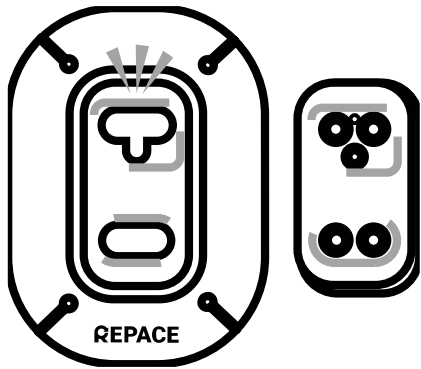

1. Insert the REPACE into the holder according to the shape of the sensor holes.

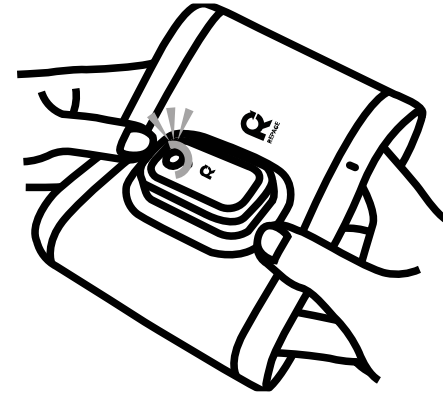
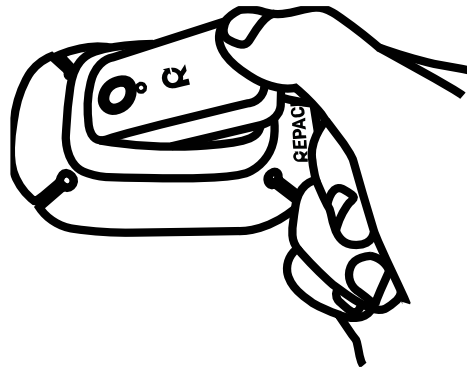

2. Insert it into the band so that the REPACE power button is directing upward.

\* There is no wireless operation during charging.

## How to wear REPACE

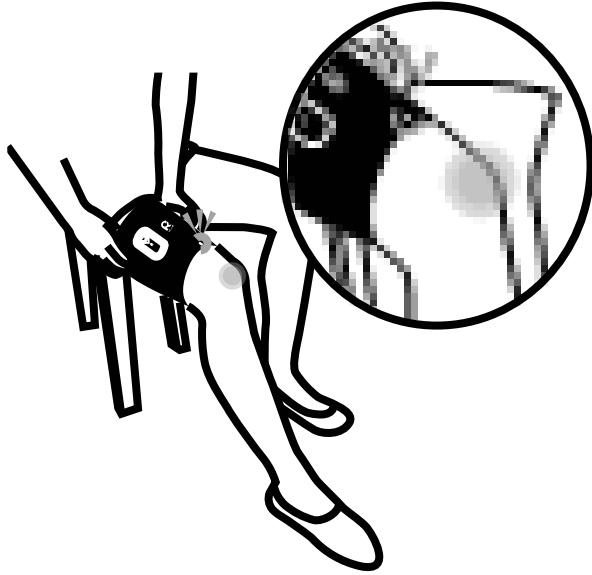

3. Slide the band on your right thigh so that the center mark on the band is placed in the center of your knee.

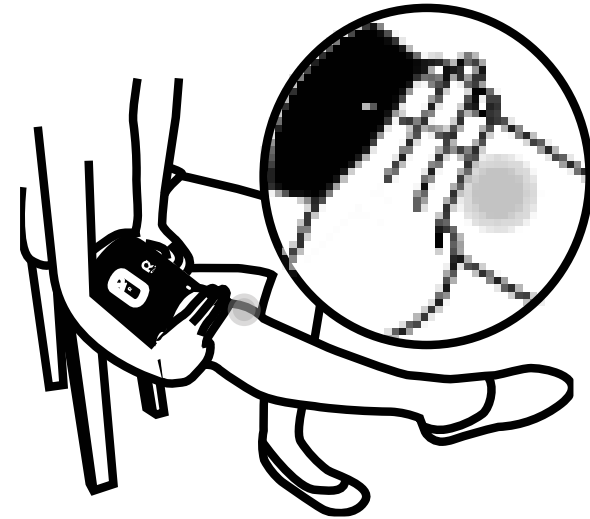

4. Take a seat, straighten your leg, then adjust the band so that the low bottom is placed 10cm (three fingers' width) above your knee cap.

## Charging the REPACÉ

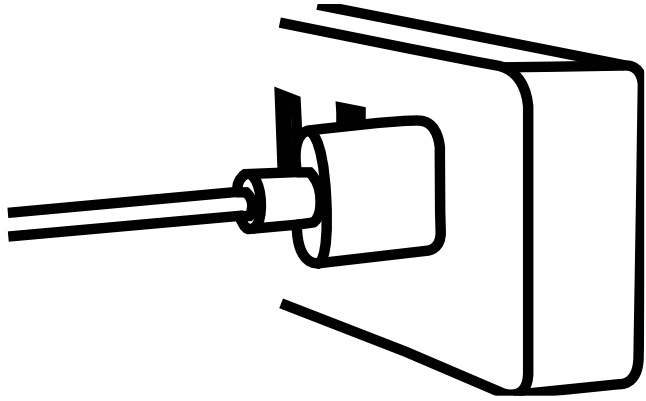

1. Plug the USB cable into your computer or USB charging adaptor.

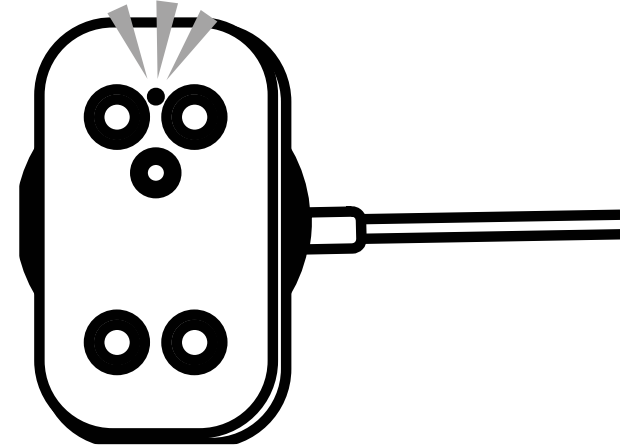

2. Place the turned off REPACÉ on the wireless charger upside down so that the detectors are facing upright.

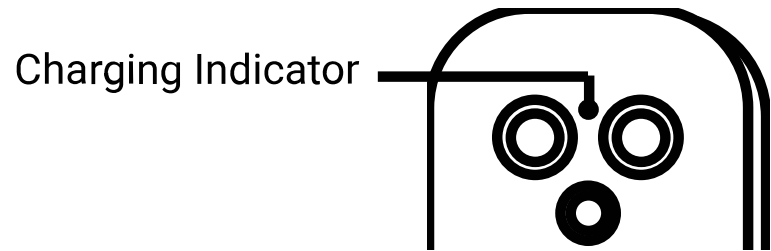

3. REPACÉ charging indicator will show the status of the battery.

## Starting a workout with the REPACE App



1. Download the REPACE App on the Apple App Store or Google Play.

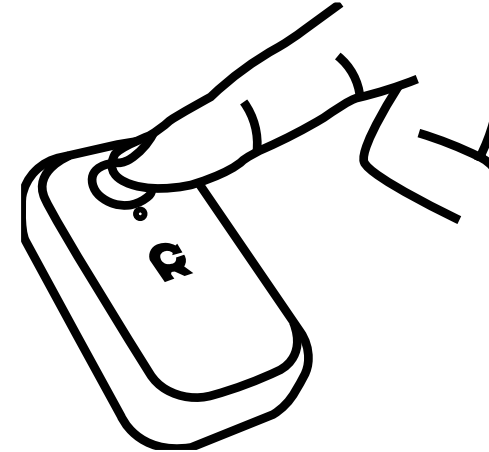

2. Long press the REPACE power button to turn it on. Follow the instructions in the REPACE App to set up a Bluetooth connection and start a workout.



# REPACE App Workouts

## **LT TEST (Lactate Threshold Test)**

· LT TEST takes into account the amount of exercises that you do in your daily life.

The REPACE measures and analyzes SmO2 shown during each LT TEST Stage.

Each Stage consists of 5 minute running which ends automatically when the targeted exercise amount is met.

## **Rx Exercise**

· Low intensity exercise : This is a competency improving exercise that facilitates your general endurance level (low to high-intensity exercise performance).

· High intensity exercise : High intensity exercise improves cardiovascular fitness as measured by maximal oxygen uptake and includes repeated rounds of exercise of maximal heart rate and maximal oxygen uptake.

## **Free Exercise**

· Free Exercise measures SmO2 and track records during your exercise without setting a goal.

# Additional Resources

Please visit our website "**repace.io**" for product information, FAQ, and additional resources.

Specification

Model	RP1-L40A
Product name	REPACE
Rated voltage(Battery)	DC 3.7 V, 300 mAh
Usage time	5 hours
Operating temperature	-20 °C ~ 50 °C
Dimensions	31.4 mm x 56 mm x 15.5 mm
Weight	20 g
Wireless communication	Bluetooth Low Energy 5.0(2.4 GHz), 1 Mbps
Manufacturer	OBELAB Inc. / Made in Korea
Conformity assessment number	KC : R-R-OBE-RP1-L40A FCC ID : 2AHYIRP1 IC : 22565-RP1 TELEC : XXXXX

# Warranty and liability

## Warranty

OBELAB Inc. warrants the quality of this product as set out below.

## Quality Assurance Service

Warranty service is a repair service caused by a device failure during normal use within the warranty period (1 year from the date of purchase).

## Payment service

- ① When the warranty period has expired
- ② Even within the warranty period, in the following cases:
  - Repairs due to natural disasters (lightning, fire, earthquake, typhoon, flood, etc.)
  - Repair of equipment failure or damage caused by user negligence (shock, drop, immersion, etc.)
  - Repairs due to aging and exhaustion of consumables (battery, cable, charger, etc.) requiring replacement
  - Repair of equipment failure due to arbitrary disassembly, repair, modification or tampering
  - Repairs due to unauthorized or imitation parts use
  - Repair of malfunctions caused by service by persons other than authorized personnel or by unauthorized entities
  - In case of failure due to not following the "Cautions" in the user's manual
  - In case the consumer's negligence is found together even if the parts fail within the product warranty period

## Notice

- Matters not specified in this document are governed by the Consumer Protection Act and applicable regulations of the Republic of Korea in connection with consumer compensation. For other repairs and inquiries, please contact your place of purchase or OBELAB Customer Support.
- If service is requested for equipment in normal operation, a service charge will apply.
- For any inconveniences related to the service, please contact the place of purchase or OBELAB Customer Support.

## Product A/S

repace@obelab.com

2021 OBELAB Inc. | Republic of Korea



**FCC (Federal Communications Commission)**

This equipment has been tested and found to comply with limits for a Class B digital device, pursuant to Part 15 of the FCC Rules. These limits are residential installation. This equipment generates uses and can radiate radio frequency energy and, if not install and use in accordance with the instructions, may cause harmful interference to radio communications.

However, there is no guarantee that interference will not occur in a particular installation. If this equipment dose cause harmful interference to radio or television reception , which can be determined by turning the equipment off and on, the user is encouraged to try to correct the interference by one or more of the following measures:

Reorient or relocate the receiving antenna.

Increase the separation between the equipment and receiver.

Connect the equipment into an outlet in a circuit different from that to which the receiver is connected.

Consult the dealer or an experienced radio/ TV technical for help.

**WARNING:** this equipment may generate or use radio frequency energy. Changes or modifications or this equipment may cause harmful interference unless the modifications are expressly approved in the instruction manual. The user could lose the authority to operate this equipment if an unauthorized change or modification is made.

This device complies with Par 15 of the FCC’s Rules. Operation is subject to the following two Conditions:

- 1.This device may not cause harmful interference, and
- 2.This device must accept interference received, interference received, including interference that may cause undesirable operation.

**Warning**

To comply with FCC RF exposure requirements, a minimum separation distance of 10 mm must be maintained between the human body and the radiator of device.

**Canadian Compliance**

This device complies with Industry Canada license-exempt RSS standard(s). Operation is subject to the following two conditions:

- (1)this device may not cause interference, and
- (2)this device must accept any interference, including interference that may cause undesired operation of the device.

Le présent appareil est conforme aux CNR d'Industrie Canada applicables aux appareils radio exempts de licence.

L'exploitation est autorisée aux deux conditions suivantes :

- (1)l'appareil ne doit pas produire de brouillage, et
- (2)l'utilisateur de l'appareil doit accepter tout brouillage radioélectrique subi, même si le brouillage est susceptible d'en compromettre le fonctionnement.

**RF Exposure statement**

This device complies with RF exposure requirement.

**Déclaration d'exposition RF**

Cet appareil est conforme à l'exigence d'exposition RF.

**Warning**

To comply with IC RF exposure requirements, a minimum separation distance of 10 mm must be maintained between the human body and the radiator of device.

**Warning**

Pour se conformer aux exigences d'exposition RF de la IC, une distance de séparation minimale de 10 mm doit être respectée entre la humaine et le radiateur de l'appareil.