

Electronic Lock for Entrance Door

Pocket Key

※Be sure to check before using the product.

- This Pocket Key is an electronic key for the locking and unlocking of the Smart Control Key Pocket Key. Always use in conjunction with the Smart Control Key Pocket Key. The electronic key of other electric lock can not be used.
- To secure the safety, be sure to lock/unlock with Built-in Key for Emergency, before starting to use.
- To secure the security, an owner should register Pocket Key by himself/herself.

Read this Manual and Caution Label on the product carefully for proper and safe use. Keep this Manual in a safe place for future reference.

For Owner

Preservation
Version

To Distributor or Builder

Provide this Manual to an owner after the construction is completed.



CONTENTS



Read This First.	P.1
Instructions for Safe Use	P.2
What is Pocket Key?	P.4
Preparation (Before Start Using the Product)	P.5
Battery Change of Pocket Key	P.6
How to Lock/Unlock with Pocket Key	P.7
Function	P.8
Specification	P.9
FCC satisfication	P.10
Care/Maintenance	P.11
Troubleshooting	P.12
Product Warranty	P.13

Dear Valued Customer

● Safety Symbol

The symbol shows the contents you should follow to prevent accident causing injury or death, and property damage. Make sure to fully understand the contents before using the product.

Symbol	Meaning
 Warning	This symbol indicates that improper handling may result in serious injury or death of the user.
 Caution	This symbol indicates that improper handling may result in injury of the user and/or physical damage.
Attention	This symbol indicates that disobeying of the instruction may result in injury of the user and/or physical damage.

Symbol	Meaning
	┌ This symbol indicates that you must do.
	┌ This symbol indicates that you must NOT do.

Other Symbol

 Read	┌ This symbol indicates that you should read before use.
--	--

2 Instructions for Safe Use



- ❗ If you use a medical electrical equipment consult your doctor or a manufacturer of your medical equipment for the influence of radio waves. The radio wave may influence a medical electrical equipment.

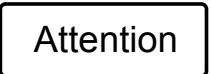

- Pocket Key, Card Key and Round Tag Key are electronic parts. Do not drop or give them a shock, for example, by crouching/sitting with a key in a pocket. It may cause malfunction.
- Pocket Key, Card Key and Round Tag Key are electronic parts. Do not wash or use with wet hands. It may cause malfunction. Be careful not to pour water on electric components on a door. Do not use in the area where a special gas is generated as hot spring, or in the area with high humidity.
- Put the battery in correct direction.
- Do not use wet battery.



- This product is an electric product and is a precision equipment. Carry Pocket Key equipped with Built-in Key in case of emergency, for example, running out of the power or malfunction or failure of the product.
- Pocket Key has "misplacement prevention function(See P.8)".
It cannot be operated by Handle Button when Pocket Key completely stop moving.
When Pocket Key is used with a little swing, the movement is detected and it functions.
- Pocket Key has "misplacement prevention function," but do not place/keep Pocket Key within 2.5m from the door, for security reasons.
- The operation range of unlocking/locking by button on Pocket key is within 3m for outside but it may vary depending on the radio wave environment near the entrance door (for example, installation of a security camera).
- When Pocket Key is used in a bag, it cannot be used depending on the material of the bag.
example) attach case made by metal
cooler bag using aluminum sheet
bag that metallic fiber is woven
- When Pocket Key is put into a bag or pocket, it may be unlocked accidentally.
example) Unlock button is pressed by key case.
Unlock button is pressed in a pocket when the user crouches.
- The battery equipped in Pocket key is for testing purpose.
The battery may be low. See P.6 if the battery replacement is required.

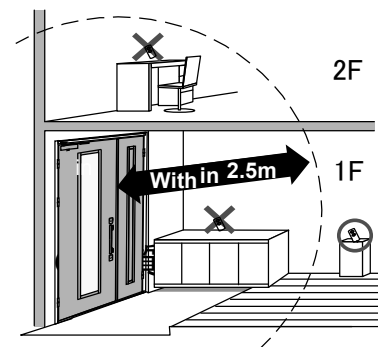

What is Pocket Key?

- This Pocket Key is an electronic key for the locking and unlocking of the Smart Control Key Pocket Key. Always use in conjunction with the Smart Control Key Pocket Key.
- This product can be locked/unlocked by pushing button on Outside Handle when you carry Pocket Key in your bag, pocket etc.
- It can be locked/unlocked by pushing Lock/Unlock button on Pocket Key.
- If Pocket Key, Card Key and Round Tag Key have damage or malfunction, it can be locked/unlocked by Built-in Key and Mechanical Key.
- Pocket Key has different operation range for each operation method.
※The operation range may vary depending on the installation environment.

【 Operation of Handle Button】

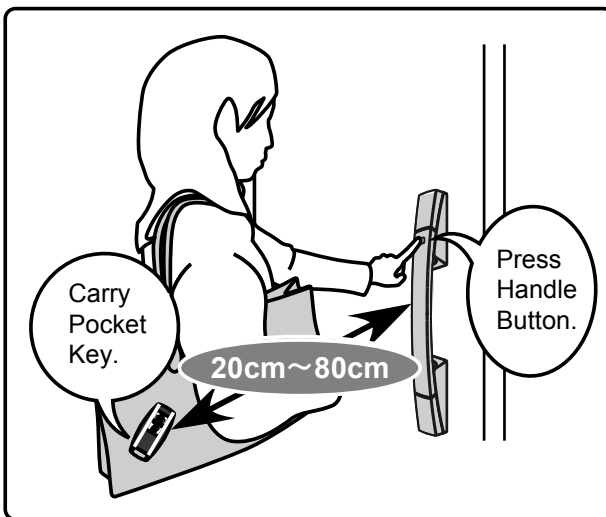

【 Operation of Pocket Key】

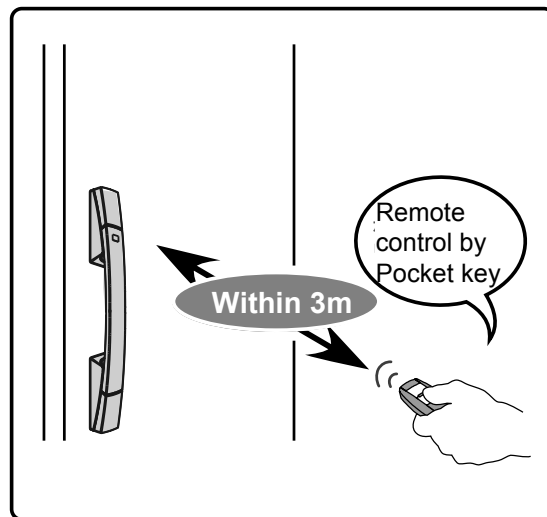

■ Registration of Pocket key

Pocket key can be registered continuously.
Register all keys during the registration mode.

● Registration Procedure for Pocket key

① Set to Registration Mode

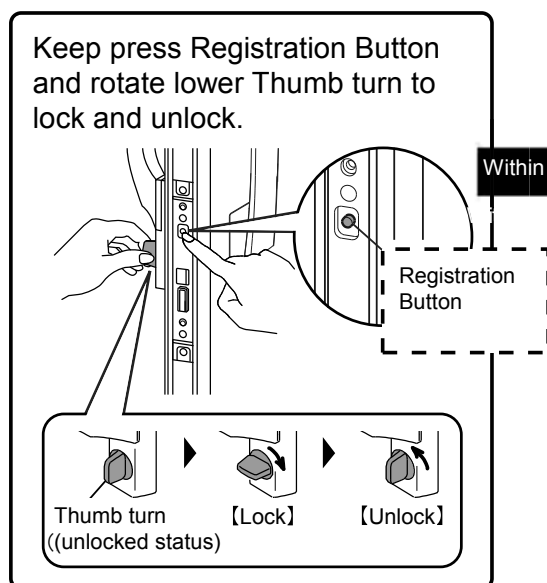

Within 10 seconds

② Register Pocket key

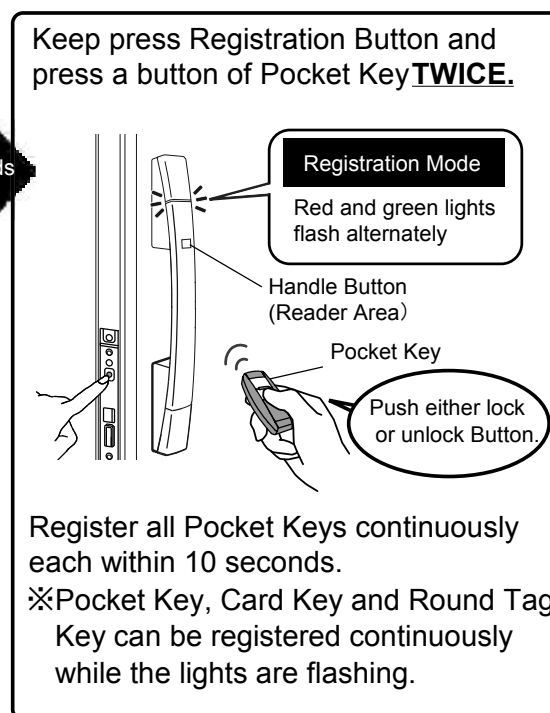

※When the registration is not started within 10 seconds after registration mode is set, red and green lights disappear and the registration mode finishes.

Status	Registration status	Remarks
One long beep sounds and green light flashes once.	Registration is completed.	It can be locked/unlocked by registered Pocket Key.
3 short beeps sound and red light flashes 3 times.	Registration is failed.	<ul style="list-style-type: none"> •The Pocket Key is already registered. •The Pocket Key is 9th Pocket Key to be registered. (Maximum registration: 8 pcs)

● Operation after Registration of Pocket Key

After registration, perform the registration check.

Close the door and check the registration of all Pocket Keys.

Press Lock/Unlock Button on Pocket Key and check that it is locked/unlocked.

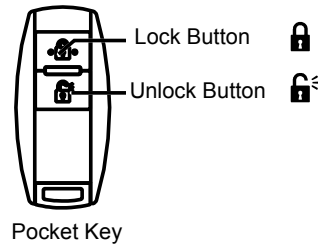

※When there is even 1pc of Pocket Key which cannot lock or unlock, re-register all keys again.

When the battery is low, light and sound notice of Smart Control Key appears be operation. (flashing red light/continuous three short beeps)

Exchange the battery immediately when the notice appears.

When the battery of Pocket Key runs out, it cannot be locked/unlocked by remote control of Pocket Key. On such an occasion, operate using Built-in Key.

The battery for Pocket Key is coin-type lithium battery, CR2032.
It is available at camera shop, electronics store etc.



Battery
CR2032



- Exchange the battery every two years, regardless of whether the battery runs out or not. It may cause malfunction due to liquid spill or corrosion.
- To protect electronic parts, follow the following instructions when the battery is replaced.
- If you are electrostatically-charged during the replacement, circuit board in Pocket Key may be damaged. Touch a metallic substance before replacing the battery and eliminate static electricity. Do not replace the battery with wearing sweater or other cloths which attract static electricity.
- Be careful that children does not swallow the battery or other disassembled parts when the battery is replaced.
- Do not replace with wet or dirty hands.

● How to Change Battery

- ① Take out a screw on the backside of Pocket Key.

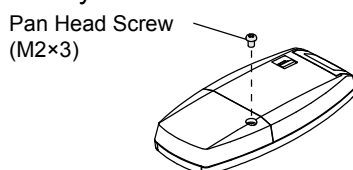

- ③ Remove the old battery and insert a new battery.

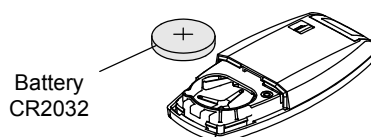

- ② Slide Battery Cover to the arrowed direction.

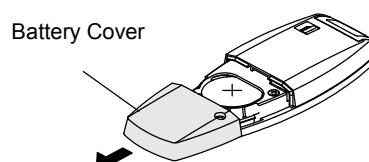

- ④ Close Battery Cover and tighten the screw.

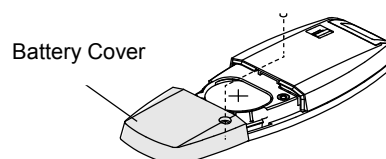

Caution for Battery change

- Do not touch or disassemble circuit board.
- Do not use a metallic substance which conducts electricity when replacing batteries.
- Install the battery with the positive end up.

When you go out (Lock by Handle Button)

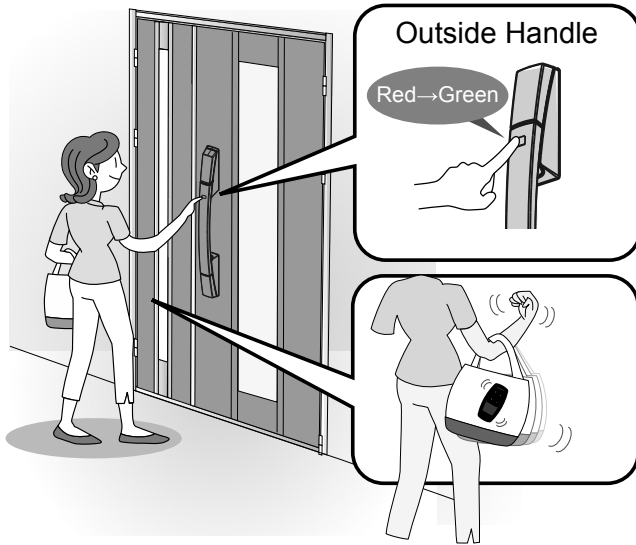

- 1** Carry Pocket key.
Pocket Key should be moving a little in your bag, pocket etc.
- 2** Push Handle Button.
One short beep sounds.
- 3** Pocket Key is recognized
One short beep sounds.
- 4** Both upper and lower locks are locked.
After both locks are locked, short beeps sound and green light turns on for a certain period.

When you go out (Lock by Pocket Key)



- 1** Push Lock button on Pocket Key
Push  button.
One short beep sounds.
- 2** Both upper and lower locks are locked.
After both locks are locked, short beeps sound and green light turns on for a certain period.

※When Pocket Key is put into a bag or pocket, it may be unlocked accidentally.
example) Unlock button is pressed by key case or pressed in a pocket when the user crouches.

When you return home (Unlock by Handle Button)

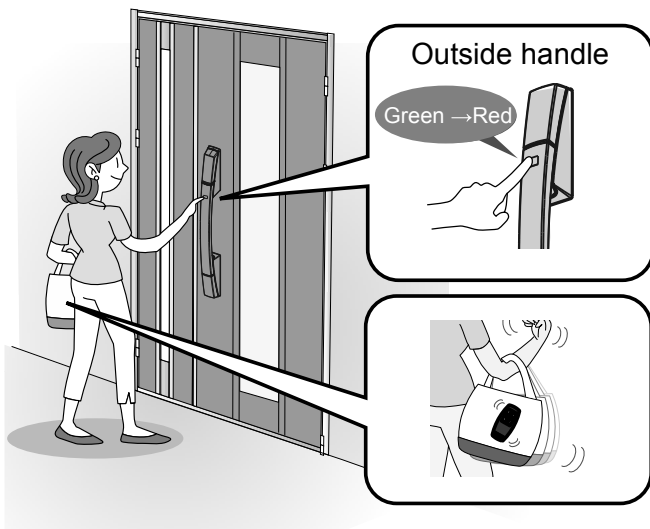

- 1 Carry Pocket key.**
Pocket Key should be moving a little in your bag, pocket etc.
- 2 Push Handle Button.**
One short beep sounds.
- 3 Pocket Key is recognized**
One short beep sounds.
- 4 Both upper and lower locks are unlocked.**
After both locks are unlocked, short beeps sound and red light turns on twice.

It re-locks automatically when the door is kept closed for 25 seconds after being unlocked. (Improper Operation Prevention Function)

When you return home (Unlock by Pocket Key)



- 1 Push Unlock Button on Pocket Key**
Push  button.
One short beep sounds.
- 2 Both upper and lower locks are unlocked.**
After both locks are unlocked, short beeps sound and red light turns on twice.

■ Pocket Key

● Misplacement Prevention Function of Pocket Key

It has "misplacement prevention function of Pocket Key" to prevent unlocking by the operation of Handle Button by a third person.

A few seconds is passed after placing Pocket Key within the communication range(around 2.5m.)



└"Misplacement prevention function of Pocket Key" activates. Continuous short beeps sound as an alarm (and red light flashes) when Handle Button is pressed.



└To reactivate from "misplacement prevention function of Pocket Key," swing Pocket Key while continuous short beeps sound. Or push lock or unlock button on Pocket Key. It can be locked/unlocked.



※It can also be locked/unlocked by operating Card Key/Round Tag Key.

※When it is locked by pushing Lock Button on Pocket Key or using Card Key/Round Tag Key, warning beeps keep sounding and red light keeps flashing after it is locked when other Pocket Key is misplaced.
Swing misplaced Pocket Key.



※When Pocket Key is not activated while warning beeps sound, it cannot be locked/unlocked by the operation of Handle Button temporarily.
Push lock or unlock button on Pocket Key, and lock/unlock.
It can be locked/unlocked by pushing Handle Button.



■Pocket key(remote control)

- | | |
|----------------------------------|---|
| 1 Use battery | button-type battery CR2032 (3V) |
| 2 Battery Life | around two years for 10 operations a day
(Detect function of low battery is equipped.)
※The battery life is when it is operated 50% by remote control,
50% by handle button.
※It varies depending on the used environment and conditions.
※Low battery is noticed on out side handle |
| 3 Classification
of Radio Act | weak(Japan Radio Act) |
| 4 Use Frequency | receiving radio wave (RF signal) 315MHz
transmitting radio wave (LF signal) 125kHz |
| 5 Operable Temperature | 0℃～50℃ |
| 6 Storage Temperature | －10℃～60℃ |

■Communication ability of Pocket Key

- | | |
|------------------------|--|
| Communication Distance | Handle Button operation: around 20～80cm
remote control operation: within around 3m
※distance from outside handle
※The range varies depending on external environment. |
|------------------------|--|

FCCID

This device complies with part 15 of the FCC Rules. Operation is subject to the following two conditions:

- (1) This device may not cause harmful interference, and
- (2) this device must accept any interference received, including interference that may cause undesired operation.

FCC CAUTION

Changes or modifications not expressly approved by the party responsible for compliance could void the user's authority to operate the equipment.

Note:

This equipment has been tested and found to comply with the limits for a Class B digital device, pursuant to part 15 of the FCC Rules. These limits are designed to provide reasonable protection against harmful interference in a residential installation. This equipment generates, uses and can radiate radio frequency energy and, if not installed and used in accordance with the instructions, may cause harmful interference to radio communications. However, there is no guarantee that interference will not occur in a particular installation. If this equipment does cause harmful interference to radio or television reception, which can be determined by turning the equipment off and on, the user is encouraged to try to correct the interference by one or more of the following measures:

- Reorient or relocate the receiving antenna.
- Increase the separation between the equipment and receiver.
- Connect the equipment into an outlet on a circuit different from that to which the receiver is connected.
- Consult the dealer or an experienced radio/TV technician for help.

It is important to clean/care frequently with the appropriate methods for each material.

If it is kept without care/cleanup, the dirt on the surface may cause stain, rust or corrosion.

When it gets dirt or stain, remove it promptly. Removing/Caring dirt or stain promptly is the best way to have longer life. Care frequently especially in coastline or heavy traffic area as it gets dirty or stain quickly with salt or exhaust gas.

Read

- Never use wire wool or hard scrubbing brush. It may damage the product. Do not use thinner, benzene, acetone and other solvents. Never use chlorine chemicals. (bleach/mold removers)



<For Product with Electric Operation>

- Be careful not to get electronic parts wet during cleaning. It may cause malfunction. When the electronic parts have malfunction, consult to construction company, builder, or dealer.

● Aluminum Product/Steel Product/Plastic Product

Read

■ Plastic Product

【 Attention to Chemical】

- Do not use organic solvent. When organic solvent is attached on the plastic surface, crack or peeling may occur.
When chlorine-based chemical (including bleach or mold removers with sodium hypochlorite) is attached and kept on the plastic surface, the surface color may be changed.
Wash off immediately when it is attached on the surface.

【 Attention to Heat】

- Do not put stove, iron, and other heat source close to the product.
It may be transformed when the heat source is close to or touched.

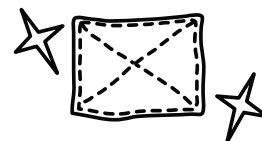
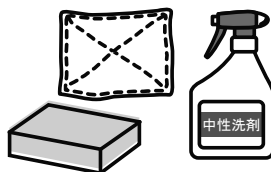
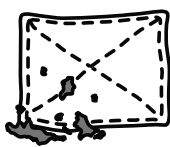

① Dip soft cloth in water and wash dust or sand off.

② Wipe the whole body with wet soft cloth or sponge.
※ Use diluted neutral detergent (water solution of 1~2%) for tough dust/stain.

③ Wipe up water thoroughly with dry cloth.

■ Check when Malfunction is Suspected.

Pocket Key

Status	Possible cause	Please check.	Page
It does not function at all. Locking/Unlocking lights in red and green does not turn on.	The power is not supplied to the product due to running out of the battery etc.	Change all batteries to new ones.	
	The battery is not installed.	Install the battery.	
	The direction of the battery is not correct.	Put the battery in correct direction.	
It does not work by pushing Lock/Unlock Button on Pocket Key or Handle Button.	Pocket key is not within operation range.	Check Pocket Key.	
	The battery of Pocket Key runs out.	Change to new lithium battery(CR2032).	
	Pocket Key is not registered.	Register Pocket Key.	
It does not work when Handle Button is pressed.	Misplacement prevention function of Pocket Key is activated and it does not work for temporarily.	Push Lock/Unlock Button on Pocket Key within operation range, 3m. Then push Handle Button and check the operation.	
	When Pocket Key is registered to 2 or more doors, Pocket Key is not registered in the same order.	Register Pocket Key to each door in the same order again.	
It is not locked/unlocked by key or thumb turn.	The power is off during the operation due to running out of the battery etc.	Operate according to "When the battery runs out."	
It is not locked by pressing Handle Button or Lock. (The sound of motor movement appears, and after a few seconds, 5 short beeps sound. Red/Green lights flash on Outside Handle.)	It is operated when the door is not fully closed and the deadbolt stops in the middle.	Check that the door is fully closed. Then check the operation by Handle Button or remote control operation. ※When it is not locked by thumb turn, adjustment of strike and a door closer is required.	
The operation range of Pocket Key becomes narrow, 3 short beeps sound, and red light on Handle flashes.	The battery of Pocket Key is running out.	Change to new lithium battery(CR2032).	
It is not locked/unlocked by Handle Button even you carry Pocket Key, short beeps sound continuously and misplacement prevention function is activated.	The movement is not transferred to Pocket Key and it is judged as static.(misplacement)	Swing Pocket Key.	
	Another Pocket Key is kept/ misplaced near Handle.	Check that other Pocket key is placed within operation range. Or wait 10 seconds until the warning beeps disappear. Invalid other Pocket Keys and lock again.	

Warranty Period

Two years from the handover date of the product from a construction company (Note1, Note2).
(one year for electric parts) 10 years for rainwater inflow from the product

Note 1: For renovation, the date when the construction of the renovated area is completed.

Note 2: For house built for sales(ready-built house) and condominium apartment,
the handover date to an owner

Warranted Contents

The defect occurs within the warranty period, when it is properly used according to operation manual, label on product or other cautions, free repair is provided except the following exemption clause. The rain water is collected in the bottom frame of sash when it rains with strong wind. This is a feature of a product and is not a defect. The rainwater inflow which is judged as a defect is that the rainwater comes out from the sash and goes into the room.

Exemption Clause

The following case is a paid repair even within the warranty period.

- ①defect caused by processing, assembling, construction, control, maintenance etc. by a third party which is not arranged by us (example: corrosion caused by mortar using sea sand or accelerator change in color or corrosion caused by using cleaning agent which is not neutral detergent, change in color or corrosion caused by cushioning defect during construction)
- ②defect caused by installation at the area where the higher ability is required than the described specification of the product
- ③defect caused by the transformation of building frame or other defects which is not occurred at the product
- ④aging change(abrasion or wastage by using) or aged deterioration (transformation or change in color of plastic parts) of the product or parts, and rust, mold or other defects caused by the aging change or aged deterioration.
- ⑤dew condensation, corrosion or other defects caused by the natural environment or housing conditions around the product.
- ⑥phenomenon associated with the material feature of product or parts
- ⑦defect caused by natural disaster and other force majeure (example: storm wind/heavy rain/tidal)
- ⑧phenomenon unpredictable by the technology which is in practical use, and defect caused by it
- ⑨defect caused by dog, cat, bird, mouse and other animals and damage from wood borer and other insects
- ⑩defect caused by improper operation, failure in adjustment, and improper maintenance/control after the handover
- ⑪defect caused by assembling/installation/modification/remodeling(including disassembling of necessary parts) by an owner/user
- ⑫defect when it is not used for intended purpose or defect when it is not used in the way for intended purpose
- ⑬defect or damage caused by crime and illegal action

* After the warranty period, we charge for repair and replacement.