



CarMinder

## CarMinder Bluetooth Car Kit

### USER MANUAL

#### Product features

Important Notice: in order for the CarMinder to work properly you must check that when you switch the car on than you have electric power in the cigarette lighter socket, and when you turn the car off the power close. (if it is not working this way than an easy action need to be made by car service).

#### How to use CarMinder

1. Place the CarMinder device in the cigarette charger and switch on the car switch.
2. CarMinder active, choose your language by long press OK .(can't choose language when Bluetooth connected to the device)
3. The CarMinder device now ready to work, While switch ON the car you will receive a Voice message that CarMinder is ON and if you have Smartphone than follow the instruction how to use the Smartphone together with the free app "CarMinder".

- \*. Pair with CarMinder:  
On your mobile phone active Bluetooth and

#### CarMinder

#### "Small Device Huge Help"

"You can forget where you left your car keys or your glasses. But no one imagines a scenario in which one for gets the most important possession of all: your baby. so that even with your baby out of sight in the backseat, you'll never let your baby down."

With the CarMinder app and CarMinder device , You can receive 2 alert if use with Smartphone. the CarMinder device is independent and will start work Automatically while car switch On/Off. No need to charge just plug it.

CarMinder is also a hand free Bluetooth speaker so you can use it to receive a phone call.

search CarMinder device name . choose CarMinder. than device will connect. Open the CarMinder App. remember the code for the APP is: 1965. The CarMinder app will search for Bluetooth device please choose CarMinder. and setup the App function.

- \*. Emergency contact :  
you can choose a contact to add, if you didn't confirm the message that appear on your mobile after you walk out from the car and the Bluetooth disconnect from CarMinder, this contact will receive an SMS message and call, if you choose it in the setting. After you done configure all setting on the App than you press ENABLE, and the APP will work on the background.

#### Song switch up and down

1. Press the volume + to choose next song
2. Press the volume - to choose last song.

#### To Adjust Volume of Headset

1. Press and hold the volume + key to increase volume
2. Press and hold the volume - key to reduce the volume.

#### Buttons

1. Volume: use + - to adjust the volume of the device, the volume of the voice alert is fixed and can't change.
  2. Answer and hang a call – press the answer button to answer and to reject or hang the call.
- USB- 2 USB port for charging devices.

#### To Answer a Call

1. According to the answer key on the phone.
2. Press the call button on the carminder.

#### To End a Call

1. According to the hang up button on the phone.
2. Press the call button on the carminder.

#### To Reject a Call

1. According to the hang up button on the phone.
2. When the phone rings continue to hold the carminder on the call button for about 1 second.

#### To Make a Call

1. Use the phone keyboard input call number and then click the call button, the call is automatically transferred to the carminder.

#### To Redial the last Called Number

1. In standby mode click carminder call for about 2 seconds to loosen.

#### CarMinder Buttons

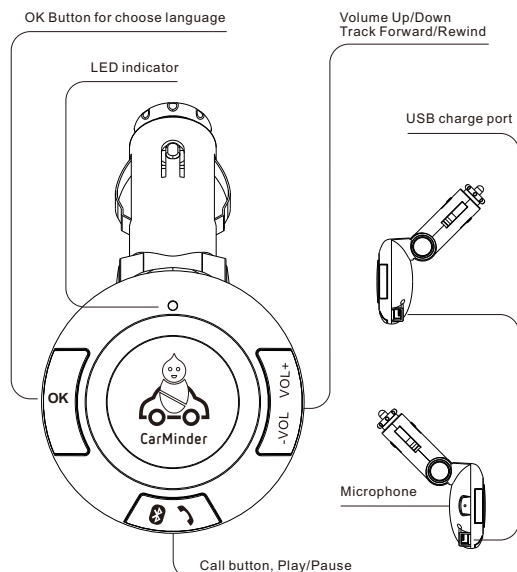

#### Techhical parameters

- Rated operating voltage: 12-24V
- Speaker: Ø36 8Ω1W 5.0H
- USB Output: (5V/2.4A)\*2
- Working Temp.: 0~80 degrees Celsius
- SNR: >60dB
- Distortion: <0.1%
- Frequency Response: 20Hz-15Khz
- Left and right channel separation: >60dB
- Bluetooth Version: 4.0
- Sound processing: A2DP (Advance Audio Distribution Profile)
- Bluetooth transmission distance: 10M
- Bluetooth microphone effective range: 0.5~2M

#### FCC Statement

This equipment has been tested and found to comply with the limits for a Class B digital device, pursuant to part 15 of the FCC Rules. These limits are designed to provide reasonable protection against harmful interference in a residential installation. This equipment generates, uses and can radiate radio frequency energy and, if not installed and used in accordance with the instructions, may cause harmful interference to radio communications. However, there is no guarantee that interference will not occur in a particular installation. If this equipment does cause harmful interference to radio or television reception, which can be determined by turning the equipment off and on, the user is encouraged to try to correct the interference by one or more of the following measures:

- Reorient or relocate the receiving antenna.
- Increase the separation between the equipment and receiver.
- Connect the equipment into an outlet on a circuit different from that to which the receiver is connected.
- Consult the dealer or an experienced radio/TV technician for help.

#### Caution:

Any changes or modifications to this device not explicitly approved by manufacturer could void your authority to operate this equipment. This device complies with part 15 of the FCC Rules. Operation is subject to the following two conditions:

- (1) This device may not cause harmful interference.
- (2) this device must accept any interference received, including interference that may cause undesired operation.

These device has been evaluated to meet general RF exposure requirement. The device can be used in portable exposure condition without restriction.



CarMinder

CarMinder  
"Small Device Huge Help"

please visit us on: [www.carminder.co](http://www.carminder.co)  
Support contact: [support@carminder.co](mailto:support@carminder.co)