

***MUSTANG***

QUICK START

**REDISCOVER  
CYCLING**



## COMPANY PROFILE

Speedx is a company which focus on creating high-end intelligent motion bicycle's technology, develop the first intelligent motion bicycle, intelligent control, and the wild rider's community APP products in the world, create the cycling sports brand with the most scientific and technological sense.

Speedx team converge the world's top creative talents, industry background, covering top sports bike, Internet, electronic technology, strategic marketing, and other fields; has more than 20 years of experience in bicycle research, development, production and sale. Within more than a year after establishment, Speedx has obtained nearly one hundred million yuan of financing from Xiaoping Xu, Dr. Lee and Jinding Fund, become the fastest growing company of the intelligent hardware enterprises.

"Only love and health can't be disappointed", we hope to put our heart to develop the products, passed healthy concept to more people, let ridding to be a lifestyle.

## TIPS

This manual is designed for you to quickly install and use, please be sure to read the quick start guide, and keep it safe, ensure that can be read at any time.

You can log in website [SPEEDX.COM](http://SPEEDX.COM) to check out the video of opening the box. Please read "Bicycle manual " to get more help.

This product's features and contents are limited to the buyers of the product to use, others can't reproduce, transfer, copy, store by scanning to other people, or other purposes.

The texts and pictures which expressed in the product are only as supplementary explanations, not as trademarks to use. The intellectual property of original commodity trademarks is still hold by former oblige.

This manual copyright belongs to Beijing Speedx. Without Speedx official authorization in written, any part of this manual can't be copied, transmitted, paraphrased, stored in a retrieval system, or translated into any language in any way.

All contents in this manual are carefully check, if there is any error or omission, please respond to us.

Speedx reserves the final interpretation of this manual.

**Unpacking  
Operation**

# STEP 1

## Open carton box

1. Put up the carton box follow the arrow direction, and open the carton.
2. Take out the blocks from the carton box.
3. Take out the fitting box, check out items in the box.

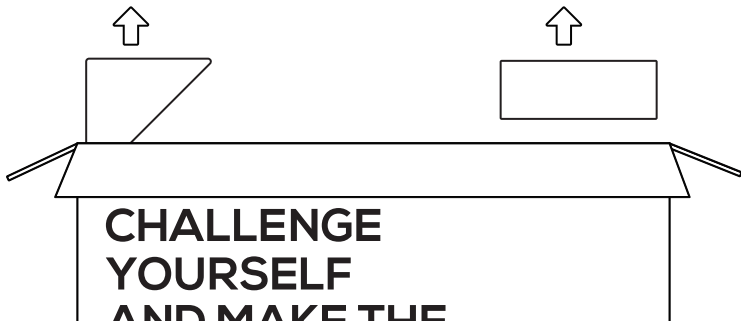
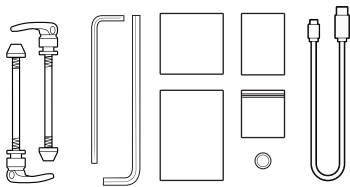

# STEP 2

## Take out the bicycle

1. Take out the bicycle from the carton box and clip front fork in cartons box.
2. Untie the bundled bicycle cushion and Velcro and blocks of front tire and handlebar, and disassemble the rest protective films.
3. Turn on the front fork to the right direction and check out the appearance of the bicycle.

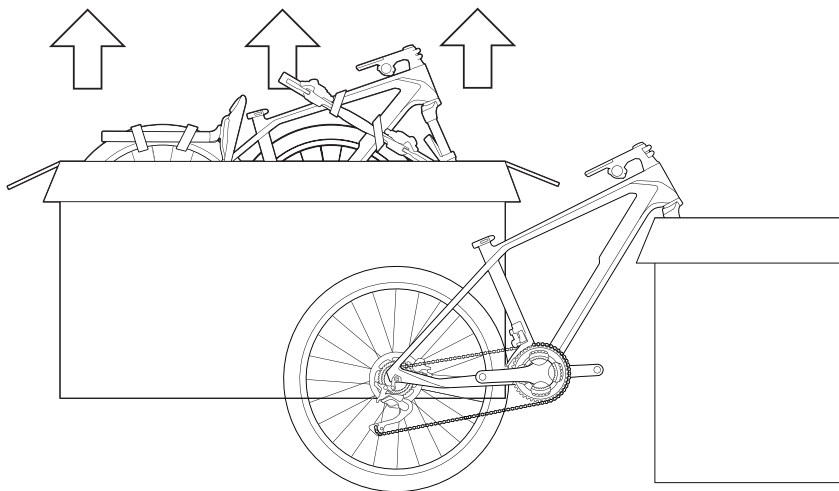

# STEP 3

## Install front wheel

1. Disassemble the protective sheets and the protective bar of the front fork, turn on the front fork to the right direction.
2. Keep the front tire's bearing and the back tire's bearing to the same direction, put the front wheel's bearing into the front wheel. (Front wheel need to be the center of the front fork without deviation).
3. Take out the front wheel quick release lever from the fitting box, unscrew the nut and spring of quick-release lever on the same side.
4. Take the quick release from the left to the right of the bicycle's forward direction, insert the spring, tighten the quick release nut.
5. Tighten the front quick release to a security angle.

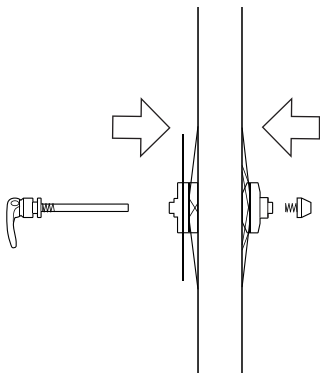
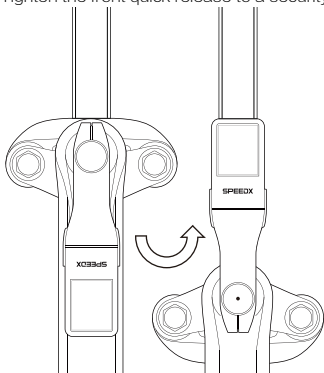

# STEP 4

## Install handlebar

1. Take out the headset Stem's lower cap, put the handlebar to the headset Stem and align the center graduated line, screw four screws into the screw hole, slightly fixed, align headset Stem to the graduated line of handlebar.
2. Adjust the handlebar's angle, align headset Stem's "0" graduated line to handlebar's "0" graduated line. Also you can adjust this by yourself according your comfort.
3. Diagonally screw the four screws, lock and adjust the handlebar to the right direction.

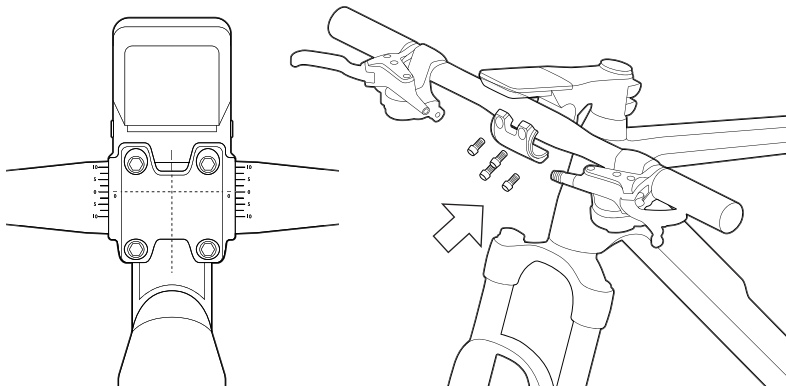



# STEP 5

## Install seat tube

1. Connect the power cord inside the seat tube with the power cord inside the frame tube and insert those to the card slot. Please check out whether the intelligent
2. control open normally and the taillight light up normally.
3. Smear the specials lubricant for carbon fiber on the sat tube, insert the seat tube to the frame tube.

Adjust the seat tube height to fit the individual height scale. Lock the seat tube' s screw tighten.

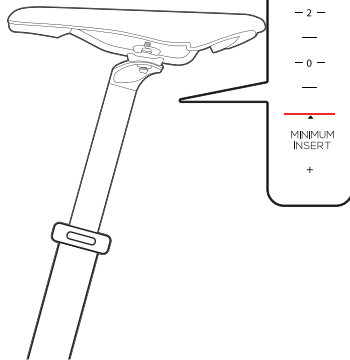
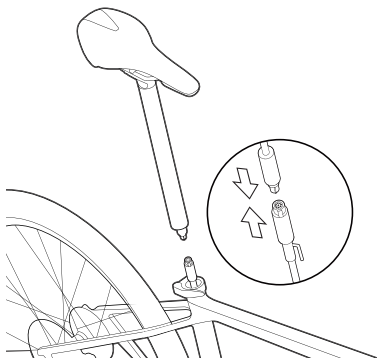

# STEP 6

## Install pedal

1. Distinguish the direction between left and right of the pedal R = Right L = Left.
2. Lock the pedal into the crank with a M6 inner hexagon and rotate pedal with front direction.
3. Until all the pedal is locked into the tooth pattern, force slowly to lock the pedal tighten.

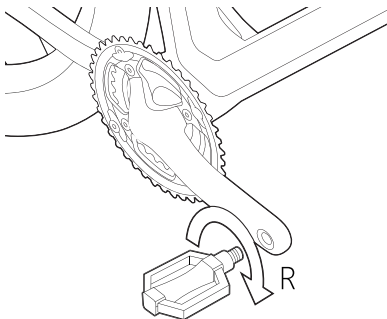

# STEP 7

## Install speed induction magnet

Insert the speed induction magnet into the hexagonal hole on the left pedal.

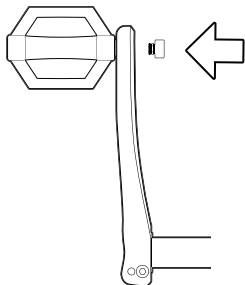

# STEP 8

## Pump up tire

1. Based on rider's weight and riding environment, pump up the tire's pressure value to 100PSI at least.(Refer the tire's pressure value to 100-145PSI/7.0-10BAR).
2. Tighten inner tube's gas nozzle, and lock tighten the gas nozzle cap to the gas nozzle.

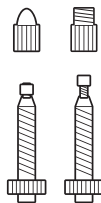
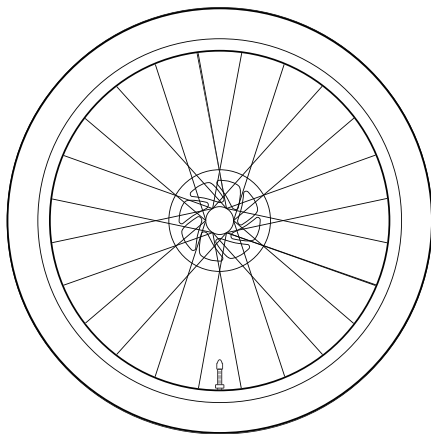

**Intelligent control  
instruction**

## Power on and Standby

1. Power on: When the seat tube wire is connected, the intelligent control is automatically activated.
2. Standby: After stop riding 5 minutes, the intelligent control will automatically be standby.
3. Wake-up: When press the primary key or detect motion, the intelligent control will be awakened, and can recover the values before standby.

## Charge Battery

1. open the waterproof rubber cap below the seat tube' s taillight, insert the charging cable into the slot.
2. When charge the battery, taillight flashes. When the battery is fully charged, the taillight normally lights.

## Key Description

1. Primary key: switch pages, pause or end riding.
2. Left key: turn the page on, connect ANT + devices.
3. Right key: turn over the page, connect APP.

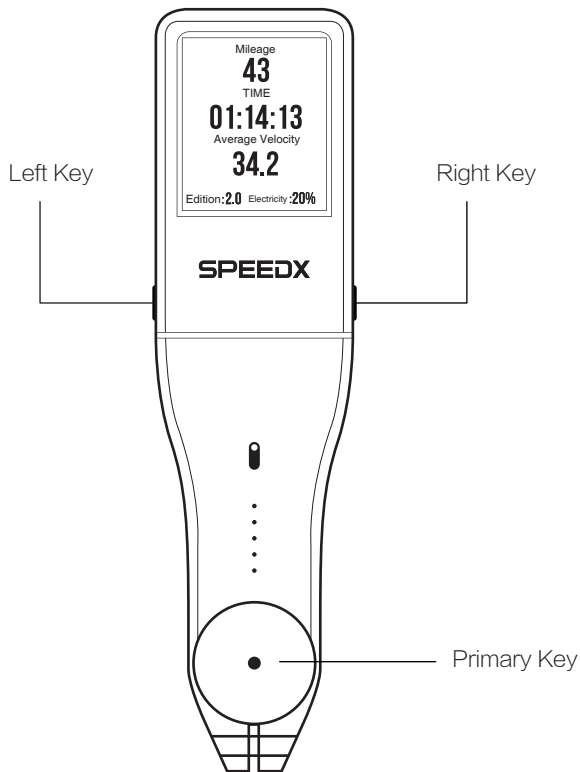

## Began to use

1. Tear off sticker in the control screen

After tear off sticker, please retain the protective film underneath the sticker, prevent the screen away from being scratched.

2. Install the “Beast riding” APP on your phone (two-dimensional code)

Scan the right two-dimensional code or log in [SPEEDX.COM](http://SPEEDX.COM) / APP. HTML to download, support Android 4.4 and iOS 8.0 or more advanced systems, support BLE (Bluetooth 4.0).

3. Connect the intelligent control and mobile phone

Connect your phone for the first time

Press the intelligent control’ s right key for a long time, the intelligent control will go to wait for matching state, open the Bluetooth of mobile phone and start the “Beast riding” APP, to find personal home page, go into “My hardware” page, select “intelligent vehicle” , wait a minute and connection will be successful.

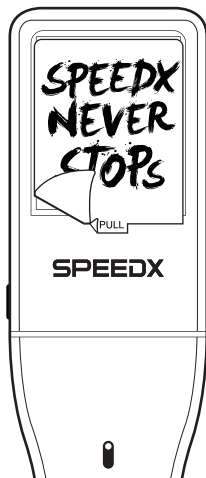

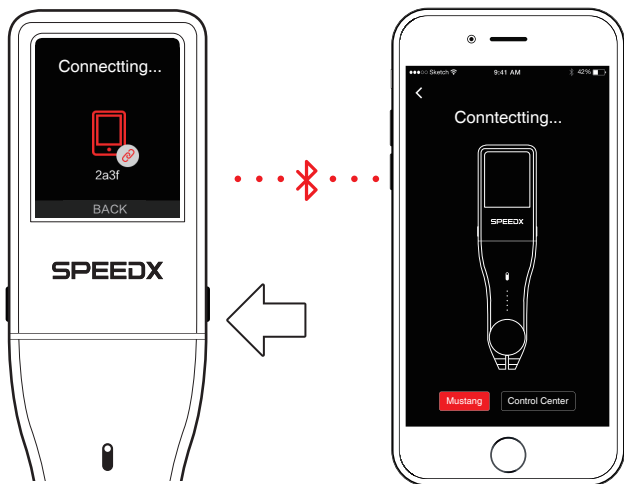

## language setting

After successful connection, click “setting” on the upper right corner, select the language which you need, save and return.

## Unit setting

After successful connection, click “setting” on the upper right corner, select the mileage unit (km / mile), save and return.



## Riding Record

### Start riding

First press the primary key for a long time to enter the reset page, as the installation process will produce displacement. Again press the primary key for a long time to clear the current riding data, and start a new riding.

### Pause riding

In the riding process, press the primary key for a long time to enter the riding pause state. Press the primary key shortly again, the record will be continued.

When you stop riding, the intelligent control will automatically enter a riding pause state. When driving signal input again, the intelligent control will start automatically.

### End riding and synchronize riding data

The mode of ending riding record by the intelligent control: after press the primary key for a long time to enter reset page, press the primary key for a long time again to end the riding record.

The mode of ending riding record by APP: on the riding state, open the beast APP, into “my intelligent control” page and the current riding data will be displayed, click the “End riding and Synchronize riding data”, and the riding will be ended, the riding data will be synchronized.

### Restart intelligent control

Tap the small hole behind the intelligent control with a pin, the intelligent control will be restarted.

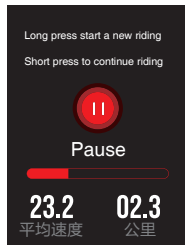

# Check bicycle

After successfully assembled, please check out bicycle. Start your MUSTANG riding trip.

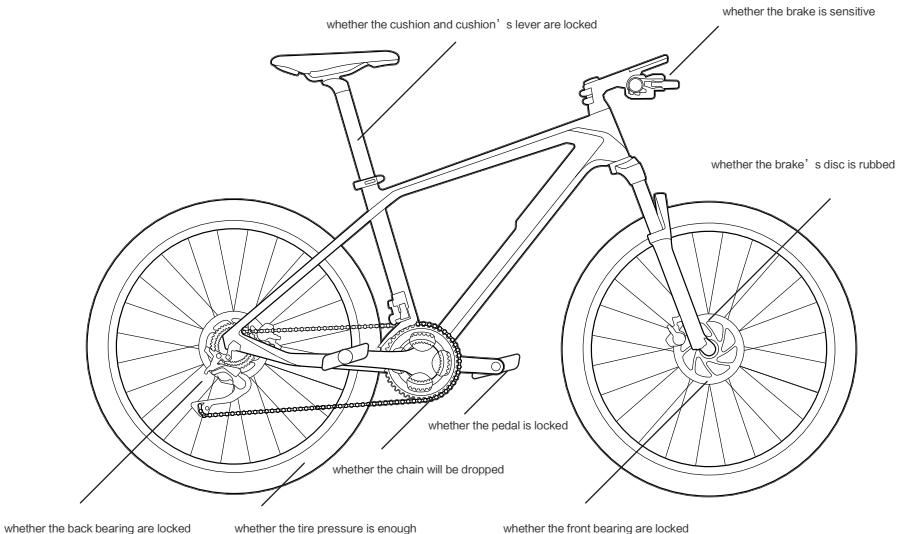



FCC statements:

This device complies with part 15 of the FCC rules. Operation is subject to the following two conditions: (1) this device may not cause harmful interference, and (2) this device must accept any interference received, including interference that may cause undesired operation.

NOTE: The manufacturer is not responsible for any radio or TV interference caused by unauthorized modifications or changes to this equipment. Such modifications or changes could void the user's authority to operate the equipment.