

Welcome

Thank you for purchasing this product. Please read this manual thoroughly before use and retain it for future reference. We are confident you will enjoy this product and its many functions.

About the product

iBeamBlock consists of modular stackable component 'blocks' which are connected via magnetic pogo pins. The idea of this product was inspired by the iconic LEGO toy blocks.

It supports Do-It-Yourself configuration and a future proof design for subsequent blocks.

Comprising of 3 blocks (Projector L400, PadUnit PAD-45 and PowerBankUnit), **iBeamBLOCK** L400 Deluxe provides 4 simple usage configurations.

iBeamBLOCK is a powerful computing system designed for on the go convenience. Featuring a HDMI projector capable of displaying a 100" screen, it is an ideal solution for business, entertainment, mobility and indoor use.

Safety Notice

1. Keep the device and packaging materials out of the reach of infants and children.
2. Avoid subjecting the power adapter and other contacts to dripping or splashing water and dry your hands before you use it. Do not place objects filled with liquids such as vases, etc. on or near the device.
3. Make sure that the used power outlet is always readily available and never hidden. In case of emergency, use the power adapter to separate the device from the power network.
4. Keep your device away from all flames such as candles and do not set them up in the vicinity of the device.
5. Keep the unit at least 10 cm away from other objects. Make sure the ventilation is not covered by newspapers, tablecloths, curtains, etc.
6. For your own safety, do not use the projector during thunderstorms or lightning.
7. Relative Humidity is 20% ~ 80%, non-condensing.

8. Ensure that the ambient room temperature is within 5 ~ 35°C.
9. Wait before using if the device has been moved from a cold location into a warm one. Any condensation that has formed may in certain circumstances destroy the device. As soon as the device has reached room temperature it can be used without risk.
10. Handle the product with care. Avoid contact with sharp objects. Keep device away from metallic objects.
11. Place the projector on a flat surface. Any collision or falling to the ground is likely to damage the product.
12. Do not drop or disassemble the product otherwise the warranty voids. Opening or removing covers may expose you to dangerous voltage or other hazards. Refer all servicing to an authorized service center.
13. Use only the accessories supplied by the manufacturer.
14. Both product and user's manual are subject to further improvement or supplement without further notice.

Care and Safety Information for Pico Projectors

1. Avoid facing directly into the projector's lens.
2. During the operation, this product may heat lightly, which is normal.
3. The device should not be used in a very dusty environment. Dust particles and other foreign objects may damage the unit.
4. Do not expose the device to extreme vibrations. It may damage the internal components.



Avoid Hearing Damage:

Listening at high volume for a long period of time could cause damage to your ears.



Notice for Long-time Projection

The built-in battery supports approximately 80 mins of projection. For long time projection, you are recommended to use AC adapter.

When the battery capacity icon displays , the battery is weak to stay in operation. You need to charge the product while the icon showed.



The CE marking certifies that the product meets the main requirements of the European Parliament and Councils directives EN55022 and/or EN55024 on information technology equipment, regarding safety and health of users and regarding electromagnetic interference.

The declaration of compliance can be consulted on the site www.aiptek.de.



Packaging: The presence of the logo (green dot) means that a contribution is paid to an approved national organisation to improve package recovery and recycling infrastructures. Please respect the sorting rules set up locally for this kind of waste.

Batteries: If your product contains batteries, they must be disposed of at an appropriate collection point.



The crossed-out waste bin stuck on the product means that the product belongs to the family of electrical and electronic equipment. In this respect, the European regulations ask you to dispose of it selectively;

- At sales points in the event of the purchase of similar equipment.
- At the collection points made available to you locally (drop-off center, selective collection, etc.).

In this way you can participate in the re-use and upgrading of Electrical and Electronic Equipment Waste, which can have an effect on the environment and human health.

The paper and cardboard packaging used can be disposed of as recyclable paper. Have the plastic wrapping recycled or dispose of it in the non-recyclable waste, depending on the requirements in your country.



FCC Compliance Statement:

This device complies with Part 15 of the FCC Rules.

Operation is subjected to the following two conditions:

(1) this device may not cause harmful interference, and (2) this device must accept any interference received, including interference that may cause undesired operation.

This equipment has been tested and found to comply with limits for a Class B digital device, pursuant to Part 15 of the FCC rules. These limits are designed to provide reasonable protection against harmful interference in residential installations. This equipment generates, uses, and can radiate radio frequency energy, and if not installed and used in accordance with the instructions, may cause harmful interference to radio communications. However, there is no guarantee that interference will not occur in a particular installation. If this equipment does cause interference to radio or television equipment reception, which can be determined by turning the equipment off and on, the user is encouraged to try to correct the interference by one or more of the following measures:

- Reorient or relocate the receiving antenna.
- Move the equipment away from the receiver.
- Plug the equipment into an outlet on a circuit different from that to which the receiver is connected.
- Consult the dealer or an experienced radio/television technician for additional suggestions.

For product available in the USA/Canada market, only channel 1~11 can be operated. Selection of other channels is not possible.

This device and its antennas(s) must not be co-located or operating in conjunction with any other antenna or transmitter except in accordance with FCC multi-transmitter product procedures.

FCC Radiation Exposure Statement:

This equipment complies with FCC radiation exposure limits set forth for an uncontrolled environment. This equipment should be installed and operated with minimum distance 20cm between the radiator & your body.

All cables used to connect peripherals must be shielded and grounded. Operation with cables connected to peripherals that are not shielded and grounded may result in interference to radio and television reception.

You are cautioned that any change or modifications to the equipment not expressly approved by the party responsible for compliance could void your authority to operate such equipment.

iBeamBLOCK Components

Projector(L400)

Top-Front



Bottom-Rear

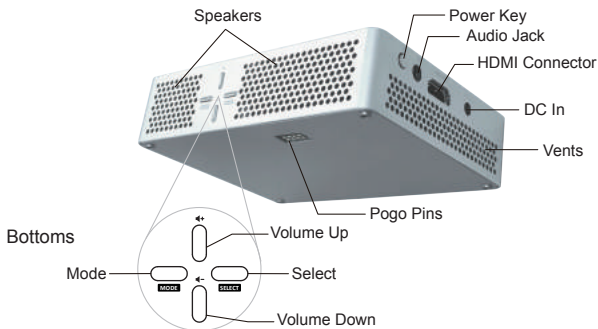

Package Content

- Projector L400
- Power Adapter
- Power cables – EU+US
- HDMI Cable
- User Manual

PadUnit (Optional)

Top

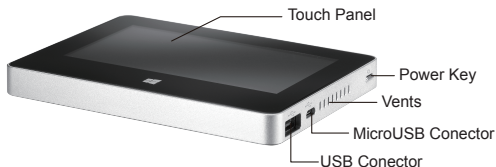

Bottom-Rear



Package Content

- PadUnit
- User Manual

PowerBankUnit (Optional)



Package Content

- PowerBankUnit
- User Manual

Getting Started

Usage Configuration of iBeamBlock L400 Deluxe



1. Projector only (Power Adapter needed)
2. PadUnit + Projector (Power Adapter needed)
3. Projector + PowerBankUnit
4. PadUnit + Projector + PowerBankUnit

Operating the Projector:

The Projector needs to be plugged with a Power adapter or stacked with a PowerBankUnit (containing sufficient power capacity) to operate.

Power ON:

Press 'Power Key' and hold for 2 seconds to turn on projector.

Projector Screen On/Off:

Push the 'Power Key' to turn OFF the projector light temporarily, push again to turn ON projector light.

Power OFF:

Press and hold 'Power Key' for over 3 seconds to turn off projector.

Adjusting the Focus

Place the projector on a flat surface and the lens toward a wall or a projection screen. Adjust the focus by spinning the focus ring to achieve a sharp and clear picture at its projection distance.

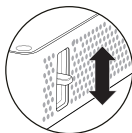

L400 can project clearly from 50 to 319cm (20" ~ 125") distance and projection size from 51 to 305cm (20" ~ 120")

Projector OSD Menu

L400 supports the adjustments of Audio Volume, Brightness, Keystone and Projection Placement.



Press **◀+ ▶-** to adjust audio volume Up and Down.

Press "MODE" to switch between Brightness, Keystone and Projection Placement. Then press "SELECT" to change and activate the setting.



Brightness:

Used to adjust the projection brightness

	Enhanced mode for the brightest projection performance.
	Optimal mode (default) for the balance between projection performance and battery life.
	Economic mode, recommended for power saving.



Keystoning:

Used to correct the projection image from trapezoid to rectangular at any projection angle.

	Automatically corrects the projection shape (default).
	Manually adjust the keystone Up or Down.



Projection Placement:

Selects the way the projector faces the screen so the image is oriented correctly.

	Front (Default)
	Rear
	Front-Ceiling
	Rear-Ceiling

Projecting Source: L400 supports Projection from an external device via HDMI or PadUnit

Projection from a **external HDMI device is higher priority**, compared to the PadUnit. To ensure projection from PadUnit, please disconnect any external HDMI connection.

Projecting from an External Device via HDMI

Use the HDMI cable to connect the HDMI port of the projector to the external HDMI signal source. After connecting, the screen will switch to the HDMI source automatically.



Projecting from iOS devices

1. Connect iPhone SE, 6/6S Plus, 6/6S, 5/5S, iPad Air, Air 2, iPad mini, mini 2, mini 3 and iPod touch (5th Gen) with the projector via the Apple Lightning Digital AV adapter and HDMI cable.
2. For iPhone 4, 4S, New iPad, iPad 2, and iPod touch (4th Gen), connect the projector with the Apple 30-pin digital AV adapter and HDMI cable.

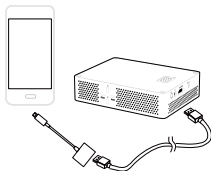

Note: Apple Lightning Digital AV adapter and 30-pin digital AV adapter are not included in the package.

Projecting from PadUnit

1. Stack PadUnit on top of the Projector L400.
AVOID hot plug between iBeamBLOCK component blocks. Before turning on Projector, please make sure all the blocks align and stacked properly. DO NOT stack PadUnit upon Projector while projection, ie. Projector ON.
2. Turn On PadUnit
Please make sure Projector power ON (after "Waiting for HDMI signal" or searching signal displays) before PadUnit power on.

PadUnit Power ON/OFF

1. Power ON: Press and hold 'Power Key' of PadUnit for 3 secs to turn on.

2. Power OFF: Press and hold 'Power Key' of PadUnit for 3 secs till the screen shows "Slide to shut down your PC" then slide down the screen of touch panel or select WIN10 Start button to initiate shutdown.

Turn OFF PadUnit in advance before turning Projector OFF.

3. Projection image from the PadUnit screen requires a few seconds after turned ON.

Supplying Power

1. Stack PowerbankUnit under Projector.
2. Projector can be operated without a power adapter if PowerBankUnit has sufficient power capacity (See indication of LED light).
 - The Power Adapter bundled with Projector is able to plug to DC-in jack either Projector or PowerBankUnit
 - When Projector stacked with PowerBankUnit, please plug Power Adapter into PowerBankUnit DC-in jack if required.

For a detailed guide for operating the PAD and PowerBank please refer to the user guide of PadUnit and PowerBankUnit.

HDMI Input Timing Support list

Resolution	Refresh rate (Hz)
640x480	60
800x600	60
1024x768	60
1280x720	60
1280x768	60
1280x800	60
1366x768	60
1600x1200	60
1920x1080	60
1920x1200	60

Troubleshooting

If the projector is functioning properly, please check the following before you contact an authorized service center.

Symptom	Check Point
The projector does not work when connecting to an external device.	<ul style="list-style-type: none">• Check the HDMI cable is plugged correctly.• Check the power adapter or PowerBankUnit is plugged correctly.• Check PowerBankUnit has sufficient power capacity.
The projected image is too dark.	<ul style="list-style-type: none">• Use the projector in a darker environment.• Plug power adapter or choose brighter mode.• Decrease the distance for a smaller but brighter projection image.
The projected image is blurred.	<ul style="list-style-type: none">• Adjust the focus.• Check if the lens is dirty.
The surface temperature of projector is hot.	<p>It is normal that this projector generates heat over prolonged use. It will not affect the performance of the projector.</p> <p>Always keep the ventilation slots free of dirt or obstructions and operate the projector in a properly ventilated environment.</p>
Abnormal performance	<p>If the projector is running slow, freezing, crashing or locking up during operation, remove the power cable or PowerBankUnit and restart the projector.</p>

Specifications-Projector L400

Item	Description
Optical technology	DLP
Light Source	RGB LED
Native Resolution	1280x720 Pixel (720P)
LED Lifetime	Up to 20,000h
Contrast	500:1
Throw Ratio	1.2
Aspect Ratio	16:9
Lens Offset	100 %
Projection Image Size (Diagonal)	51~305cm (20"~120")
Projection Distance	50~319cm (20"~125")
Brightness	Up to 400 sensual lumens
Focus	Manual
Keystone	Auto / Manual
Speaker	Built-in stereo speakers
Interface	HDMI, Audio jack, Pogo pins
Projection Source	HDMI, PadUnit
Power Adapter	100~240V AC input ,50~60Hz, DC 12V/3.5A
Power consumption	28W
Colour	Silver
Dimension (LxWxH)	125*95*30mm (4.92"x3.74"x1.18")
Weight	320g / 11.29oz
Humidity	20 – 80%, 80% (Max.), non-condensing.
Operating Temperature	5°C – 35°C