

User Manual

G-LED-002

14X14 Premium Lighted Canopy

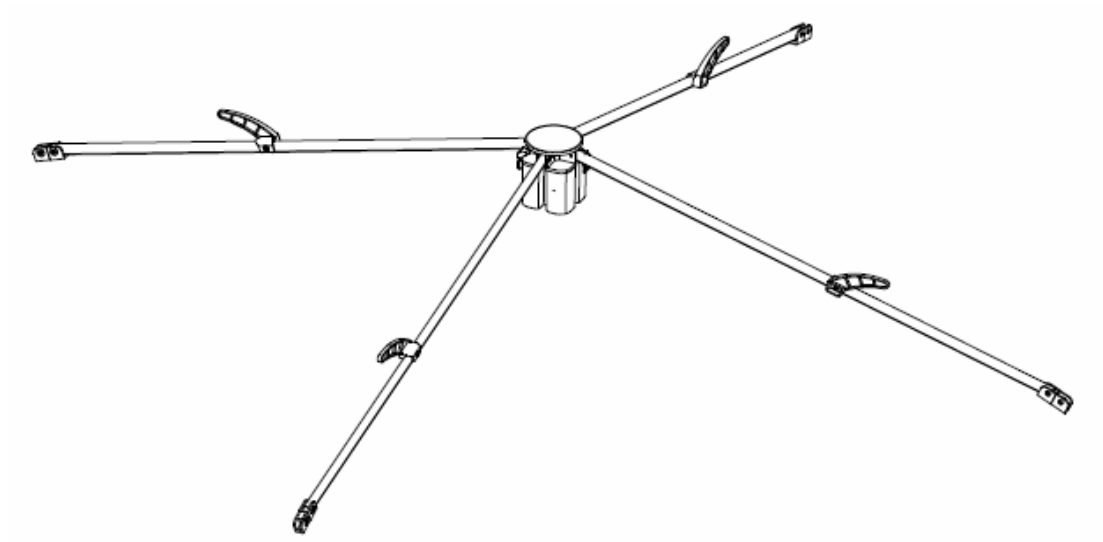

1. Product description:

- ① 4 D batteries supply power to system
- ② 3 different brightness
- ③ only 1 key, easy to use
- ④ 48 LEDs, high light efficiency
- ⑤ maximum power 3.6W, output 300lm minimum
- ⑥ high color-rendering index, restore object original color
- ⑦ when low battery, system dimming automatically, prolong battery life
- ⑧ high efficiency LED driver IC, longer battery life
- ⑨ aluminium lighting tube, lower temperature, longer LED life
- ⑩ 433MHz remote controller, distance more than 10M

2. Use instruction

- ① Follow 3 steps show in figure 1, install 4 D batteries. Pay attention to polarity of battery.

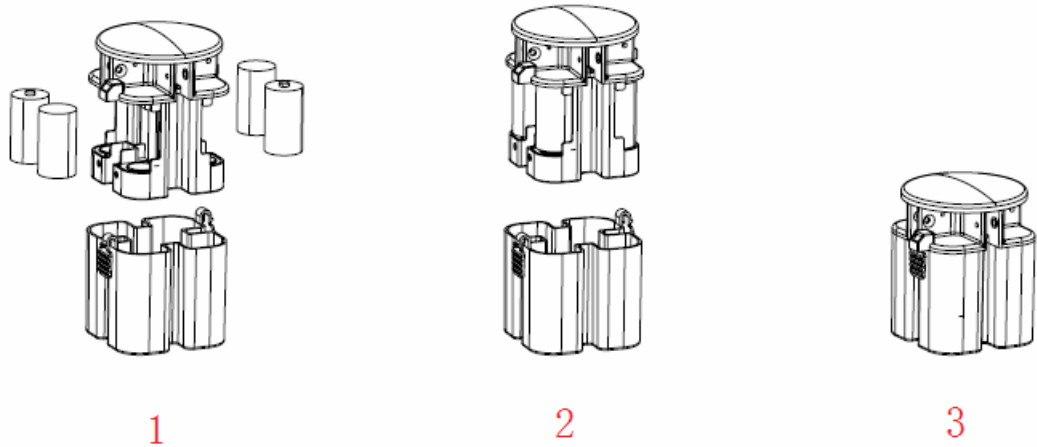

figure 1

- ② 1 key on remote controller (show in figure 2). When press key, state of lamp change according to figure 3.

Press key longer than 5s, remote controller go into pair mode, indicator LED flash 3 times.

Caution: Before remote controller go into pair mode, battery box must go into pair mode first.

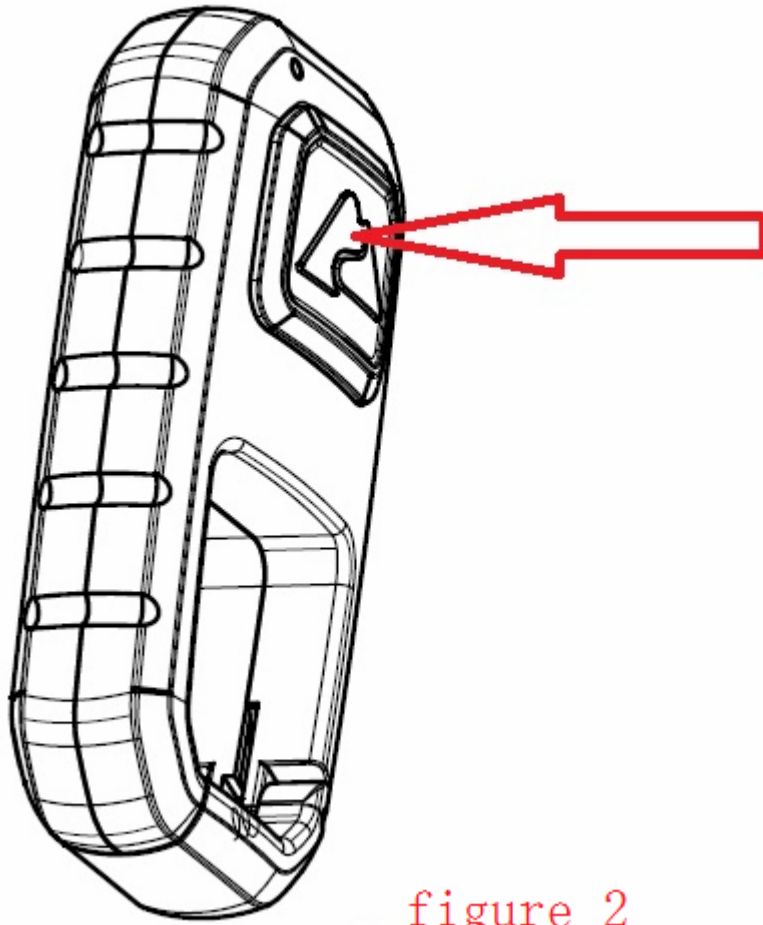

figure 2

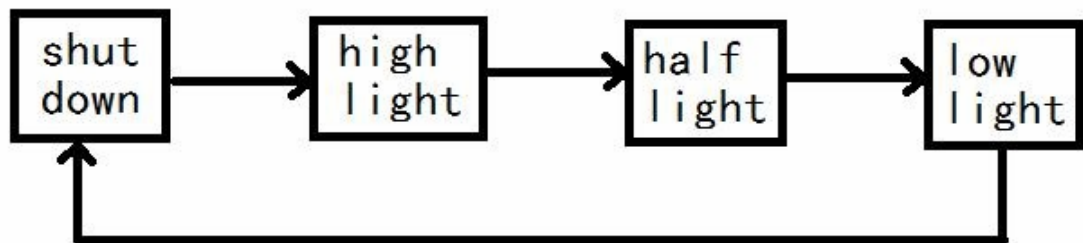

figure 3

③ 1 key on battery box (show in figure 4). When press key, state of lamp change according to figure 3 .

Press key longer than 5s, battery box go into pair mode, indicator LED light. If pair successfully, LED board and indicator LED flash 3 times.

Caution: Before remote controller go into pair mode, battery box must go into pair mode first.

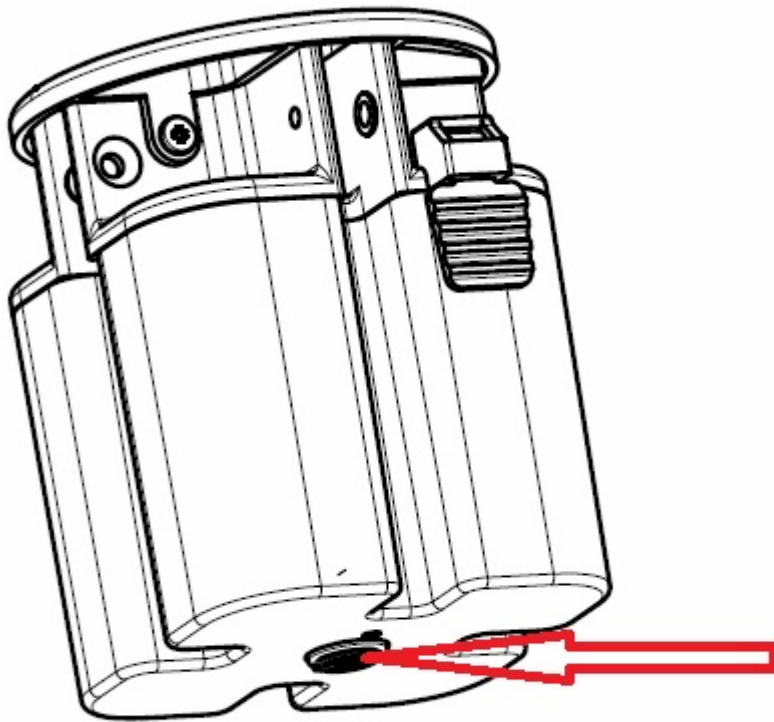

figure 4

④ If distance of remote controller work become short observably, that meaning remote controller battery run out, need replace a new CR2032 battery follow steps show in figure 5.

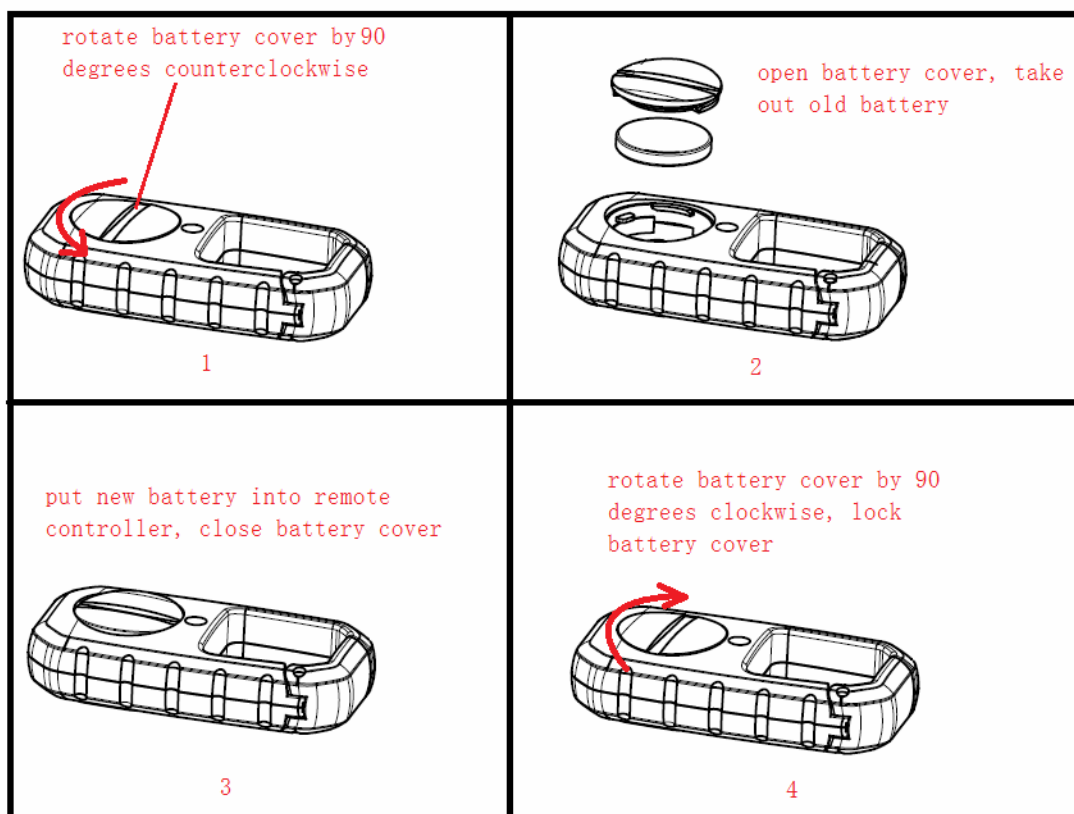

figure 5

3. Caution

- ① When insert D batteries into lamp, need pay attention to the mark on product. If Battery inserted incorrectly, may damage lamp
- ② When replace CR2032 battery on remote controller, need pay attention to polarity of battery. If Battery inserted incorrectly, may damage remote controller
- ③ Even lamp is shut down, system has a leakage current. If lamp not use for a long time, suggest take out D batteries, in order to avoid battery run out or battery leakage.

4. FCC Statement

Changes or modifications not expressly approved by the party responsible for compliance could void the user's authority to operate the equipment.

This equipment has been tested and found to comply with the limits for a Class B digital device, pursuant to Part 15 of the FCC Rules. These limits are designed to provide reasonable protection against harmful interference in a residential installation. This equipment generates uses and can radiate radio frequency energy and, if not installed and used in accordance with the instructions, may cause harmful interference to radio communications. However, there is no guarantee that interference will not occur in a particular installation. If this equipment does cause harmful interference to radio or television reception, which can be determined by turning the equipment off and on, the user is encouraged to try to correct the interference by one or more of the following measures:

- Reorient or relocate the receiving antenna.
- Increase the separation between the equipment and receiver.
- Connect the equipment into an outlet on a circuit different from that to which the receiver is connected.
- Consult the dealer or an experienced radio/TV technician for help

This device complies with part 15 of the FCC rules. Operation is subject to the following two conditions (1) this device may not cause harmful interference, and (2) this device must accept any interference received, including interference that may cause undesired operation.