

## Quick Installation Guide

### 300M WiFi Signal Repeater



1. Please power this device by plugging into USB port (Such as USB power charger, power bank, computer or USB port of TV). The indicator light will turn off after turning on, the process indicates that the device is starting up and is fully activated in about 15 seconds.
2. Open the WiFi setting of your phone to search and connect WiFi. The default WiFi name is EDUP-XXXX format (XXXX is random code).



3. Open the phone's browser page (such as "safari", Google Chrome, IE, etc.), type: 192.168.20.1, click the START button, the device will automatically scan the nearby 2.4G wifi signal.



4. In the list of available WiFi signals, select the WiFi signal that you want to expand. (For example: EDUP)

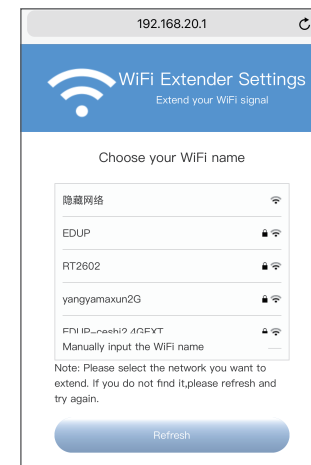

5. Type the password for the wireless signal to be extended, then click next step.

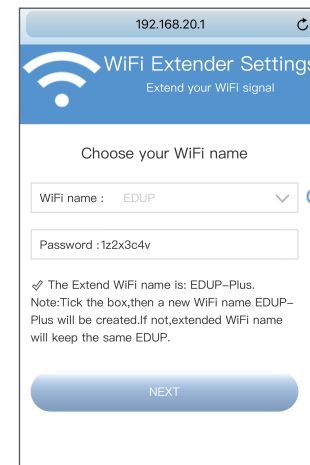

6. This interface displays the wireless settings status of the current device, then click to complete the settings.

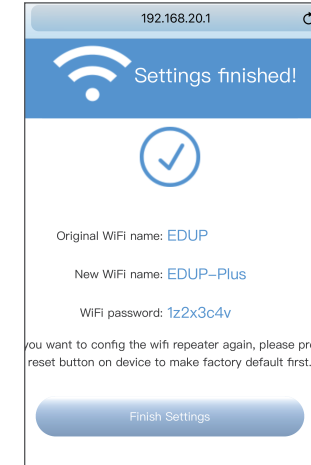

7. After completing the settings, a note interface appears: about the description of working status after the setting.

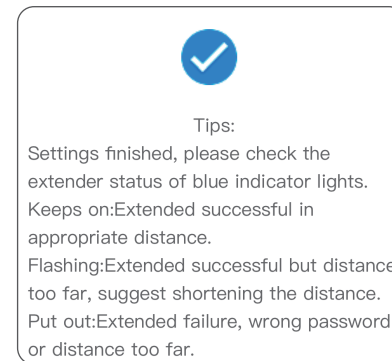

### Frequently Asked Questions

1. How to restore factory settings?  
Answer: When the wireless repeater device is powered on, press the RST button with a pointed object (such as a clip, a toothpick, etc.), and when the device light is turned off, it restore successfully.
2. Device indicator light status description?  
Without indicator light turning on: didn't repeat WiFi or didn't repeat successfully.  
Blue light is always turning on: expand WiFi successfully, the signal is very good.
3. What to do when can't open the settings interface?  
Answer: First confirm that your phone is connected to the WiFi signal of this device, open the phone browser and enter the default gateway: 192.168.20.1, then you can enter the setting interface.

**FCC ID: 2AHRDEP-2911S**  
**EP-2911S, OT2911S, EH-2911S, WT-2911S, KW-2911S**

### FCC Statement

1. This device complies with Part 15 of the FCC Rules. Operation is subject to the following two conditions:  
(1) This device may not cause harmful interference.  
(2) This device must accept any interference received, including interference that may cause undesired operation.
2. Changes or modifications not expressly approved by the party responsible for compliance could void the user's authority to operate the equipment.

This equipment has been tested and found to comply with the limits for a Class B digital device, pursuant to Part 15 of the FCC Rules. These limits are designed to provide reasonable protection against harmful interference in a residential installation.

This equipment generates uses and can radiate radio frequency energy and, if not installed and used in accordance with the instructions, may cause harmful interference to radio communications.. However, there is no guarantee that interference will not occur in a particular installation. If this equipment does cause harmful interference to radio or television reception, which can be determined by turning the equipment off and on, the user is encouraged to try to correct the interference by one or more of the following measures:

- Reorient or relocate the receiving antenna.
- Increase the separation between the equipment and receiver.
- Connect the equipment into an outlet on a circuit different from that to which the receiver is connected.
- Consult the dealer or an experienced radio/TV technician for help.