

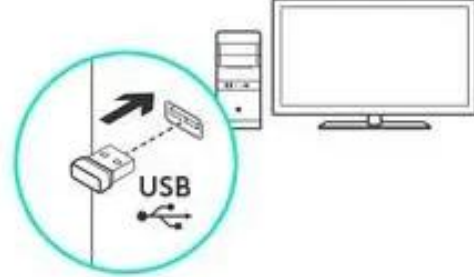

3

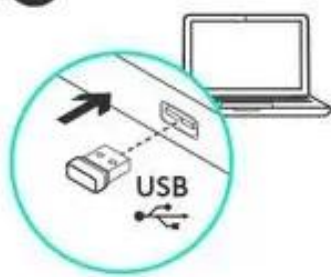

Specifications

WIRED KEYBOARD SLIM BK - Dongle

TC-KB-WS-101-BK

Transmission method: 2.4G wireless radio frequency;

Use frequency range: 2400-2483MHZ;

Frequency response: 20HZ-20KHZ;

Receiving sensitivity: $\geq -85\text{dBm}$.

Keyboard receiving radius ≥ 15 meters;

The automatic pairing connection distance between the keyboard and the receiver is ≥ 3 meters, and the pairing connection time is ≤ 1 second;

It will automatically enter the pairing state when it is turned on. After the pairing is successful, it will automatically enter the receiving state;

The receiver has its own antenna, no need to connect another antenna;

After successful pairing, the keyboard can operate the device

Overview

This device is a wonderful combination of a full, **QWERTY** keyboard and a touch pad mouse. The 2.4GHz Mini Wireless Keyboard operates with a universal USB interface Adapter, the Nano USB Receiver.

This device is perfect for everyday computer use when it would be difficult to use a typical mouse and keyboard setup. For example, a presenter, can operate their presentation display computer wirelessly from within a 30 foot radius. Change slides and screen options, write on the screen, highlight words and objects just by using this wireless Mini Keyboard and Mouse with Touch Pad.

For people who want to watch internet TV play on their computer or even standard TV, you can use this wireless mini combo like a universal remote control.

FCC ID:2AHN6-DE7

Note: This equipment has been tested and found to comply with the limits for a Class B digital device, pursuant to part 15 of the FCC Rules. These limits are designed to provide reasonable protection against harmful interference in a residential installation. This equipment generates, uses and can radiate radio frequency energy and, if not installed and used in accordance with the instructions, may cause harmful interference to radio communications. However, there is no guarantee that interference will not occur in a particular installation. If this equipment does cause harmful interference to radio or television reception, which can be determined by turning the equipment off and on, the user is encouraged to try to correct the interference by one or more of the following measures:

- Reorient or relocate the receiving antenna.
- Increase the separation between the equipment and receiver.
- Connect the equipment into an outlet on a circuit different from that to which the receiver is connected.
- Consult the dealer or an experienced radio/TV technician for help.

Caution: Any changes or modifications not expressly approved could void the user's authority to operate the equipment.

FCC Radiation Exposure Statement:

This equipment complies with FCC radiation exposure limits set forth for an uncontrolled environment.

FCC Warning

This device complies with Part 15 of the FCC Rules. Operation is subject to the following two conditions:

(1) This device may not cause harmful interference, and (2) this device must accept any interference received, including interference that may cause undesired operation.

NOTE 1: This equipment has been tested and found to comply with the limits for a Class B digital device, pursuant to part 15 of the FCC Rules. These limits are designed to provide reasonable protection against harmful interference in a residential installation. This equipment generates, uses and can radiate radio frequency energy and, if not installed and used in accordance with the instructions, may cause harmful interference to radio communications. However, there is no guarantee that interference will not occur in a particular installation. If this equipment does cause harmful interference to radio or television reception, which can be determined by turning the equipment off and on, the user is encouraged to try to correct the interference by one or more of the following measures:

- Reorient or relocate the receiving antenna.
- Increase the separation between the equipment and receiver.
- Connect the equipment into an outlet on a circuit different from that to which the receiver is connected.
- Consult the dealer or an experienced radio/TV technician for help.

NOTE 2: Any changes or modifications to this unit not expressly approved by the party responsible for compliance could void the user's authority to operate the equipment.

The device has been evaluated to meet general RF exposure requirement. The device can be used in portable exposure condition without restriction.