



# XT 001A

## XT FLYER Instructions

### XT FLYER®

Please read this manual before using this product! Please keep this manual, for future reference.

#### Specifications

Propeller:	ø 54mm	Motor:	ø7x20 (mm) 4 PCS
Dimensions:	135x135x101 (mm)	Charging time:	40minute
Lithium Battery:	3.7V 390mAh	Flight Time:	6-8minute
Weight:	40g	Gyro:	6-axis gyro

#### 1. Foreword

Thank you for purchasing a new XT Flyer! Please read the instructions carefully for most enjoyable and easy use before operating this aircraft. Also, please retain these instructions so that you may refer to them in the future when you wish to adjust and maintain your aircraft. If you wish to make adjustments to the aircraft, please do so outside, without windy conditions.

#### Important Notice

The aircraft is not an ordinary toy, and though it is small, there is still a risk involved (as with any flying vehicle) in operating it. Please observe the safety precautions and proper use of the model. Improper disassembly or modifications can cause unpredictable behavior in the craft, creating danger or an accident.

NOTE! During any use of the remote control aircraft, the manufacturer or distributor is not responsible or liable for the loss of the craft, harm to individuals or the environment due to improper assembly, or an accident occurring in an insecure environment. This product is intended to be operated by children and adults ages 8 years and older. Before flying the craft always be sure that the environment is safe and that you are aware of people and objects in the vicinity. Stay safe!

#### 2. Safety Precautions

Flying a model aircraft involves risk. Be sure to stay away from crowds and other objects when flying. Improper assembly or mechanical failure, the loss of electronic control, and not being familiar with the operation of the craft, may lead to loss of control and damage and other unexpected accidents. Please be sure to pay attention when flying, and understand the responsibility of any accident caused by negligence.

#### Important Notice

During indoor or outdoor flight, please stay away from obstacles. In order to avoid a vehicle collision, poor landing, or entanglement do not operate in an unsafe environment, such as near fire, electrical wires, power supply, in the rain, etc.



1

#### 3. Standard accessories



#### 4. Part Name

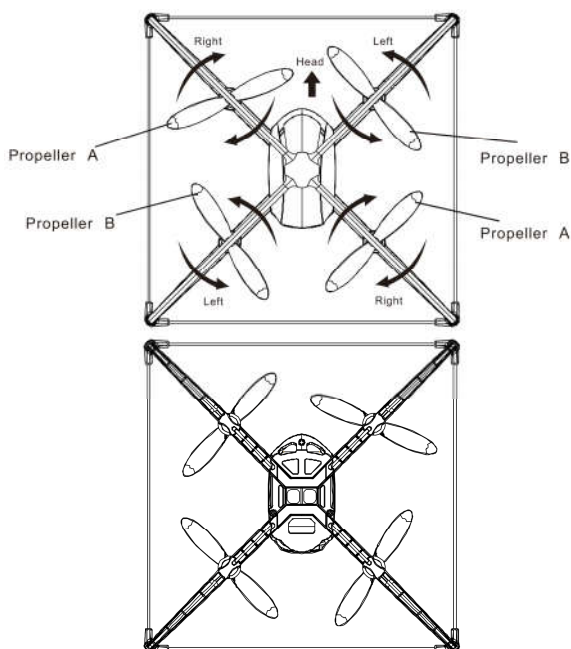

3

#### Lithium battery safety

Compared with other batteries, lithium batteries have a higher risk during use. Please read the instructions carefully before use, and follow these precautions while using and charging the battery. The manufacturer and distributor will not be held liable for any damages caused by improper use.

1. Do not use of batteries and chargers from other manufacturers to avoid possible When the battery is used for a long time or appears aging or swollen, please replace them timely.
2. Do not disassemble or alter the battery in any way (such as reversing the positive and negative terminals).
3. Do not burn the battery, cause metal objects to touch the positive and negative terminals, short-circuit, or let sharp objects piercing the battery. Avoid the risk of battery fire.
4. Please be careful when charging the battery. Charge in an area where you can see the battery and keep it away from small children to avoid danger. Battery should be put in the dried or ventilated place with environment temperature about 18~25℃, keep it far away from heat source or explosive product.
5. When the batteries are fully charged, if you do not remove it from the charger for a long time, the battery may discharge automatically, which may cause lower than the rated voltage, the charger will re-charge the battery until it is fully charged. Charging or discharging too often or repeated charging or discharging may reduce the using life of the batteries.
6. When the battery needs to be stores for a long time, please charge the battery for about 50~60% of the volume.
7. If you do not use it for more than 1 months, it's highly recommended that you need to check the battery voltage every month so as to make sure the voltage no less than 3V.
8. Please dispose of the battery properly in strict accordance with national and regional waste clean-up programs. Prevent pollution of the environment.

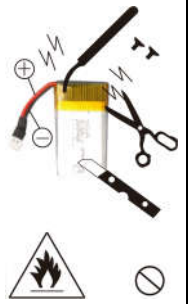

#### Keep Away from Humid Environments

The aircraft is constructed with many precision prevent any moisture or water from entering the product. Do not use 1 electronic parts. Absolutely n the bath, wet conditions, or rain. Unexpected accidents will occur.



#### Do not use the product incorrectly

Do not disassemble or modify this product. Please use only our product parts in order to ensure the safety of the aircraft.



#### Instructions for Battery Use

Be sure to install the positive and negative terminals properly. Do not mix old and new batteries, as this will shorten and affect battery life. If you are not going to use the product for a long time, remove the batteries to avoid battery leakage. If the batteries are found to have leaked or are damaged in any way, immediately discontinue use and dispose of the batteries in accordance with state law. Prevent pollution of the environment.



#### Keep away from Heat

This product, both the structure and the internal electronics are sensitive to heat. Do not leave the craft in a hot car or other hot environment where the structure may become deformed or damaged due to high temperatures.



#### Avoid Operating While Alone

This product is suitable for ages 8 and older. When learning to pilot a remote control aircraft there is a certain degree of difficulty. Guidance from an experienced pilot can help you learn and enjoy flying your craft.



2

#### 5. Battery charging operation

1. Insert plug from the battery into USB charger.
2. Connect USB cable to a standard USB outlet. USB charger indicator light is off during charging, the aircraft is being charged, the USB charger indicator light is on, the battery is fully charged, (charging time is approximately 40 minutes)



#### 6. Remote Control Part Names

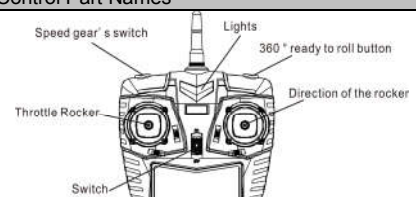

1. Speed gear's switch
2. 360° ready to roll button
3. Lights
4. Switch
5. Throttle Rocker
6. Direction of the rocker

NOTICE: The default power indicator is orange.

A slow flashing orange lights indicates inadequate power. Press the 360° roll button, the direction stick to the maximum, it will roll 3D! Proceed with caution!

#### 7. Install the Remote Control Battery



Open the Battery Door , install 6 AA Size Battery in the battery box. Be sure to install the positive and negative terminals properly.

4

## 8. Adjustment and setting the Flight



### Automatic frequency

Pull the throttle stick to the highest points and pull back to the lowest point, the automatic frequency is completed before the aircraft is started. A orange light indicates the completion of the frequency adjustment

Mode	Icon
Aileron	
Elevator	
Throttlo	
Rudder	
Calibration gyroscope	
Headless mode	

5

## 9. 360 ° Eversion and fast and slow speed switch

1. Press the throttle rocker switch on the left, then the remote give out "DD", and get the fast speed mode.
2. Slowly raise the throttle stick.
3. Operate the aircraft to maintain stable flight status.
4. When the aircraft is stable, press the direction of the rocker switch, then direction stick to any one direction, to flip the aircraft.



### Step two

Model	Icon
Flip right	
Flip Left	
Flip forward	
Flip back	



Press the button on the top left corner:  
"D" indicates slow mode  
"DD" means fast mode  
(The default mode is slow)

6

## 10. How to exclude flight status

Status	Cause	Countermeasure
Connect aircraft battery, the receiver keeps flashing lights, operating without reaction	Remote control and receiver not on the frequency	Please re-frequency
Connected to the aircraft battery, no reaction.	1. Check the remote control and the receiver is powered 2. Check the battery voltage 3. Battery positive and negative film is bad	1. Reconnect the battery 2. Full use of rechargeable batteries 3. Reconfirmed battery positive and negative, correct exposure
When the push throttle stick, the motor does not turn, the receiver indicator light starts blinking	Aircraft battery is not enough	Charge the battery, or replace it with a full battery
Aircraft vibration fast	1. Propeller deformation 2. Motor problem	1. Replace the propeller 2. Replace the motor

## 11. Each Part Name

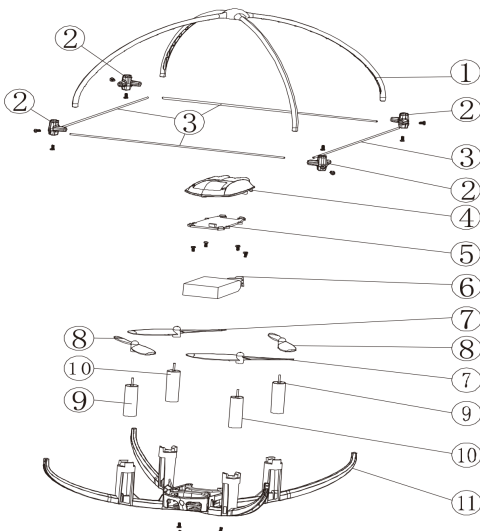

7

Number	Name	Number	Name
1	Protective cover	2	Connector
3	Protection bar	4	Decorative cover
5	PCB	6	Battery
7	Propeller A	8	Propeller B
9	Motor forward rotation	10	Motor reverse
11	Body frame		

### Precautions

1. Remote control or aircraft electricity shortage, the aircraft will fall down or shorten the flying distance.
2. If the aircraft power is low, it will take off difficult or fly in short distance.
3. If the aircraft appears damaged, deformed, please repair the damage parts. Do not fly otherwise it will cause injury.
4. If long-term no use the remote controller's battery, please remove it to prevent the battery leakage.
5. The aircraft crash or serious collision will damage or shorten the life of the aircraft.
6. Non-original batteries and chargers cannot be used instead.

### 12. Parts

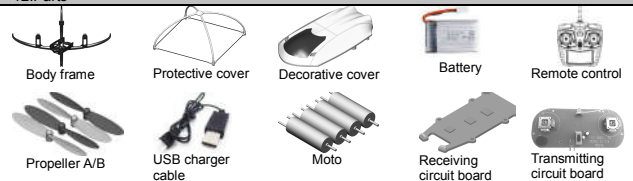

WARNING: This device complies with Part 15 of the FCC Rules.

Operation is subject to the following two conditions:

- (1) This device may not cause harmful interference.
- (2) This device must accept any interference received, including interference that may cause undesired operation.

CAUTION: Changes or modifications not expressly approved by the party responsible for compliance could void the user's authority to operate the equipment.

NOTE: This equipment has been tested and found to comply with the limits for a Class B digital device, pursuant to Part 15 of the FCC Rules. These limits are designed to provide reasonable protection against harmful interference in a residential installation. This equipment generates, uses, and can radiate radio frequency energy and, if not installed and used in accordance with the instructions, may cause harmful interference to radio communications. However, there is no guarantee that interference will not occur in a particular installation. If this equipment does cause harmful interference to radio or television reception, which can be determined by turning the equipment off and on, the user is encouraged to try to correct the interference by one more of the following measures:

- Reorient or relocate the receiving antenna.
- Increase the distance between the equipment and receiver.
- Connect the equipment into an outlet on a circuit different from that to which the receiver is connected.
- Consult the dealer or an experienced radio/TV technician for help.



SPECIFICATIONS AND COLORS OF CONTENTS MAY VARY FROM PHOTO.

The company has the right of final interpretation of this instruction manual statement.  
Distributor: XT FLYER LIMITED

8