

Product name:LifeFuels Bottle

To Begin:

- 1 Download the LifeFuels App by visiting LifeFuels.com/GetStarted.
- 2 Power on your Bottle via the Power/Reset Button.
- 3 Complete Bottle setup via the LifeFuels App.

Your Bottle comes with enough charge for setup. The LifeFuels App provides detailed instructions for setup and use.

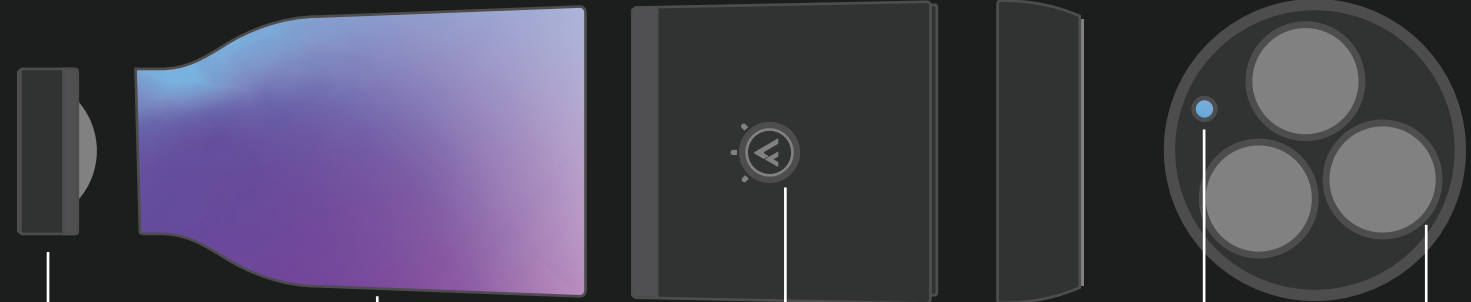

Charging Port

Open water tight seal
to charge with included
micro USB charger.

Vessel Cap

Remove the rubber bulb before dishwashing.

Vessel

Not for use with hot liquid. Top rack dishwasher safe.

Base

Charge lasts
5-7 days.
Hand wash only.

Front Button

Wake, cycle through loaded FuelPods, press and hold to dispense.

Base Cap

See FuelPods
through window,
remove with a twist.

Power/Reset Button

Located under the Base Cap on the bottom of the Base.

Bay

Clean with included brush after removing your FuelPod.

To Load Your FuelPods:

- 1 Unscrew the Base Cap and FuelPod cap.
- 2 Insert your FuelPod into any empty Bay.
- 3 The Bay LEDs will flash the corresponding color to your FuelPod's status.
- 4 Turn the FuelPod clockwise until you reach a stop.
- 5 Screw the Base Cap back onto the bottom of the Base.

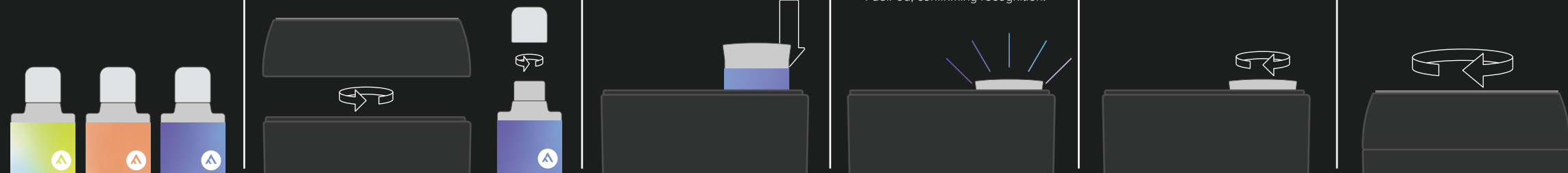

A large sphere with a vertical gradient from purple at the top to blue at the bottom is centered in the lower half of the image. The background is dark gray with three horizontal lines: a thin light green line at the top, a thin light green line in the middle, and a thin light blue line at the bottom. The text "Welcome to LifeFuels" is centered on the sphere.

Welcome to LifeFuels

Find Your Fuel



LifeFuels Quick Guide

Warning

- The Bottle is not intended for use with hot beverages.
- Do not microwave the Bottle.
- Do not put Base in the dishwasher.
- Keep components out of reach of children.



LifeFuels
Quick Guide

www.LifeFuels.com

Bottle Terms to Know

1. Vessel Cap
2. Vessel
3. Lanyard
4. Front Button
5. Base
6. Base Cap
7. Reset/Power Button
8. Bay
9. Expansion Bulb (Inside the Vessel Cap)
10. Vessel Gasket (Inside the Base)





How to Connect to the App

1. Download the LifeFuels App by visiting LifeFuels.com/GetStarted.
2. Power on your Bottle by removing the Base Cap and pressing the Reset/Power Button for 1-2 seconds. The LEDs will flash twice to confirm the Bottle is on.
3. Click on Get Started to create your account and follow the on-screen instructions to pair your Bottle and app.



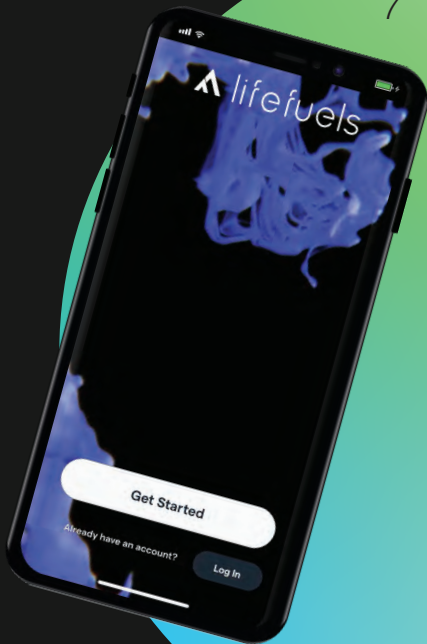

How to Load Your FuelPods

1. Unscrew the Base Cap from the bottom of the Base.
2. Unscrew the cap from the FuelPod.
3. Insert your FuelPod into any empty Bay. Then turn the FuelPod clockwise until you reach a hard stop.
4. Repeat step 3 with your remaining FuelPods.
5. Screw the Base Cap back onto the bottom of the Base.



Mix it up.



How to Dispense Your FuelPods Directly from the Bottle

1. Fill the Vessel with water.
2. Short press the Front Button to scroll through the FuelPod options.
 - Notice that you can turn your Bottle upside down to confirm which FuelPod you've selected. The LED indicator on the Front Button will match the LED on the bottom.
3. Once you've selected your desired FuelPod, long press the Front Button to dispense.
4. Shake the Bottle to mix.





lifeuels

How to Dispense Your FuelPods from the App

1. Fill the Vessel with water.
2. Open the LifeFuels App to the Bottle screen (Home Screen).
3. Select a FuelPod from the list under Ready to Dispense.
4. Select your preferred strength level.
5. Swipe the bar at the bottom right of the screen to dispense.
6. Press the X at the bottom of the screen to go back.
7. Shake the Bottle to mix.



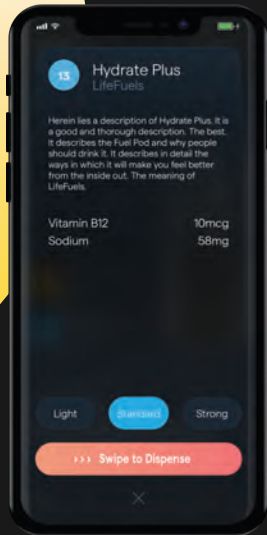
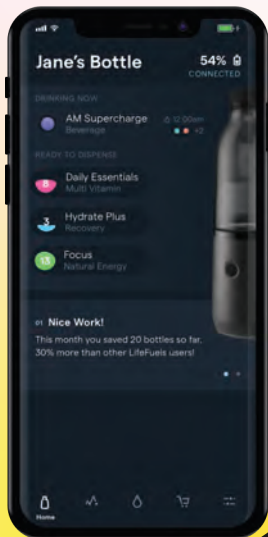

How to Clean Your Bottle

1. Remove the Vessel from the Base by twisting counterclockwise and lifting straight up.
2. Unscrew the Vessel Cap.
3. Pull the Expansion Bulb out of the Vessel Cap.
4. Remove the Lanyard from the Vessel.
5. Remove the Vessel Gasket from the Base.
6. Place your Vessel Gasket, Vessel Cap, Expansion Bulb and Vessel on the top rack of the dishwasher.

Note: Make sure not to use any cleaners that contain acetone. It may tarnish or damage the finish of the Bottle.





How to Clean Your Bottle (Continued)

7. Unscrew the Base Cap and turn the Bottle upside down so the FuelPods are facing up. Leave the Bottle in this position during cleaning.
8. Unscrew each FuelPod by turning them counterclockwise and remove them from the Bay.
9. Locate the cleaning brush provided in your package. Insert the brush into each Bay and circulate it to clean out any remaining liquid.
10. Turn the Bottle right-side up.
11. Use your cleaning brush to wipe around the top of the Bottle thoroughly.





How to Reassemble Your Bottle

1. Screw the Base Cap back onto the bottom of the Base.
2. Place the Vessel Gasket with the flat side down inside the Base.
3. Snap your Lanyard onto the top of the Vessel.
4. Notice a small cutout on the edge of the Base. Connect the other end of the Lanyard to that cutout.
5. Press it down into place with your finger.
6. Line up the Vessel notches to the notches in the Base and press down.
7. Turn the Vessel clockwise until you reach a hard stop to lock it into place.
8. Place the Expansion Bulb back inside the Vessel Cap with the bulb side facing out.
9. Press down on the Expansion Bulb for a secure fit.
10. Screw the Vessel Cap back onto the Vessel.

Note: The Expansion Bulb must be placed back inside to prevent leaking through the Vessel Cap.





How to Recycle Your Empty FuelPods

- A 100% recyclable poly mailer and a prepaid USPS return label are included in the bottom of your Bottle packaging.
- The bag can hold 25 used FuelPods.
- Once you've accumulated 25 used FuelPods, please ship them back to LifeFuels for recycling.







www.LifeFuels.com

FCC Statement

15.19

1. This device complies with Part 15 of the FCC Rules. Operation is subject to the following two conditions:

- (1) This device may not cause harmful interference.
- (2) This device must accept any interference received, including interference that may cause undesired operation.

15.21

Note: The grantee is not responsible for any changes or modifications not expressly approved by the party responsible for compliance. Such modifications could void the user's authority to operate the equipment.

15.105(b)

NOTE: This equipment has been tested and found to comply with the limits for a Class B digital device, pursuant to part 15 of the FCC Rules. These limits are designed to provide reasonable protection against harmful interference in a residential installation.

This equipment generates uses and can radiate radio frequency energy and, if not installed and used in accordance with the instructions, may cause harmful interference to radio communications. However, there is no guarantee that interference will not occur in a particular installation. If this equipment does cause harmful interference to radio or television reception, which can be determined by turning the equipment off and on, the user is encouraged to try to correct the interference by one or more of the following measures:

- Reorient or relocate the receiving antenna.
- Increase the separation between the equipment and receiver.
- Connect the equipment into an outlet on a circuit different from that to which the receiver is connected.
- Consult the dealer or an experienced radio/TV technician for help

IC Statement

This device complies with Industry Canada licence-exempt RSS standard(s). Operation is subject to the following two conditions: (1) this device may not cause harmful interference, and (2) this device must accept any interference received, including interference that may cause undesired operation.

Le présent appareil est conforme aux CNR d'Industrie Canada applicables aux appareils radio exempts de licence. L'exploitation est autorisée aux deux conditions suivantes :

- (1) l'appareil ne doit pas produire de brouillage, et
- (2) l'utilisateur de l'appareil doit accepter tout brouillage radioélectrique subi, même si le brouillage est susceptible d'en compromettre le fonctionnement.