

# Akuvox ACR-CID01

## Quick Guide

### Product Overview

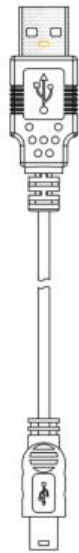

USB Cable

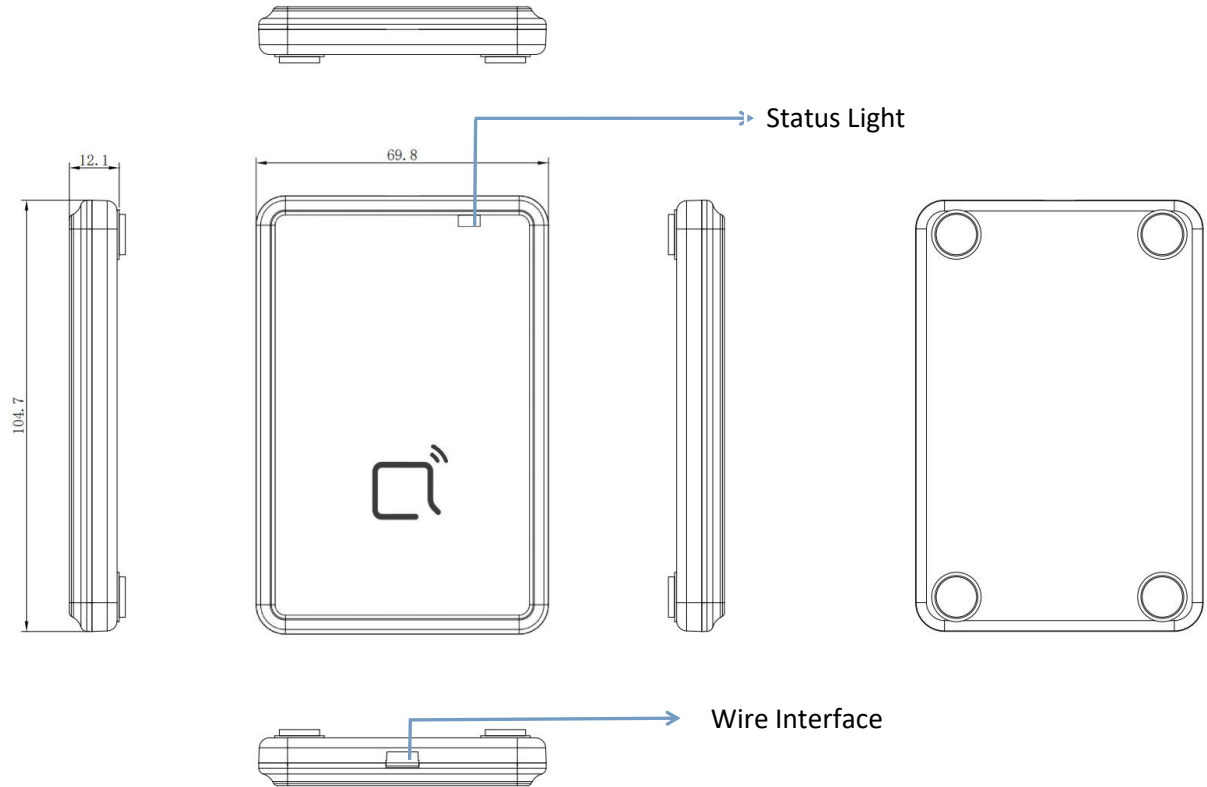

Note: Dimensions in the figure are in millimeters.

# Akuvox ACR-CID01

## Requirements

1. Place the device away from sunlight and light sources to prevent potential damage.
2. Do not place the device in the high-temperature, and humid environments or in surroundings impacted by magnetic field.
3. Ensure proper waterproofing to protect the device from water damage.
4. Do not use or place the device near heating objects.
5. Ensure the device is securely placed on a flat surface to prevent falling, and verify proper place before connecting it to power.
6. Disconnect the device from power before moving it.

### Caution

1. Do not knock device with hard objects.
2. Do not press down hard on the device.
3. Avoid stacking devices, ensure good ventilation in the operating environment.
4. Do not expose device to chemical products, such as alcohol, acid liquid, disinfectants, and so on.
5. Use wet cloth clean device surface softly, and then wipe the surface with dry cloth for cleaning the device.
6. If there is abnormal situation of the device, including uncommon sound and smell, please power off the device and contact Akuvox Technical Team immediately.

# Akuvox ACR-CID01

## Device Security

1. It is highly recommended to change the default password after first login and create a strong password.
2. Update device password periodically and store it securely to ensure that only authorized users can access the device.
3. Avoid using the same username and password for device as those used for other platforms and accounts to reduce the risk of information leaks.
4. To ensure access to the latest features and improve security, update device to the latest firmware version. Visit Akuvox Knowledge Base or contact authorized tech support team for the most recent firmware updates.

## Before Using

1. Place the device on a flat surface with the status light facing up and ensure it is stable.
2. Connect one end of the USB cable to the device and the other end to the PC to power it on. If the status light turns blue, flashes, and then remains on, the device has started successfully.
3. For detailed configuration steps, please refer to [\[link\]](#).

# Akuvox ACR-CID01

## Indicators

LED Status		Description
Blue	Always on	Normal status
	Flashing	Booting
Blue and Green	Flashing	Upgrading
Green	Always on	Card reading/writing successful
	Flashing	Card reading abnormal

# Akuvox ACR-CID01

## Warranty

1. Akuvox warranty does not cover intentional mechanical damage or destruction caused by improper installation.
2. Do not attempt to modify, alternate, maintain, or repair device by yourself. Akuvox warranty does not apply to damages caused by anyone who is not representative of Akuvox or an Akuvox authorized service provider. Please contact Akuvox Technical Team if the device need to be repaired.

## Get Help

For help or more assistance, contact us at:



<https://ticket.akuvox.com/>



[support@akuvox.com](mailto:support@akuvox.com)

Scan the QR code to get more videos, guides, and additional product formation.



# Akuvox ACR-CID01

## FCC Statement:

This device complies with part 15 of the FCC Rules. Operation is subject to the following two conditions: (1) This device may not cause harmful interference, and (2) this device must accept any interference received, including interference that may cause undesired operation.

This equipment has been tested and found to comply with the limits for a Class B digital device, pursuant to part 15 of the FCC Rules. These limits are designed to provide reasonable protection against harmful interference in a residential installation. This

Equipment generates,uses and can radiate radio frequency energy and,if not installed and used in accordance with the instructions,may cause harmful interference to radio communications.However,there is no guarantee that interference will not occur in a Particular installation.If thise quipment does cause harmful interference to radio or television reception, which can be determined by turning the equipment off and on, the user is encouraged to try to correct the interference by one or more of the following measures:

- Reorient or relocate the receiving antenna.
- Increase the separation between the equipment and receiver.
- Connect the equipment into an outlet on a circuit different from that to which the receiver is connected.
- Consult the dealer or an experienced radio/TV technician for help.

Caution: Any changes or modifications not expressly approved by the party responsible for compliance could void the user's authority to operate the equipment.

This equipment complies with FCC radiation exposure limits set forth for an uncontrolled environment. This transmitter must not be co-located or operating in conjunction with any other antenna or transmitter.

## Notice Information

***Information contained in this document is believed to be accurate and reliable at the time of printing. This document is subject to change without notice, any update to this document can be viewed on Akuvox' s website: <https://www.akuvox.com> © Copyright 2024 Akuvox Ltd. All rights reserved.***

