

This unique device is user friendly.

The key fob has a **RED** button and a **GREEN** button on it (as shown on the right).

The **RED** button **ARMS** the device and the **GREEN** button **DISARMS** it.

There is also a **SAFETY** "sleeve" on the key fob. Slide the sleeve over the buttons, when the key fob is **NOT** in use.

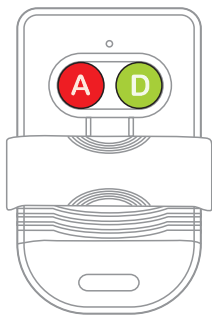

To ARM the device

- FACE** toward the device and **POINT** the key fob directly at the device.
- PRESS** the **RED** button firmly and hold it down until you hear one (1) short beep sound. Now release the button.
- A **red LED** light will flash once. The device is now **ARMED**, (turned on)
- EXIT time** is **60 seconds**. This allows you time to leave.

To DISARM the device

- The **ENTRY** delay time is pre-set for **30 seconds**. Upon entering the protected area turn and face the device.
- To **DISARM** (turn off the device) **POINT** the remote key fob directly at the device and **PRESS** the **GREEN** button firmly and hold it down until you hear two (2) beeps. Now release the button.
- When the device has been **DISARMED**, the strobe lights will stop flashing, and the device will automatically go back sleep mode awaiting instructions to be armed again.

It's just that SIMPLE

The device also has "PANIC" mode capability.

Even when the device is in sleep mode just **PRESS** the **RED** and **GREEN** buttons at the same time and hold them down for three (3) seconds and the device will automatically emit pepper spray.

4

To **STOP** the spray, just press the **GREEN** button and the device will go to the **SLEEP** mode. After the pepper spray has been disbursed install a **NEW** pepper spray canister.

ATTENTION PROFESSIONAL ALARM INSTALLERS:

It is recommended that you install this alarm device to a separate interior zone. The **BLACK** (negative) wire is hard wired to the **GND** connector, the **RED** (positive) wire goes to **+12V** and the **GREEN** or yellow wire is attached to the **TRIG** (trigger) connector.(as shown on right)

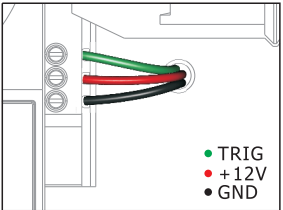

This device does **NOT** require batteries when powered from a 12 Volt alarm panel because the customer's alarm panel will have complete control over the pepper spray dispenser **device**.

This device complies with part 15 of the FCC Rules. Operation is subject to the following two conditions:(1) This device may not cause harmful interference, and (2) this device must accept any interference received, including interference that may cause undesired operation.

Changes or modifications not expressly approved by the party responsible for compliance could void the user's authority to operate the equipment.

5

PEPPER ALARM

installation operation

Now press **DOWN** on the front part of the **SAFETY CAP**.

When the front part is pushed down the back of the safety cap will automatically rise up.

If you are **NOT** exactly sure, please contact your dealer for help.

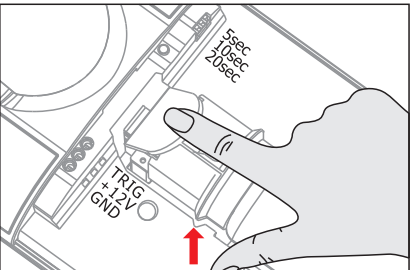

With the back side of the **SAFETY CAP** in the up position, **CAREFULLY** place the ridge part of the canister head into the groove (as shown with the **RED** arrow in picture) and push the canister in.

Now replace the cover on the device. Slide the cover **UPWARDS** until the cover "snaps" into place.

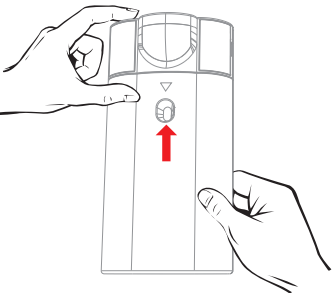

The alarm device is now ready to be activated.

VERY IMPORTANT: Change the batteries twice (2) a year same as you would in a smoke detector. Also it is a good idea to change the batteries **AFTER** a canister has been discharged.

RELOADING: (after the device has been discharged)

- First remove the batteries.
- Take out the old canister and replace the batteries with new ones.
- NOTE:** The Negative ends of the batteries go up into the device **FIRST**.
- Now slide the front cover back on.

3

You are now ready for installation

This alarm device should be placed high off the floor or above a doorway using the mounting screws provided and facing away from any windows. Insert SIX (6) **Ultimate Lithium** "AA" batteries (not included) into the device in the correct polarity. The **Negative (-)** end of the batteries go **up** into the device first. Once all the batteries are installed you will notice that the **strobe** lights will flash once. This is an indicator that the device has recognized the batteries. The device is now in **"SLEEP"** mode (conserving energy), waiting to be armed via a key fob.

VERY IMPORTANT: WE HIGHLY RECOMMEND YOU TEST THE DEVICE AS PER THE OPERATION INSTRUCTIONS FOUND IN THE PACKAGE PRIOR TO INSERTING THE PEPPER SPRAY CANISTER. WHEN YOU ARE CONFIDENT YOU UNDERSTAND THE ARM AND DISARM FUNCTION OF THE DEVICE YOU MAY THEN INSERT THE CANISTER.

Note: The factory has pre-set the **ENTRY** time delay on the device for **30 seconds**.

This time delay can be adjusted by simply lowering just **one (1)** of the dip switches (upper right hand side) to 20 seconds, 10 seconds or 5 seconds. See the picture to the right.

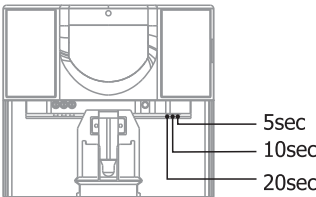

Just beside the dip switches you will see a **BLACK** button (above) the word **LEARN**. This button is helpful because if you lose a key fob just purchase a new one and place it within 3 inches of the device and hold the **black "LEARN"** button **DOWN** for two (2) seconds. The new key fob will instantly **"learn"** the **SECURITY CODE** of the alarm device.

INSERTING A CANISTER INTO THE DEVICE

Hold the **Mk3** pepper spray canister with your right hand. See the raised ridge around the canister top (just below the nozzle). This ridge is important because the ridge **MUST** slide into the grooves that are located just below the plunger in the device.

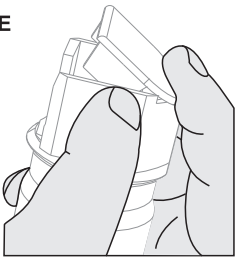

2

PRODUCT DIAGRAM

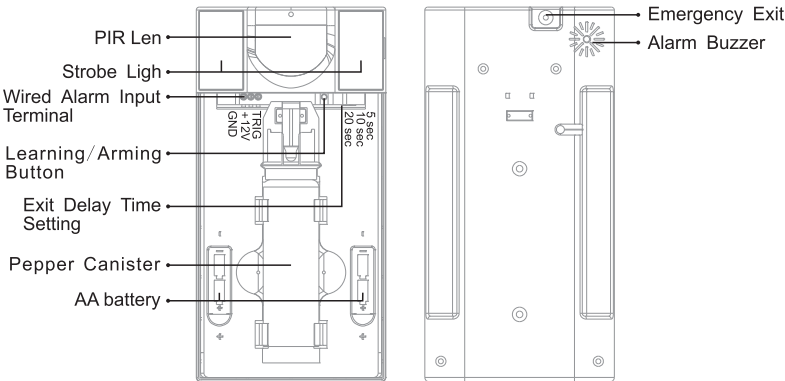

INSTALLATION INSTRUCTIONS

Purchasing a pepper spray canister

Pepper spray canisters **MUST** have "**grip grooves**" on both sides of a **MK3** flip top.

Just below the grip grooves, you will also see a ridge around the top. This ridge is **IMPORTANT** because it **MUST** slide into the grooves that are located just below the plunger **inside** the device.

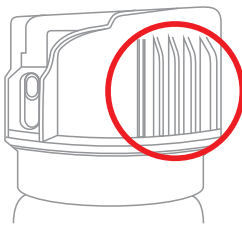

The Package

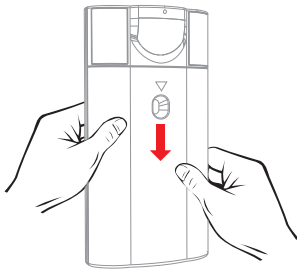

- Look at the front of the device and you see an arrow on the front cover just above the hole.
- Now place your thumbs on either side of the arrow and lightly press and slide the front cover off. (as shown with the **RED** arrow).
- Inside the device you will find **THREE (3)** key fobs, a package containing mounting screws and Operation Instructions.
- Take these items out of the device and put them aside for now.

1

SIZE: 160x115mm